



DC-26.5 GHz

## SMA and 3.5 mm Coaxial Fixed Terminations

- Low VSWR
- Operation to 26.5 GHz
- 10W, 5W and .5W models

### Specifications

SMA (M), DC to 18 GHz (Low / Medium Power)

FREQUENCY RANGE (GHz)	MODEL	POWER		VSWR* (max.)	WEIGHT	
		AVERAGE (W)	PEAK (kW)		oz.	gr.
DC-8	4377BM	5.0	2	1.05 + .015f	3.0	85
	4370DM	0.5	1	1.05 + .010f	0.1	3
DC-18	4379BM	0.5	1	1.05 + .005f	0.1	3
	4378BM	5.0	2	1.05 + .015f	3.0	85
	4375GM	10.0	2	1.05 + .015f	4.0	115

3.5 mm (M), DC to 26.5 GHz (Low / Medium Power)

FREQUENCY RANGE (GHz)	MODEL	POWER		VSWR* (max.)		WEIGHT	
		AVERAGE (W)	PEAK (kW)	DC-18	18-26.5	oz.	gr.
DC-26.5	4380M	0.5	1	1.05 + .0075f	<1.25	0.2	6

\* f represents frequency in GHz

# Terminations

## Outline Drawings

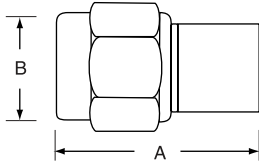

MODEL	A (max.)	B DIAMETER (max.)
4370DM	.75	.31
4379BM	.75	.31
4380M	1.02	.40

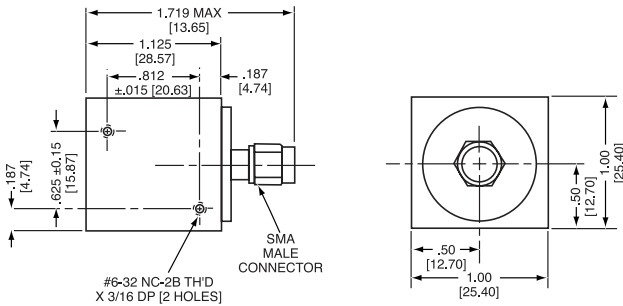
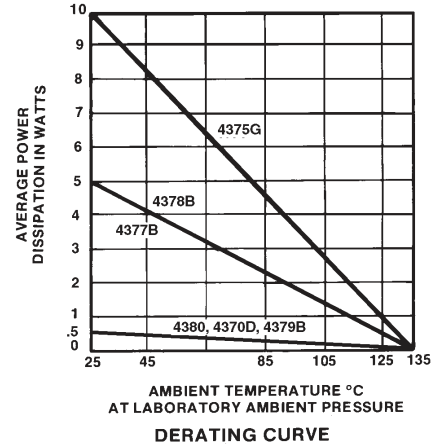

MODEL 4377 and 4378

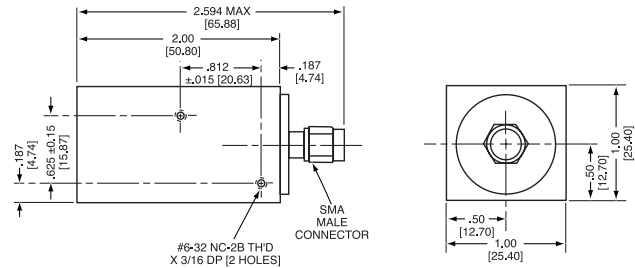

MODEL 4375

Dimensions in inches (mm in parentheses), unless otherwise specified.