

# KSU Series

## Micro Mini Surface Mount Detect Switches



### Features/Benefits

- New multi contact construction
- Metal actuator
- Low actuating force
- Gold contacts
- Compatible with pick and place machines
- RoHS compliant and compatible

### Typical Applications

- Mobile phones and other handheld devices
- Portable medical devices
- Audio devices
- Automotive
- Alarm devices
- Payment terminals

### Specifications

FUNCTION: Momentary action.  
 CONTACT TYPE: SPST Normally open.  
 TERMINALS: Gullwing type for SMT.

### Mechanical

ACTUATING FORCE:  
 W version: 1,1 N ±0,8 N  
 ST version: 0,7 N ±0,5 N

TRAVEL TO MAKE:  
 W version: 0,65 mm - 0,45/+0,25 mm  
 ST version: 0,45 mm - 0,25/+0,1 mm

MECHANICAL TRAVEL: 1,5 ± 0,2 mm  
 OPERATING LIFE: 100,000 cycles

### Packaging

Switches are delivered on continuous tape, in reels of 1,000 pieces

### Electrical

MAXIMUM POWER: 0.2 VA  
 MAXIMUM VOLTAGE: 32 VDC  
 MINIMUM VOLTAGE: 20 mV  
 MAXIMUM CURRENT: 0.01 A  
 MINIMUM CURRENT: 0.01 mA  
 CONTACT RESISTANCE: ≤ ≤ 100 mΩ  
 INSULATION RESISTANCE: (100 VDC) 10<sup>9</sup> Ω  
 DIELECTRIC STRENGTH: ≥ ≥ 250 Vrms  
 BOUNCE TIME: ≤ 3 ms

### Environmental

OPERATING TEMPERATURE: -40°C to +125°C  
 STORAGE TEMPERATURE: -55°C to + 125°C

### Process

SOLDERING: Compatible with lead free reflow process

**NOTE:** Specifications listed above are for switches with standard options.  
 For information on specific and custom switches, consult Customer Service Center.

### Build-A-Switch

To order, simply select desired option from each category and place in the appropriate box. Available options are shown and described on page E-17. For additional options not shown in catalog, consult our Customer Service Center.

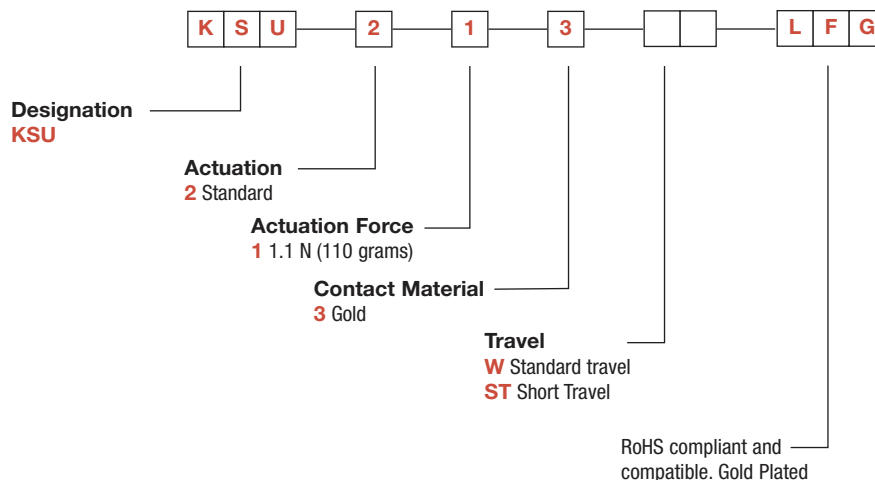

# KSU Series Micro Mini Surface Mount Detect Switches

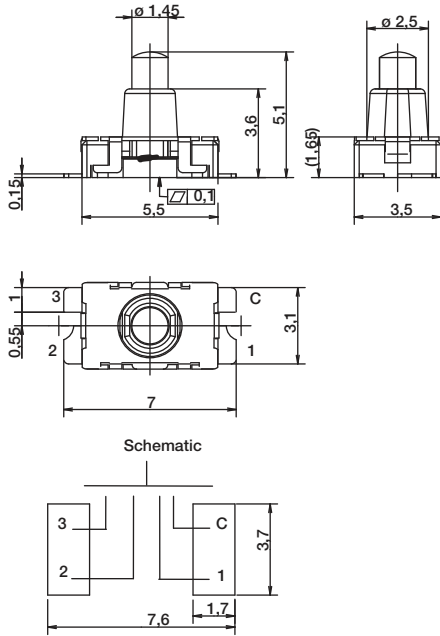

## TAPE & REEL



Detect