

DO NOT
SCALE FROM
THIS PRINT

DESIGNED & DIMENSIONED
IN INCHES[MILLIMETERS]

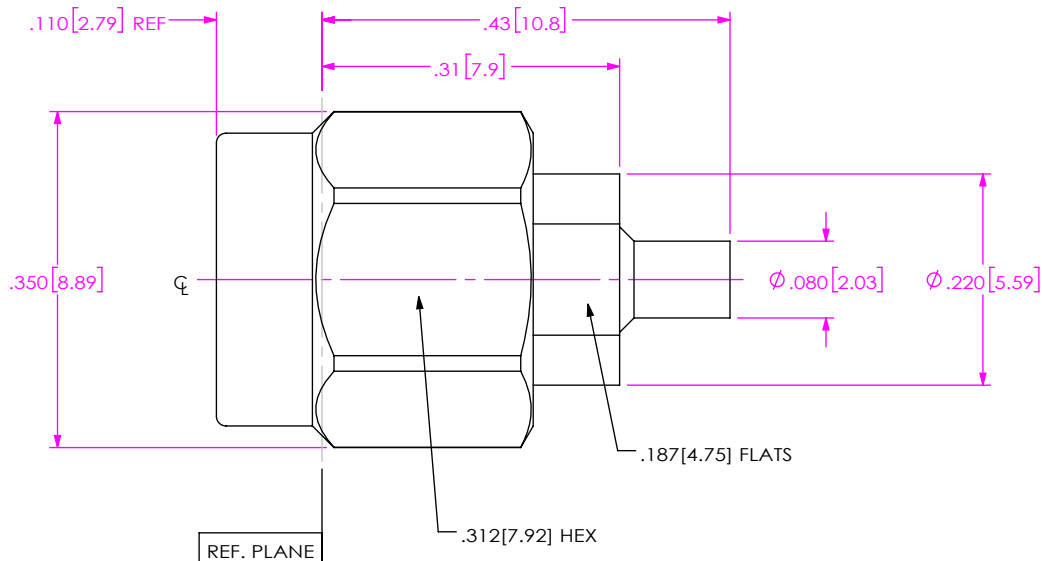

PRF92-P-C-EE-047H-SD

SERIES
-92: 2.92MM

GENDER
-P: PLUG

TYPE
-C: CABLE

TERMINATION
-D: DIRECT SOLDER

ORIENTATION
-S: STRAIGHT

CABLE TYPE
-047H: EZ-47-LA SEMI-RIGID

FINISH
-EE: 50µ" EXTRA HEAVY GOLD CENTER CONTACT,
50µ" EXTRA HEAVY GOLD OUTER BODY

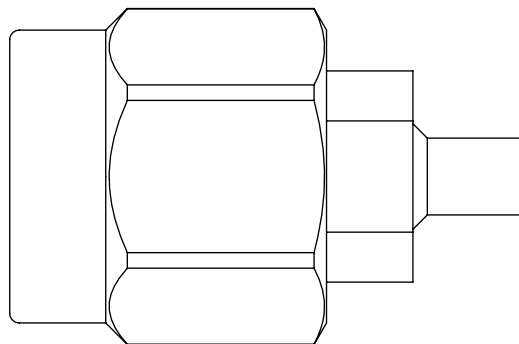
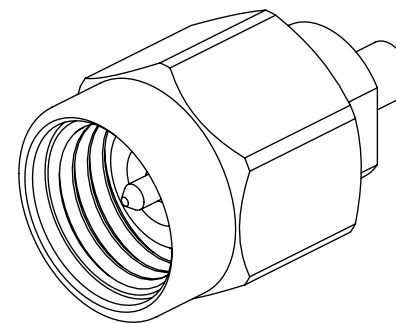

EXPLODED VIEW
NOT TO SCALE
(FOR CLARITY ONLY)

NOTES:

- MATERIAL:
BUSHING & COUPLING NUT: STAINLESS STEEL.
BODY, CONTACT & LOCK RING: BERYLLIUM COPPER.
SUPPORT BEADS: TEFLON FLUOROCARBON.
DIELECTRIC BEAD: ULTEM 1000.
GASKET: SILICONE RUBBER.
- FINISH:
COUPLING NUT & BUSHING: PASSIVATED.
BODY & CONTACT: GOLD OVER NICKEL PLATE,
50 MIN MIN GOLD OVER 50 MIN MIN NICKEL.
- PCI P/N: 4132.

F:\dwg\misc\mktg\PRF92-P-C-EE-047H-SD-MKT.SLDDRW

UNLESS OTHERWISE SPECIFIED,
DIMENSIONS ARE IN INCHES.
TOLERANCES ARE:
DECIMALS ANGLES
.XX: ±.02[0.5] 1°
.XXX: ±.005[0.13]
.XXXX: ±.0005[0.013]

PROPRIETARY NOTE
THIS DOCUMENT CONTAINS CONFIDENTIAL AND
PROPRIETARY INFORMATION AND ALL DESIGN,
MANUFACTURING, REPRODUCTION, USE, PATENT RIGHTS
AND SALES RIGHTS ARE EXPRESSLY RESERVED BY SAMTEC,
INC. THIS DOCUMENT SHALL NOT BE DISCLOSED, IN WHOLE
OR PART, TO ANY UNAUTHORIZED PERSON OR ENTITY NOR
REPRODUCED, TRANSFERRED OR INCORPORATED IN ANY
OTHER PROJECT IN ANY MANNER WITHOUT THE EXPRESS
WRITTEN CONSENT OF SAMTEC, INC.



520 PARK EAST BLVD, NEW ALBANY, IN 47150
PHONE: 812-944-6733 FAX: 812-948-5047
e-Mail info@SAMTEC.com code 55322

DO NOT SCALE DRAWING

SHEET SCALE: 5:1

DESCRIPTION: 2.92MM PLUG, DIRECT SOLDER FOR
EZ-47-LA SEMI-RIGID CABLE

DWG. NO.
PRF92-P-C-EE-047H-SD

BY: EVE L 01/09/2021 SHEET 1 OF 2

CABLE APPLICATION VIEWS

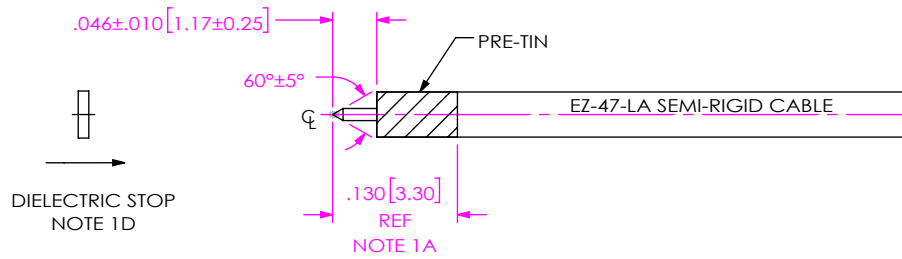

- 1A. PRE-TIN CABLE OUTER JACKET OVER APPROX. LENGTH SHOWN.
- 1B. TRIM CABLE TO EXPOSE CENTER CONDUCTOR AS SHOWN.
- 1C. POINT CENTER CONDUCTOR AS INDICATED.
- 1D. SLIDE DIELECTRIC STOP ONTO CENTER CONDUCTOR AGAINST CABLE FACE.

IN-PROCESS 1

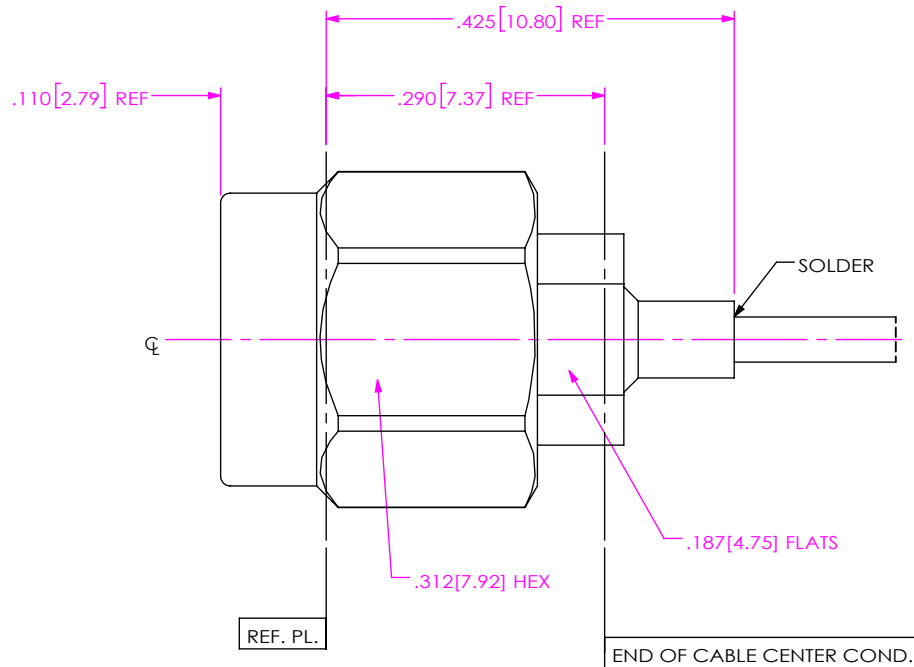

- 2A. INSERT CABLE INTO CONNECTOR UNTIL CENTER CONDUCTOR PLUGS IN AND CABLE SEATS IN CONNECTOR BORE.
- 2B. SOLDER CABLE JACKET TO BODY WHERE SHOWN APPLYING HEAT TO EXTENDED BODY TAIL.

IN-PROCESS 2

<p>PROPRIETARY NOTE</p> <p>THIS DOCUMENT CONTAINS CONFIDENTIAL AND PROPRIETARY INFORMATION AND ALL DESIGN, MANUFACTURING, REPRODUCTION, USE, PATENT RIGHTS AND SALES RIGHTS ARE EXPRESSLY RESERVED BY SAMTEC, INC. THIS DOCUMENT SHALL NOT BE DISCLOSED, IN WHOLE OR PART, TO ANY UNAUTHORIZED PERSON OR ENTITY NOR REPRODUCED, TRANSFERRED OR INCORPORATED IN ANY OTHER PROJECT IN ANY MANNER WITHOUT THE EXPRESS WRITTEN CONSENT OF SAMTEC, INC.</p>	 <p>520 PARK EAST BLVD, NEW ALBANY, IN 47150 PHONE: 812-944-6733 FAX: 812-948-5047 e-Mail: info@SAMTEC.com code 55322</p>	
	<p>DESCRIPTION: 2.92MM PLUG, DIRECT SOLDER FOR EZ-47-LA SEMI-RIGID CABLE</p>	
<p>DO NOT SCALE DRAWING</p> <p>SHEET SCALE: 5:1</p>	<p>DWG. NO. PRF92-P-C-EE-047H-SD</p>	
	<p>BY: EVE L</p>	<p>01/09/2021</p>
	<p>SHEET 2 OF 2</p>	