

THIS DRAWING CONTAINS INFORMATION THAT IS PROPRIETARY TO J.S.T. AND SHALL NOT BE USED OR SHOWN WITHOUT WRITTEN PERMISSION.

4		3		2		1	
ITEM	CONNECTOR PART NO.	DESCRIPTION	IPI CHECK	EOR CHECK	Applicable Tooling		
1	SLEB-001T-P0.2	LEB CONNECTOR CONTACT			APPLICATOR		
2	UL1061, 22 AWG	BLACK					

Applicable Housings	
NO. OF CIRCUITS	HOUSING PART NO.
1	LEBRP-01V-S
2	LEBRP-02V-S

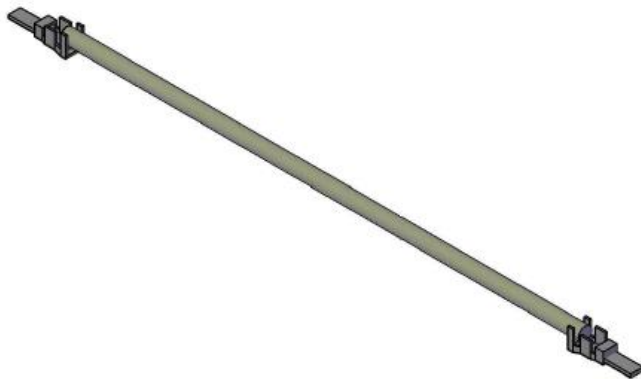
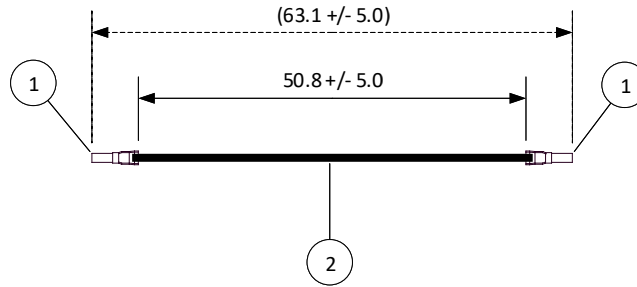

JST

SCALE 1:1	CUSTOMER NAME	CUSTOMER PART NO.
DIMENSIONS All dimensions are in MM with a tolerance of +/- 3.0 unless otherwise specified.	DESCRIPTION 4.0 mm Pitch LEB Series Standard Leads - 2" Inside Length DOUBLE-END LEADS, F-F	
DRAWN BY STEVEN PILKINGTON	ASSEMBLY PART NO. ALEBLEB22K51	
CHECKED BY JUSTIN BAKER	DRAWING NO. & REVISION GAM-181	REVISED 5/6/2016

REV.	DESCRIPTION	DATE	BY
------	-------------	------	----

4

3

2

1

D

D

C

C

B

B

A

A