

THIS DRAWING IS UNPUBLISHED. RELEASED FOR PUBLICATION 20
 © COPYRIGHT 20 BY TYCO ELECTRONICS CORPORATION. ALL RIGHTS RESERVED.

LOC	DIST	REVISIONS			
P	LTR	DESCRIPTION	DATE	DWN	APVD
F	00				
	B	HOLE DIA. TOLERANCES	09JUN2006	JJD	YP
	C	ECR 07-025006	26OCT2007	JT	GR

COUPE C-C

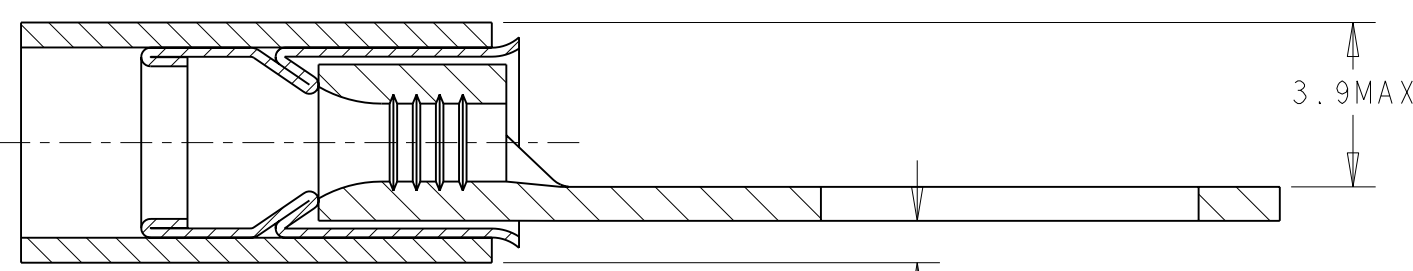

3.9 MAX

1.3 MAX

BODY 0.80±0.03 TONGUE THICKNESS

Ø8.34±0.13 FOR 5/16 STUD

STAMP : AMP 18 16

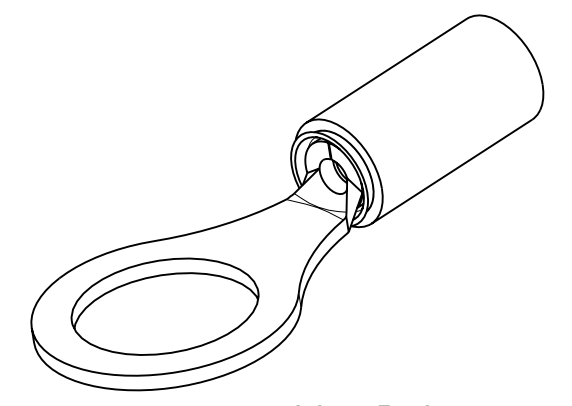

SCALE 3:1

FOR INSULATION Ø1.4 - 2.67

Ø5.15 MAX

SLEEVE

INSULATION

SERRATIONS

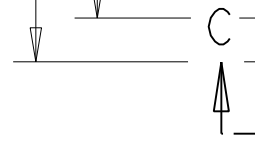

11.91±0.15

0.79 MIN

10.72 MIN

22.35 MAX

28.38 MAX

WIRE TERMINAL	1577635-1	BODY : COPPER ANNEALED FINISH : NICKEL PLATED
		SLEEVE : COPPER ANNEALED FINISH : NICKEL PLATED
		INSULATION : PEEK COLOR : ORANGE
DESCRIPTION	PART NUMBER	MATERIAL & FINISH

THIS DRAWING IS A CONTROLLED DOCUMENT FOR TYCO ELECTRONICS CORPORATION IT IS SUBJECT TO CHANGE AND THE CONTROLLING ENGINEERING ORGANIZATION SHOULD BE CONTACTED FOR THE LATEST REVISION.

DIMENSIONS: mm	TOLERANCES UNLESS OTHERWISE SPECIFIED:
	0 PLC ± 1 PLC ±0.3 2 PLC ± 3 PLC ± 4 PLC ± ANGLES ±5
MATERIAL SEE TABLE	FINISH SEE TABLE

DWN JJ. DESPRETZ 22FEB2006	Tyco Electronics France SAS 95300 Pontoise, France
CHK G. ROBERT 22FEB2006	
APVD Y. PETRONIN 22FEB2006	
PRODUCT SPEC 108-15356	NAME TERMINAL, PEEK PIDG STRATO, 18-16 AWG
APPLICATION SPEC 114-15102	SIZE CAGE CODE DRAWING NO RESTRICTED TO
WEIGHT 1,2 gr	A300779 C-1577635
CUSTOMER DRAWING	SCALE 6:1 SHEET 1 OF 1 REV C