

## MR LED 4' T8 Tubes

Beyond LED Technology's MR High Quality LED T8 lamps offer a good replacement for conventional fluorescent lamps, offering significant energy-efficiency and lifetime improvements. These tubes are an ideal replacement for 36w T8 or 40w T12 fluorescent tubes offering energy-savings of up to 55% compared to their T12 fluorescent equivalents. These products are often used in environments like offices, schools, shops, warehouses, and domestic applications such as kitchens and garages. This Type B version requires a ballast by-pass and can be used with either a single-ended or a double-ended power input. These lamps are available in 5000k (Cool White) and 6500k (Daylight) CCT models.



### Product Features

- Environmentally friendly: no mercury used
- Instant start-up and instant energy saving
- Frosted lens eliminates pixilation
- Operating temperature: -20°C to 45°C
- Integral driver (non-isolated), eliminates the need for an external driver or ballast
- Improved lamp durability with shatterproof coated glass (optional)
- Complies with UL safety regulations for tubes with double ended wiring
- Up to 150 Lumens per Watt
- Single & Double End Power
- Full glass housing inhibits yellowing and distortion
- Longer lifespan – 50,000 hours
- Uniform illumination with no visible LED pixilation
- No flickering for maximum eye comfort
- Universal 120-277Vac 50-60Hz

SKU #	Model #	Watts	Lumens	CCT	Lens	Power	Size	Certifications
153482	DYSYHU-TBGBBE2UL1218AM-50-B	18W	2724LM	5000K	Frosted	Single Ended/Double Ended	4'	UL & DLC
153483	DYSYHU-TBGBBE2UL1218AT-65-B	18W	2724LM	6500K	Clear	Single Ended/Double Ended	4'	UL

## SKU Number 153482 Specifications

Parameter	Description	Value
<b>General Performance</b>	Model #	DYSYHU-TBGBBE2UL1218AM-50-B
	Wattage	18W
	Lumen	Up to 2724LM
	Lumen Efficacy	Up to 150LM/W
	Color Temperature	5000K
	CRI (Ra)	>80
	Base Type	G13
	Beam Angle	>220 degree
	Lens	Frosted
<b>Electrical</b>	Input Voltage	120-277Vac
	Frequency	50/60Hz
	PF	≥0.9
<b>Physical</b>	Operating Temperature	-20°C TO 45°C
	Relative Humidity	45%-85%
	Housing	Glass Tube
	Size	4'
<b>Qualification</b>	IP Rating	IP20
	Lumen Maintenance	50,000 hours
	Warranty	5 years warranty with 24/7 operating hours Luminaire lifetime at 25°C



## SKU Number 153483 Specifications

Parameter	Description	Value
<b>General Performance</b>	Model #	DYSYHU-TBGBBE2UL1218AT-65-B
	Wattage	18W
	Lumen	Up to 2724LM
	Lumen Efficacy	Up to 150LM/W
	Color Temperature	6500K
	CRI (Ra)	>80
	Base Type	G13
	Beam Angle	>220 degree
	Lens	Clear
<b>Electrical</b>	Input Voltage	120-277Vac
	Frequency	50/60Hz
	PF	≥0.9
<b>Physical</b>	Operating Temperature	-20°C TO 45°C
	Relative Humidity	45%-85%
	Housing	Glass Tube
	Size	4'
<b>Qualification</b>	IP Rating	IP20
	Lumen Maintenance	50,000 hours
	Warranty	5 years warranty with 24/7 operating hours Luminaire lifetime at 25°C

## Correlated Color Temperature (CCT)

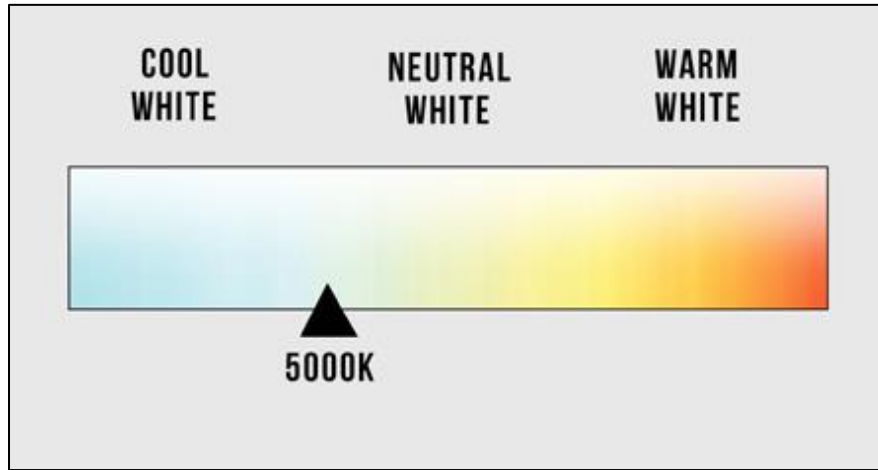

## Dimensions

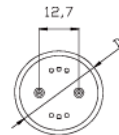
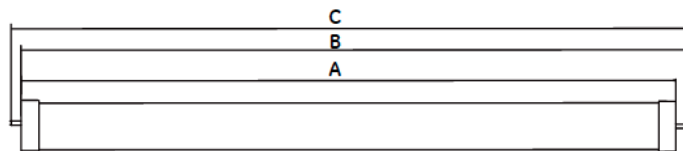

Maximum overall length (mm)	4ft
A	1198
B	1205
C	1213



## Photometric Data

### Luminous Intensity Distribution Curve

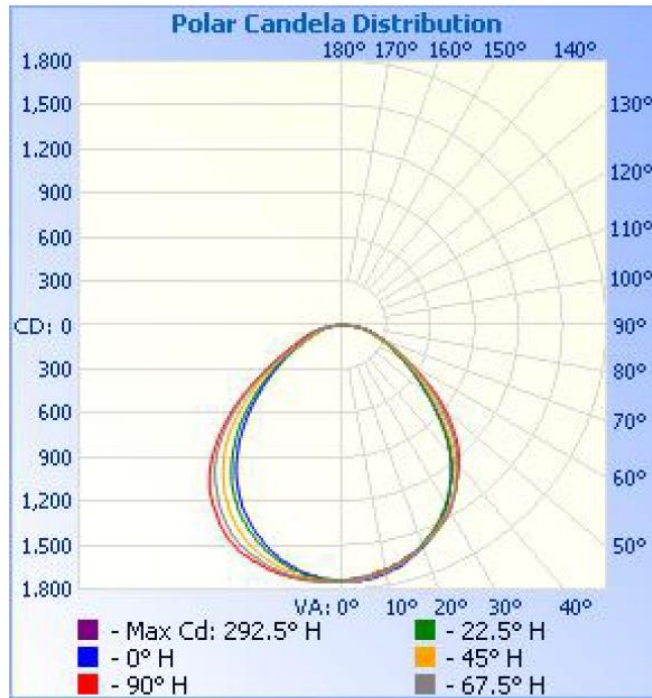

### Illuminance at a Distance

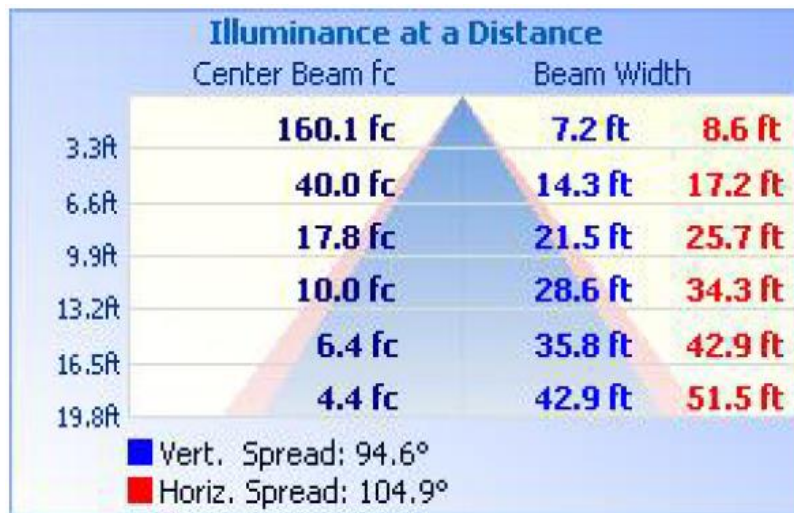

## Installation Instructions

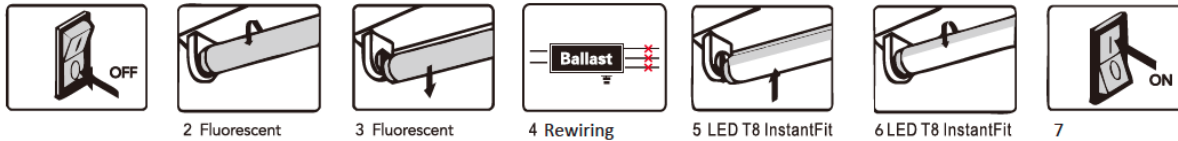

1. Turn off the power.
2. Remove diffuser (if provided).
3. Remove the fluorescent tubes. Please dispose of these items properly as they contain mercury.
4. Cut the wires as shown in the diagram.
5. Make the new wire connect to branch circuit as shown.
6. Replace the cover over the wiring channel.
7. Install the led tubes, close the diffuser.
8. Turn on the power.

## Wiring Diagram & Instructions

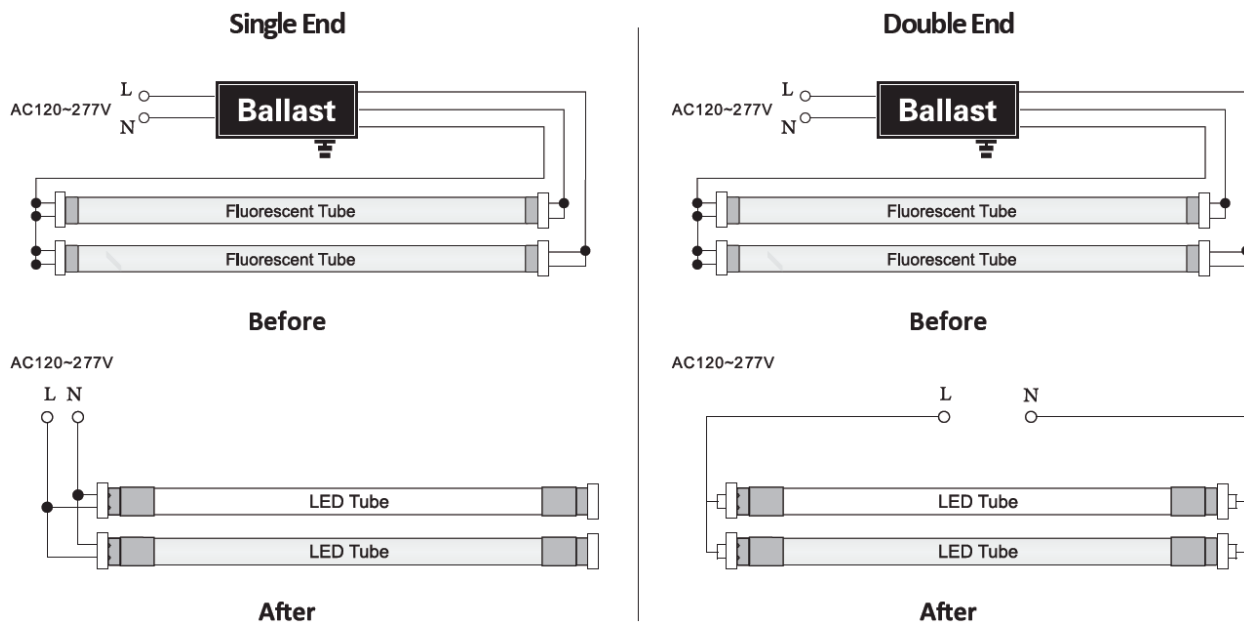

1. These lamps should be installed by a licensed electrician.
2. These lamps should be used indoors (damp or dry locations only). Not suitable for wet location.
3. Make sure tombstones/lamp holder are still in good condition and not defected before installation.
4. Put LED tubes/G13 pins into right position of the socket, install properly.
5. This device is not suitable for using with emergency exits.
6. These lamps are not suitable to be used with a light dimmer.
7. If the LED lamp damaged by anyone who didn't comply with above warning, We'll not responsible for that.

## Packaging Info

Size	Carton Size	Qty/Box	N.W./Box	G.W./Box
4'	48.62 X 7.7 X 7.7 in	25 PC	0.42 lbs	12.43 lbs

Tolerance of Carton Size:  $\pm 15$  MM, Tolerance of Weight:  $\pm 10\%$ .

<b>4' LED T8 Glass Tube MR Series</b> SKU:153482 Frosted		4' LED T8 Glass Tube MR Series SKU:153482 Frosted	
--	--	---	--

<b>4' LED T8 Glass Tube MR Series</b> SKU:153483 Clear		4' LED T8 Glass Tube MR Series SKU:153483 Clear	
--	--	---	--

## Application

- High Output for Car Parks.
- High Output for Supermarkets.
- High Output for Industry and Commercial Sector.

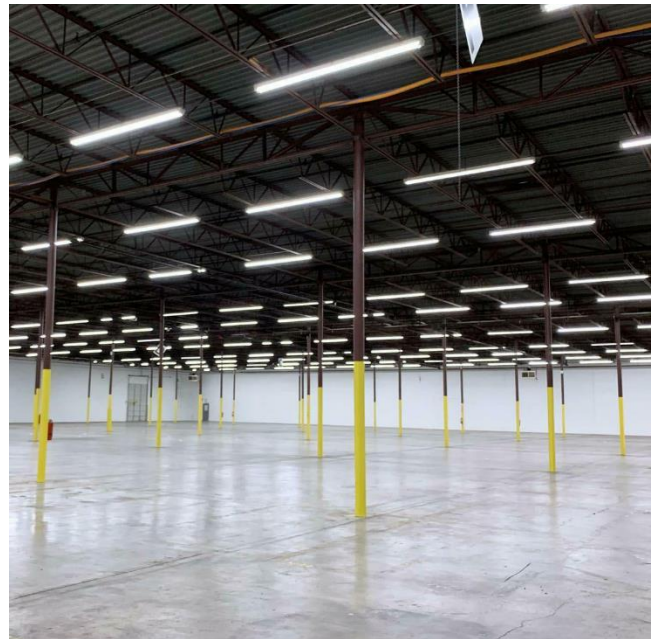

## Safety Precautions

To reduce the risk of death, personal injury or property damage from fire, electric shock, falling parts, cuts/abrasions, and other hazards read all warnings and instructions included with and on the fixture box and all fixture labels. Before installing, servicing, or performing routine maintenance upon this equipment, follow these general precautions. Commercial installation, service and maintenance of luminaires should be performed by a qualified licensed electrician.

For the installation: If you are unsure about the installation or maintenance of the luminaires, consult a qualified licensed electrician and check your local electrical code. To prevent wiring damage or abrasion, do not expose wiring to edges of sheet metal or other sharp objects. Do not make or alter any open holes in an enclosure of wiring or electrical components during kit installation.

### **WARNING: RISK OF FIRE OR ELECTRICAL SHOCK**

Turn off electrical power at fuse or circuit breaker box before wiring fixture to the power supply. Turn off the power when you perform any maintenance. Verify that supply voltage is correct by comparing it with the luminaire label information. Make all electrical and grounded connections in accordance with the National Electrical Code and any applicable local code requirements. All wiring connections should be capped with UL approved wire connectors.

### **CAUTION: RISK OF INJURY**

Avoid direct eye exposure to the light source while it is on.  
Account for small parts and destroy packing material, as these may be hazardous to children.

## Warranty

### 5 Years Warranty

This product is warranty to be free from defects in workmanship and materials for up to 5 Years from date of purchase. If it fails to do so, please contact Beyond LED technology at [sales@beyondledtechnology.com](mailto:sales@beyondledtechnology.com) or call 1(866) 786-1117 for instructions on replacement.

