

CABLE 234 RF: RP SMA STRAIGHT PLUG + RP SMA STRAIGHT BULKHEAD JACK W/O-RING RATED TO IP67/68 + MULTIPLE CABLE SIZES

SPECIFICATIONS :
 1. RP SMA STRAIGHT PLUG, P/N:
 FOR RG178 CABLE: RFCT-SMA017-M78.
 FOR ϕ 1.13MM CABLE: RFCT-SMA042-M13.
 FOR RG316 CABLE: RFCT-SMA017-M74.
 2. COAXIAL CABLE, SEE P/N FOR DETAIL.
 3. RP SMA STRAIGHT BULKHEAD JACK W/O-RING RATED TO IP67/68, P/N:
 FOR ϕ 1.13MM~RG178 CABLE: RFCT-SMA008-F78.
 FOR RG316 CABLE: RFCT-SMA008-F74.

USAGE PRECAUTIONS: CABLES USING 'MICRO' COAX ARE DELICATE:
 (i) HANDLE WITH CARE.
 (ii) DO NOT TWIST; APPLY EXCESSIVE FORCES OR SHARP BENDS TO THE CABLE. DO NOT FORCEFULLY DEFORM WIRES.
 (iii) CONSULT CONNECTOR MANUFACTURER'S DATASHEETS FOR DETAILED NOTES ON HANDLING INSTRUCTIONS.

ENVIRONMENTAL:
 A. BULKHEAD MOUNTED CONNECTOR (RFCT-SMA008-Fxx) TESTED TO THE FOLLOWING SPECIFICATION:
 i. IP6X - DUST TIGHT - NO PARTICLE INGRESS.
 ii. IPX7 WATERPROOF FOR 30 MINUTES UP TO 1 METER UNDERWATER.
 iii. IPX8 WATERPROOF FOR 48 HOURS AT 1 METER UNDERWATER.
 iv. IPX8 WATERPROOF FOR 12 HOURS AT 5 METERS UNDERWATER.
 v. PRESSURE TEST - 1 BAR FOR 10 SECONDS.

NOTES:
 1. WORKING FREQUENCY RANGE: DC-3GHz.
 2. OPERATING TEMPERATURE: -40°C~+125°C
 3. IMPEDANCE: 50 OHM.

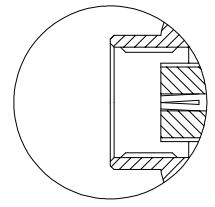
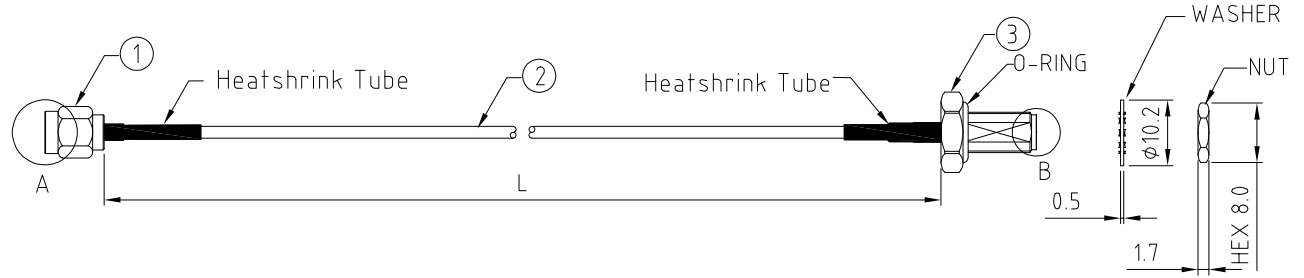

DETAIL A

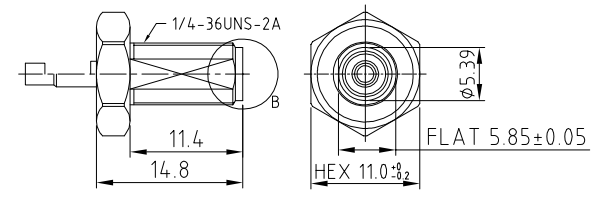

SMA JACK DETAIL DRAWING

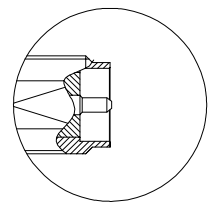

DETAIL B

HOW TO ORDER

CABLE 234 RF - X X X X - X - X

"L" LENGTH IN MM:
 eg: 100MM = 0100
 (MIN. 0050-MAX.2000)
 STANDARD = 0100, 0150, 0200)
 Tolerance: <50mm: ±2mm.
 51-200mm: ±5mm.
 201-500mm: ±7mm.
 >501mm: ±10mm.

CABLE SIZE OPTIONS:
 1 = RG178 CABLE, COLOR: BROWN.
 2 = ϕ 1.13MM CABLE, COLOR: GRAY.
 3 = RG316 CABLE, COLOR: BROWN.

WASHER AND NUT OPTIONS:
 BLANK = SEPARATELY PACKED (STANDARD)
 A = ALL ASSEMBLED WITH CONNECTOR

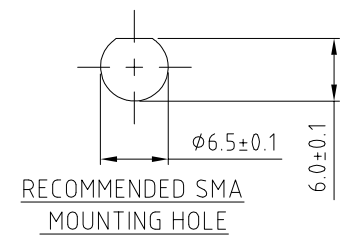

RECOMMENDED SMA MOUNTING HOLE

REV. DATE & DRN	10 26/05/16 - RJH RELEASE
11	20/02/17 - NYW ADD I35 CABLE OPTION
12	08/04/18 - NYW ADD 0150mm CABLE DETAIL DRAWING
13	27/05/19 - NYW ADD OPERATING TEMP.
14	02/09/21 - NYW ADD IMPEDANCE
15	19/07/22 - NYW ADD CABLE SIZE 3 OPTION AND OPERATING TEMP.

Scale: NTS	THIRD ANGLE	Unstated Tolerances:
Drawn: RJH		X N/A XX N/A XXX N/A ANGLES N/A
App'd: XXX	Title CABLE ASSEMBLY	
Date: 19 JAN. '22	Revision: 15	Unit: mm

		Type: Cable 234 RF
IP67/68 Rated Cables	www.gradconn.com	CABLE 234 RF
THIS DRAWING IS CONFIDENTIAL AND MUST NOT BE COPIED OR DISCLOSED WITHOUT WRITTEN CONSENT		Drawing Number:
		Sheet 1 of 1
		Drawing © E and O E