

RECOMMENDED PADS LAYOUT (TOP VIEW)

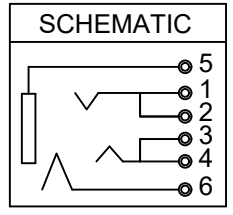
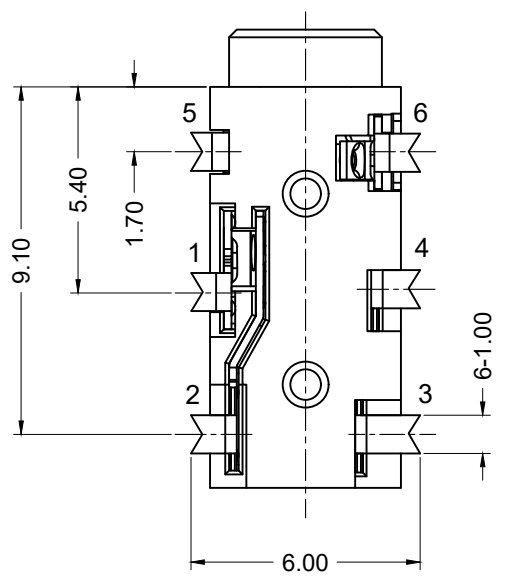

Material and Finish

Housing: High Temp Plastic
 Terminals: Copper Alloy,
 Gold Plated.

Electrical Characteristics

Contact Resistance:
 Before Test: 50 milliohms max.
 After Durability Test:
 100 milliohms max.

Insulation Resistance:
 100 Megohms min.
 at 250V DC

Dielectric Strength:
 250V AC RMS for 1 minute

Operating Temp:
 -25°C to +70°C

Durability Rating:
 10K Cycles

Insertion Force:
 0.4kg to 3.0kg.

Extraction Force:
 0.4kg to 3.0kg.

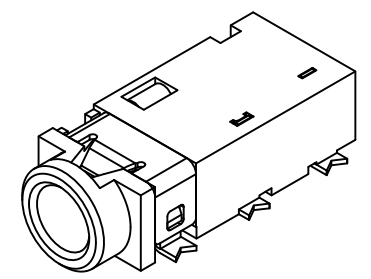

Tolerances	
X.X ± 0.35	
X.XX ± 0.25	
Unless Stated	Otherwise

REV.	DATE	DESCRIPTION	REV. BY	CHK. BY	DRAWN BY	DATE
A0	1/11/08	New Drawing	WILL H.	H. MA	WILL H.	1/010/08
A1	3/5/08	Release Drawing	H. MA	N/A		
A2	06/22/09	Add Durability Info.	S. Vien	H. MA		UNITS
A3	09/14/09	ECO #09-070	S. Vien	H. MA		mm
A4	01/09/12	Add Insertion Force	S. Vien	H. MA		
A5	08/14/18	Update Address	D.Shehan	N/A		

STX-25427-6N-TR

2.5mm Stereo Jack, SMT
 6 Pins, RoHS Compliant

