

A

P.C.B. LAYOUT

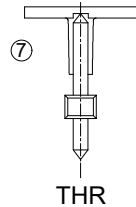
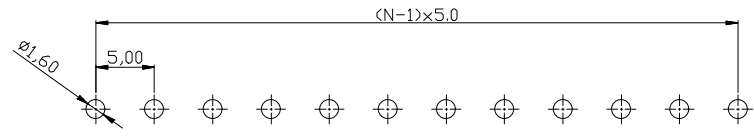

Material:
 Solid PIN: Brass(CuZn)
 Surface of solder tail: Matte Tin plated ④
 ⑦ Insulator(housing): THT: PA66,UL94V-0
 THR: PA46,UL94V-0

N = Number of contact

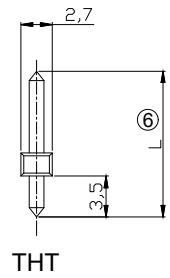
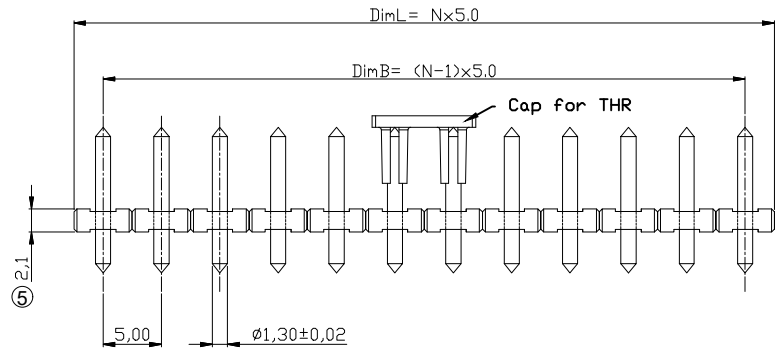

Electrical: UL
 Voltage rating: 300V
 Current rating: 10A
 Withstanding Voltage: 1.6KV
 ⑤ Operating temperature: -40°C to +105°C
 ⑦ Soldering temperature: THT: 250°C±10°C/5 Sec
 THR: 260°C±5°C/5 Sec

Safety Approval:

⑦ Order code: A-TB500-OPxx-xxx-xx

Pin count: 02~24
 Solder type: Blank:THT
 TR:THT with T&R packing
 Dim L: Blank:16.5mm
 175:17.5mm

Tolerance:

	Dim L	Dim B
2 -21p	±0.30	±0.30
22-24p	±0.40	±0.40

RoHS compliant
 Unit:mm

Scale	Free	⑦	Update and add P/N	20.09.2022	Daniel		Date	Name	Customer-No.
TOLERANCE		⑥	Add P/N	09.03.2022	Daniel	Drawn	07.12.2006	Hellwig	ASSMANN WSW-No. A-TB500-OPxx-xxx-xx
X	±0.50	⑤	Update the dimension	09.01.2018	Tom	Approved	20.09.2022	Daniel	
X.X	±0.30	④	Update the plating to Matte Tin	23.07.2014	Amy				
⑤ X.XX	±0.20	③	Update	29.07.2009	Dean				
DIM	TOL	②	Update technical data	28.07.2008	N.Schulz				
X°	±1°	Id.	Modification	Date	Name				
Angle	TOL								Replace

Drawing-No.
ASS 1157 CO

rev07

Sheet 1 / 1