

THIS DOCUMENT IS SUBJECT TO CHANGE WITHOUT NOTICE. IT IS CONFIDENTIAL AND A PROPERTY OF Amphenol LTW. DISCLOSURE TO THIRD PARTY HAS TO BE AUTHORIZED BY Amphenol LTW.

REV.	ECN NO.	DATE	SIGN	DESCRIPTION
A		2019/03/08	Allen Pan	
B	CI91680	2019/09/24	Vicky	Update Wire Tolerance
C	BOMR19110191	2019-11-27	Peng	$\triangle C$ X4

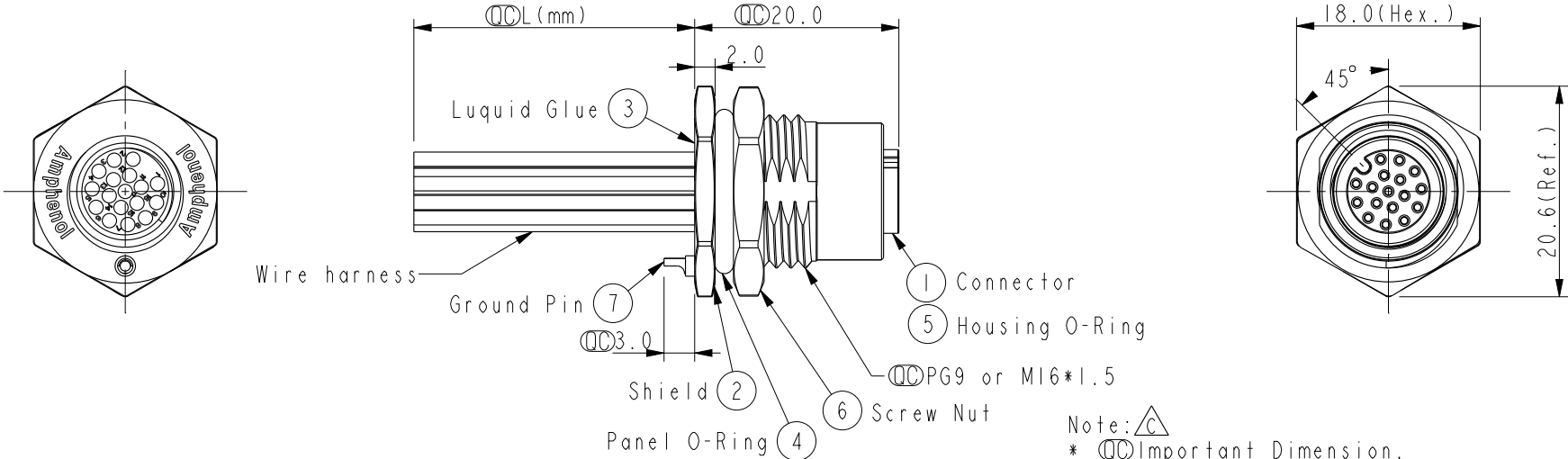

- Note: $\triangle C$
- * \circ Important Dimension.
 - * Waterproof Rate: IP68, IP69K.
 - * Connector: Nylon+GF, Black.
 - * Female Pin: Copper Alloy, Gold Plated.
 - * Shield: Zinc Alloy, Nickel Plated.
 - * Screw Nut: Zinc Alloy, Nickel Plated.
 - * Panel O-Ring: Viton, Black.
 - * Housing O-Ring: Viton, Green.
 - * Wire harness: UL1061
 - * Rated Voltage: 3 & 4Pin 250V dc. or ac.
5Pin 60V dc. or ac.
6~12Pin, 17Pin 30V dc. or ac.
 - * Rated Current: 3~5Pin 4A
6~8Pin 2A
10~12Pin, 17Pin 1.5A
 - * Operating Temperature: -25~85°C
 - * For Panel Thickness Max 4.5mm.
 - * Nut Torque: 4-6 Kgf.cm.
 - * Wire harness Tolerance: 150~300 ± 15 mm
301~1000 ± 20 mm
 $\triangle B$ Over 1000 +50/-0mm

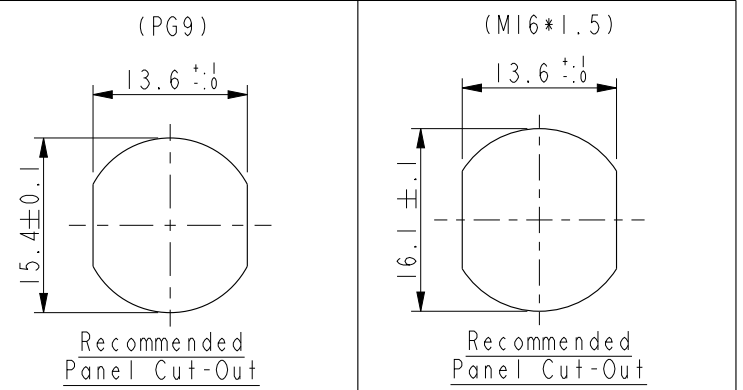

UNIT: mm		TITLE M12 A-Code Female Conn. Panel Front With Wire harness Shielded
TOLERANCE .X ± 0.25 .XX ± 0.1 .XXX ± 0.05 ANGLES $\pm 1^\circ$	SCALE 3:2	SIZE A4
	REV. C	SHEET 1 OF 2
	WC-REV. A.3	\circ Inspection item

Amphenol LTW
安費諾亮泰企業股份有限公司

ITEM NO.	DRAWN BY Vicky	DATE 2019-09-24
DWG NO. MSAS-XXPFFX-SF8XXX	CHECKED BY Rita	DATE 2019-09-24
CUSTOMER ALTW	APPROVED BY Max	DATE 2019-09-24



Contacts	Wire harness	AWG	Item No.
17P	UL1061	26	MSAS-17PFFC-SF8CXX
12P			MSAS-12PFFS-SF8CXX
10P			MSAS-10PFFS-SF8CXX
8P		24	MSAS-08PFFS-SF8CXX
6P			MSAS-06PFFS-SF8CXX
5P			MSAS-05PFFC-SF8CXX
4P		22	MSAS-04PFFC-SF8CXX
3P			MSAS-03PFFC-SF8CXX
17P			MSAS-17PFFC-SF8BXX
12P		26	MSAS-12PFFS-SF8BXX
10P			MSAS-10PFFS-SF8BXX
8P			MSAS-08PFFS-SF8BXX
6P		24	MSAS-06PFFS-SF8BXX
5P			MSAS-05PFFC-SF8BXX
4P			MSAS-04PFFC-SF8BXX
3P		22	MSAS-03PFFC-SF8BXX

Pin #	Wire	Pin #	Wire	Pin #	Wire	Pin #	Wire	Pin #	Wire	Pin #	Wire	Pin #	Wire	Pin #	Wire
5	--	5	--	5	Gray	5	Gray	5	Gray	5	Gray	5	Gray	5	Gray
4	Black	4	Black	4	Black	4	Black	4	Black	4	Black	4	Black	4	Black
3	Blue	3	Blue	3	Blue	3	Blue	3	Blue	3	Blue	3	Blue	3	Blue
2	--	2	White	2	White	2	White	2	White	2	White	2	White	2	White
1	Brown	1	Brown	1	Brown	1	Brown	1	Brown	1	Brown	1	Brown	1	Brown

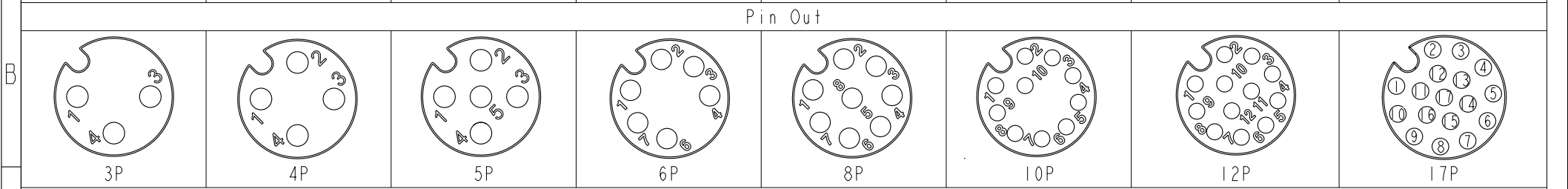

Pin Assignments Front View

UNIT: mm TOLERANCE .X ±0.25 .XX ±0.1 .XXX ±0.05 ANGLES ±1°		TITLE M12 A-Code Female Conn. Panel Front With Wire harness Shielded	Amphenol LTW 安費諾亮泰企業股份有限公司	ITEM NO MSAS-XXPFFX-SF8XXX	DRAWN BY Vicky	DATE 2019-09-24
		SCALE 3:2 SIZE A4 SHEET 2 OF 2		DWG NO MSAS-XXPFFX-SF8XXX	CHECKED BY Rita	DATE 2019-09-24
		REV. C WC-REV. A.3 Inspection item		CUSTOMER ALTW	APPROVED BY Max	DATE 2019-09-24