

MUO 2.5 Termination Connector

molex[®]

The MUO 2.5 termination connector replaces closed-end (CE) terminals efficiently as a grounding solution. It reduces harness assembly lead time and improves reliability and processing at OEM and cable assembly houses.

Features and Benefits

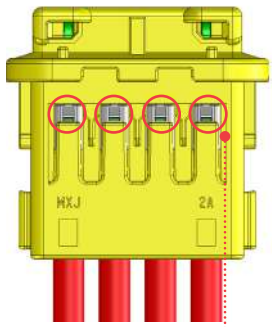

Finger Protection

Terminal lance is exposed, a potential electrical hazard. Retainers cover this area and prevent potential hazard.

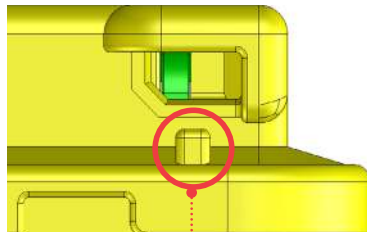

Tangle Prevention

Wire entanglement prevention feature.



MUO 2.5 Termination Connector 8 Circuits
MUO 2.5 Termination Connector shown with separated wire retainers

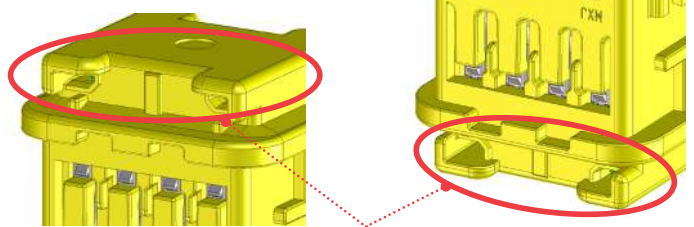

Simple Water Exhaust Function

Prevents water from permeating inside of the housing

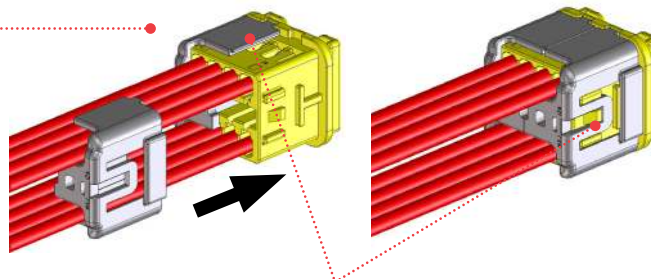

Two Separated Retainers

2 separated retainers protect cables and secure the terminal position. Also, electrical shock hazard is removed.

Applications

General Home Appliance

- Shower
- Toilet
- Hair Dryer
- Washing Machine
- Refrigerator

HVAC Equipment

- Water Heater
- Fan Heater
- Floor Heating System
- Air Conditioner



Water Heater



Refrigerator



Hair Dryer

MUO 2.5 Termination Connector



Specifications

REFERENCE INFORMATION

Packaging: Poly Bag
Terminal Used: Copper Alloy, Tin Plating
Designed In: Millimeters
RoHS: Compliant
Glow Wire Compliant: No

ELECTRICAL

Voltage (max.): 250V (AC/DC)
Current (max.): 6.0A (Refer to below table)
Contact Resistance: 20 milliohms MAX.
Insulation O.D.: $\phi 0.85 \sim \phi 2.00$ mm

PHYSICAL

Housing: PA66
Contact: Copper Alloy
Plating: Tin (overall)
Operating Temperature: -40 to +105°C

MECHANICAL

Contact Insertion Force: 9.8N MAX
Contact Retention to Housing: 9.8N MIN

Allowable Current (MAX.)	Applicable Wire	Allowable Current	Applicable Receptacle
	AWG #20	6.0A	505597-9*00
	SHKV0.5	5.5A	
	AWG #22	5.0A	505597-9*00
			56134-9*00
	SHKV0.3	4.5A	59370-8*00
	AWG #24	4.0A	56134-9*00
	AWG #26	3.5A	59370-8*00
	AWG #28	3.0A	

Ordering Information

Series No.	Component	Circuit Size	Applicable Wire
505594	Retainer	2, 4	-
505596	Header Housing	4, 6, 8	AWG #20, #22, #24, #26, #28 SHKV 0.5, SHKV 0.3
505597	Receptacle Terminal	-	SHKV 0.5
56134	Receptacle Terminal	-	SHKV 0.3
59370	Receptacle Terminal	-	SHKV 0.3

www.molex.com/link/muo25.html