

THIS DRAWING IS UNPUBLISHED. RELEASED FOR PUBLICATION .19
 © COPYRIGHT 19 BY AMP INCORPORATED. ALL INTERNATIONAL RIGHTS RESERVED.

LOC	DIST	P	F	ZONE	LTR	DESCRIPTION	DATE	APPD
AJ	16				O	RLSE -1 PER 92-3137-017	8-18-92	JL
					A	REV PER 0130-0153-92	1-20-93	JL
					B	REV PER 0130-0275-93	5-14-93	JL

- ① ZINC PER QQ-Z-363.
- ② PTFE PER MIL-P-19468.
- ③ PHOSPHOR BRONZE PER QQ-B-750.
- ④ TIN-LEAD PLATE PER ASTM-B-545, 3.04 μm [.000120] MINIMUM THICK.
- ⑤ GOLD PLATE PER MIL-G-45204, 0.76 μm [.000030] MINIMUM THICK.
- 6. SEE INSTRUCTION SHEET 408-9889.

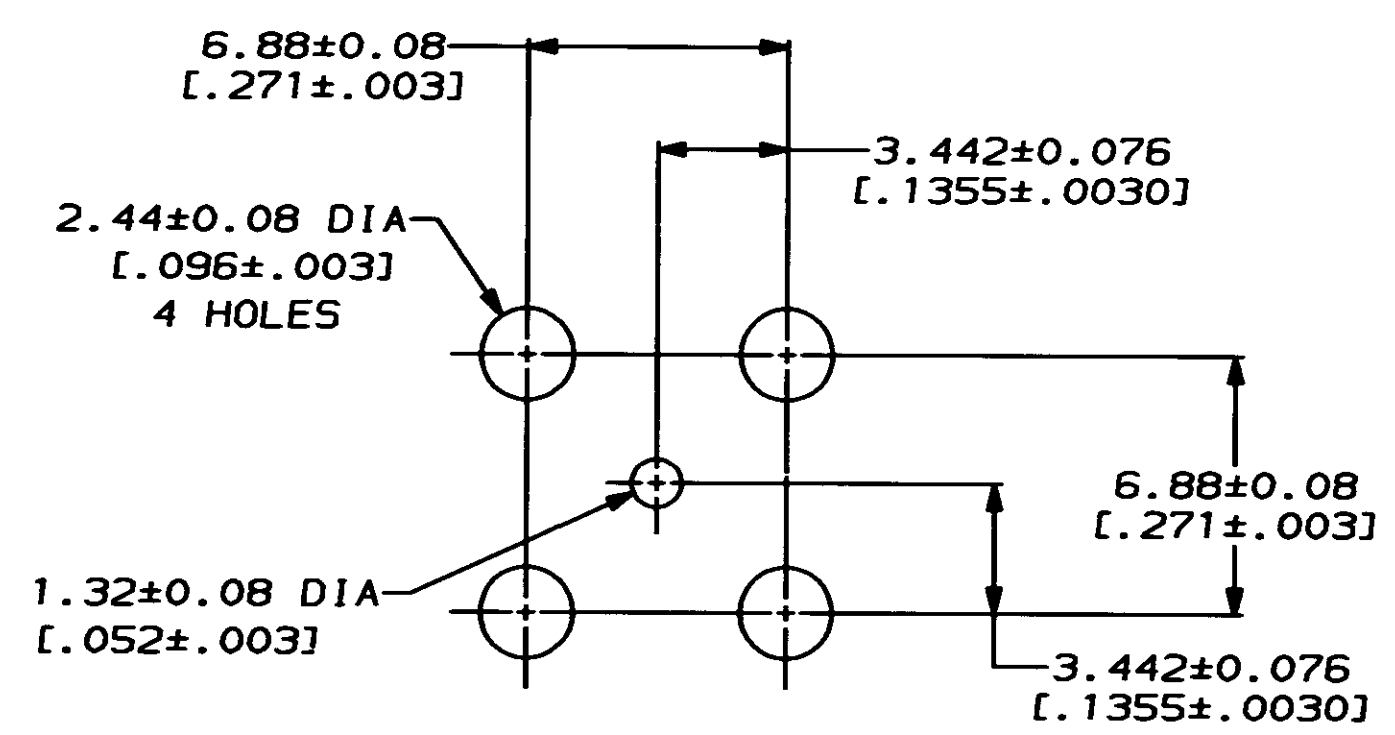
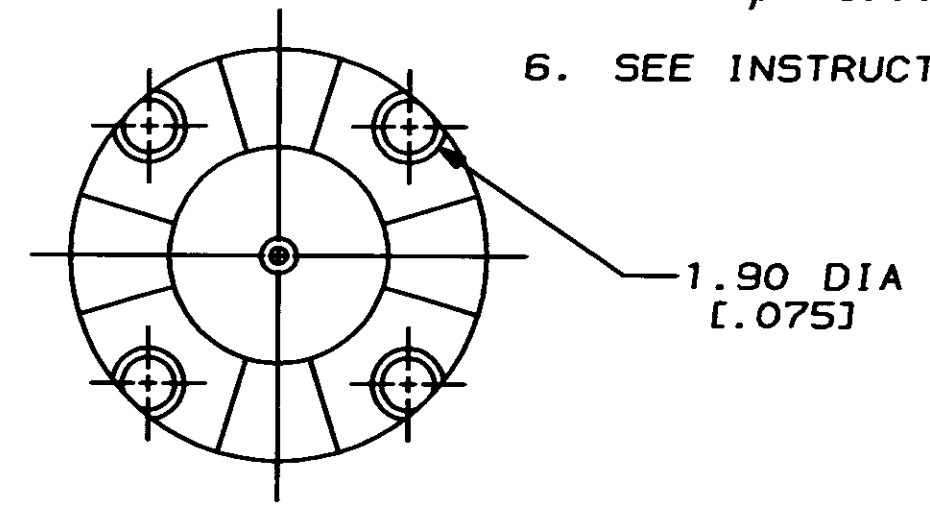
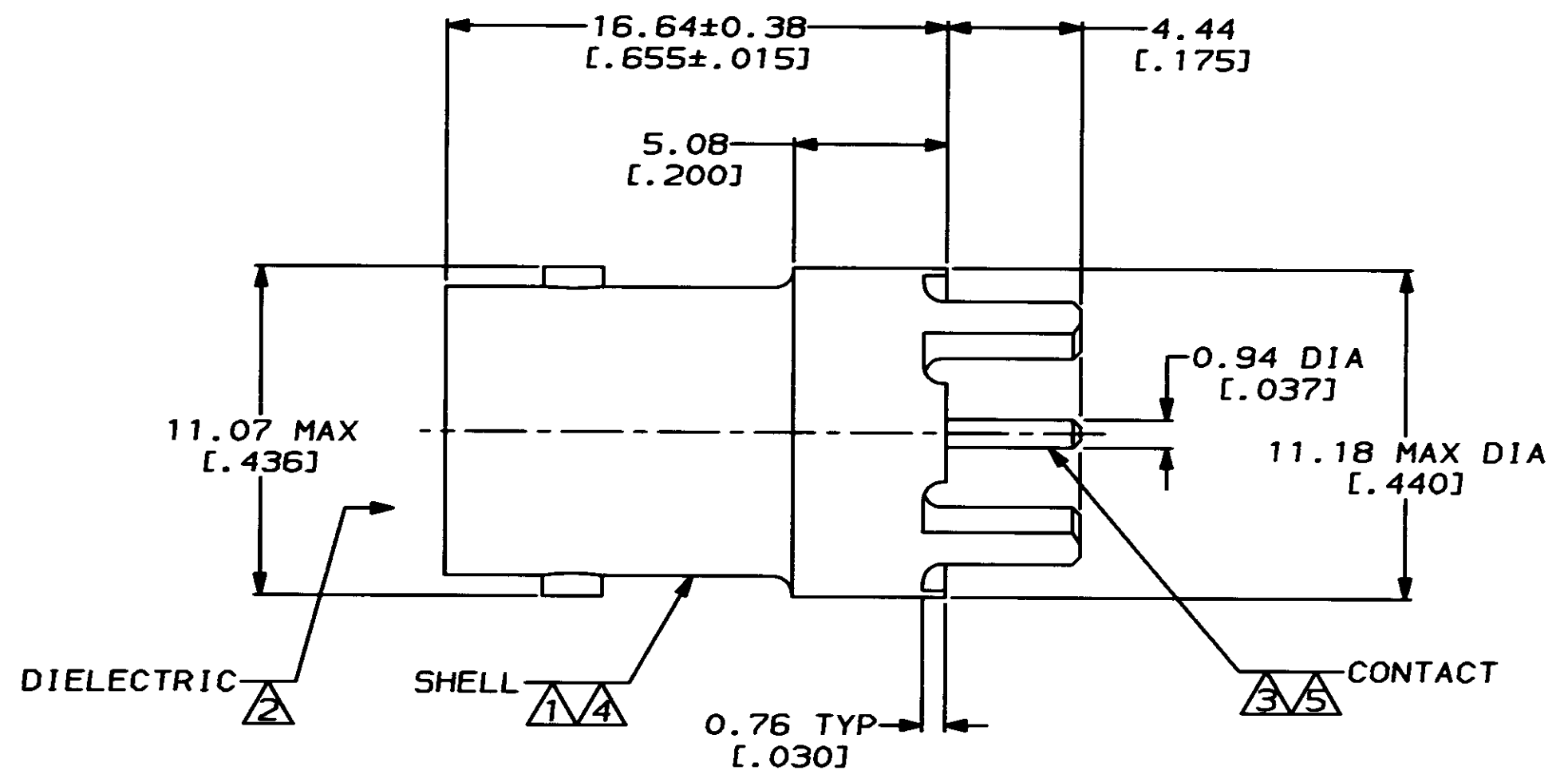

SUGGESTED PCB CONFIGURATION

THIS DRAWING IS A CONTROLLED DOCUMENT FOR AMP INCORPORATED. IT IS SUBJECT TO CHANGE AND THE CONTROLLING ENGINEERING ORGANIZATION SHOULD BE CONTACTED FOR THE LATEST REVISION.

DO NOT SCALE PRINT. UNLESS SPECIFIED DIMENSIONS IN mm [INCHES] TOLERANCES ON: 2 PLC DEC ± 0.20 [.008] 3 PLC DEC ± - ANGLES ± -		DR 8-18-92 J. LIPPERT		414394-1 PART NO	
MATERIAL SEE NOTES 1 THRU 3		CHK 8-27-92 A. GABANY		AMP AMP Incorporated Harrisburg, PA 17105-3608	
FINISH SEE NOTES 4 & 5		APPD 8-27-92 A. GABANY		NAME JACK, VERTICAL, 75 OHM, PCB, BNC	
APPLICATION SPEC		APPD 8-27-92 J. LIPPERT		SIZE CAGE CODE DRAWING NO C 00779 C-414394	
WEIGHT -		PRODUCT SPEC -		SCALE 5:1 SHEET 1 OF 1	