

H
G
F
E
D
C
B
A

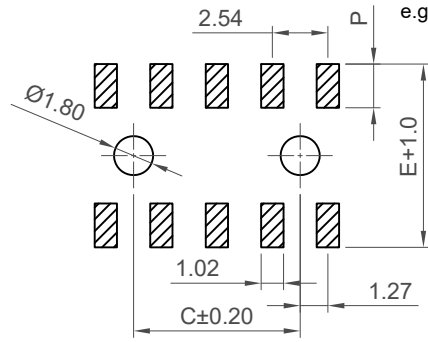

Note: $P=(E+1-2)/2$
e.g.: $E=7.37\text{mm}$, $P=3.185\text{mm}$

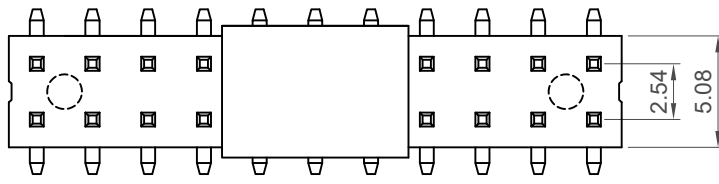
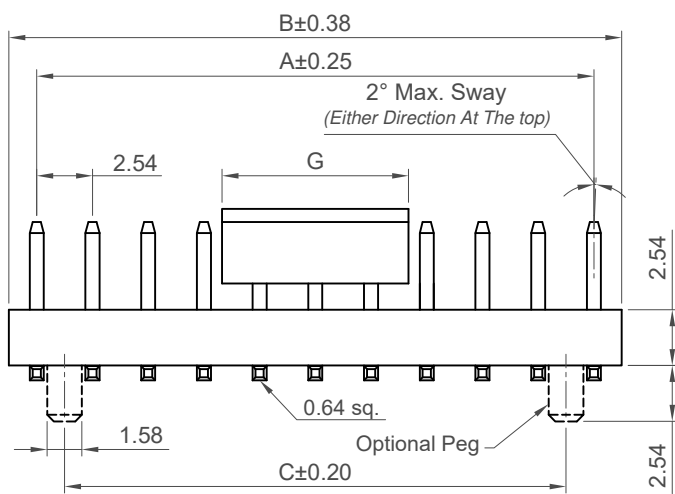
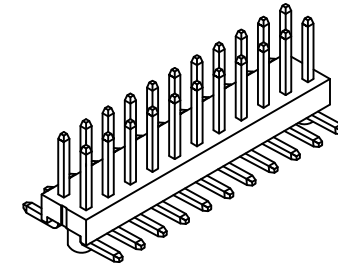

Recommended PCB Layout

▨ Solder Area

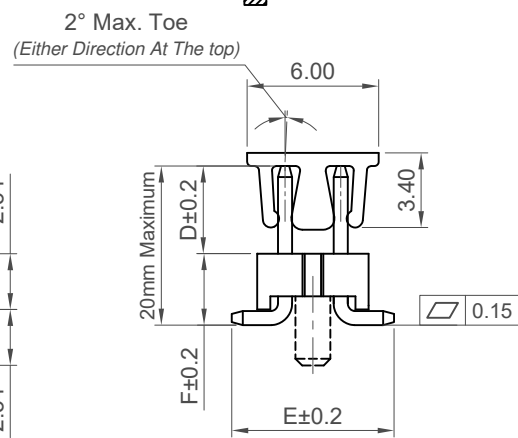

Specifications

Material
Insulator:
Standard: Polymer, LCP, UL94V-0
Option: Polyamide, Nylon 6T, UL94V-0
Contact: Copper Alloy

Plating
Contact: See Ordering Grid

Electrical
Current Rating: 3 Amp Per Pin
Contact Resistance: 20 mΩ max.
Insulation Resistance: 1000 MΩ min.
Dielectric Withstand Voltage: 600 V AC

Mechanical & Environmental
Operating Temperature: -40°C to +105°C
Soldering Process
LCP (Standard)
IR Reflow: 260°C for 10 sec.
Wave: 250°C for 5-10 sec.
Manual Solder: 350°C for 3-5 sec.
Nylon 6T (Option)
IR Reflow: 260°C for 10 sec.
Wave: 230°C for 5-10 sec.
Manual Solder: 350°C for 3-5sec.

Mates with (Subject to Pin Length)

- BG120 BG121 BG140 BG150 BG151
 - BG152 BG160 BG165 BG166 BG170
 - BG175 BG180 BG185 BG190 BG195
 - BG200 BG210 BG220 BG225
- BG121 Recommended mating length 3.00mm
BG166 Recommended mating length 3.00mm

| Number of Contacts | Dimensions | | | |
|--------------------|------------|--------|-------|------|
| | A | B | C | G |
| 4 | 2.54 | 5.08 | - | 5.00 |
| 6 | 5.08 | 7.62 | 2.54 | 6.00 |
| 8 | 7.62 | 10.16 | 5.08 | |
| 10 | 10.16 | 12.70 | 7.62 | |
| 12 | 12.70 | 15.24 | 10.16 | |
| 14 | 15.24 | 17.78 | 12.70 | |
| 16 | 17.78 | 20.32 | 15.24 | |
| 18 | 20.32 | 22.86 | 17.78 | 8.50 |
| 20 | 22.86 | 25.40 | 20.32 | |
| 22 | 25.40 | 27.94 | 22.86 | |
| 24 | 27.94 | 30.48 | 25.40 | |
| 26 | 30.48 | 33.02 | 27.94 | |
| 28 | 33.02 | 35.56 | 30.48 | |
| 30 | 35.56 | 38.10 | 33.02 | |
| 32 | 38.10 | 40.64 | 35.56 | |
| 34 | 40.64 | 43.18 | 38.10 | |
| 36 | 43.18 | 45.72 | 40.64 | |
| 38 | 45.72 | 48.26 | 43.18 | |
| 40 | 48.26 | 50.80 | 45.72 | |
| 42 | 50.80 | 53.34 | 48.26 | |
| 44 | 53.34 | 55.88 | 50.80 | |
| 46 | 55.88 | 58.42 | 53.34 | |
| 48 | 58.42 | 60.96 | 55.88 | |
| 50 | 60.96 | 63.50 | 58.42 | |
| 52 | 63.50 | 66.04 | 60.96 | |
| 54 | 66.04 | 68.58 | 63.50 | |
| 56 | 68.58 | 71.12 | 66.04 | |
| 58 | 71.12 | 73.66 | 68.58 | |
| 60 | 73.66 | 76.20 | 71.12 | |
| 62 | 76.20 | 78.74 | 73.66 | |
| 64 | 78.74 | 81.28 | 76.20 | |
| 66 | 81.28 | 83.82 | 78.74 | |
| 68 | 83.82 | 86.36 | 81.28 | |
| 70 | 86.36 | 88.90 | 83.82 | |
| 72 | 88.90 | 91.44 | 86.36 | |
| 74 | 91.44 | 93.98 | 88.90 | |
| 76 | 93.98 | 96.52 | 91.44 | |
| 78 | 96.52 | 99.06 | 93.98 | |
| 80 | 99.06 | 101.60 | 96.52 | |

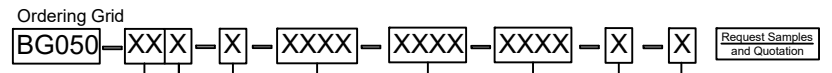

No. of Contacts
04 to 80

Contact Plating
A = Gold Flash All Over (Standard)
B = Selective Gold Flash Contact Area / Tin On Tail
C = Tin All Over
G = 10µ" Gold Contact Area/Tin On Tail
I = 30µ" Gold Contact Area/Tin On Tail

Locating Peg
0 = Without
1 = With

Packing Options
B = Tape and Reel with Cap (Standard)
D = Tube
E = Tube with Cap
Insulator Material
L = LCP (Standard)
N = Nylon 6T

Dimension F (1/100mm) (PCB to Top of Insulator)
0350 = 3.50mm (Standard)
Or specify custom length
eg 0320 = 3.20mm (Minimum)

Dimension E (1/100mm) (Footprint Width)
0737 = 7.37mm (Standard)
Or specify custom footprint width
eg 1000 = 10.00mm (minimum 7.37mm)
(Tooling charge may be apply)

Dimension D (1/100mm) (Post Height)
0300 = 3.00mm (Standard)
0450 = 4.50mm (Standard)
0650 = 6.50mm (Standard)
Or specify custom post height
eg 0550 = 5.50mm
(Maximum 1500=15.00mm)
(Minimum 0100=1.00mm)

| | | | |
|--------------|----------------|---|----------------------|
| Part Number | | Product Description | |
| BG050 | | 2.54mm Pitch Pin Header, Dual Row, Surface Mount, Vertical | |
| Drawing Date | | 23rd December 2014 | |
| By | CC | Tolerances (Except as Noted) | Units: |
| Detail | BG050 E PCN | Length X. ± 0.30 XX ± 0.20 X.XX ± 0.15 X.XXX ± 0.10 | Metric (mm) |
| Revision | E6 | Angle | 3rd Angle Projection |
| Date | 30/06/21 | | |



This drawing is confidential and copyright of Global Connector Technology, Ltd (GCT).
This drawing must not be copied or disclosed without written consent. E & OE



| | | |
|--------------|--------------|---------------|
| Not to Scale | Drawn By LYH | Sheet No. 1/1 |
|--------------|--------------|---------------|