

# Crocodile Clip, Flanged, Fully Insulated

## Features

- UL/CSA Compliant
- Accepts All Standard 4mm Test Lead Plugs
- Offset Jaw & Special Tooth Design Grips Small and Large Diameter Test Points Securely



NTE Type No.	Color	Diag No.
72-053	Black	TL-010
72-054	Red	TL-010
72-054-KIT	Contains 1 ea. of 72-053 & 72-054	

TL-010

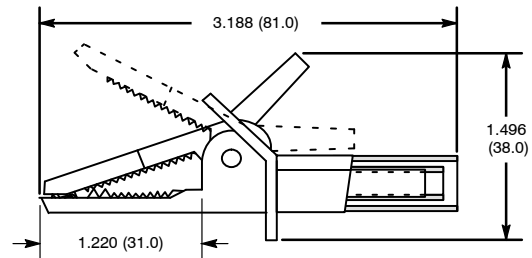

## Specifications

IEC 1010 Rating: 1000V CAT2 / 600V CAT3  20 Amps  
 Maximum Jaw Opening: .945" (24mm)

# Crocodile Clip, Small, Fully Insulated

## Features

- Accepts All Standard 4mm Test Lead Plugs
- Small Size is Ideal for Connecting to Confined Test Points



NTE Type No.	Color	Diag No.
72-055	Black	TL-011
72-056	Red	TL-011
72-056-KIT	Contains 1 ea. of 72-055 & 72-056	

TL-011

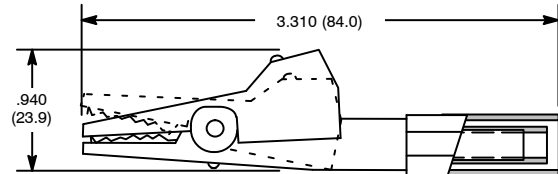

## Specifications

Rating: 1000V CAT2, 20 Amps  
 Maximum Jaw Opening: .275" (7mm)

# Crocodile Clip, Large, Fully Insulated

## Features

- UL/CSA Compliant
- Accepts All Standard 4mm Test Lead Plugs
- Wide Jaw Opening & Special Tooth Design Assures Firm Grip and Electrical Contact

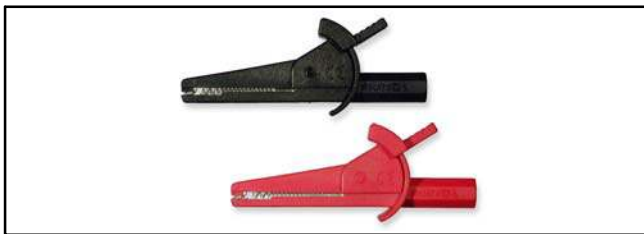

NTE Type No.	Color	Diag No.
72-057	Black	TL-012
72-058	Red	TL-012
72-058-KIT	Contains 1 ea. of 72-057 & 72-058	

TL-012

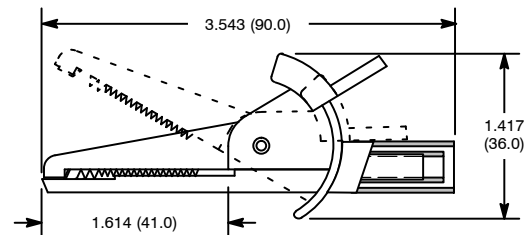

## Specifications

IEC 1010 Rating: 1000V CAT3 / 600V CAT4  30 Amps  
 Maximum Jaw Opening: .866" (22mm)