



**ANATECH ELECTRONICS INC**  
RF & Microwave Filters & Products

# 1910 MHz Connectorized Ceramic Band Pass Filter

**Part Number: AM1910B1684-C**



## Electrical Specifications

**Center:** 1910 MHz  
**Bandwidth:** 20 MHz  
**Insertion Loss:** 3.0 dB Max  
**Ripple in BW:** 0.5 dB Max  
**Return Loss:** 15 dB Min  
**Attenuation:** >40 dB @ 1810 MHz  
>38 dB @ 2010 MHz  
**In/Out Impedance:** 50  $\Omega$   
**Input Power:** 30 dBm Max

## Mechanical

**Connector Type:** SMA (F)  
**Dimensions:** 35 x 33 x 11.5 mm

## Environmental

**Operating Temperature:** -40 to +85° C  
**Storage Temperature:** -50 to +95° C  
**Shock:** 20 G. 11 ms  
**Vibration:** 20 G. 5 to 200 MHz

This product is RoHS compliant.

## Outline Drawing:

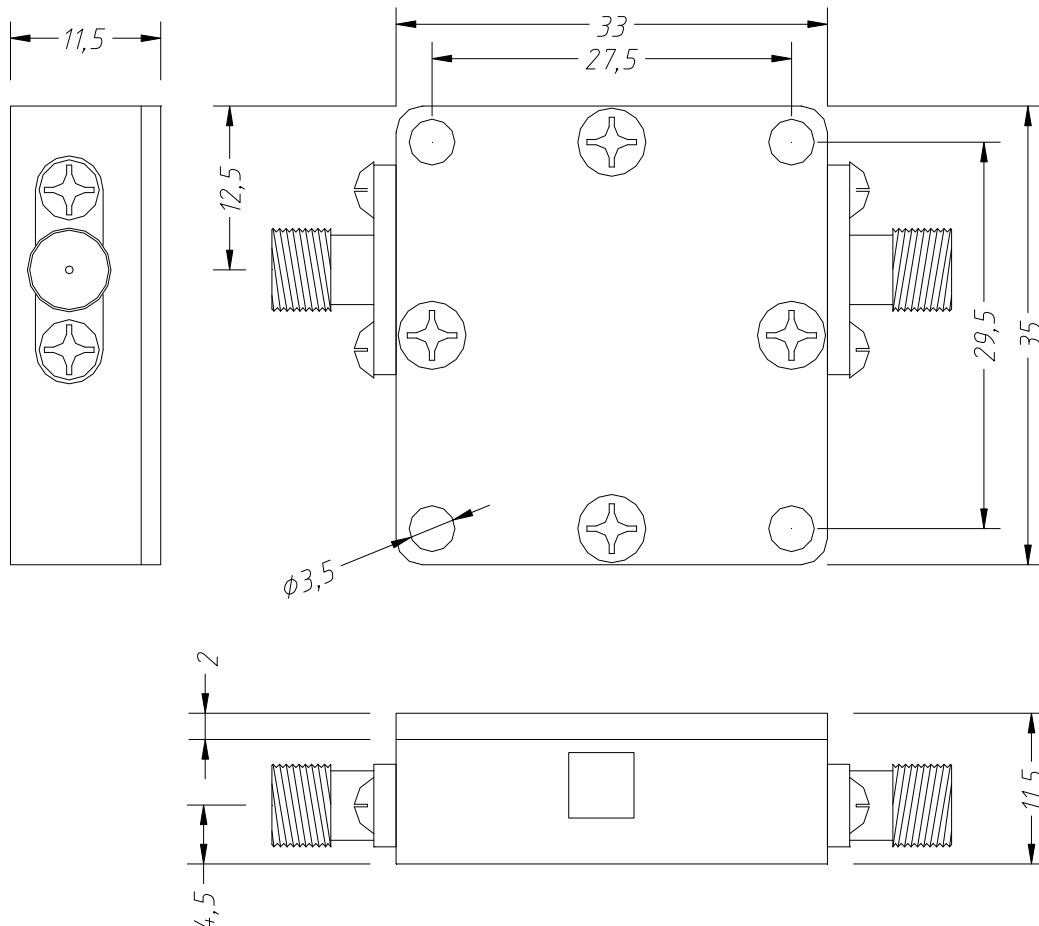

UNIT :mm

Tolerance : +/- 0.2