



Electrical specifications

Center Frequency: 1555 MHz
Bandwidth: 30 MHz
Passband: 1540-1570 MHz
Insertion Loss: 2.5 dB Max
Ripple: 0.5 dB Max
Return Loss: 12.0 dB Min
Attenuation 1: 30 dB @ 1000 MHz
Attenuation 2: 30 dB @ 1626 MHz
Input/Output Impedance: 50 Ω
Power: 1 W

Mechanical

Mounting Method: SMT
Dimensions: 8.6 x 7.3 x 3.8 mm

Environmental

Operating Temperature: -35 to +85° C

Outline Drawing:

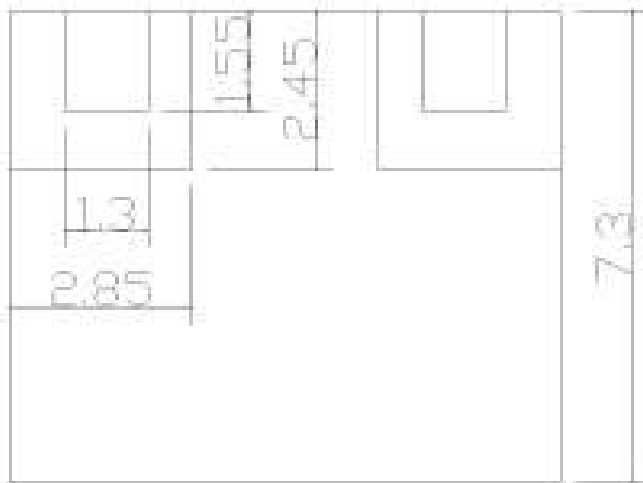

* NOTE *

Tolerance : $\pm 0.2\text{mm}$