

RECOMMENDED PCB LAYOUT (TOP)

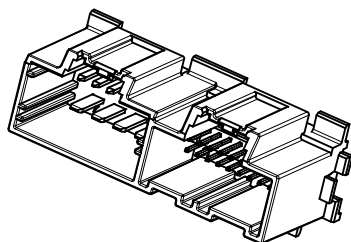

FRONT ISO VIEW

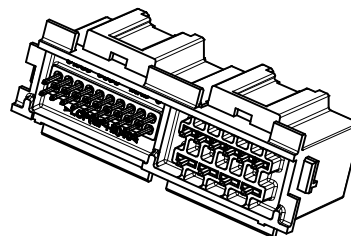

BACK ISO VIEW

NOTES:

1. MATERIALS: HOUSING - LCP, 40% GLASS, MINERAL FILLED, COLOR BLACK.  
TERMINALS - C26000 BRASS, H03 TEMPER  
MAX REGRIND: 50%
2. DRAWING TO BE INTERPRETED ACCORDING TO ANSI Y14.5M-1994.
3. PLATING: 0.64MM PINS - 150 TO 250 MICROMETERS TIN  
OVERALL OVER 125 TO 2.25 MICROMETERS NICKEL OVERALL.  
150 & 2.80 BLADES - 250 TO 4.00 MICROMETERS TIN  
OVERALL OVER 125 TO 2.25 MICROMETERS NICKEL OVERALL.
4. TRACEABILITY MARK TO BE IN AREA SHOWN, MARK IS CODED AS FOLLOWS:  
- 1ST THRU 4TH DIGITS = ASSY, P/N SUFFIX (EXAMPLE: 31359-8001 = "8001"  
- 5TH THRU 7TH DIGITS = JULIAN DATE (EXAMPLE: FEB 3RD = "034")  
- 8TH DIGIT = CALANDER YEAR MANUFACTURED (EXAMPLE: 2004 = "4")  
- 9TH THRU 10TH DIGITS = HOUR OF THE DAY  
TEXT HEIGHT SHALL BE 15 MINIMUM AND LEGIBLE.  
(ACCEPTABLE IF TEXT IS READABLE BY HOLDING ASSY AT AN ANGLE TO LIGHT)
5. PACKAGING: SEE CHART.
6. PIN DIMENSIONS INCLUDE PLATING.
7. PART MUST BE FREE FROM LUBRICANTS, SOLVENTS, AND OTHER IMPURITIES THAT MAY OCCUR DURING PROCESSING.
8. NO SILICONE RELEASE COMPOUND SHALL BE USED DURING PROCESSING OF THIS PART.
9. PART SHALL BE FREE OF FLASH, WARP, SINK, OCCLUSIONS, TOOL MARKS, OR OTHER IMPERFECTIONS DETRIMENTAL TO FIT, OR FUNCTION.
10. MOLDED PARTS MARKINGS SHALL BE 15MM MIN HEIGHT AND LEGIBLE.
11. HOLD DOWN AND EJECTOR PIN MARKS SHALL BE FLUSH TO 0.2 BELOW PART SURFACE.
12. PLASTIC IDENTIFICATION MARKS SHALL BE PER ISO11469.
13. MATES WITH CONNECTOR ASSEMBLIES FROM FOLLOWING DRAWINGS:  
10 WAY: SD-31372-900  
20 WAY: SD-31408-900
14. PART MUST CONFORM TO 'HEADER PIN RETENTION' SPECIFICATION OF:  
- 64MM PIN = 12 N MIN  
- 15MM BLADE = 7 N MIN  
- 2.8MM BLADE = 14 N MIN

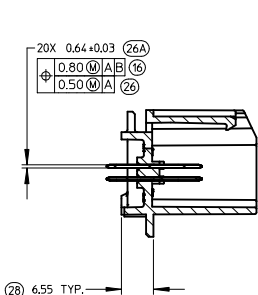

SECTION B-B

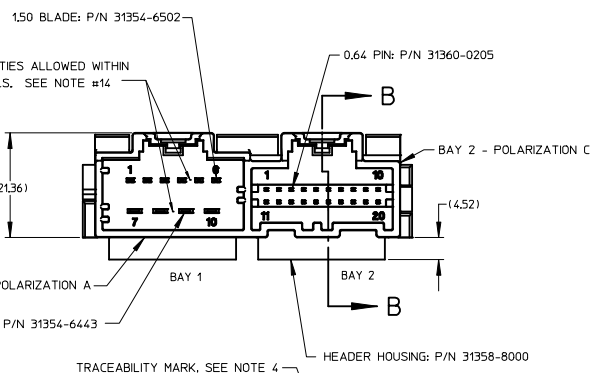
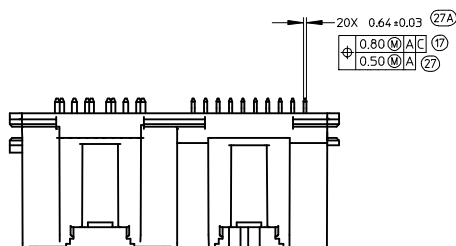

TRACEABILITY MARK, SEE NOTE 4

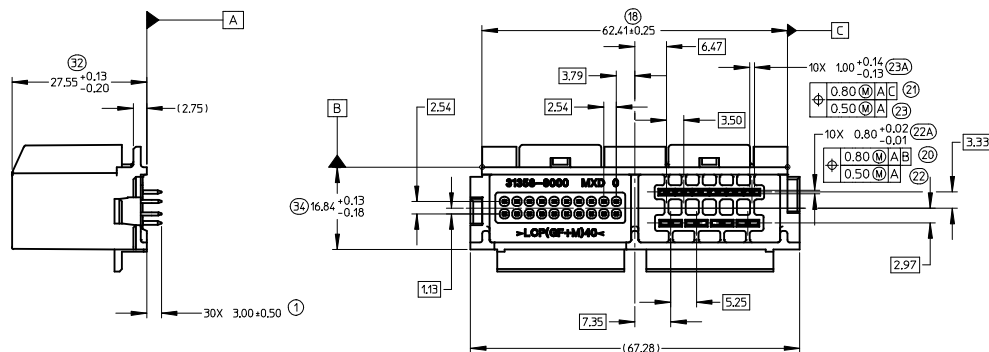

PART NUMBER	PACKAGING SPECIFICATION (DESCRIPTION)
31359-8000	PK-31300-332 (TUBE)
31359-8001	PK-31300-408 (TRAY)

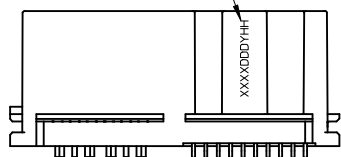

EC NO: UAU2013-0100 DRWN: JFISCHERO 2012/07/18 CHKD: APPR: SMARCEAU 2012/07/19	QUALITY SYMBOLS -0 -0	GENERAL TOLERANCES (UNLESS SPECIFIED) .mm INCH		SCALE 2:1 DESIGN UNITS METRIC	THIRD ANGLE PROJECTION REVISE ON CAD ONLY
		4 PLACES ±.013 ±.0005 3 PLACES ±.013 ±.0005 2 PLACES ±.013 ±.0005 1 PLACE ±.025 ±.001		DIMENSION STYLE MM ONLY	TITLE 10X20 VERTICAL HYBRID LCP SALES HEADER ASSY.
		DRAFT WHERE APPLICABLE MUST REMAIN WITHIN DIMENSIONS		DRAWN BY SKAROLEWI 2006/01/19 CHECKED BY GMEYER 2006/01/31 APPROVED BY PBERG 2006/01/31	SHEET NO. 1 OF 1
		MOLEX INCORPORATED MATERIAL NO. SEE CHART DOCUMENT NO. SD-31359-800		THIS DRAWING CONTAINS INFORMATION THAT IS PROPRIETARY TO MOLEX INCORPORATED AND SHOULD NOT BE USED WITHOUT WRITTEN PERMISSION	

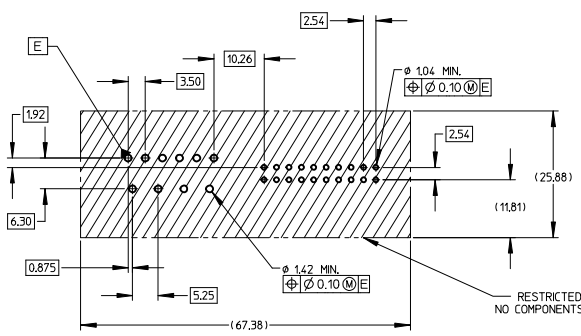

RECOMMENDED PCB LAYOUT (TOP)

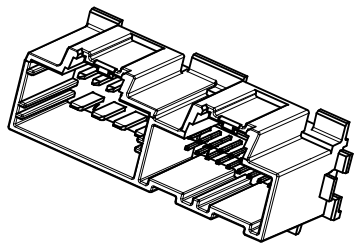

FRONT ISO VIEW

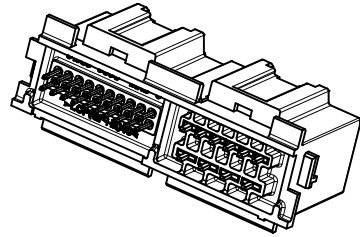

BACK ISO VIEW

- NOTES:
1. MATERIALS: HOUSING - LCP, 40% GLASS, MINERAL FILLED, COLOR BLACK. TERMINALS - C26000 BRASS, H03 TEMPER. MAX REGRIND: 50%
  2. DRAWING TO BE INTERPRETED ACCORDING TO ANSI Y14.5M-1994.
  3. PLATING: 0.64MM PINS - 150 TO 250 MICROMETERS TIN. OVERALL OVER 125 TO 2.25 MICROMETERS NICKEL OVERALL. 150 & 2.80 BLADES - 250 TO 4.00 MICROMETERS TIN. OVERALL OVER 125 TO 2.25 MICROMETERS NICKEL OVERALL.
  4. TRACEABILITY MARK TO BE IN AREA SHOWN, MARK IS CODED AS FOLLOWS:
    - 1ST THRU 4TH DIGITS = ASSY, P/N SUFFIX (EXAMPLE: 31359-8001 = "8001")
    - 5TH THRU 7TH DIGITS = JULIAN DATE (EXAMPLE: FEB 3RD = "034")
    - 8TH DIGIT = CALANDER YEAR MANUFACTURED (EXAMPLE: 2004 = "4")
    - 9TH THRU 10TH DIGITS = HOUR OF THE DAY
 TEXT HEIGHT SHALL BE 15 MINIMUM AND LEGIBLE. (ACCEPTABLE IF TEXT IS READABLE BY HOLDING ASSY AT AN ANGLE TO LIGHT)
  5. PACKAGING: SEE CHART.
  6. PIN DIMENSIONS INCLUDE PLATING.
  7. PART MUST BE FREE FROM LUBRICANTS, SOLVENTS, AND OTHER IMPURITIES THAT MAY OCCUR DURING PROCESSING.
  8. NO SILICONE RELEASE COMPOUND SHALL BE USED DURING PROCESSING OF THIS PART.
  9. PART SHALL BE FREE OF FLASH, WARP, SINK, OCCLUSIONS, TOOL MARKS, OR OTHER IMPERFECTIONS DETRIMENTAL TO FIT, OR FUNCTION.
  10. MOLDED PARTS MARKINGS SHALL BE 15MM MIN HEIGHT AND LEGIBLE.
  11. HOLD DOWN AND EJECTOR PIN MARKS SHALL BE FLUSH TO 0.2 BELOW PART SURFACE.
  12. PLASTIC IDENTIFICATION MARKS SHALL BE PER ISO11469.
  13. MATES WITH CONNECTOR ASSEMBLIES FROM FOLLOWING DRAWINGS:
    - 10 WAY: SD-31372-900
    - 20 WAY: SD-31408-900
  14. PART MUST CONFORM TO "HEADER PIN RETENTION" SPECIFICATION OF:
    - .64MM PIN = 12 N MIN
    - 1.5MM BLADE = 7 N MIN
    - 2.8MM BLADE = 14 N MIN

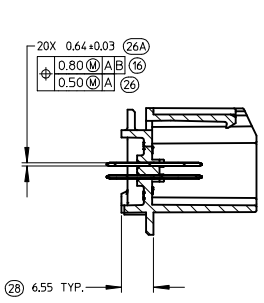

SECTION B-B

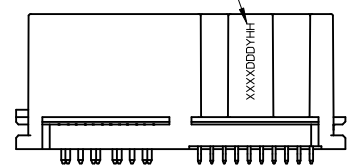
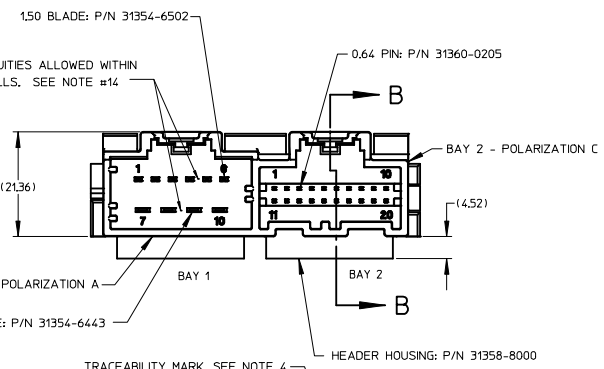
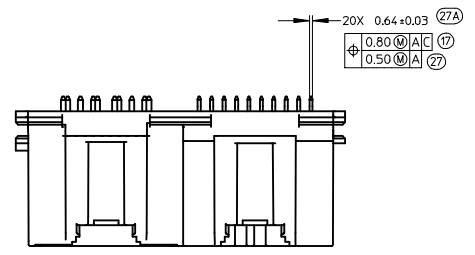

PART NUMBER	PACKAGING SPECIFICATION (DESCRIPTION)
31359-8000	PK-31300-332 (TUBE)
31359-8001	PK-31300-408 (TRAY)

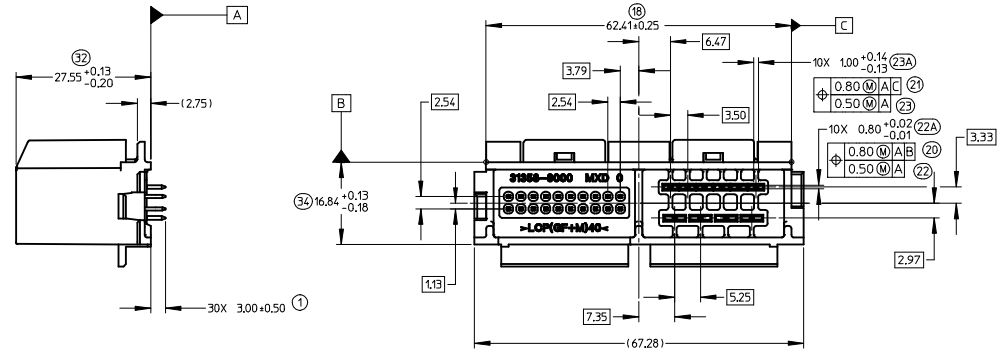

EC NO: UAU2013-0100 DRWN: JFISCHER 2012/07/18 CHKD: APPR: SMARCEAU 2012/07/19	QUALITY SYMBOLS -0 -0	GENERAL TOLERANCES (UNLESS SPECIFIED) .mm INCH	SCALE 2:1 DESIGN UNITS METRIC	THIRD ANGLE PROJECTION REVISE ON CAD ONLY
		4 PLACES ± --- ± --- 3 PLACES ± --- ± --- 2 PLACES ± 0.13 ± --- 1 PLACE ± 0.25 ± ---	DIMENSION STYLE MM ONLY	TITLE 10X20 VERTICAL HYBRID LCP SALES HEADER ASSY.
		ANGULAR ± 3 °	DRAWN BY SKAROLEWI DATE 2006/01/19	CHECKED BY GMEYER DATE 2006/01/31
		DRAFT WHERE APPLICABLE MUST REMAIN WITHIN DIMENSIONS	APPROVED BY PBERG DATE 2006/01/31	MATERIAL NO. SEE CHART DOCUMENT NO. SD-31359-800 SHEET NO. 1 OF 1