

NOTES:

1. METALSHELLS: STEEL; min. 315µm TIN over 40-80µm NICKEL
2. INSULATORS: PBT GF UL 94 V-0; BLACK
3. CONTACTS: COPPER ALLOY
PLATING: 8µm HARD GOLD over min. 50µm NICKEL
4. THREADED SPACER CLIPS: COPPER ALLOY; min. 200µm TIN over 80µm NICKEL
PCB-HOLE: $\varnothing 3.1 \pm 0,1$; PCB THICKNESS 2,3mm
5. COLLARS: COPPER ALLOY; min. 200µm TIN over 80µm NICKEL
6. MAXIMUM TORQUE VALUE FOR THREAD: 6 in.LB
7. P.C.B. HOLE DRILLINGS ON SHEET 2
8. CONNECTOR IS PART MARKED: DSS3XPRAA15X CONEC ABC

Directive 2002/95/EC
"RoHS"
Compliant

| | |
|---|--------|
| APPROVAL # FREIGABE # AUTORIZACION # APPROVAL | |
| CUSTOMER APPROVAL DATE: | |
| NAME: | TITLE: |
| COMPANY NAME: | |
| APPROVAL # FREIGABE # AUTORIZACION # APPROVAL | |

| | | | | | |
|--|-------------|----------|----------------|--|---------------------|
| THIS DRAWING MAY NOT BE COPIED OR REPRODUCED IN ANY WAY, AND MAY NOT BE PASSED ON TO A THIRD PARTY WITHOUT WRITTEN PERMISSION. OWNERSHIP AND COPYRIGHT OF CONEC GmbH DO NOT ALTER CAD DRAWING BY HAND | tolerance | | dim. in mm | scale: 2:1 (5:1) | |
| | | | | material: SEE NOTES | |
| | date | name | | title: | |
| | drawn | 16.12.09 | | name | Lehmenkühler |
| | appd. | 16.12.09 | name | Kühle | dwg no: Inventor 10 |
| | norm | | d-old | | DIN-A3 |
| a | Origin | | | | sh: 1 |
| rev. | description | date | name | part no: DSS3XPRAA15X North American Version | |

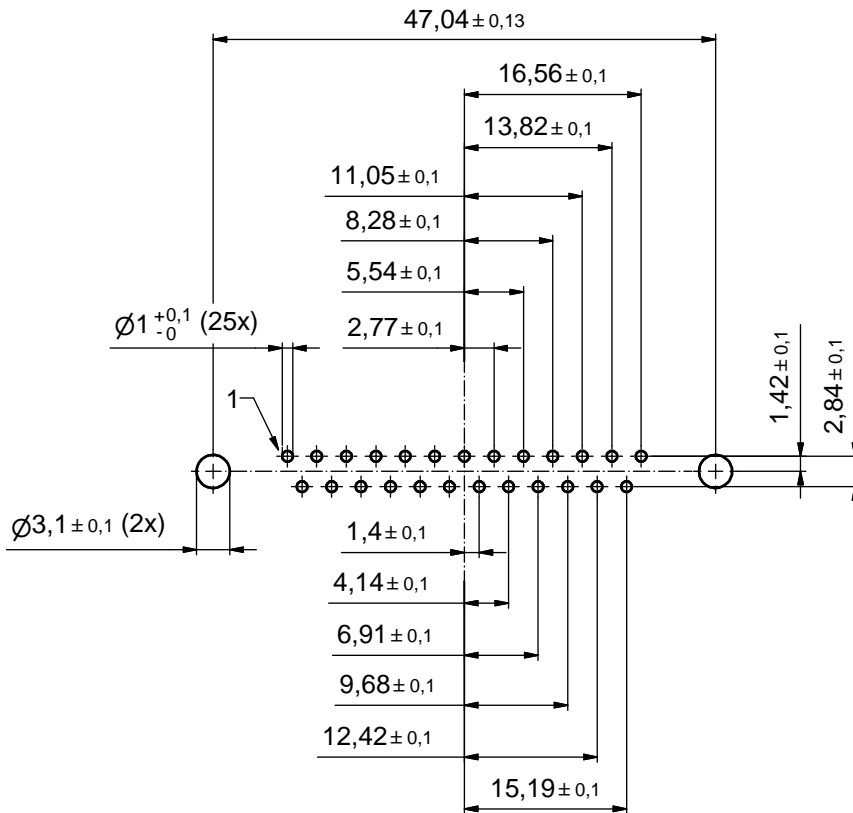

PCB TOP SIDE

| | |
|---|--------|
| APPROVAL # FREIGABE # DEBLOCAGE # AUTORIZACION # APPROVAL | |
| CUSTOMER APPROVAL DATE: | |
| NAME: | TITLE: |
| COMPANY NAME: | |
| APPROVAL # FREIGABE # DEBLOCAGE # AUTORIZACION # APPROVAL | |

| | | | | | | | | | | | | | | | | | | | | | |
|--|--|--------|------|--|-------------|----------------|---------|-------------|--------|-----------|--------------|-------|--------|--|--|---------|-------------|--------|----------|--------------|-------|
| THIS DRAWING MAY NOT BE COPIED OR REPRODUCED IN ANY WAY, AND MAY NOT BE PASSED ON TO A THIRD PARTY WITHOUT WRITTEN PERMISSION. OWNERSHIP AND COPYRIGHT OF CONEC GmbH | | | | tolerance | | dim. in mm | | | | | | | | | | | | | | | |
| DO NOT ALTER CAD DRAWING BY HAND | | | | date | name | | | | | | | | | | | | | | | | |
| a | Origin | | | drawn | 16.12. | Lehmenkühler | | | | | | | | | | | | | | | |
| rev. | description | date | name | appd. | 16.12. | Kühle | | | | | | | | | | | | | | | |
| | | | | norm | | | | | | | | | | | | | | | | | |
| | | | | d-old | | | | | | | | | | | | | | | | | |
| | | | | <table border="1"> <tr> <td>dwg no:</td> <td>Inventor 10</td> <td>DIN-A3</td> </tr> <tr> <td>part no:</td> <td>16K1A2574-NA</td> <td>sh: 2</td> </tr> </table> | | | dwg no: | Inventor 10 | DIN-A3 | part no: | 16K1A2574-NA | sh: 2 | | | | | | | | | |
| | | | | dwg no: | Inventor 10 | DIN-A3 | | | | | | | | | | | | | | | |
| part no: | 16K1A2574-NA | sh: 2 | | | | | | | | | | | | | | | | | | | |
| | | | | <table border="1"> <tr> <td>scale:</td> <td colspan="2">2:1</td> </tr> <tr> <td>material:</td> <td colspan="2">SEE SHEET 1</td> </tr> <tr> <td>title:</td> <td colspan="2">P.C.B. HOLE DRILLINGS D-SUB MALE 25pos. SOLDER PIN with threaded spacer clip</td> </tr> <tr> <td>dwg no:</td> <td>Inventor 10</td> <td>DIN-A3</td> </tr> <tr> <td>part no:</td> <td>16K1A2574-NA</td> <td>sh: 2</td> </tr> </table> | | | scale: | 2:1 | | material: | SEE SHEET 1 | | title: | P.C.B. HOLE DRILLINGS D-SUB MALE 25pos. SOLDER PIN with threaded spacer clip | | dwg no: | Inventor 10 | DIN-A3 | part no: | 16K1A2574-NA | sh: 2 |
| scale: | 2:1 | | | | | | | | | | | | | | | | | | | | |
| material: | SEE SHEET 1 | | | | | | | | | | | | | | | | | | | | |
| title: | P.C.B. HOLE DRILLINGS D-SUB MALE 25pos. SOLDER PIN with threaded spacer clip | | | | | | | | | | | | | | | | | | | | |
| dwg no: | Inventor 10 | DIN-A3 | | | | | | | | | | | | | | | | | | | |
| part no: | 16K1A2574-NA | sh: 2 | | | | | | | | | | | | | | | | | | | |

| | | |
|-----------|--|--------|
| scale: | 2:1 | |
| material: | SEE SHEET 1 | |
| title: | P.C.B. HOLE DRILLINGS D-SUB MALE 25pos. SOLDER PIN with threaded spacer clip | |
| dwg no: | Inventor 10 | DIN-A3 |
| part no: | 16K1A2574-NA | sh: 2 |
| material: | SEE SHEET 1 | |