

DO NOT SCALE FROM THIS PRINT

No OF PAIRS PER COLUMN

-4

COLUMNS

-06  
-08  
-10

COLUMN PITCH

-2.0: 2.0 mm

PLATING SPECIFICATION

-S: 30µ" SELECTIVE GOLD IN CONTACT AREA, MATTE TIN ON TAIL

ORIENTATION

-RA: RIGHT ANGLE

KEYING

(ONLY AVAILABLE WITH -L OR -R GUIDANCE)  
BLANK: NO KEYING  
-A THRU -H: DENOTES POSITION OF FLAT ON KEY (SEE KEYING POSITION TABLE, SHT 4)

GUIDANCE

BLANK: NONE  
-L: LEFT (SEE FIG 3, SHT 5)  
-R: RIGHT (SEE FIG 2, SHT 4)

PIN CONFIGURATION

-1: STANDARD

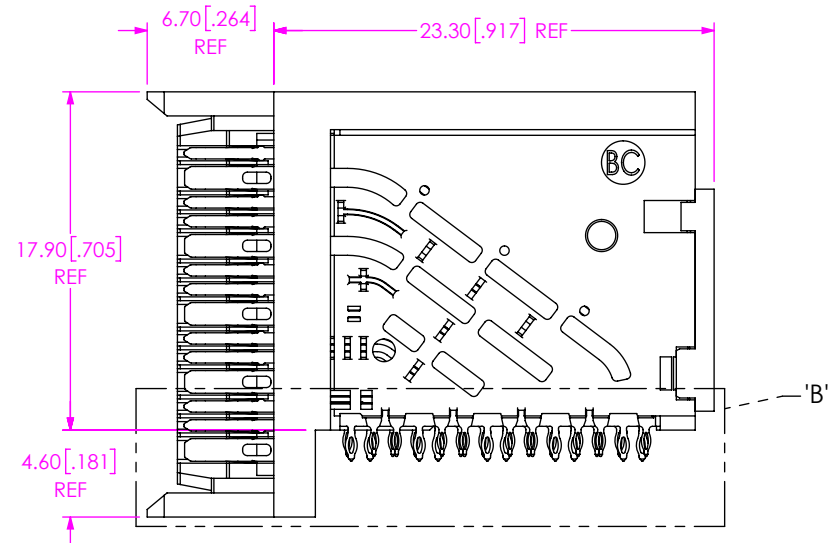
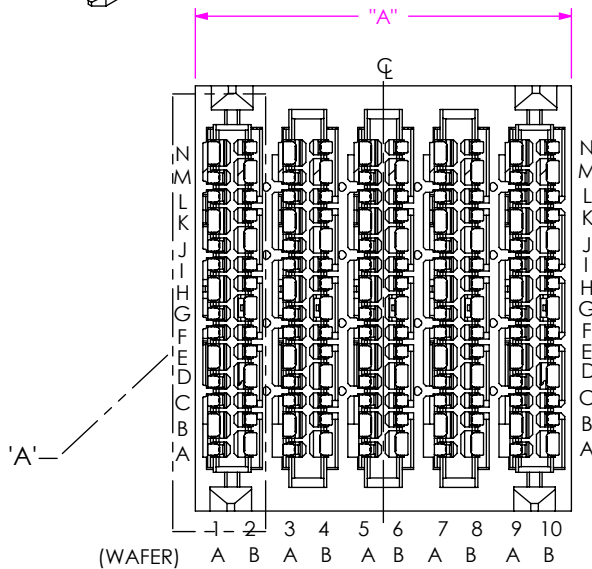

FIG 1  
EBTM-4-10-2.0-X-RA-1 SHOWN

TABLE 1				
COLUMNS	"A"	"B"	"C"	
-06	11.90 [0.469]	10.00 [0.394]	5.20	[0.205]
-08	15.90 [0.626]	14.00 [0.551]	7.20	[0.283]
-10	19.90 [0.783]	18.00 [0.709]	9.20	[0.362]

NOTES:

1. MINIMUM PUSHOUT FORCE: 2.22N [5 LB].
2. CONTACT SAMTEC FOR CONNECTOR PRESS FIT INSTRUCTIONS.
3. TRAYS TO BE STANDARD PACKAGING.
4. ORDERS WILL BE PACKAGED ACCORDING TO THE SAMTEC PACKAGING EFFICIENCY STANDARDS (SPES) FOUND ON [WWW.SAMTEC.COM](http://WWW.SAMTEC.COM).

UNLESS OTHERWISE SPECIFIED, DIMENSIONS ARE IN MILLIMETERS [INCHES].

TOLERANCES ARE:

DECIMALS      ANGLES  
X.X: ±0.3 [0.01]      2°  
X.XX: ±0.10 [0.004]  
X.XXX: ±0.050 [0.0019]

PROPRIETARY NOTE

THIS DOCUMENT CONTAINS CONFIDENTIAL AND PROPRIETARY INFORMATION AND ALL DESIGN, MANUFACTURING, REPRODUCTION, USE, PATENT RIGHTS AND SALES RIGHTS ARE EXPRESSLY RESERVED BY SAMTEC, INC. THIS DOCUMENT SHALL NOT BE DISCLOSED, IN WHOLE OR PART, TO ANY UNAUTHORIZED PERSON OR ENTITY NOR REPRODUCED, TRANSFERRED OR INCORPORATED IN ANY OTHER PROJECT IN ANY MANNER WITHOUT THE EXPRESS WRITTEN CONSENT OF SAMTEC, INC.

MATERIAL: DO NOT SCALE DRAWING SHEET SCALE: 3:1

INSULATOR: LCP, UL 94-V0; COLOR: BLACK  
CONTACT: COPPER ALLOY  
SHIELD: COPPER ALLOY



520 PARK EAST BLVD., NEW ALBANY, IN 47150  
PHONE: 812-944-6733 FAX: 812-948-5047  
e-Mail: [info@SAMTEC.com](mailto:info@SAMTEC.com) code 53322

DESCRIPTION:  
EXAMAX™ RIGHT ANGLE HEADER ASSEMBLY

DWG. NO.  
EBTM-4-XX-2.0-X-RA-X-X-X

BY: B BLESSING 8/18/17 SHEET 1 OF 5

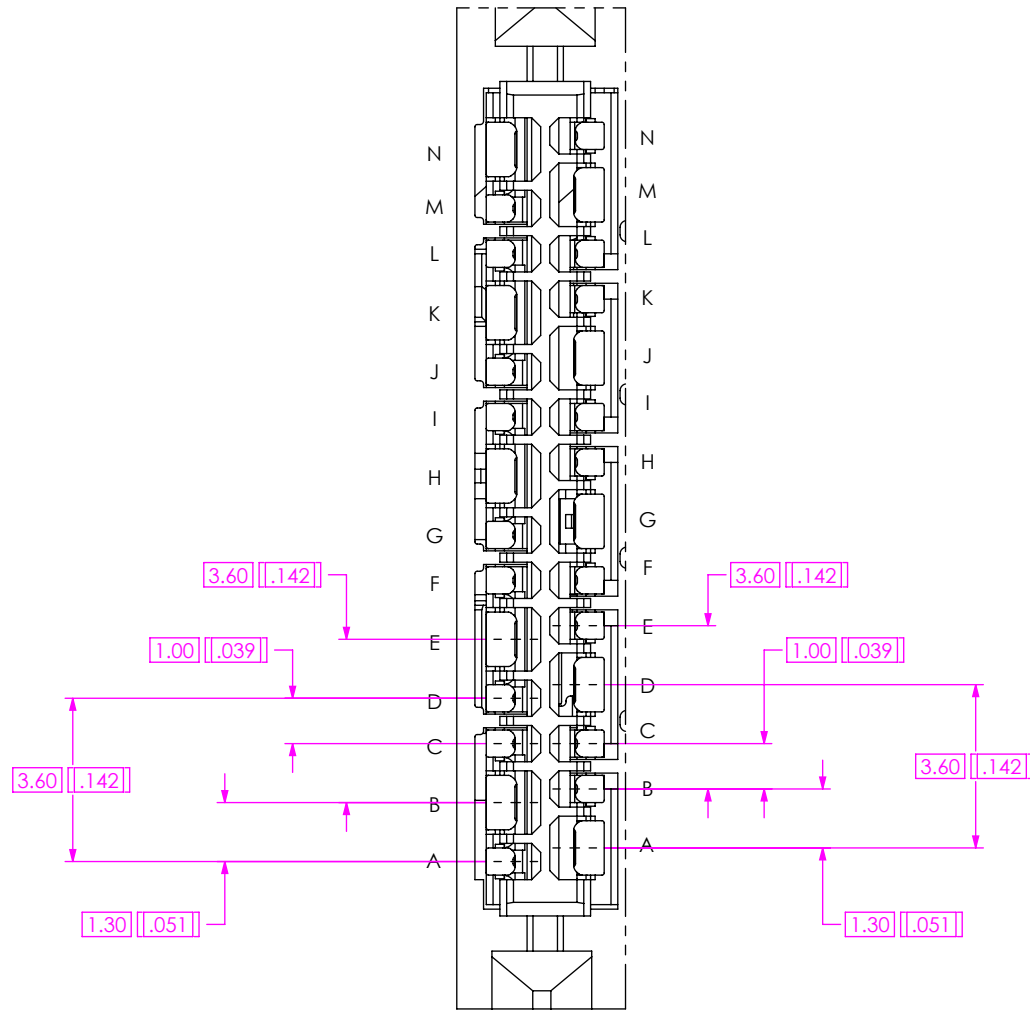

DETAIL 'A'  
SCALE 6 : 1

**PROPRIETARY NOTE**  
 THIS DOCUMENT CONTAINS CONFIDENTIAL AND PROPRIETARY INFORMATION AND ALL DESIGN, MANUFACTURING, REPRODUCTION, USE, PATENT RIGHTS AND SALES RIGHTS ARE EXPRESSLY RESERVED BY SAMTEC, INC. THIS DOCUMENT SHALL NOT BE DISCLOSED, IN WHOLE OR PART, TO ANY UNAUTHORIZED PERSON OR ENTITY NOR REPRODUCED, TRANSFERRED OR INCORPORATED IN ANY OTHER PROJECT IN ANY MANNER WITHOUT THE EXPRESS WRITTEN CONSENT OF SAMTEC, INC.

DO NOT SCALE DRAWING

SHEET SCALE: 2:1



520 PARK EAST BLVD. NEW ALBANY, IN 47150  
 PHONE: 812-944-6733 FAX: 812-948-5047  
 e-Mail info@SAMTEC.com code 55322

DESCRIPTION:  
 EXAMAX™ RIGHT ANGLE HEADER ASSEMBLY

DWG. NO.  
 EBTM-4-XX-2.0-X-RA-X-X-X

BY: B BLESSING 8/18/17 SHEET 2 OF 5

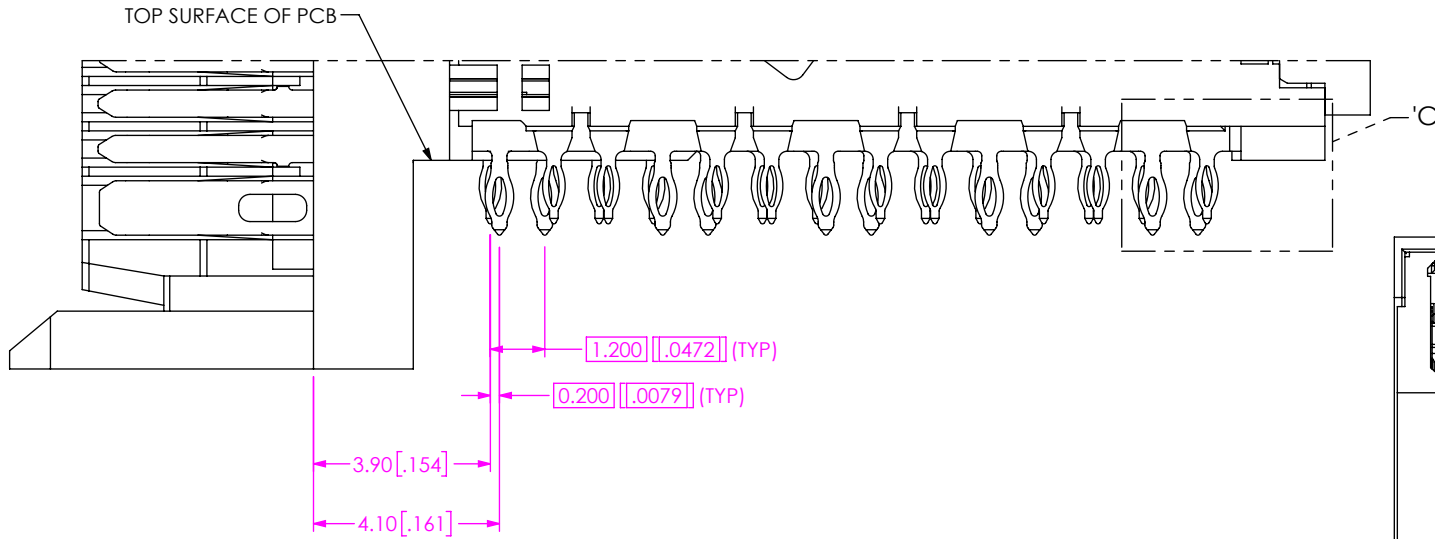

DETAIL 'B'  
SCALE 6 : 1

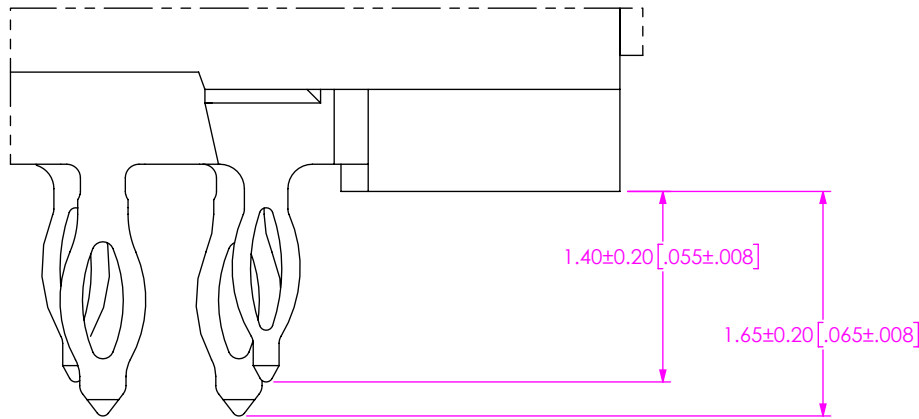

DETAIL 'C'  
SCALE 18 : 1

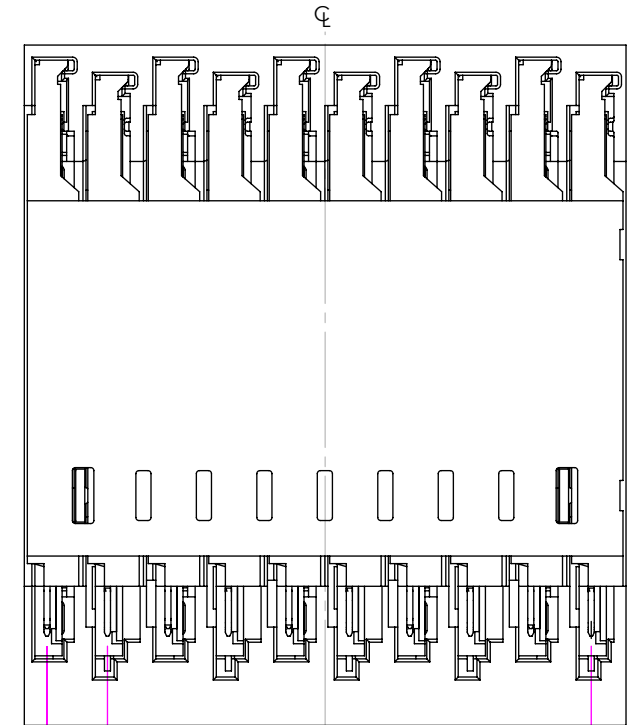

BACK VIEW

PROPRIETARY NOTE

THIS DOCUMENT CONTAINS CONFIDENTIAL AND PROPRIETARY INFORMATION AND ALL DESIGN, MANUFACTURING, REPRODUCTION, USE, PATENT RIGHTS AND SALES RIGHTS ARE EXPRESSLY RESERVED BY SAMTEC, INC. THIS DOCUMENT SHALL NOT BE DISCLOSED, IN WHOLE OR PART, TO ANY UNAUTHORIZED PERSON OR ENTITY NOR REPRODUCED, TRANSFERRED OR INCORPORATED IN ANY OTHER PROJECT IN ANY MANNER WITHOUT THE EXPRESS WRITTEN CONSENT OF SAMTEC, INC.

DO NOT SCALE DRAWING

SHEET SCALE: 4:1



520 PARK EAST BLVD. NEW ALBANY, IN 47150  
PHONE: 812-944-6733 FAX: 812-948-5047  
e-Mail info@SAMTEC.com code 55322

DESCRIPTION:  
EXAMAX™ RIGHT ANGLE HEADER ASSEMBLY

DWG. NO.  
EBTM-4-XX-2.0-X-RA-X-X-X

BY: B BLESSING 8/18/17 SHEET 3 OF 5

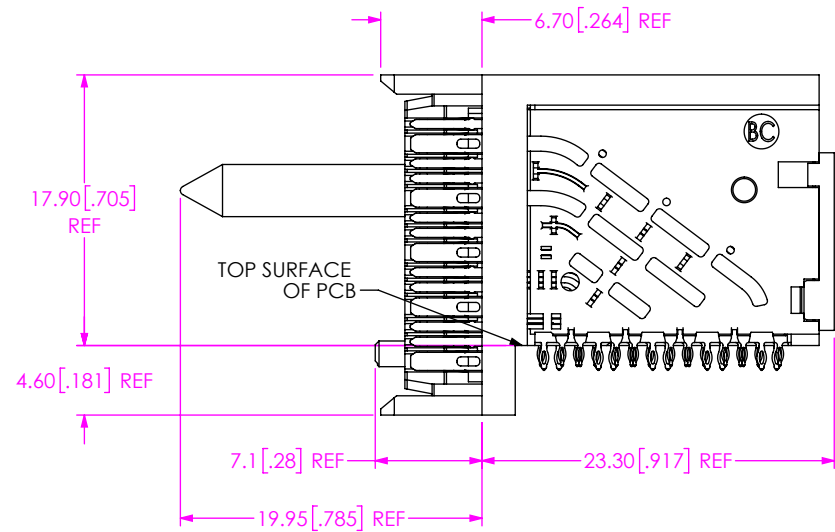
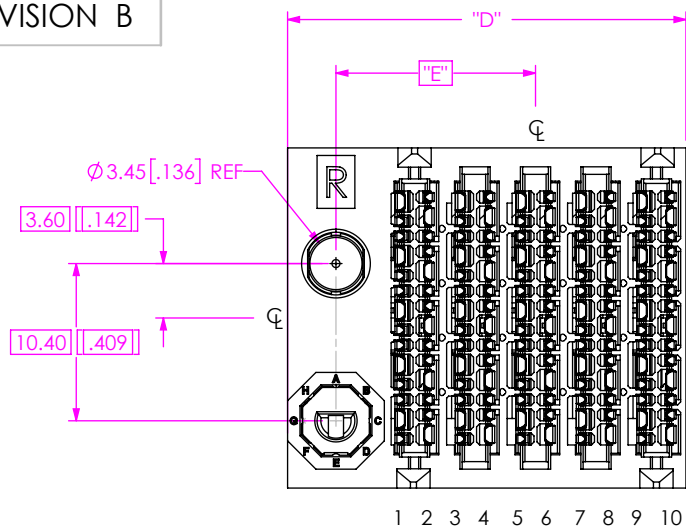
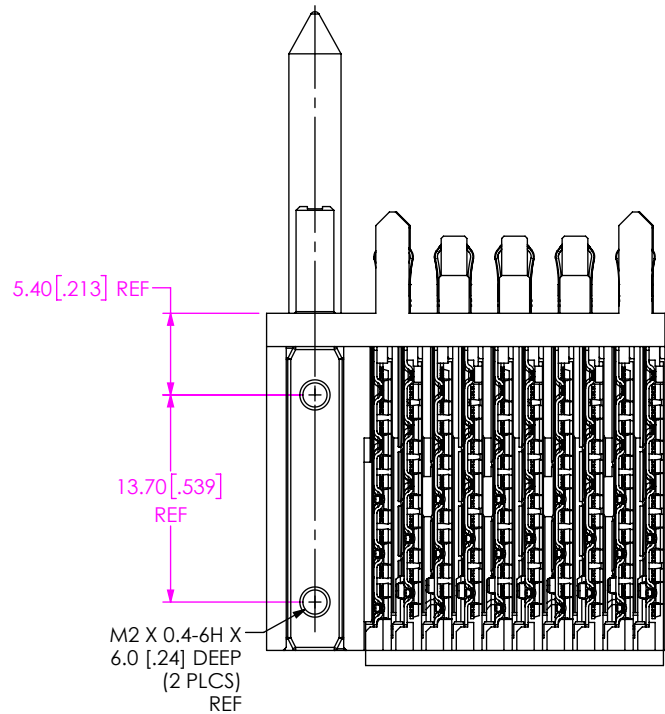

FIG 2  
RIGHT GUIDANCE  
EBTM-4-10-2.0-X-RA-X-R-A SHOWN  
(DIFFERENT AS SHOWN, OTHERWISE SAME AS FIG 1)



KEYING POSITION TABLE

		KEYING							
		-A	-B	-C	-D	-E	-F	-G	-H
-R / -L	H	A	B	A	B	A	B	A	B
	G	C	D	C	D	C	D	C	D
	F	E	D	E	D	E	D	E	D

COLUMNS	"D"	"E"
-06	18.35 [0.722]	9.20 [0.362]
-08	22.35 [0.880]	11.20 [0.441]
-10	26.35 [1.037]	13.20 [0.520]

**PROPRIETARY NOTE**  
THIS DOCUMENT CONTAINS CONFIDENTIAL AND PROPRIETARY INFORMATION AND ALL DESIGN, MANUFACTURING, REPRODUCTION, USE, PATENT RIGHTS AND SALES RIGHTS ARE EXPRESSLY RESERVED BY SAMTEC, INC. THIS DOCUMENT SHALL NOT BE DISCLOSED, IN WHOLE OR PART, TO ANY UNAUTHORIZED PERSON OR ENTITY NOR REPRODUCED, TRANSFERRED OR INCORPORATED IN ANY OTHER PROJECT IN ANY MANNER WITHOUT THE EXPRESS WRITTEN CONSENT OF SAMTEC, INC.

DO NOT SCALE DRAWING  
SHEET SCALE: 2:1

**samtec**  
520 PARK EAST BLVD. NEW ALBANY, IN 47150  
PHONE: 812-944-6733 FAX: 812-948-5047  
e-Mail info@SAMTEC.com code 55322

DESCRIPTION:  
EXAMAX™ RIGHT ANGLE HEADER ASSEMBLY  
DWG. NO.  
**EBTM-4-XX-2.0-X-RA-X-X-X**  
BY: B BLESSING 8/18/17 SHEET 4 OF 5

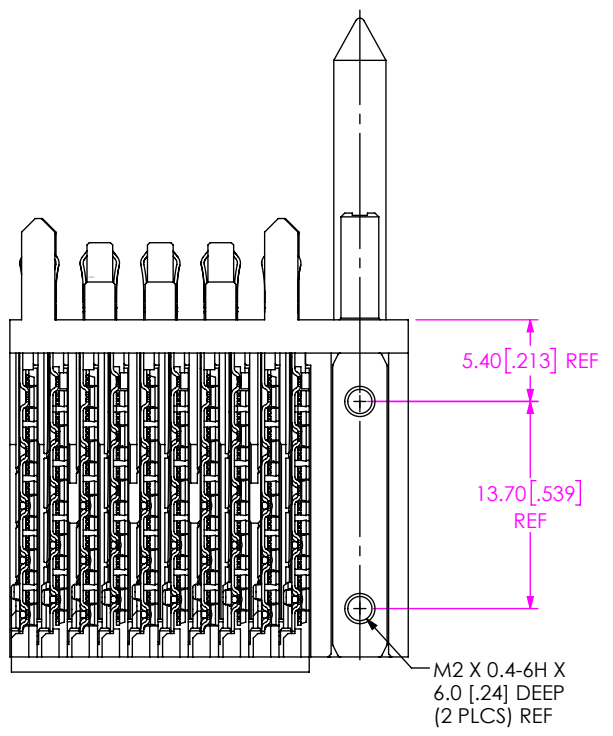
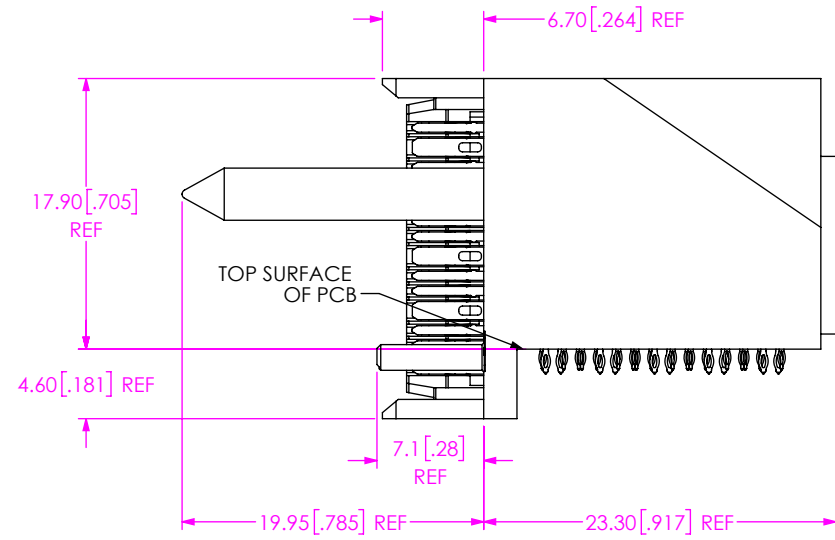
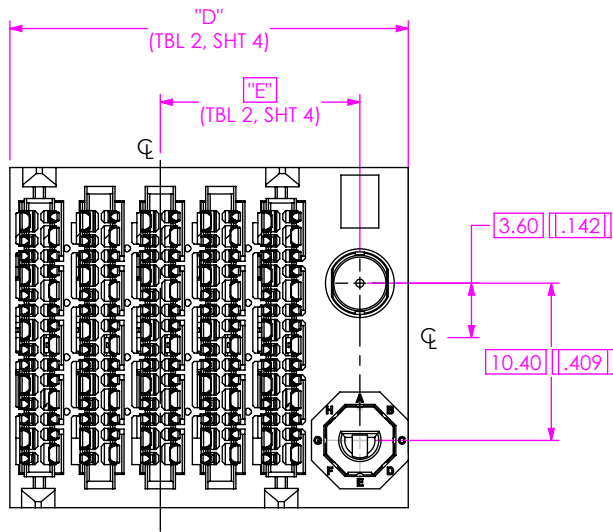

FIG 3  
 LEFT GUIDANCE  
 EBTM-4-10-2.0-X-RA-1-L-A SHOWN  
 (DIFFERENT AS SHOWN, OTHERWISE SAME AS FIG 2)

**PROPRIETARY NOTE**  
 THIS DOCUMENT CONTAINS CONFIDENTIAL AND PROPRIETARY INFORMATION AND ALL DESIGN, MANUFACTURING, REPRODUCTION, USE, PATENT RIGHTS AND SALES RIGHTS ARE EXPRESSLY RESERVED BY SAMTEC, INC. THIS DOCUMENT SHALL NOT BE DISCLOSED, IN WHOLE OR PART, TO ANY UNAUTHORIZED PERSON OR ENTITY NOR REPRODUCED, TRANSFERRED OR INCORPORATED IN ANY OTHER PROJECT IN ANY MANNER WITHOUT THE EXPRESS WRITTEN CONSENT OF SAMTEC, INC.

**samtec**  
 520 PARK EAST BLVD. NEW ALBANY, IN 47150  
 PHONE: 812-944-6733 FAX: 812-948-5047  
 e-Mail info@SAMTEC.com code 55322

DO NOT SCALE DRAWING  
 SHEET SCALE: 2:1

DESCRIPTION:  
**EXAMAX™ RIGHT ANGLE HEADER ASSEMBLY**  
 DWG. NO.  
**EBTM-4-XX-2.0-X-RA-X-X-X**  
 BY: B BLESSING 8/18/17 SHEET 5 OF 5