

THIS DRAWING IS UNPUBLISHED. RELEASED FOR PUBLICATION, 19
 (C) COPYRIGHT 19 BY AMP INCORPORATED, ALL RIGHTS RESERVED.

LOC	DIST	REVISIONS					
DF	AO	P	LTR	DESCRIPTION	DATE	DWN	APVD
		A		REV PER 063D-0598-02	12-02	CT	SG

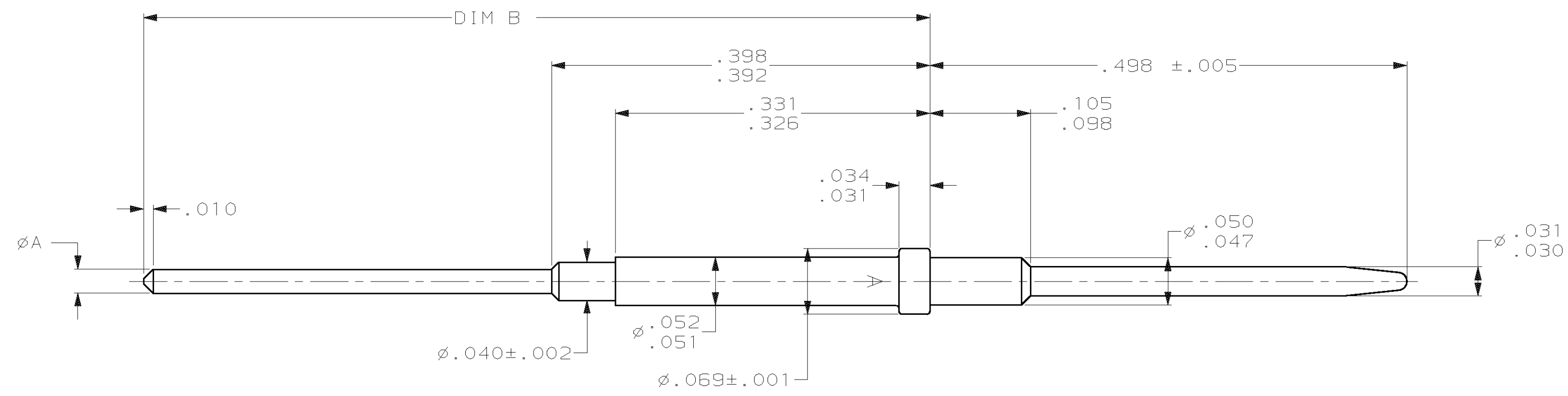

1 MAT'L: LEADED COPPER PER ASTM-B-301.
 2 FINISH: GOLD PLATED .000050 MIN THK PER ASTM-B-488 OVER NICKEL .000050 MIN THK PER QQ-N-290.

1.590	.0235-.0265	448825-6
.721	.0226-.0246	448825-4
.821	.0235-.0265	448825-2
DIM B	DIM A	PART NO.

THIS DRAWING IS A CONTROLLED DOCUMENT.		DWN	C.C. THOMAS	12-9-02	 TYCO Electronics Harrisburg, PA 17105-3608			
DIMENSIONS: INCHES		CHK	S. GLATFELTER	12-9-02				
TOLERANCES UNLESS OTHERWISE SPECIFIED:		APVD	S. GLATFELTER	12-9-02				
0 PLC ±- 1 PLC ±- 2 PLC ±- 3 PLC ±.005 4 PLC ±- ANGLES ±-		PRODUCT SPEC	PIN CONTACT, SIZE 22, FR, ARINC 600					
MATERIAL	FINISH	APPLICATION SPEC	-		SIZE	CAGE CODE	DRAWING NO	RESTRICTED TO
		WEIGHT	-		A2	00779	448825	-
CUSTOMER DRAWING					SCALE	10:1	SHEET	1 OF 1
					REV	A		