

THIS DRAWING IS UNPUBLISHED. RELEASED FOR PUBLICATION 20  
 © COPYRIGHT 20 BY TYCO ELECTRONICS CORPORATION. ALL RIGHTS RESERVED.

LOC	DIST	REVISIONS			
P	LTR	DESCRIPTION	DATE	DWN	APVD
GP	00	A	RELEASED	22MAY2008	RG SF

1. PART NUMBER CHANGES AND/OR DESIGN CHANGES AFFECTING ITEM INTERCHANGEABILITY REQUIRE TYCO ELECTRONICS APPROVAL AND AUTHORIZATION BY REVISION TO THIS DRAWING.

2. ITEMS PROVIDED TO THIS SPECIFICATION TO BE PERMANENTLY IDENTIFIED PER THE FOLLOWING IDENTIFIER:  
 YEAR 1 WEEK 1

TYCO ELECTRONICS P/N      DATE CODE (e.g. 0225)  
 XXXXXXXX-X                      XXXX

3. MODULE NOTED ARE FOR CRIMP STYLE REMOVABLE CONTACTS. THEY WILL BE PURCHASED SEPARATELY.  
 REF PIN CONTACT: SIZE 20, POSTMATE P/N 1650162-2  
 REF PIN CONTACT: SIZE 20, STANDARD P/N 1650155-1

4. MOUNTING FLANGE BUSHING ACCEPTS 6/32 SCREW (Ø.156 CLEARANCE HOLE, FLOAT MOUNT) OR 8/32 SCREW (Ø.173, CLEARANCE HOLE, FIXED MOUNT) USER SUPPLIED.

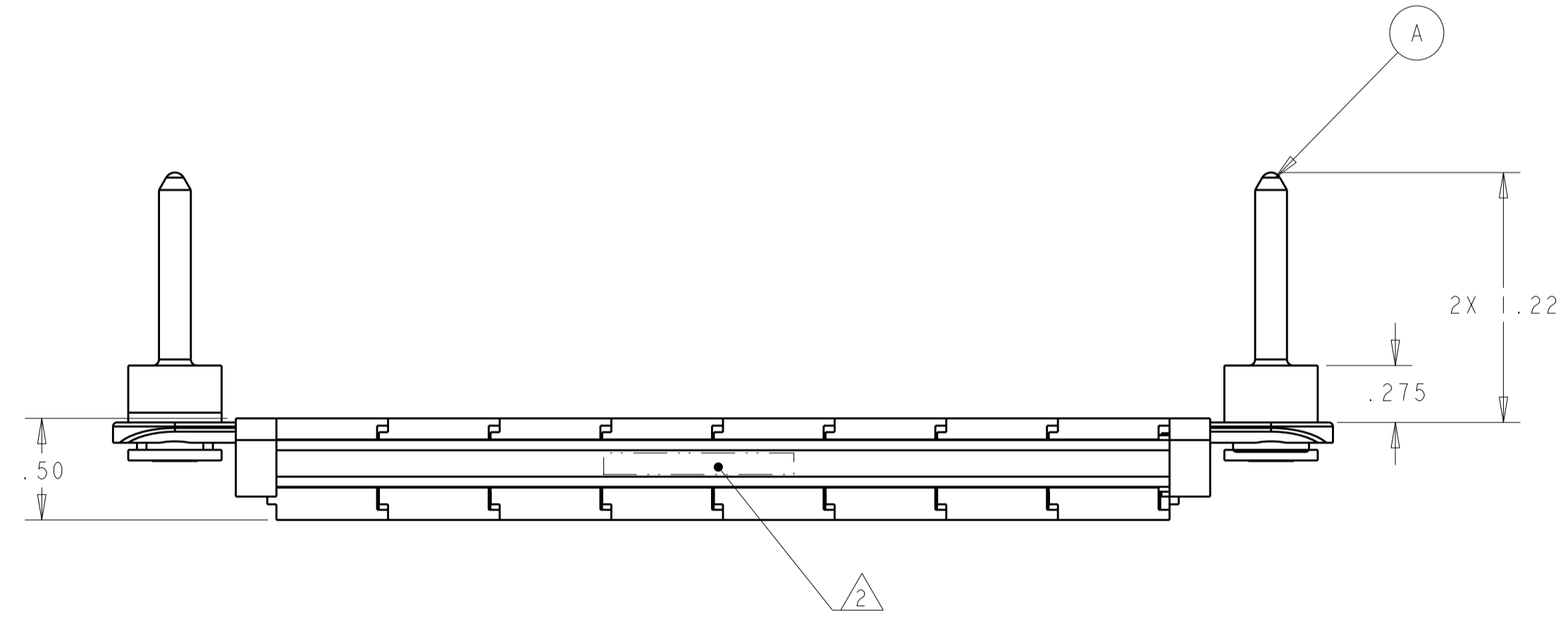
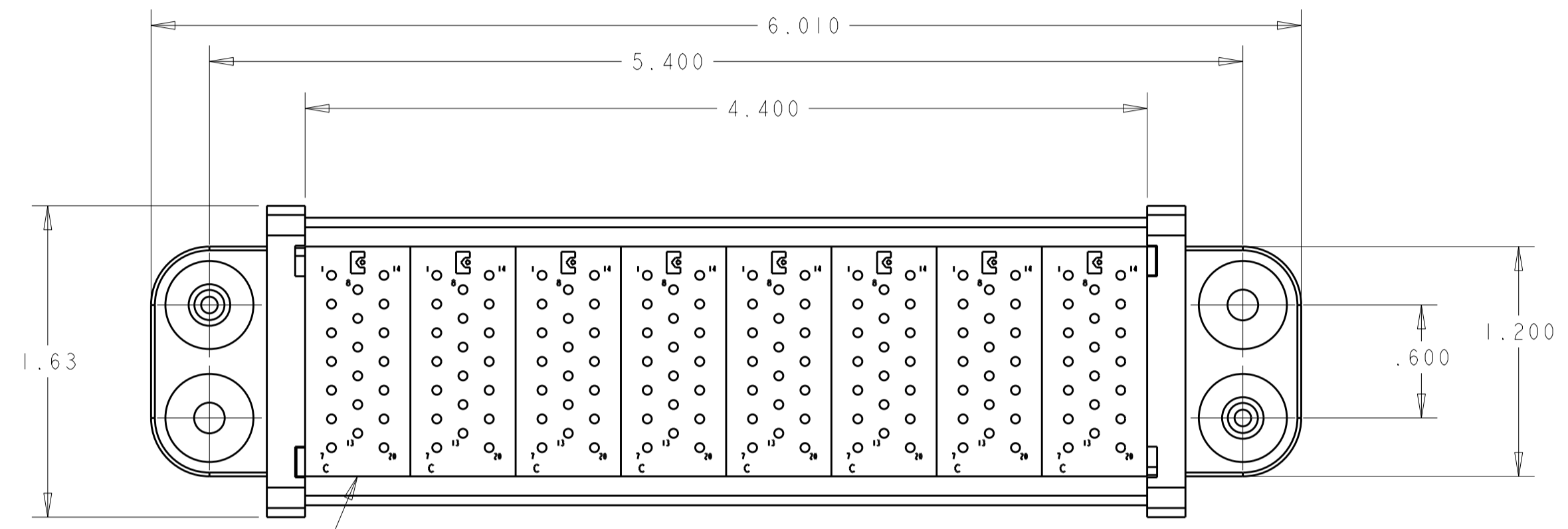

QTY	PART NO.	DESCRIPTION	ITEM
8	1648463-1	MODULE "C"	B
2	6648251-1	END CAP, FLOAT MOUNT, GUIDE PIN	A
-1			

<small>THIS DRAWING IS A CONTROLLED DOCUMENT FOR TYCO ELECTRONICS CORPORATION. IT IS SUBJECT TO CHANGE AND THE CONTROLLING ENGINEERING ORGANIZATION SHOULD BE CONTACTED FOR THE LATEST REVISION.</small>		DWN R. GRZYBOWSKI 20MAY08 CHK S. FLICKINGER 20MAY08 APVD S. FLICKINGER 20MAY08	Tyco Electronics Harrisburg, PA 17105-3608
DIMENSIONS: INCHES	TOLERANCES UNLESS OTHERWISE SPECIFIED: 0 PLC ± 1 PLC ± 2 PLC ±.02 3 PLC ±.010 4 PLC ± ANGLES ± FINISH	PRODUCT SPEC APPLICATION SPEC WEIGHT	NAME PIN CONNECTOR DOMINO W/ PANEL CUT-OUT SIZE CAGE CODE DRAWING NO RESTRICTED TO A200779 C-6646096 -
MATERIAL		CUSTOMER DRAWING	SCALE 2:1 SHEET 1 OF 2 REV A

4

3

2

1

THIS DRAWING IS UNPUBLISHED. RELEASED FOR PUBLICATION 20  
 © COPYRIGHT 20 BY TYCO ELECTRONICS CORPORATION. ALL RIGHTS RESERVED.

LOC	DIST	REVISIONS			
P	LTR	DESCRIPTION	DATE	DWN	APVD
GP	00	-	SEE SHEET 1	-	-

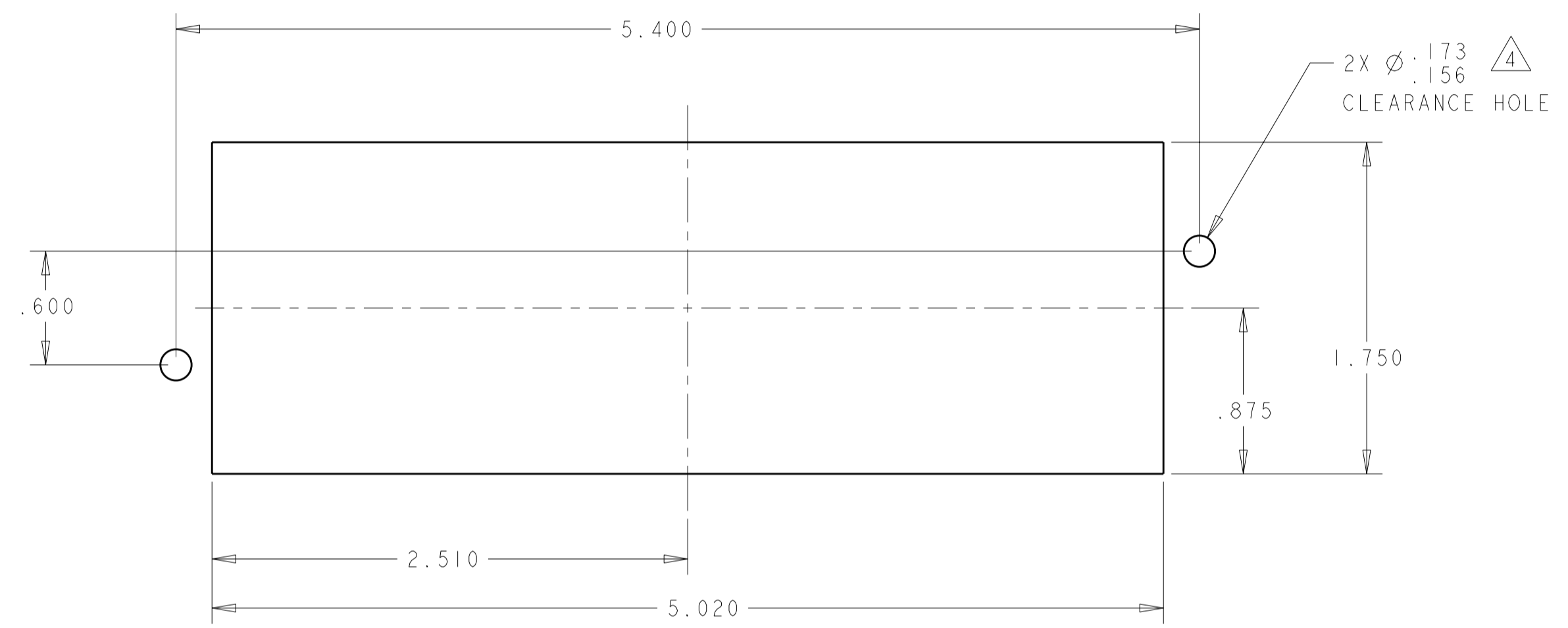

PANEL MOUNT CUT-OUT

<small>THIS DRAWING IS A CONTROLLED DOCUMENT FOR TYCO ELECTRONICS CORPORATION. IT IS SUBJECT TO CHANGE AND THE CONTROLLING ENGINEERING ORGANIZATION SHOULD BE CONTACTED FOR THE LATEST REVISION.</small>		DWN <b>R. GRZYBOWSKI</b> 20MAY08 CHK <b>S. FLICKINGER</b> 20MAY08 APVD <b>S. FLICKINGER</b> 20MAY08	<b>Tyco Electronics</b> Tyco Electronics Harrisburg, PA 17105-3608
DIMENSIONS: INCHES	TOLERANCES UNLESS OTHERWISE SPECIFIED: 0 PLC ± 1 PLC ± 2 PLC ±.02 3 PLC ±.010 4 PLC ± ANGLES ± FINISH	PRODUCT SPEC APPLICATION SPEC WEIGHT	NAME <b>PIN CONNECTOR          DOMINO          W/ PANEL CUT-OUT</b>
MATERIAL	FINISH	CUSTOMER DRAWING	SIZE <b>A200779</b>
		DRAWING NO. <b>C-6646096</b>	RESTRICTED TO -
		SCALE <b>2:1</b>	SHEET <b>2</b> OF <b>2</b> REV <b>A</b>