

CUSTOMER PRINT

PART NUMBER: W8380-XPG-P-3XX

NOTES:

1. ALL PARTS ARE BULK PACKED
2. CONTACTS SHIPPED UNASSEMBLED
3. ALL DIMENSIONS ARE REFERENCE EXCEPT THOSE WITH A TOLERANCE

ASS'Y P/N	CABLE O.D.
W8380-XPG-P-3DC	DAISY CHAIN
W8380-XPG-P-311	.09-.14 [2.3-3.5]
W8380-XPG-P-315	.15-.17 [3.8-4.3]
W8380-XPG-P-318	.18-.20 [4.6-5.1]
W8380-XPG-P-321	.21-.23 [5.3-5.8]

ASS'Y P/N	NO. OF CONTACTS
W8380-2PG-P-3XX	(2) #16
W8380-3PG-P-3XX	(3) #16
W8380-4PG-P-3XX	(4) #16
W8380-5PG-P-3XX	(5) #16
W8380-XPG-P-3XX	

GROMMET SIZE
NUMBER OF CONTACTS

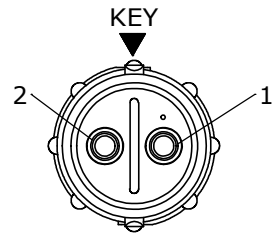

WIRE VIEW
W8380-2PG-P-3XX

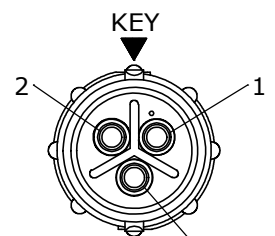

WIRE VIEW
W8380-3PG-P-3XX

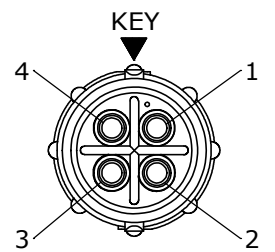

WIRE VIEW
W8380-4PG-P-3XX

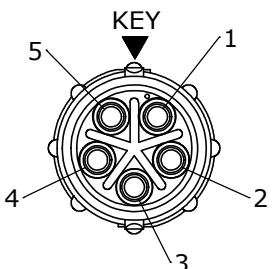

WIRE VIEW
W8380-5PG-P-3XX

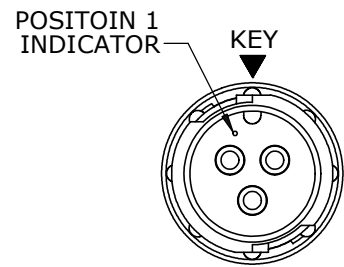

FACE VIEW
W8380-3PG-P-3XX SHOWN

IN-LINE CONNECTOR, MALE
MAT'L: UV PBT, BLACK

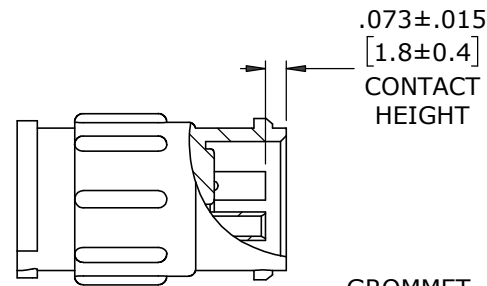

.073±.015
[1.8±0.4]
CONTACT
HEIGHT

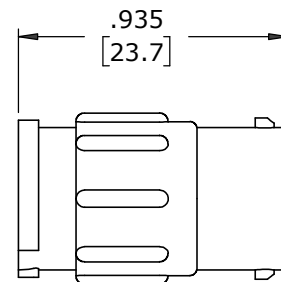

(2-5) #16 PIN CONTACTS, CRIMP
MAT'L: GOLD PLATED COPPER ALLOY

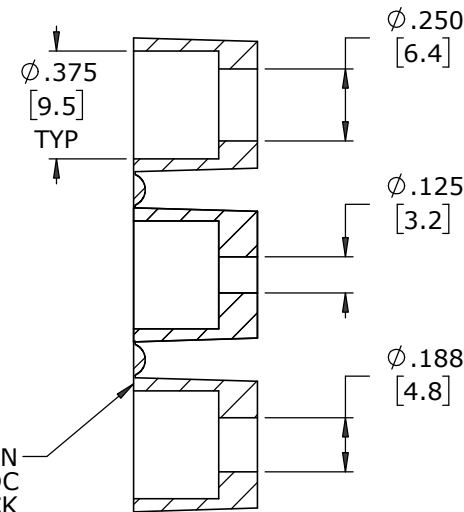
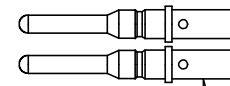

GROMMET, DAISY CHAIN
FOR W8380-XPG-P-3DC
MAT'L: RUBBER, BLACK

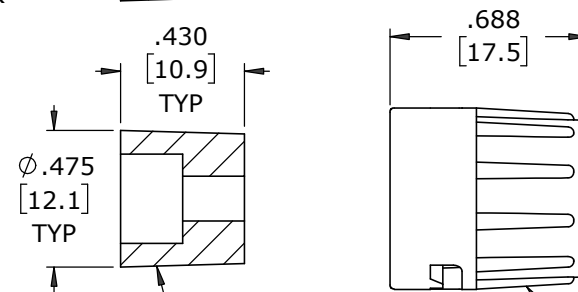

GROMMET
MAT'L: SANTOPRENE, BLACK

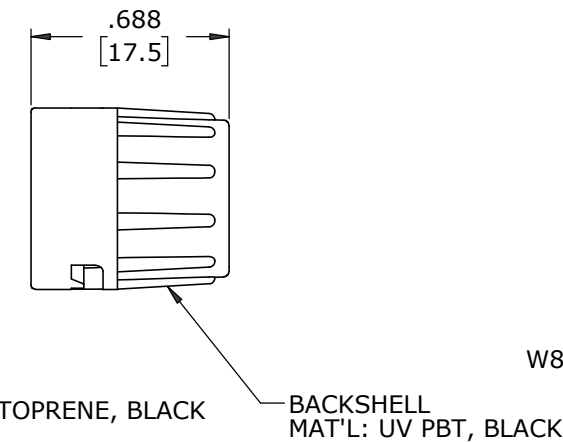

BACKSHELL
MAT'L: UV PBT, BLACK

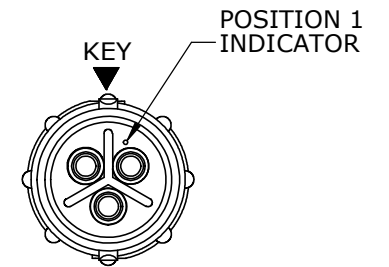

WIRE VIEW
W8380-3PG-P-3XX SHOWN

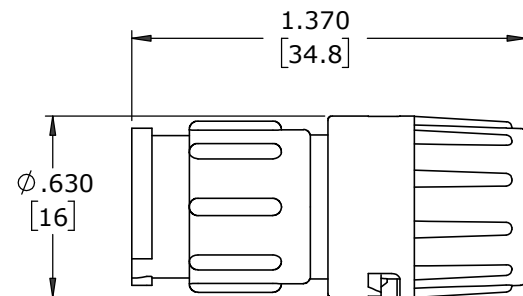

ASSEMBLED VIEW
FOR CUSTOMER REFERENCE

DIMENSIONS IN BRACKETS [] ARE IN MILLIMETERS UNLESS INDICATED

CUSTOMER APPROVAL

THIS DOCUMENT CONTAINS CONFIDENTIAL INFORMATION PROPRIETARY TO CONXALL CORPORATION. ANY REPRODUCTION, DISCLOSURE, OR USE OF THIS DOCUMENT /INFORMATION IS EXPRESSLY PROHIBITED UNLESS AUTHORIZED IN WRITING BY CONXALL CORPORATION.

APPROVED BY: _____
DATE: _____

RoHS COMPLIANT

A	MA	07-13-20	DRAWING CREATED PER PDR 16014-10	
REV.	INIT.	DATE	DESCRIPTION	
	MA	07-13-20	ORIG. DRAWN BY: _____ DATE: 07-13-20 CHECKED BY: _____ APPROVED BY: _____	
ALL INFORMATION ILLUSTRATED IS THE PROPERTY OF "CONXALL CORPORATION". UNAUTHORIZED DUPLICATION OR DISTRIBUTION OF THIS DOCUMENT IS PROHIBITED.			601 E. WILDWOOD VILLA PARK, IL 60181 TITLE: IN-LINE CONNECTOR ASSEMBLY (2-5) #16 PIN CONTACTS, CRIMP INSTA-CLICK™ MINI-CON-X STANDARD PRODUCT	
ALL UNITS ARE IN FEET, INCHES, FRACTIONS OF INCHES AND DECIMALS.				
SCALE	SIZE	SHEET	CUSTOMER:	
NTS	B	1 OF 1	PART NUMBER: W8380-XPG-P-3XX	
FILE:	DIRECTORY:	PART	REV	
W8380-XPG-P-3XX	SLW		A	