

PC board drilling dimensions (after plating)  
(thickness ≤ 3.20 ± 0.30mm)

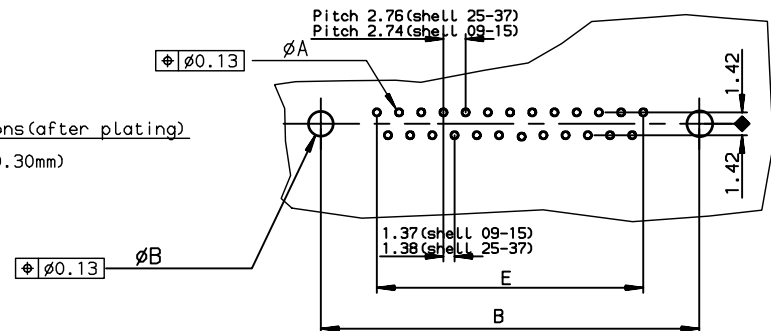

TIN LEAD PART NUMBER

SHELL	A±0.38	B±0.12	C±0.10	D±0.25	E±0.07	PART NUMBER	PART NUMBER
09	30.81	24.99	16.96	16.21	10.96	D09S90C4PA00	D09S90C6PA00
15	39.14	33.32	25.18	24.54	19.18	D15S90C4PA00	D15S90C6PA00
25	53.03	47.04	39.12	38.25	33.12	D25S90C4PA00	D25S90C6PA00
37	69.32	63.50	55.68	54.71	49.68	D37S90C4PA00	D37S90C6PA00
						gold flash	0.76µ gold

LEAD FREE PART NUMBER

SHELL	A±0.38	B±0.12	C±0.10	D±0.25	E±0.07	PART NUMBER	PART NUMBER
09	30.81	24.99	16.96	16.21	10.96	D09S90C4PA00LF	D09S90C6PA00LF
15	39.14	33.32	25.18	24.54	19.18	D15S90C4PA00LF	D15S90C6PA00LF
25	53.03	47.04	39.12	38.25	33.12	D25S90C4PA00LF	D25S90C6PA00LF
37	69.32	63.50	55.68	54.71	49.68	D37S90C4PA00LF	D37S90C6PA00LF
						gold flash	0.76µ gold

rev	ecn no	dr	date
C	-	PES	1996/07/18
D	LS05-004	MPE	2005/02/10
E	LS06-0095	LGO	2006/06/28
F	LS06-0186	LGO	2006/09/25
-	-	-	-
-	-	-	-
-	-	-	-

GENERAL CHARACTERISTICS AND ROHS INFORMATIONS:

SEE DRAWING C01-8646-0001

European Views

www.fciconnect.com			surface ISO 1302 ✓	tolerance std ISO 406 ISO 1101	projection mm
TOLERANCES UNLESS OTHERWISE SPECIFIED					
Dr	PESSON	1995/02/09	ANGULAR	0.X ± 0.1	size A3
Eng	PESSON	1995/02/09	LINEAR	0.XX ± 0.1	Scale 2
Chr	LEGARE	1995/02/09	0.XX ± 2'	0.XXX ± 0.1	ECN LS06-0186
Appr	LEGARE	1995/02/09	Product family	D-SUB	Spec ref -
FCj			title FEMALE CONNECTOR DELTA D LOW PROFIL straight press fit		Rev. F
catalog no			-		dwg no C01-8646-0340
CUSTOMER			sheet 1 of 1		