

REVISIONS					
P	LTR	DESCRIPTION	DATE	DMN	APVD
B		REVISED PER ECO-20-013368	22SEP20	RZ	HL

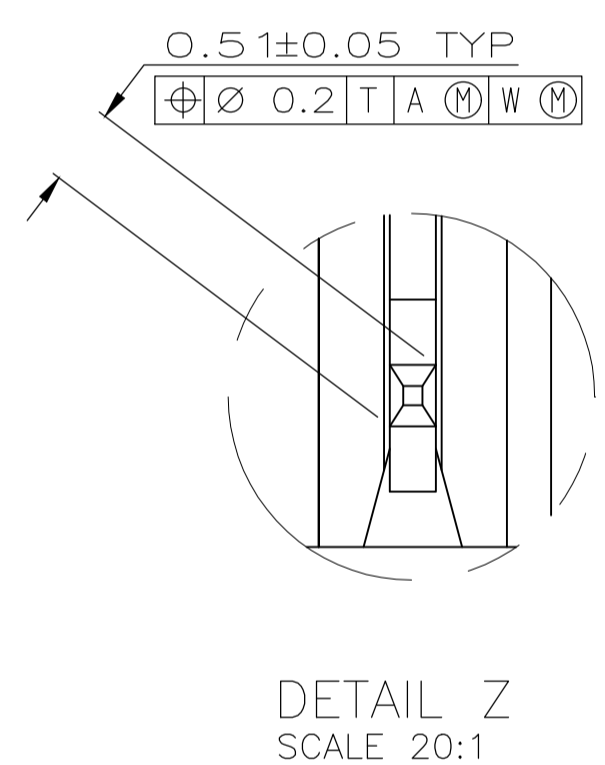
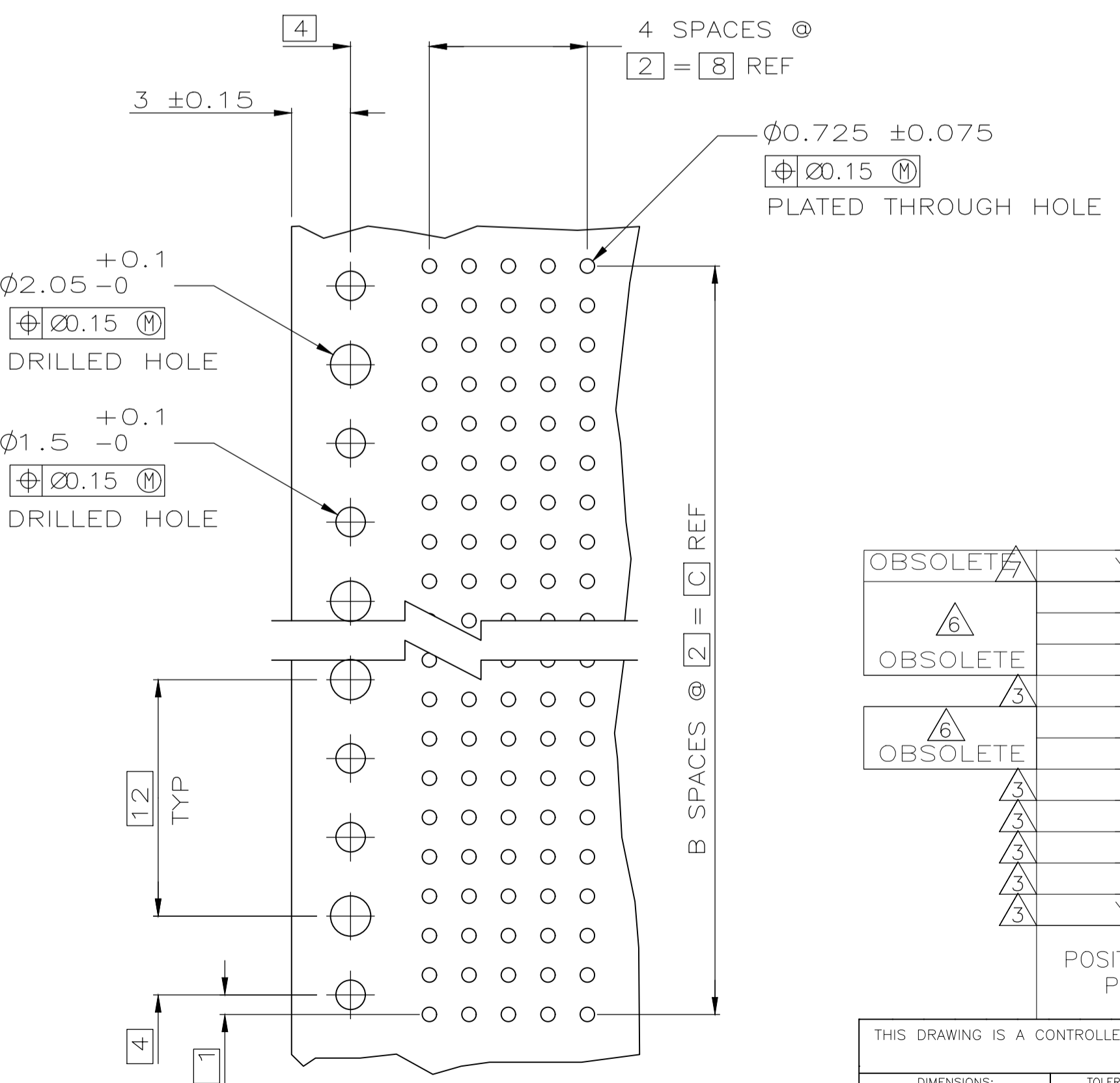
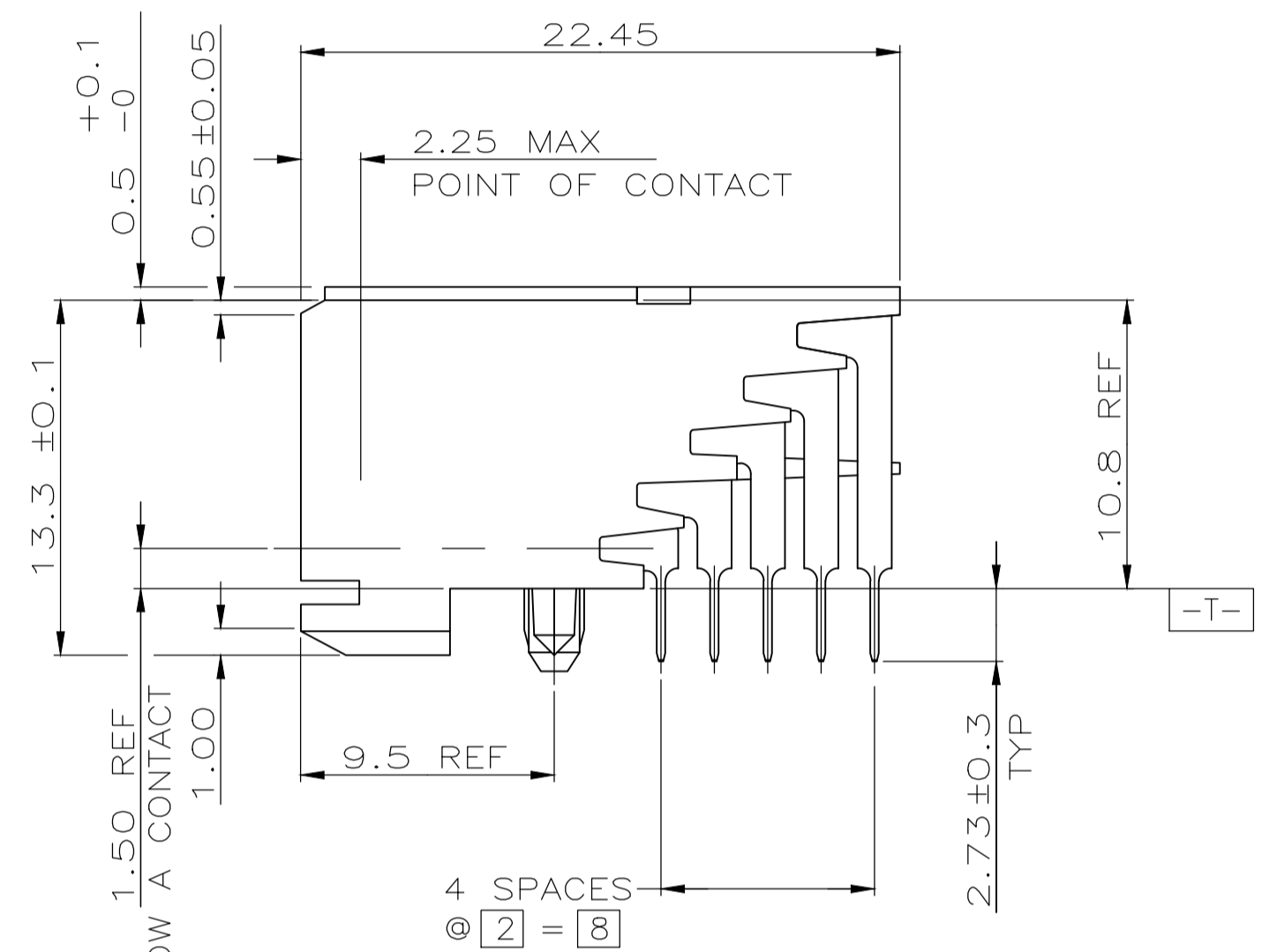
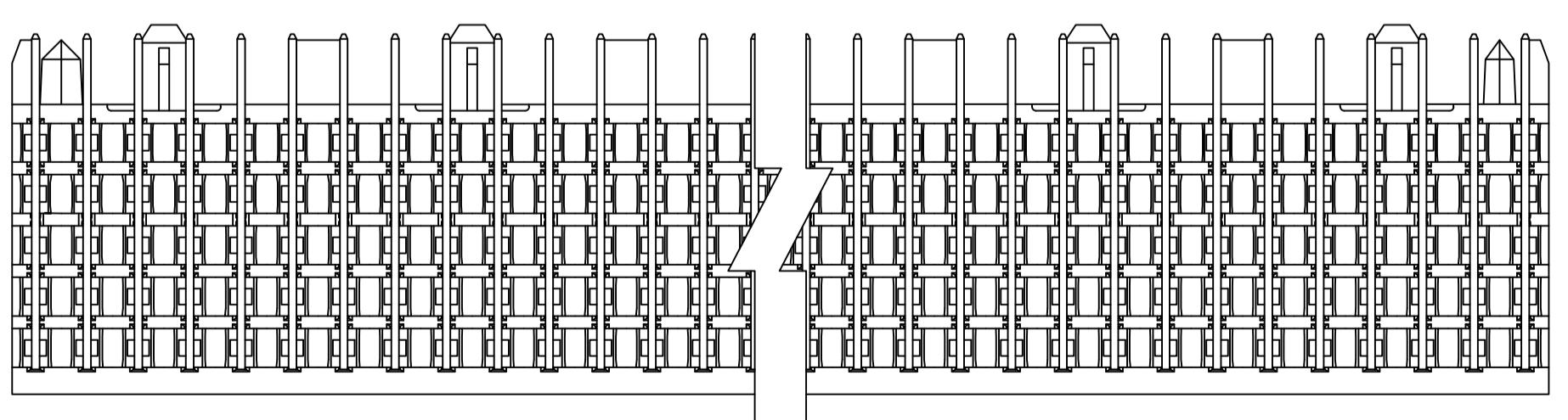
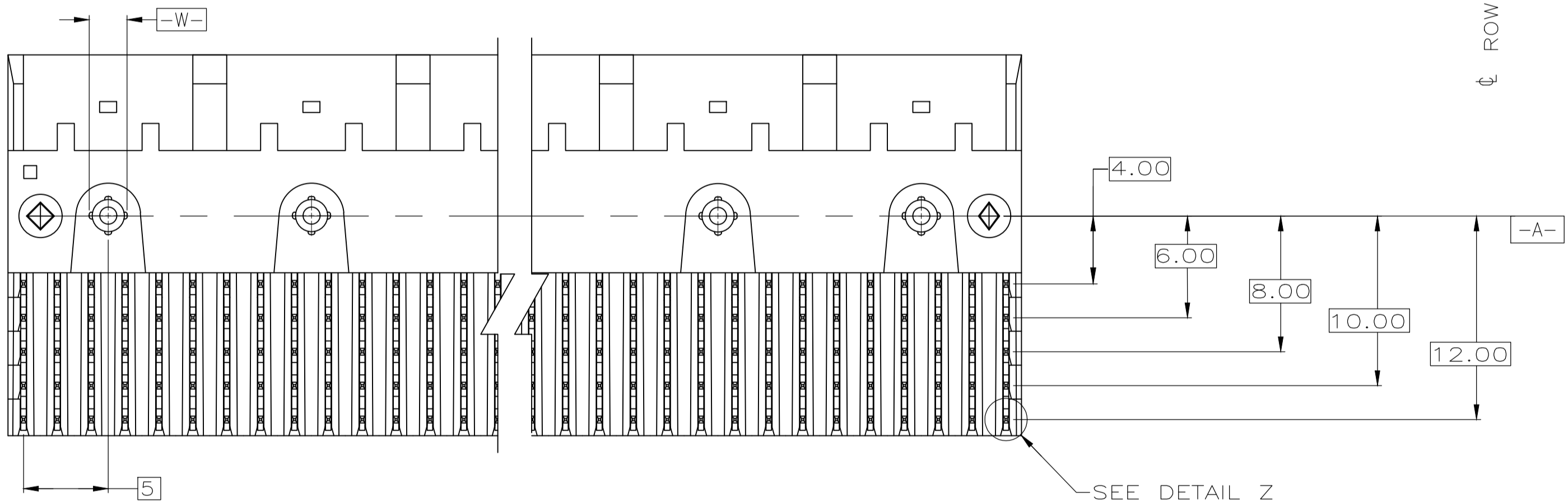
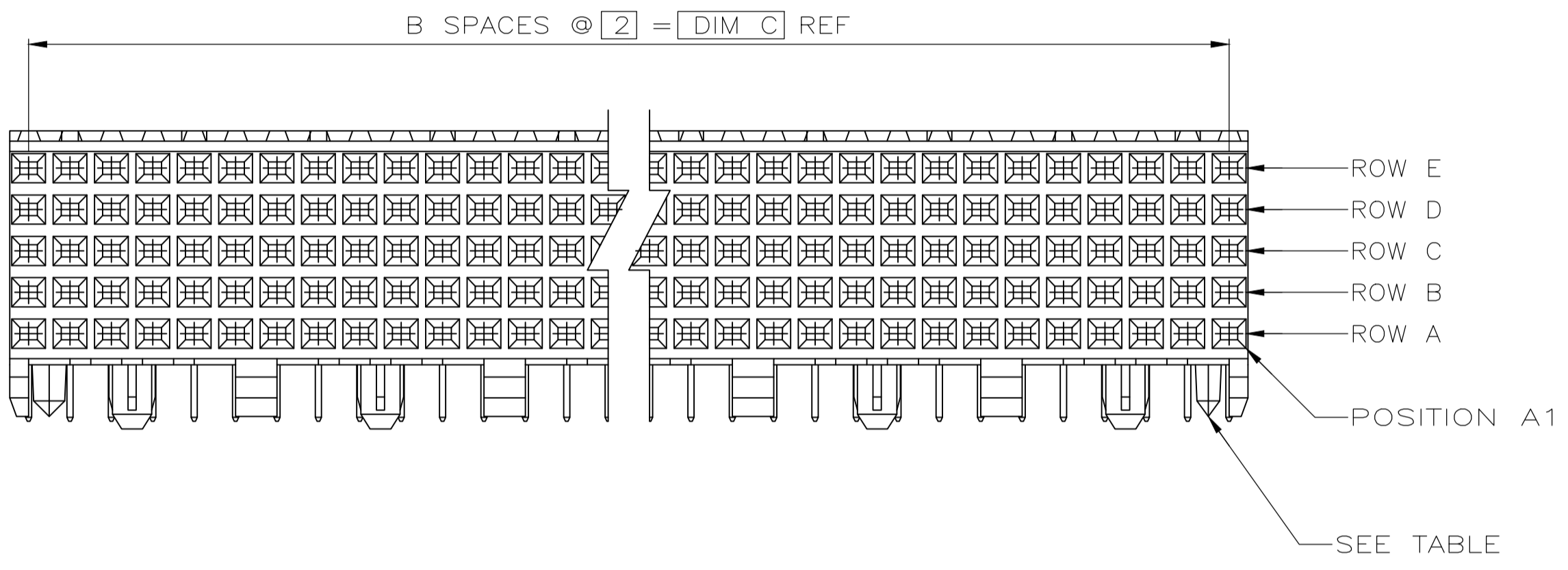
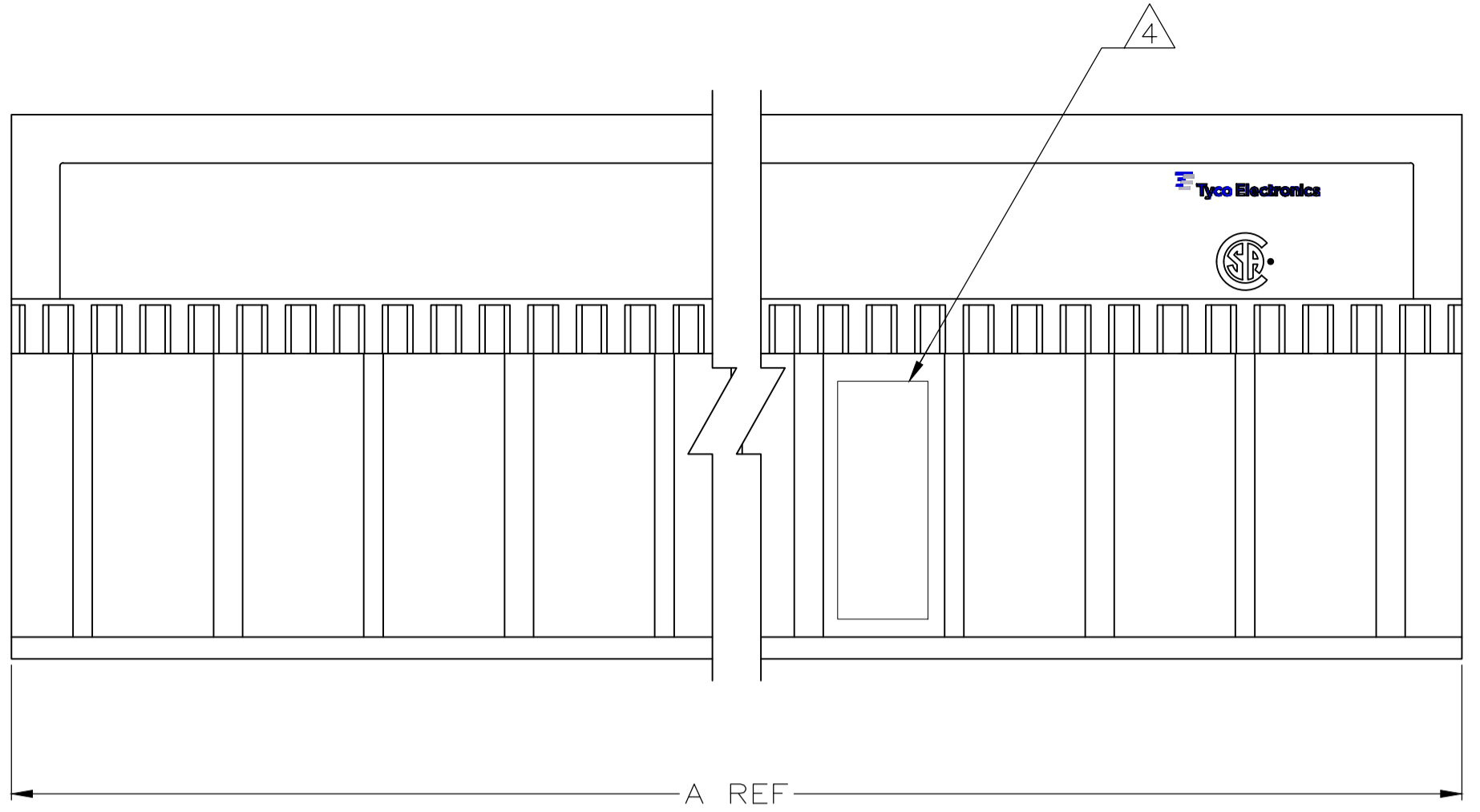

- ① HOUSING MATERIAL: LIQUID CRYSTAL POLYMER  
COLOR: NATURAL.
- ② CONTACT MATERIAL: PHOSPHOR-BRONZE.
- ③ CONTACT FINISH:(A)  
UNDERPLATE (ENTIRE CONTACT):  
0.00127 MIN NICKEL PER SAE-AMS-QQ-N-290  
ON MATING SURFACES:  
CONFORMS TO ALL TESTING SPECIFIED FOR TELCORDIA  
UNCONTROLLED ENVIRONMENT.  
ON LEADS:  
0.00381 MIN MATTE TIN PER ASTM B 545 OVER UNDERPLATE.  
LUBRICATION (MIN MATING SURFACES):  
SURFACE CONDITIONER AFTER PLATING.
- ④ PART MARKING LOCATED APPROXIMATELY AS SHOWN.
- ⑥ OBSOLETE PARTS: OBSOLETE CIS STREAMLINING PER D.RENAUD/D.SINISI
- ⑦ CONTACT FINISH:(A)  
UNDERPLATE (ENTIRE CONTACT):  
0.00127 MIN NICKEL PER SAE-AMS-QQ-N-290  
ON MATING SURFACES:  
0.00076 MIN GOLD PER ASTM B-488 OVER UNDERPLATE.  
ON LEADS:  
0.00381 MIN MATTE TIN PER ASTM B 545 OVER UNDERPLATE.  
LUBRICATION (MIN MATING SURFACES):  
SURFACE CONDITIONER AFTER PLATING.

OBSOLETE	YES	10	3	11.88	30	-3-5223004-1
	NO	130	65	131.88	330	-1-5223004-1
	NO	118	59	119.88	300	-1-5223004-0
OBSOLETE	NO	106	53	107.88	270	-5223004-9-
	NO	94	47	95.88	240	5223004-8
	NO	82	41	83.88	210	-5223004-7-
OBSOLETE	NO	70	35	71.88	180	-5223004-6-
	NO	58	29	59.88	150	5223004-5
	NO	46	23	47.88	120	5223004-4
	NO	34	17	35.88	90	5223004-3
	NO	22	11	23.88	60	5223004-2
	YES	10	3	11.88	30	5223004-1
		C	B	A	NO OF SIGNAL POSN	PART NUMBER

THIS DRAWING IS A CONTROLLED DOCUMENT.

DIMENSIONS: mm  
 TOLERANCES UNLESS OTHERWISE SPECIFIED:  
 0. PLC ± -  
 1. PLC ± -  
 2. PLC ± 0.13  
 3. PLC ± -  
 4. PLC ± -  
 ANGLES ± -

MATERIAL: ① ②  
 FINISH: ③ ⑤

WEIGHT: 0.000000  
 SIZE: A1  
 CUSTOMER DRAWING

DIN: B, MCMMASTER  
 CJK: R, WERTZ  
 APVD: R, WERTZ  
 NAME: ASSEMBLY, RECEPTACLE, SIGNAL, RIGHT ANGLE, Z-PACK 2mm FB, 5 ROW, SOLDER LEAD

DATE: 19NOV04  
 DATE: 19NOV04  
 DATE: 19NOV04

SCALE: 4:1  
 SHEET: 1 of 1  
 REV: B

RECOMMENDED CIRCUIT PATTERN  
PER IPC-D300 TYPE II, CLASS C  
(COMPONENT SIDE)