

ALL DIMENSIONS ARE IN mm										
Part Number	Class 2r Wire Size	Wire Strip Length	Panduit Die Index No. For Class 2r Wire Circumferential Dies	$l \pm 2.76$	$o \pm .50$	$i \pm .50$	$a \pm 2.25$	$b \pm 2.25$	$c \pm 2.25$	t
LCMA500-00-1	500mm ²	48.0	P125	121.0	40.00	31.00	46.5	57.5	54.0	8.90 ± .55
LCMA630-00-1	630mm ²	57.7	P125	132.0	44.00	34.50	56.2	63.0	56.0	9.40 ± .65

- NOTES:
1. Material: High conductivity seamless copper tube.
 2. Plating: Parts are annealed and tin plated.
 3. Wire Type: Class 2r Stranded Copper per DIN VDE 0295, IEC 60228 and HD 383.
 4. UL Listed Wire Connector: Yes, for applications up to 35kv. Consult cable manufacturer for voltage stress relief instructions with applications greater than 2000 volts.
 5. UL Temperature Rating: 90° C
 6. C.S.A. Certified Wire Connector: Yes

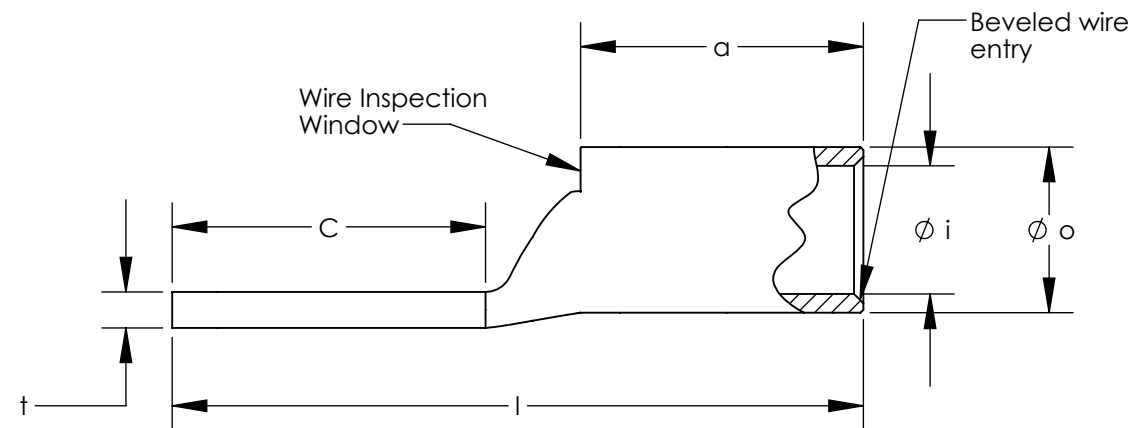

LISTED
Wire Connector

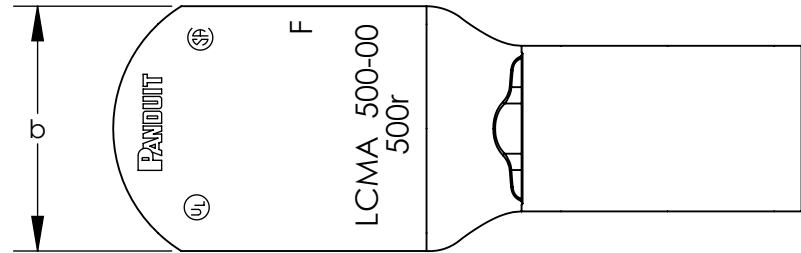

CERTIFIED

REV	DATE	BY	CHK	APR	DESCRIPTION	ECN
01	6/14	JHNU	TLCO	RGB	REVISED I DIM: LCMA500-00 WAS 120.0, LCMA630-00 WAS 131.0	13J059BH-JC
00	4/14	JHNU	TLCO	RGB	DRAWING RELEASED	

TITLE METRIC LUGS - LCMA BLANK TONGUE STANDARD BARREL CUSTOMER DRAWING			
ITEM REVISION NAME 12J059BH/01		PANDUIT	
DATASET FILE NAME 12J059BH-JC/01.SLDDRW			
UNLESS OTHERWISE SPECIFIED, DIMENSIONAL TOLERANCES ARE: IN [mm]			
.X ±	.XXX ±	THIRD ANGLE PROJECTION	
.XX ±	ANGLES ±		
DRAWN BY JHNU		DATE 12/13	CHK TLCO
SCALE NONE		DRAWING NUMBER 12J059BH-JC	
SHEET 1 OF 1			SIZE B