

THIS DRAWING IS UNPUBLISHED. RELEASED FOR PUBLICATION
 © COPYRIGHT BY TYCO ELECTRONICS CORPORATION. ALL RIGHTS RESERVED.

LOC	DIST	REVISIONS			
P	LTR	DESCRIPTION	DATE	DWN	APVD
AJ	16	0	REV PER EC-0S14-0496-04	01FEB2005	GA GM

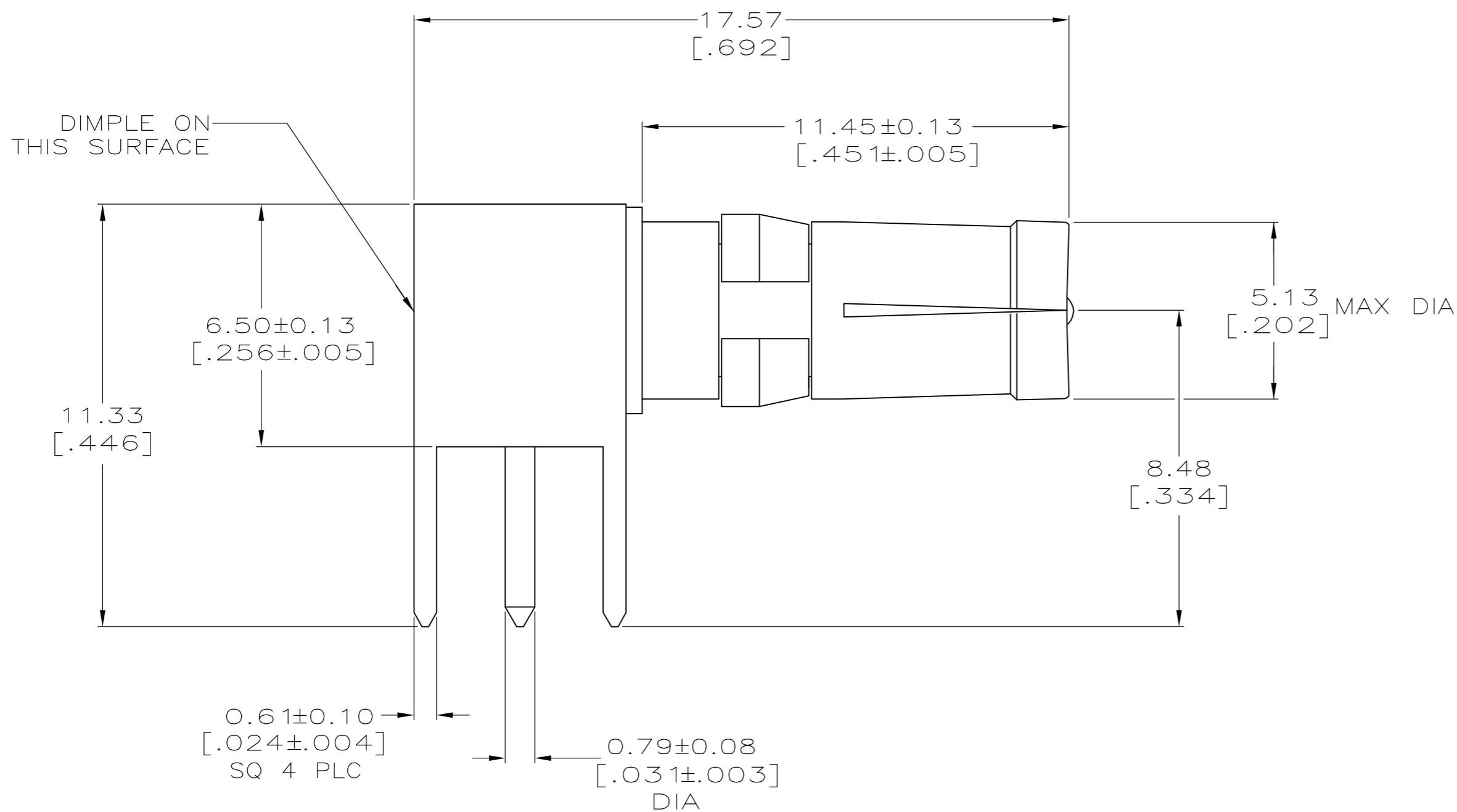

- ① BRASS PER QQ-B-626.
- ② PTFE PER MIL-P-19468.
- ③ PHOSPHOR BRONZE PER QQ-B-750.
- ④ BERYLLIUM COPPER PER QQ-C-530.
- ⑤ TIN PLATE PER ASTM-B-545.
- ⑥ COPPER PLATE PER MIL-C-14550.
- ⑦ NICKEL PLATE PER QQ-N-290.
- ⑧ GOLD PLATE PER MIL-G-45204.
- ⑨ DIELECTRIC AND CONTACT ASSEMBLY WILL WITHSTAND 2.5 LB PUSHOUT FORCE DIRECTED FROM MATING END.

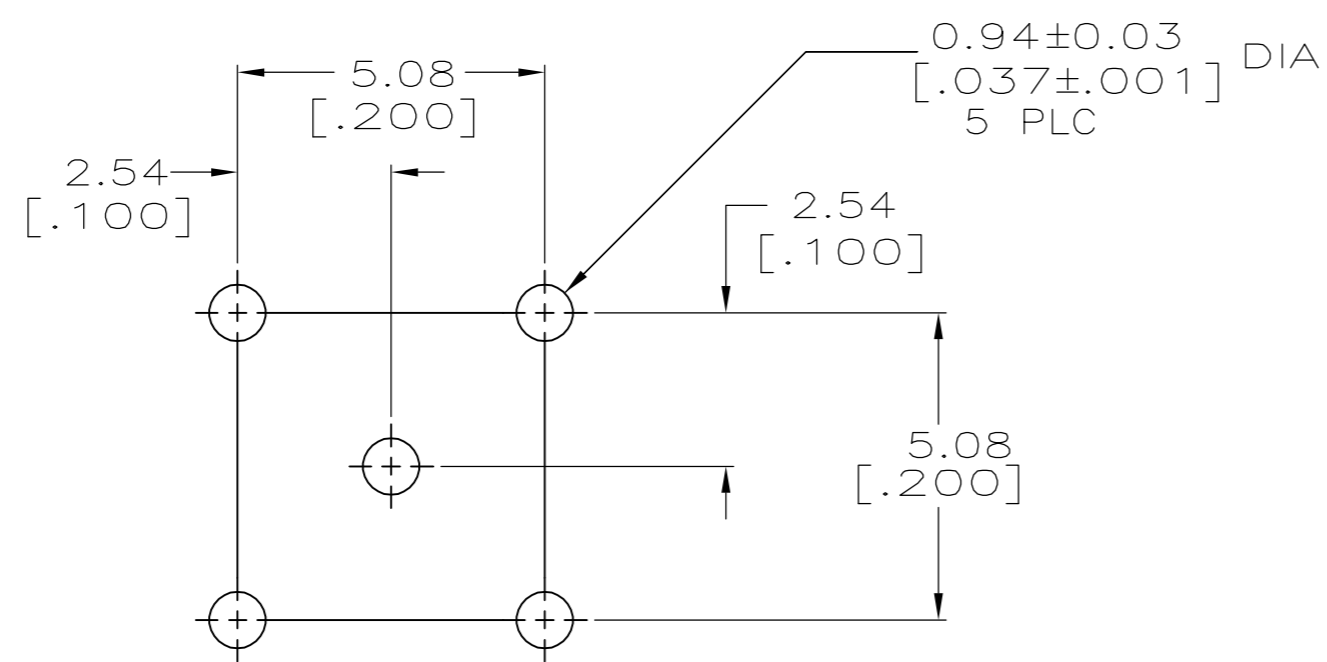

PCB CONFIGURATION

5414507-1
 PART NO

THIS DRAWING IS A CONTROLLED DOCUMENT.		DWN G. ATTADIA - 01FEB2005	Tyco Electronics Corporation Harrisburg, PA 17105-3608	
DIMENSIONS: INCHES		CHK J. HAVENER 01FEB2005		
TOLERANCES UNLESS OTHERWISE SPECIFIED:		APVD G. MICHAEL 01FEB2005	NAME SOCKET,PCB,RIGHT ANGLE SIZE 8, HDI	
0 PLC ± - 1 PLC ± - 2 PLC ± - 3 PLC ± .010 4 PLC ± - ANGLES ± 0° 30'		PRODUCT SPEC -	APPLICATION SPEC -	RESTRICTED TO -
MATERIAL		WEIGHT -	SIZE A2	CAGE CODE 00779
FINISH		DRAWING NO C=5414507		SCALE 8:1
		CUSTOMER DRAWING		SHEET 1 OF 1
				REV 0