

PART NUMBER	REV	FIRST USED	POWER UNIT	FEED TYPE	DESCRIPTION
1855251-1	A	122500-1	LEADMAKER	AIR FEED	CUTS CARRIER
1855251-2	A	565435-5	BENCH MODEL K	AIR FEED	CUTS CARRIER
1855251-3	A	354500-1	BENCH MODEL G	AIR FEED	CUTS CARRIER
1855251-6	A	122500-1	LEADMAKER	AIR FEED	CONTINUOUS CARRIER
7-1855251-7	A	-	-	-	SPARE PARTS

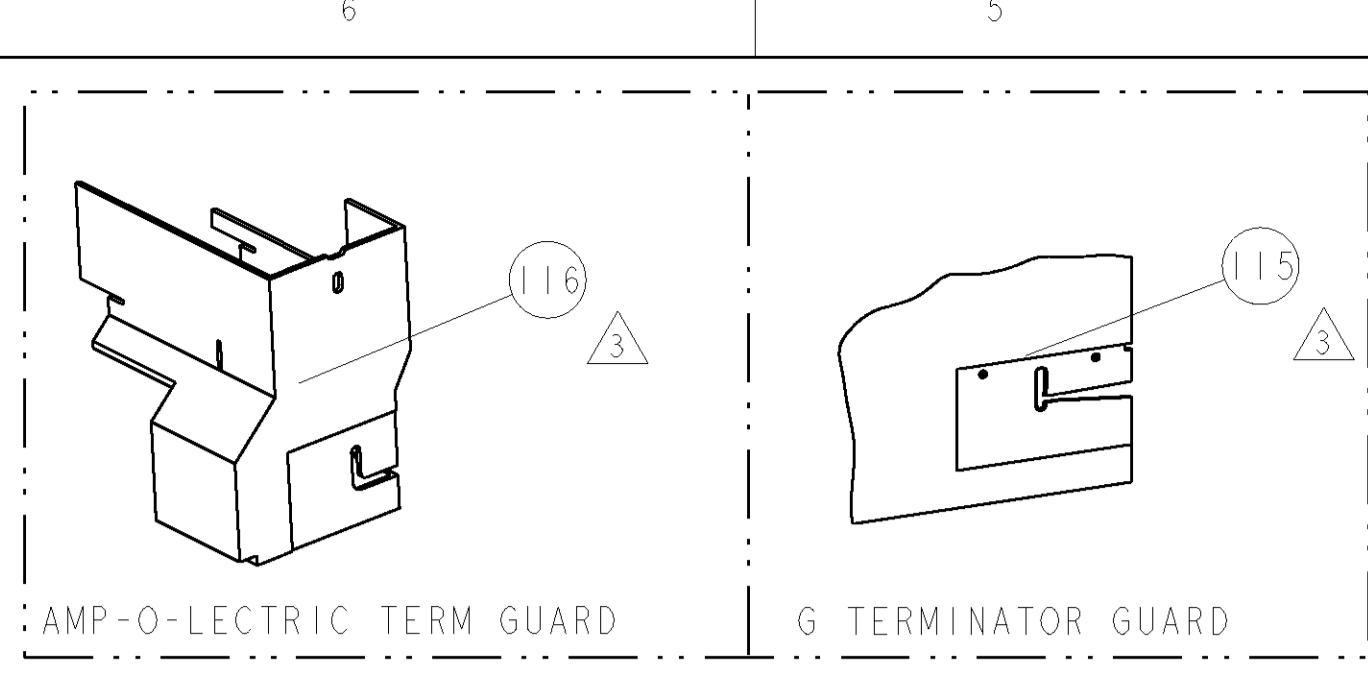

TERMINAL NAME: TERMINAL, POTTED W2 DOUBLE					
TYCO	MFR	CIC TERMINAL - AMP CRIMP SPECS			
1949328-1	13202310				
1948328-2	13202311				
1949328-3	1320313	1.78±0.05mm [1.070±.002]	(2) 18 AWG		C7
-	-	1.66±0.05mm [1.066±.002]	(2) 20 AWG		D4
-	-	-	-	-	-
-	-	-	-	-	-
-	-	CRIMP	SIZE	TYPE	RANGE
-	-	WIRE	2.54mm [1.00]	F	20-18 AWG
-	-	INSUL	3.81mm [1.150]	F	∅1.8mm Max
WIRE STRIP LENGTH	TERM APPL SPEC	FEED	APPLICATOR INSTRUCTIONS	SET UP GAGE	
2.9-3.3mm	NONE	19.05mm	408-8040	458637-1	

- △ RECOMMENDED SPARE PARTS
- △ GREASE LIGHTLY
- △ GUARD MUST BE IN PLACE WHEN OPERATING APPLICATOR IN A BENCH MACHINE
- △ WHEN RUNNING TERMINAL P/N 1949328-3 ITEM 34 IS REQUIRED. ITEM 34 IS NOT REQUIRED ON REMAINING TERMINALS.

*** WARNING**
ON INSTALLATION, SET WIRE DISC TO LARGEST WIRE SIZE SETTING. USE OF SETTINGS BELOW MIN. REQUIRED CRIMP HEIGHT SETTING WILL CAUSE DAMAGE TO CRIMP TOOLING.

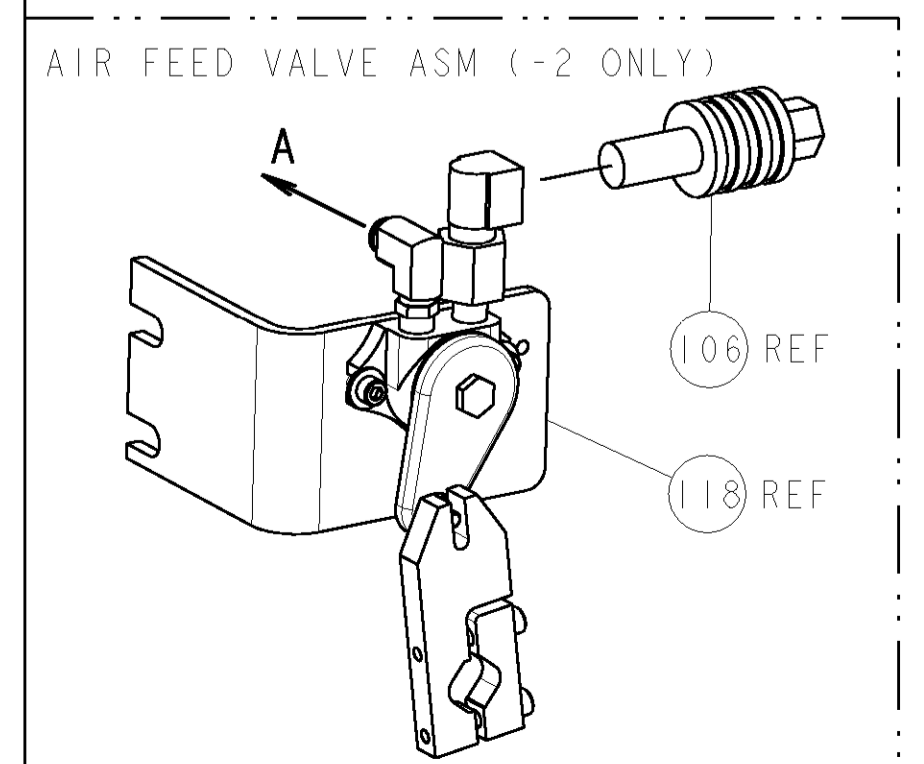
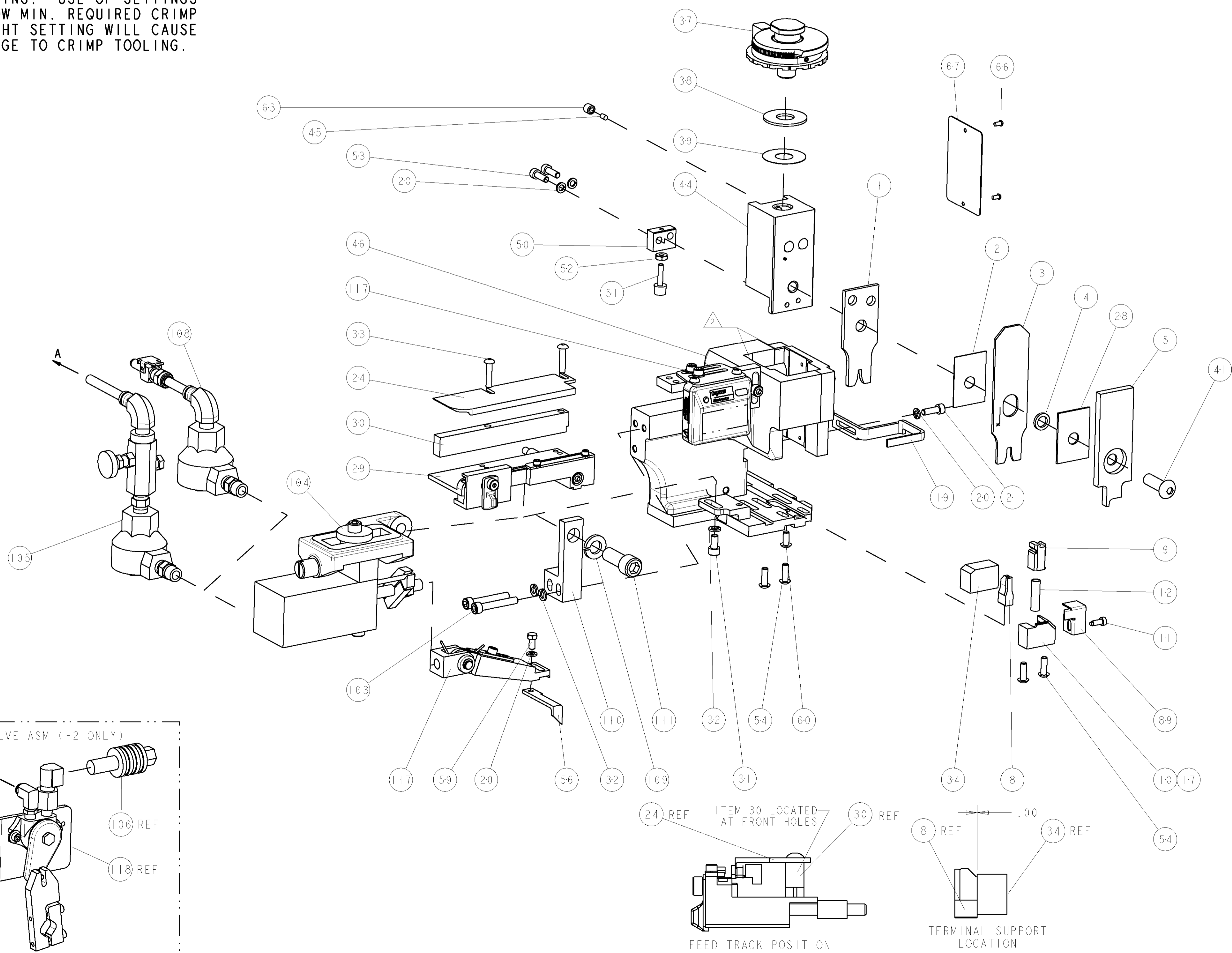

REF	QTY	DESCRIPTION	ITEM NO
-	-	692655-6 AIR FEED VALVE ASSEMBLY	118
-	1	461062-1 FEED FINGER ASSEMBLY	117
-	-	455749-1 GUARD WINDOW	116
-	-	679532-1 INSERT, GUARD	115
-	1	3-21001-5 SCR, SKT HD CAP 3/8-16 X 1.000	111
-	1	459610-3 MOUNT, FEED BRACKET	110
-	1	21024-8 WASHER, SPRG LOCK, REG 3/8	109
-	1	692655-7 AIR FEED VALVE ASSEMBLY	108
-	-	24024-2 VALVE, SHUT OFF	106
-	-	692655-5 AIR FEED VALVE ASSEMBLY	105
-	1	461065-1 ASSEMBLY, AIR FEED	104
-	2	4-21000-0 SCR, SKT HD CAP 10-32 X 1.250	103
-	1	318563-1 GUARD, FRONT CHIP	89
-	1	4088040 SF APPL INST 408-8040	72
-	1	217238-1 GENERAL INSTRUCTION PKG	71
-	1	461264-5 PLATE, IDENTIFICATION	67
-	2	21017-2 SCREW, DRIVE	66
-	1	21009-2 SCR, SET, SELF LOCKING 1/4-20 X .250	63
-	1	22733-8 SCR, BHSC, SELF-LOCKING, 8-32 X .375	60
-	1	2-22603-0 SCR, HEX HD CAP 8-32 X .312	59
-	1	458537-2 PAWL, FEED	56
-	4	2-21002-2 SCR, BTN SKT HD CAP 8-32 X .500	54
-	2	2-21000-7 SCR, SKT HD CAP 8-32 X .500	53
-	1	21018-5 NUT, HEX, REG 6-32	52
-	1	811242-2 BUMPER, HOLD DOWN	51
-	1	690753-1 SPACER, TONKER	50
-	1	1633399-1 APPL., BASIC AIR FEED SUB ASSY	46
-	1	690191-1 PLUG, NYLON	45
-	1	1-455673-4 RAM, SIDE FEED	44
-	1	7-21002-9 SCR, BTN SKT HD CAP 5/16-24 X 1.00	41
-	1	690125-1 SHIM SUB-ASSY	39
-	1	1-469367-4 SHIM	38
-	1	879103-2 FINE ADJUST HEAD ASSEMBLY	37
-	1	5-690786-4 TERMINAL SUPPORT	34
-	2	2-21002-4 SCR, BTN SKT HD CAP 8-32 X .750	33
-	3	21024-5 WASHER, SPRG LOCK, REG NO 10	32
-	1	3-21000-4 SCR, SKT HD CAP 10-32 X .375	31
-	1	1-1320908-0 SPACER, STRIP GUIDE	30
-	1	1633091-1 ASSEMBLY, STRIP GUIDE	29
-	1	1-455888-0 SPACER, CRIMPER	28
-	1	1-1320928-3 PLATE, STRIP GUIDE	24
-	1	2-21000-7 SCR, SKT HD CAP 8-32 X .500	21
-	4	21024-4 WASHER, SPRG LOCK, REG NO 8	20
-	1	456468-5 STRIPPER, SPECIAL	19
-	1	679625-1 SHEAR HOLDER, FRONT (NO CUT)	17
-	1	3-22280-3 SPRING, COMPRESSION	12
-	1	690461-1 STOP, SHEAR	11
-	-	690459-1 SHEAR HOLDER, FRONT	10
-	1	454276-1 FLOATING SHEAR, FRONT	9
-	1	1-1633111-8 ANVIL, COMBINATION .100	8
-	1	1-455889-4 DEPRESSOR, SHEAR	5
-	1	238011-6 BLOCK, CRIMPER SPACER	4
-	1	4-683453-6 CRIMPER, INSULATION PREMIUM	3
-	1	455888-4 SPACER, CRIMPER	2
-	1	2-1490019-1 CRIMPER, WIRE PREMIUM	1

INCHES	TOLERANCES UNLESS OTHERWISE SPECIFIED:	FINISH	WEIGHT	CUSTOMER DRAWING
0 PLC	±			
1 PLC	±0.1			
2 PLC	±0.01			
3 PLC	±0.001			
4 PLC	±0.0001			
ANGLES	±			

CUSTOMER VIEWABLE ASSEMBLY