

| REV | ECN | APPD |
|-----|------|-------------|
| M | 5910 | RS 7/27/06 |
| N | 5979 | JT 11/16/06 |
| 0 | 6027 | |

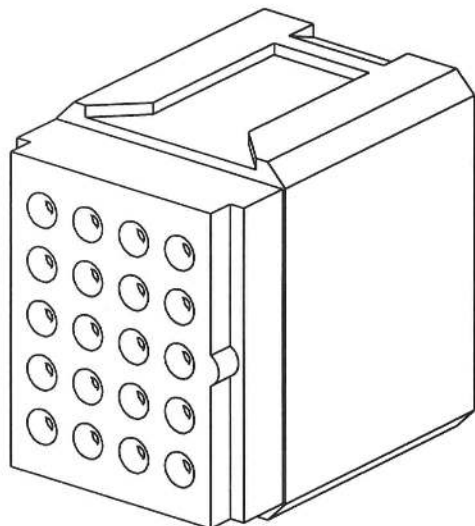

.030±.010 TYP

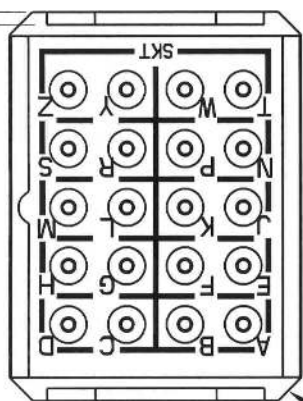

.225±.018

.040 X 45° ±.005 TYP.

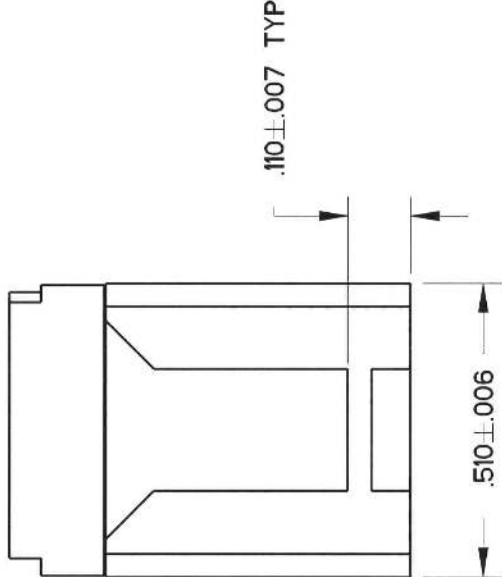
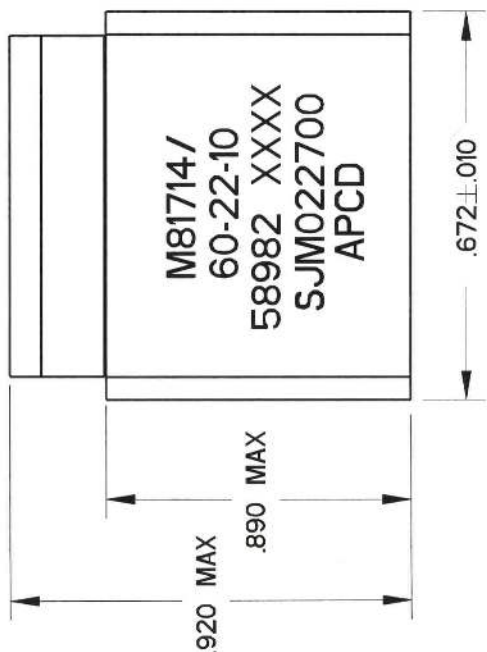

- NOTES:
- PART MEETS ALL REQUIREMENTS OF MIL-T-81714/60
 - MATERIALS:
GROMMET - SILICONE RUBBER PER A-A-59588
BODY - POLYETHERIMIDE PER ASTM-D-5205
INTERNAL CONTACT - BRASS PER ASTM-B16, GOLD PLATED PER SAE-AMS-2422
CONTACT RETAINER CLIPS - STAINLESS STEEL PER ASTM-A666
 - PART ACCEPTS M39029/22-191 SOCKET CONTACTS. SEE TABLE

| APCD P/N | SUPPLIED | | MARKING | |
|-----------|----------|-------|---------------|-----------------|
| | SKTS | PLUGS | APCD PART NO. | MIL. NO. |
| SJM022700 | 21 | 2 | SJM022700 | M81714/60-22-10 |
| SJM022701 | - | - | | |

| | | | |
|--|--|--|-------------------------------------|
| <p>Amphenol Pcd SPECIFICATION DRAWING</p> | | <p>SOCKET JUNCTION MODULE SIZE 22, 10-BUS</p> | |
| <p>DRWN R. SWAINE 9/25/06</p> | <p>ENGR R. NEWMAN 11/15/06</p> | <p>SIZE B</p> | <p>DWG NO. SJM022700</p> |
| <p>DIMENSIONS ANSI Y14.5M UNITS: INCHES Pro/E FILE</p> | | <p>TOLERANCES .XX ±0.01 .XXX ±0.005 ANGLES ±2.0°</p> | |
| <p>PROJECTION </p> | | <p>THIS DOCUMENT CONTAINS PROPRIETARY INFORMATION WHICH IS THE CONFIDENTIAL PROPERTY OF AMPHENOL PCD INC., PEABODY, MA</p> | |
| <p>ORIGINAL </p> | | <p>CODE: 58982</p> | <p>SCALE: 3:1</p> |
| | | <p>SHEET 1 OF 1</p> | <p>REV 0</p> |