

TYPE A
58721-0010

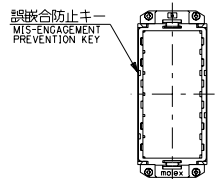

TYPE B
58721-0020

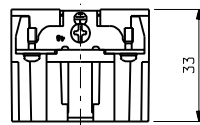

部番 NO.	部品名 PART NAME	数量 QTY.	材質 MATERIAL	記事 ARTICLE
①	プラグシェル PLUG SHELL	1	アルミニウム合金 ALUMINUM ALLOY	—
②	M2.5×8 パナ座金付ねじ M2.5X8 SCREW	4	鋼 STEEL	Ni ヌッキ NI PLATING
③	M3×5 パナ座金付ねじ M3X5 SCREW	2	鋼 STEEL	Ni ヌッキ NI PLATING
④	グラウンドターミナル GROUND TERMINAL	2	黄銅 BRASS	Ni ヌッキ NI PLATING

注記:
NOTES:

1. 適用ハウジングとターミナル
APPLICATION HOUSING AND TERMINAL

	適用ハウジング APPLICATION HOUSING	ターミナル TERMINAL
ピンハウジング PIN HOUSING	51194-0800	50638-9*49 Au PLATING
ソケットハウジング SOCKET HOUSING	51195-0800	59320-9*90 Au PLATING
ピンハウジング PIN HOUSING	51203-1200	50637-0*49 Au PLATING
ソケットハウジング SOCKET HOUSING	51204-1200	59319-0*90 Au PLATING
		5558-GS* Au PLATING
		5556GS** Au PLATING

2. M3ねじ推奨締付トルク: 5~6kpf.cm
M3 SCREW RECOMMENDATION TIGHTENING TORQUE.

DO NOT SCALE DRAWING

EC NO. DRAWN CHKD. APPR.	EC NO. DRAWN CHKD. APPR.	EC NO. JD91218 '98/03/08 DRAWN: SAKIYAMA CHKD: Y.IITO APPR: HIKE-SUGI	EC NO. JD90894 '98/02/23 DRAWN: Y. TETSUKA CHKD: SAKIYAMA/Y.IITO APPR: HIKE-SUGI	RELEASED EC NO. JD90402 '98/08/21 DRAWN: SAKIYAMA CHKD: Y.IITO APPR: HIKE-SUGI	MATERIAL 材料
		REVISED	REVISED		
					FINISH 仕上げ
					WIRE RANGE 適用電線範囲
					INS. RANGE 適用絶縁径

GENERAL TOLERANCES: (UNLESS SPECIFIED) 一般公差	SCALE 1:1	DESIGN UNITS mm □ INCH	THIRD ANGLE PROJECTION	DIMENSIONS: mm □ INCH mm ONLY	SHT REVISE ON CAD ONLY
10 UNDER 未注	+0.2	DRAWN BY & DATE S. Akiyama '98/09/14	TITLE: POWER CONN 48P PLUG SHELL ASS'Y		
10 OVER 30 UNDER 未注	+0.25	CHECKED BY & DATE Y. Ito '98/09/21			
30 OVER 未注	+0.3	APPROVED BY & DATE Y. Ito '98/09/21			
ANGLE 角度	+3'	CAD FILE NAME 58721002.S01	MATERIAL NO. SEE CHART	DRAWING NO. SD-58721-002	SHEET NO. 1 OF 1

THIS DRAWING CONTAINS INFORMATION THAT IS PROPRIETARY TO MOLEX INCORPORATED AND SHOULD NOT BE USED WITHOUT WRITTEN PERMISSION.		SIZE B
--	--	-----------

B	58721-0020	58721-00*0
A	58721-0010	
TYPE	MATERIAL NO.	MODEL NO.