

PC CARD DRILLING DIMENSIONS
Components side view - Thickness 1.60mm

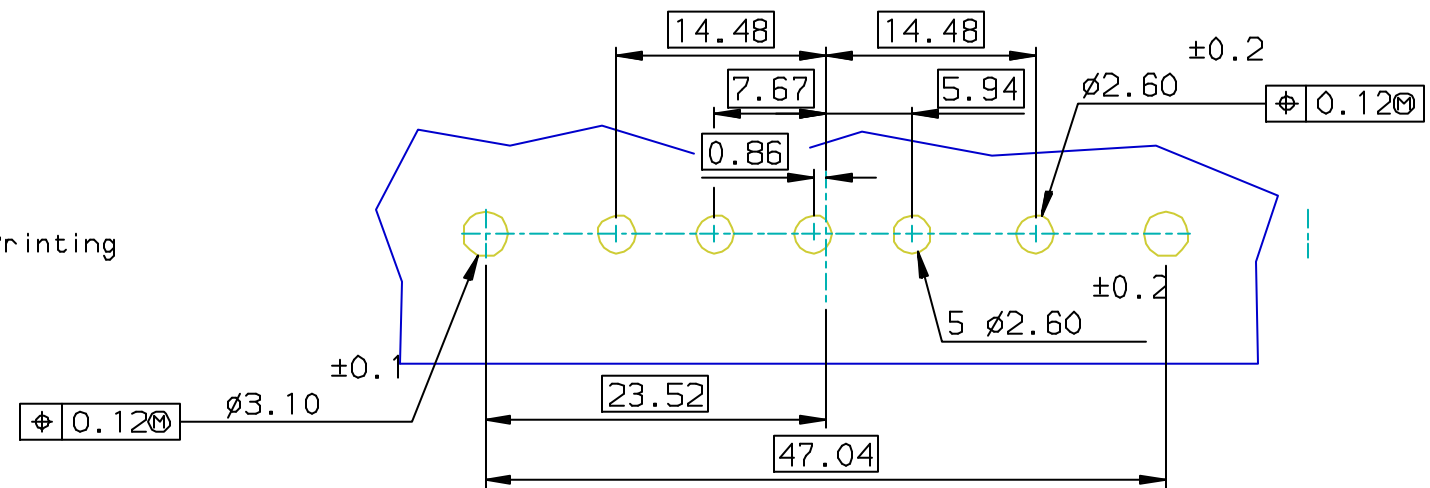
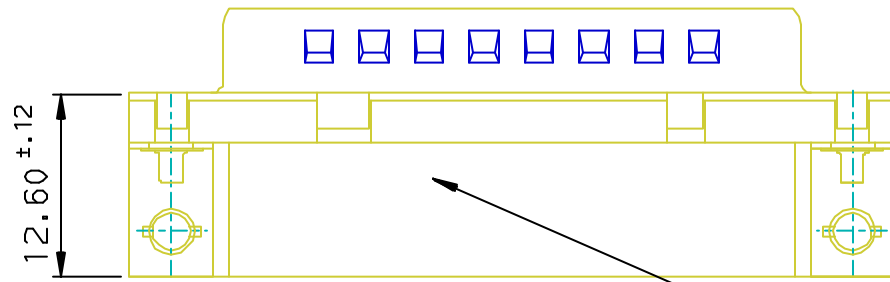

LF FOR LEAD FREE

FOR ROHS DETAILS REFER DWG.NO:C01-8646-0000

REQUIREMENTS

Technical characteristics:

- Shell: steel tin/Zinc Cr3 plated
- Insulators: self-extinguishing thermoplastic, ULclass94V0
- Contacts: brass, 0.76µ Au +2µ Ni mini on mating end and 2µ SnPb +1.27 Ni mini on termination end
- Grounding brackets: brass, tin/Zinc Cr3 plated
- Female screwlock: brass, tin/Zinc Cr3 plated
- Harpoon: brass, tin plated

Electrical characteristics:

- max.current rating: 30A per contact
- Test voltage: 1000V
- Rated voltage: 300V
- Contact resistance: ≤5mΩ
- Shell resistance: ≤5mΩ
- Insulation resistance: ≥5000MΩ

Climatic characteristics:

- Operating temperature range: -55°C +125°C

Dimensions:

- in accordance with MIL-C-24308

Part number **D5WSP36AGL3B** European Views

rev	ecn no	dr	date
C	105-0124	JS	2005/07/27
D	106-0074	SK	2006/06/08
-	-	-	-
-	-	-	-
-	-	-	-
-	-	-	-

www.fciconnect.com		surface ISO 1302 ✓	tolerance std ISO 406 ISO 1101	projection mm
TOLERANCES UNLESS OTHERWISE SPECIFIED				
Dr	JOHN SLEEBA	1994/12/13	ANGULAR	0.X ±0.1
Eng	GEORGE VJ	1994/12/13	LINEAR	0.XX ±0.1
Chr	GEORGE VJ	2005/07/27	0.XX* ±1*	0.XXX ±0.1
Appr	KVSD	2005/07/27	Product family	D-SUB Spec ref -
FCI		title MALE CONNECT. 5W5 + POWER CONTACTS metal plate, harpoons, screwlock M3		Rev. D
catalog no DELTA-D		dwg no C01-8646-0336		sheet 1 of 1



Copyright FCI.