

NOTES:

1 MATERIAL: THERMOPLASTIC GLASS-FILLED, U194V-0

CONTACTS: PHOSPHOR BRONZE

2 DIMENSION OF MATING AND TERMINATION MATING TERMINATION

LENGTH / WIDTH x THICKNESS LENGTH

A: 5.3 / 0.4 - 0.50 x 0.4 - 0.36 3.7

B: 6.8 / 0.4 - 0.50 x 0.4 - 0.36 3.7

C: 8.3 / 0.4 - 0.50 x 0.4 - 0.36 3.7

3 FINISH

30u" (0.75um) GOLD PLATING ON CONTACT AREA, TIN-PLATED ON TAIL, UNDER PLATING NICKEL ALL OVER

4 MARKING: SULLINS

PART NUMBER

MFG CODE/BATCH NUMBER

ON THE APPROXIMATE AREA AS DRAWING

CONTACT DIMENSION

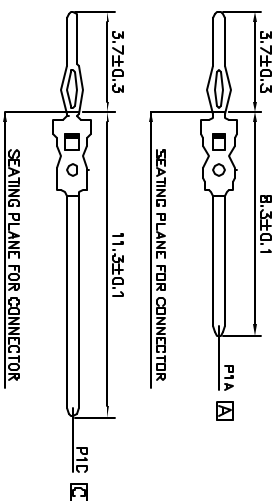

DESCRIPTION : 2.0mm MALE, TYPE C

PRODUCT

NO.1	2CM77P1001-1-H			
NO.2		m/m	QWTF103A	
NO.3				
NO.4				TA0115