

NOTES

- PLEASE SEE SHEET 2 FOR CURRENTLY CONFIGURED PART NUMBERS. FOR SPECIFIC PART NUMBERS PLEASE CONTACT SALES OR CONSULT THE INTELLIGENT PART NUMBERS IN THE TABLE ATTACHED.
- EARTH POSITION SHOWN, H12
- FOR PACKAGING SEE PACKAGING SPEC PK-121024-C05
- PRODUCT SPEC: SEE PS-121201-001
- PART NO 1210230093 SHOWN FOR ILLUSTRATION PURPOSES ONLY

LAST INSPECTION NUMBER USED: 2

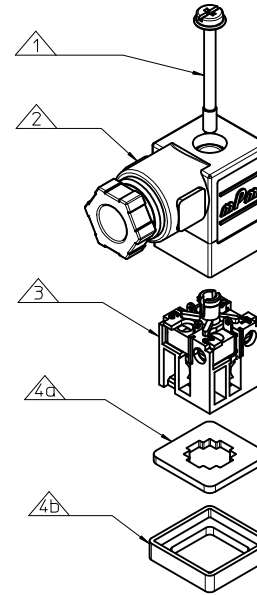

ITEM	DESCRIPTION
1	SCREW
2	COVER ASSEMBLY
3	INSERT ASSEMBLY
4a	FLAT GASKET
4b	PROFILE GASKET

C05307N22**

SERIES
C05= INTERNAL THREAD FORM C
POLES
2= 2 POLE & 3= 3 POLE
THREAD
07= PG7, M2= M12x1.5
MATERIAL AND HOUSING COLOUR
G= PA6 GRAY, N= PA6 BLACK, W= PA6 BLACK V0, T= TRANSPARENT
EARTH PIN POSITION
0= UNMOUNTED, 2= H12, 3= H3, 6= H6, 9= H9

SCREW AND GASKET
1= NBR PROFILE GASKET & SCREW
2= NBR FLAT GASKET & SCREW
3= WHITE SILICON PROFILE GASKET & SCREW
4= WHITE SILICON FLAT GASKET & SCREW

NON STANDARD COMPONENTS
14= SINGLE PACKED IN NEUTRAL BAG
5J= SINGLE PACKED
5S= SINGLE PACKED
6X= WITHOUT RING NUT AND CABLE FIXING NUT

ADDED PART NUMBERS EC NO: IPG2012-0757 DRAWN: DSHEA 2012/04/19 CHKD: SMCREVEY 2012/04/24 APPR: EFOLAN 2012/04/30	QUALITY SYMBOLS ▽=0 ▽=0	GENERAL TOLERANCES (UNLESS SPECIFIED)		DIMENSION STYLE MM ONLY	SCALE 2:1	DESIGN UNITS METRIC	THIRD ANGLE PROJECTION
		4 PLACES ± --- ± --- 3 PLACES ± --- ± --- 2 PLACES ± 0.10 ± --- 1 PLACE ± 0.2 ± --- ANGULAR ± ---°	mm INCH ± --- ± --- ± --- ± --- ± --- ± ---	DRAWN BY DSHEA DATE 2011/05/20 CHECKED BY DMAHER DATE 2011/05/27 APPROVED BY EFOLAN DATE 2011/06/08	TITLE INTERNAL THREAD C05 SERIES	MOLEX INCORPORATED	
DRAFT WHERE APPLICABLE MUST REMAIN WITHIN DIMENSIONS		THIS DRAWING CONTAINS INFORMATION THAT IS PROPRIETARY TO MOLEX INCORPORATED AND SHOULD NOT BE USED WITHOUT WRITTEN PERMISSION					

PART NO	mPm NO	DESCRIPTION
1210230082	C05207G62	TYPE C 2P PG7 GRAY NBR FLAT GASKET
1210230083	C05207N21	TYPE C 2P PG7 BLACK NBR PROFILE GASKET
1210230084	C05207N22	TYPE C 2P PG7 BLACK NBR FLAT GASKET
1210230087	C05207T22	TYPE C 2P PG7 TRANSPARENT NBR FLAT GASKET
1210230093	C05307N22	TYPE C 3P PG7 BLACK NBR FLAT GASKET
1210230095	C05307T22	TYPE C 3P PG7 TRANSPARENT NBR FLAT GASKET
1210230684	C05307N21	TYPE C 3P PG7 BLACK NBR PROFILE GASKET
1210230691	C052M2N21	TYPE C 2P M12x1.5 BLACK NBR PROFILE GASKET
1210230713	C05207N626X	TYPE C 2P PG7 BLACK NBR FLAT GASKET NO RING NUT OR CABLE FIXING NUT
1210230775	C052M2N62	TYPE C 2P M12x1.5 BLACK NBR FLAT GASKET
1210230779	C053M2N62	TYPE C 3P M12x1.5 BLACK NBR FLAT GASKET
1210230824	C053M2N21	TYPE C 3P M12x1.5 BLACK NBR PROFILE GASKET
1210240019	C05207G625J	TYPE C 2P PG7 GRAY NBR FLAT GASKET SINGLE BAGGED
1210240022	C05207N625S	TYPE C 2P PG7 BLACK NBR FLAT GASKET SINGLE BAGGED
1210240503	C05207N6214	TYPE C 2P PG7 BLACK NBR FLAT GASKET SINGLE BAGGED IN NEUTRAL BAG
1210230085	C05207N62	TYPE C 2P PG7 BLACK NBR FLAT GASKET
1210230094	C05307N62	TYPE C 3P PG7 BLACK NBR FLAT GASKET
1210230670	C05307N61	TYPE C 3P PG7 BLACK NBR PROFILE GASKET
1210230088	C05207T62	TYPE C 2P PG7 TRANSPARENT NBR FLAT GASKET
1210240946	C05207N61	TYPE C 2P PG7 BLACK NBR PROFILE GASKET
1210240947	C05207N63	TYPE C 2P PG7 BLACK SILICONE PROFILE GASKET

SEE SHEET 1 EC NO: IPG2012-0757 DRAWN BY: OSHEA 2012/04/19 CHKD: SMCREVEY 2012/04/24 APPR: EFOLAN 2012/04/30	QUALITY SYMBOLS	GENERAL TOLERANCES (UNLESS SPECIFIED)	DIMENSION STYLE	SCALE	DESIGN UNITS	THIRD ANGLE PROJECTION																		
	$\nabla=0$ $\nabla=0$	<table border="1"> <tr><th colspan="2">mm</th><th>INCH</th></tr> <tr><td>4 PLACES</td><td>± ---</td><td>± ---</td></tr> <tr><td>3 PLACES</td><td>± ---</td><td>± ---</td></tr> <tr><td>2 PLACES</td><td>± 0.10</td><td>± ---</td></tr> <tr><td>1 PLACE</td><td>± 0.2</td><td>± ---</td></tr> <tr><td colspan="2">ANGULAR</td><td>± ---°</td></tr> </table>	mm		INCH	4 PLACES	± ---	± ---	3 PLACES	± ---	± ---	2 PLACES	± 0.10	± ---	1 PLACE	± 0.2	± ---	ANGULAR		± ---°	MM ONLY DRAWN BY: OSHEA 2011/05/20 CHECKED BY: DMAHER 2011/05/27 APPROVED BY: EFOLAN 2011/06/08	2:1	METRIC	INTERNAL THREAD C05 SERIES
	mm		INCH																					
	4 PLACES	± ---	± ---																					
3 PLACES	± ---	± ---																						
2 PLACES	± 0.10	± ---																						
1 PLACE	± 0.2	± ---																						
ANGULAR		± ---°																						
DRAFT WHERE APPLICABLE MUST REMAIN WITHIN DIMENSIONS	SEE TABLE	MATERIAL NO.	DOCUMENT NO.	MOLEX INCORPORATED		SHEET NO. 2 OF 2																		
		THIS DRAWING CONTAINS INFORMATION THAT IS PROPRIETARY TO MOLEX INCORPORATED AND SHOULD NOT BE USED WITHOUT WRITTEN PERMISSION																						