

MECHANICAL:

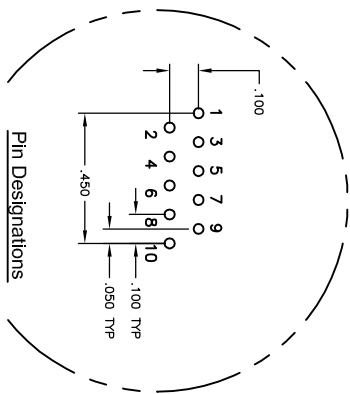

ELECTRICAL:

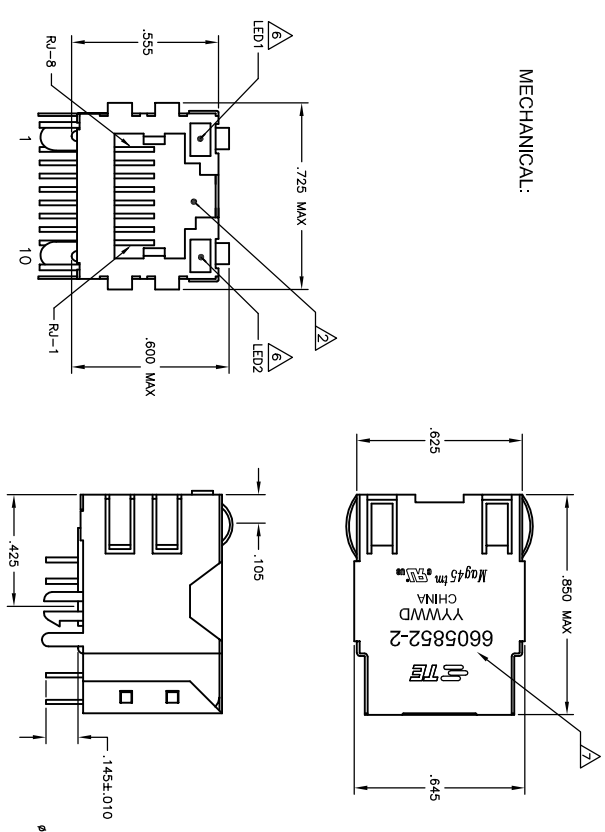
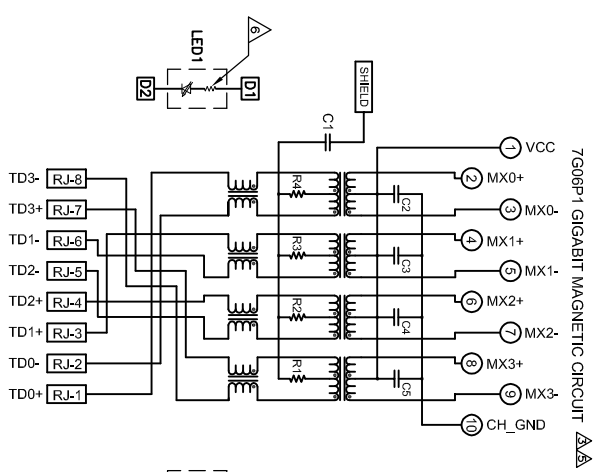

C1 = 1000 pF, 2kV CAPACITOR
 R1-R4 = 75 OHMS, 1/16 W RESISTORS
 C2-C5 = 0.1uF, 10%, 50V, X7R CAPACITORS

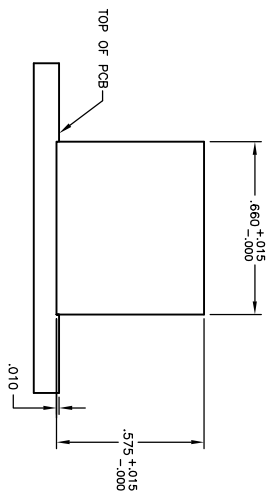
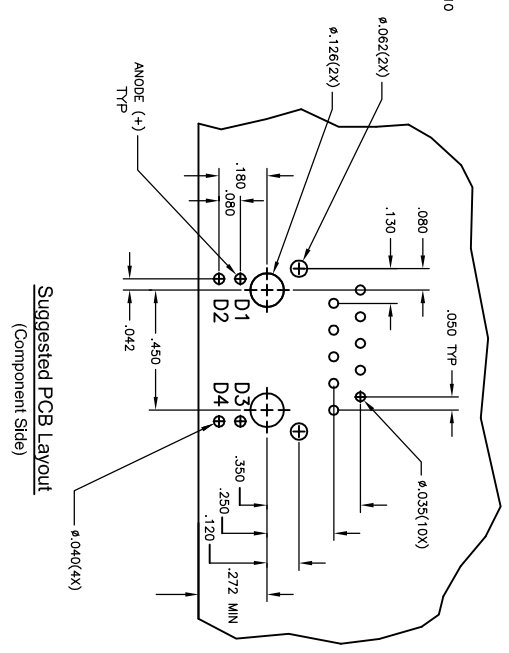

MATERIALS:
 -HOUSING - THERMOPLASTIC PET POLYESTER FLAMMABILITY RATING UL 94V-0
 -SHIELD - 010" THICK, C26800 BRASS PREPLATED WITH 30µINCH MIN SEMI-BRIGHT NICKEL, SOLDER TABS POST DIPPED WITH 100µINCH MIN SAC SOLDER
 -MOD JACK CONTACTS - 0.0157" x 0.018" PHOSPHOR BRONZE, 50µINCH MIN OVERALL NICKEL UNDERPLATE, WITH SELECT 50µINCH MIN HARD GOLD FINISH PLATE
 -SOLDER TABS WITH 100µINCH MIN MATE TIN AND/OR SAC SOLDER DIP
 -LIGHT EMITTING DIODE(LED) - DIFFUSED EPOXY LENS, 020" x 020" CARBON STEEL WIREFRAME LEADS PRE-PLATED WITH 80µINCH SILVER OVER 40µINCH NICKEL UNDERPLATE OVER 40µINCH COPPER UNDERPLATE, POST-PLATED WITH 100µINCH MIN MATE TIN AND/OR SAC SOLDER DIP OR PURE TIN SOLDER DIP
 -PINS: JACK CAVITY CONFORMS TO FCC RULES AND REGULATIONS PART 68, SUB PART 7

MAGNETICS:
 -IMPEDANCE: 100 OHMS
 -TURNS RATIO (CABLE): 1:1 ALL FOUR PAIRS
 -OPEN CIRCUIT INDUCTANCE (OCL): 350pH MIN @100MHz, 0.1VRRMS, 8mA DC BIAS FROM 0°C TO 70°C, ALL FOUR PAIRS
 -ALL FOUR PAIRS BI-DIRECTIONAL
 -PERFORMANCE @ 25°C
 INSERTION LOSS (IL): 1.1dB MAX FROM 0.5MHz TO 100MHz
 RETURN LOSS (RL): 18dB MIN FROM 0.5MHz TO 40MHz
 12-20LOG(F/80)DB MIN FROM 4.0 MHz TO 100MHz
 CROSSTALK ATTENUATION: 35dB MIN FROM 0.5MHz TO 40MHz
 33-20*LOG(F/50)DB MIN FROM 4.0 MHz TO 100MHz
 COMMON MODE REJECTION RATIO (CMRR): 30dB MIN FROM 0.5MHz TO 100MHz
 -ISOLATION VOLTAGE(25VDC (MAX)) FOR 60 SECONDS WITH A RISE TIME OF 500V/SEC

4. OPERATING TEMPERATURE: FROM 0°C - +70°C
 5. THE MAGNETICS ARE SYMMETRICAL, AND SUPPORTS AUTO-MD/MDX.
 6. LEADS WITH BUILT-IN RESISTOR
 LEADS ARE DRIVEN WITH 5V VOLTAGE AND THE MAX OPERATING CURRENT IS 20mA.
 LED COLOR: DOMINANT WAVELENGTH (NM): GREEN 568 nm TYP @ VF=5V
 FORWARD CURRENT (IF): GREEN 75mA TYP @ VF=5V
 DOMINANT WAVELENGTH (NM): YELLOW 588 nm TYP @ VF=5V
 FORWARD CURRENT (IF): YELLOW 15mA TYP @ VF=5V

THIS DRAWING IS A CONTROLLED DOCUMENT.

REVISION	DATE	DESCRIPTION	BY	CHK
1	10/21/10	1X1 MAG45(N), 7G06P1 GIGABIT ETHERNET SCHEMATIC, 7G06P1 MAGNETIC CIRCUIT, SHIELD, DECOUPLING CAPACITOR, WITH RESISTOR LEADS	HOWARTH	EL

DATE: 10/21/10
 DRAWN BY: HOWARTH, EL
 CHECKED BY: HOWARTH, EL
 CUSTOMER DRAWING: A1100779C-6605852

GREEN	GREEN	1-6605852-1
YELLOW	GREEN	6605852-2

LED1
 LED2

STE TE Connectivity