

THIS DRAWING IS UNPUBLISHED.

RELEASED FOR PUBLICATION

© COPYRIGHT - TE Connectivity Ltd.

ALL RIGHTS RESERVED.

REVISIONS

| P | LTR | DESCRIPTION | DATE | DWN | APVD |
|---|-----|----------------------------|-----------|-----|------|
| P | | CUTTING BURR DETAILS ADDED | 19NOV2018 | RK | PS |

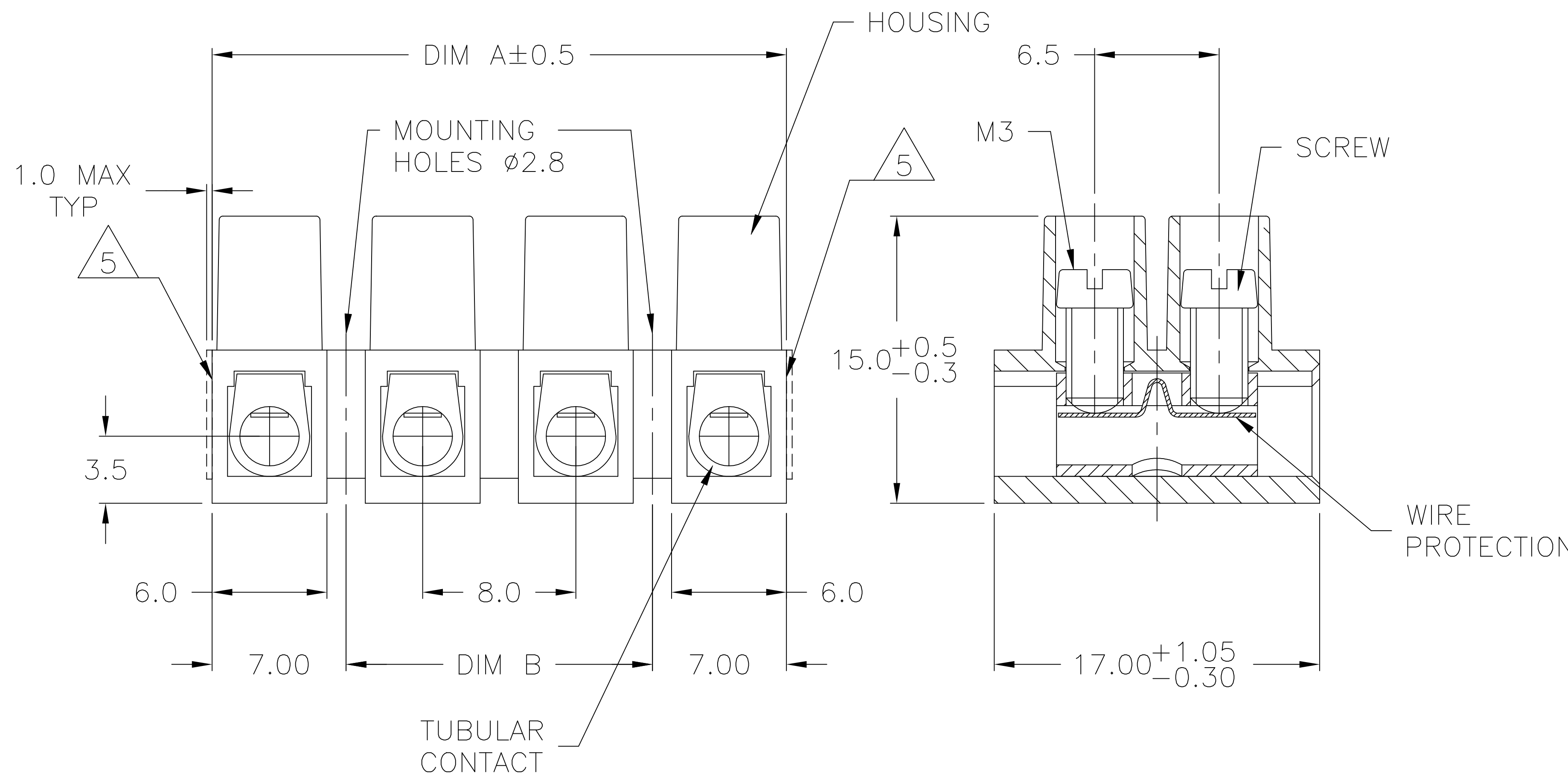

1. MATERIAL:
HOUSING: POLYAMIDE 6 UL94V-0.
COLOR: BROWN.
TUBULAR CONTACT: BRASS TIN PLATED.
SCREW: STEEL M3 ZINC W/ NON-HEXAVALENT CHROMATE (CHROME III).
WIRE PROTECTOR: STAINLESS STEEL.
2. ELECTRICAL:
CURRENT RATING: 30A.
OPERATING VOLTAGE: 250V.
WIRE RANGE: 12-26 AWG.
3. ENVIRONMENTAL:
CONTINUOUS WORKING TEMP.: -35°C TO +150°C.
- 4 MARKED WITH PERMANENT INK.
- 5 CUTTING PROJECTION CAN BE ON BOTH SIDES DEPENDING ON CUTTING LOCATION.
6. CUTTING BURR MAX. 1mm ALLOWED.

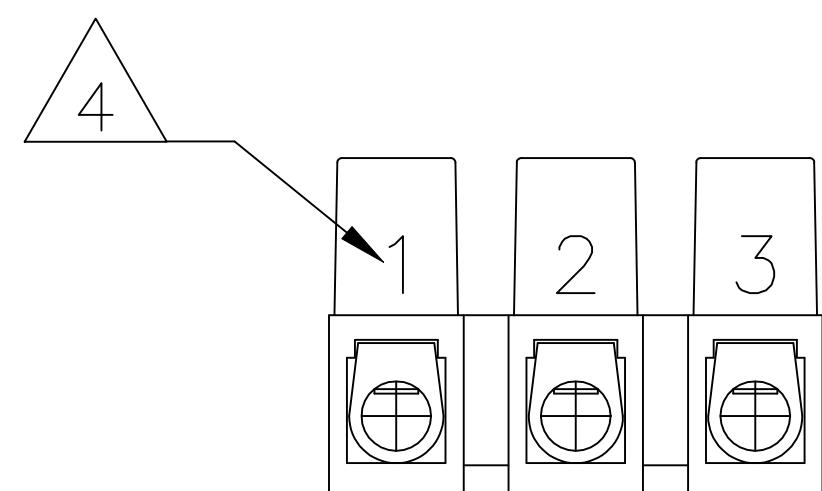

1-1779295-3

1776295-4 AS SHOWN

| | DIM B | DIM A | NO. POSN | CATALOG NUMBER | TE PART NUMBER |
|----------|-------|-------|----------|----------------|----------------|
| | 8.0 | 22.0 | 3 | TSB23003DS HT | 1-1776295-3 |
| | 80.0 | 94.0 | 12 | TSB23012DS HT | 1-1776295-2 |
| | 72.0 | 86.0 | 11 | TSB23011DS HT | 1-1776295-1 |
| OBSOLETE | 64.0 | 78.0 | 10 | TSB23010DS HT | 1-1776295-0 |
| | 56.0 | 70.0 | 9 | TSB23009DS HT | 1776295-9 |
| | 48.0 | 62.0 | 8 | TSB23008DS HT | 1776295-8 |
| | 40.0 | 54.0 | 7 | TSB23007DS HT | 1776295-7 |
| | 32.0 | 46.0 | 6 | TSB23006DS HT | 1776295-6 |
| | 24.0 | 38.0 | 5 | TSB23005DS HT | 1776295-5 |
| | 16.0 | 30.0 | 4 | TSB23004DS HT | 1776295-4 |
| | 8.0 | 22.0 | 3 | TSB23003DS HT | 1776295-3 |
| | - | 14.0 | 2 | TSB23002DS HT | 1776295-2 |
| | - | 6.0 | 1 | TSB23001DS HT | 1776295-1 |

| | | | | | |
|---|--|------------------------------|--|--------------------|--------------------|
| THIS DRAWING IS A CONTROLLED DOCUMENT. | | DWN S SCHLEGEL 3/18/05 | TE Connectivity Ltd. | | |
| DIMENSIONS: mm | | CHK C RICHARD 3/18/05 | | | |
| TOLERANCES UNLESS OTHERWISE SPECIFIED: | | APVD C RICHARD 3/18/05 | NAME HIGH TEMP EUROPA TERMINAL BLOCK W/WIRE PROTECTOR MOUNTING HOLES 2.8DIA 8.0mm PITCH | | |
| 0 PLC ± - 1 PLC ± 0.3 2 PLC ± 0.25 3 PLC ± - 4 PLC ± - ANGLES ± 2° | | PRODUCT SPEC - | APPLICATION SPEC - | | |
| MATERIAL SEE NOTES | | FINISH SEE NOTES | WEIGHT - | SIZE A3 | CAGE CODE 00779 |
| CUSTOMER DRAWING | | | DRAWING NO C=1776295 | RESTRICTED TO - | |
| | | | SCALE NTS | SHEET 1 of 1 | REV P |