

LOC	DIST	REVISIONS			
GP	00	REV	DESCRIPTION	DATE	BY
		A	REVISED PER ECO-09-026043	15JAN2010	CR SB
		A1	REVISED PER ECO-10-002990	30JAN10	KK HMR

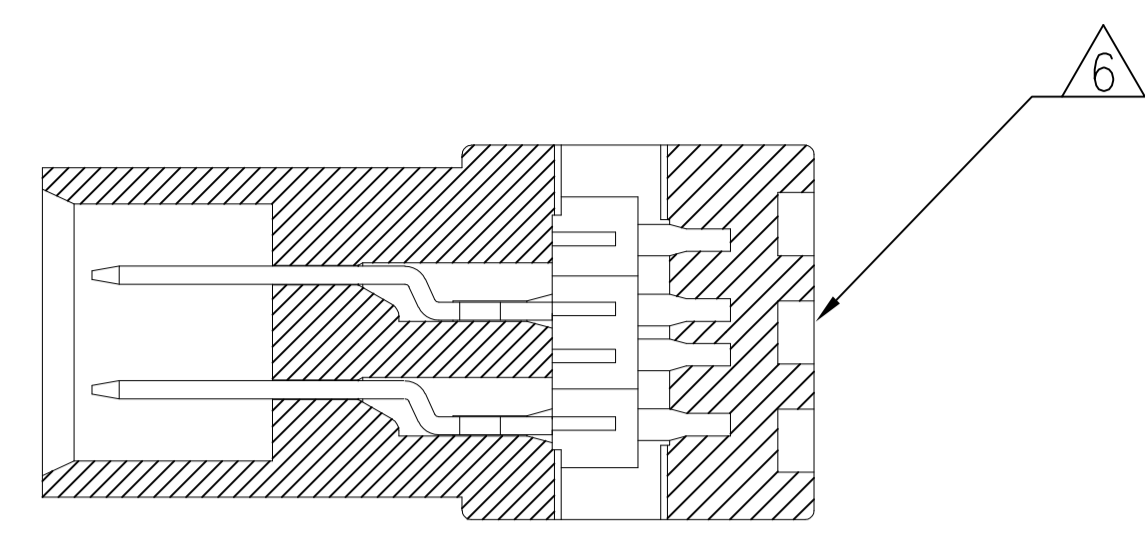

SEC. A-A

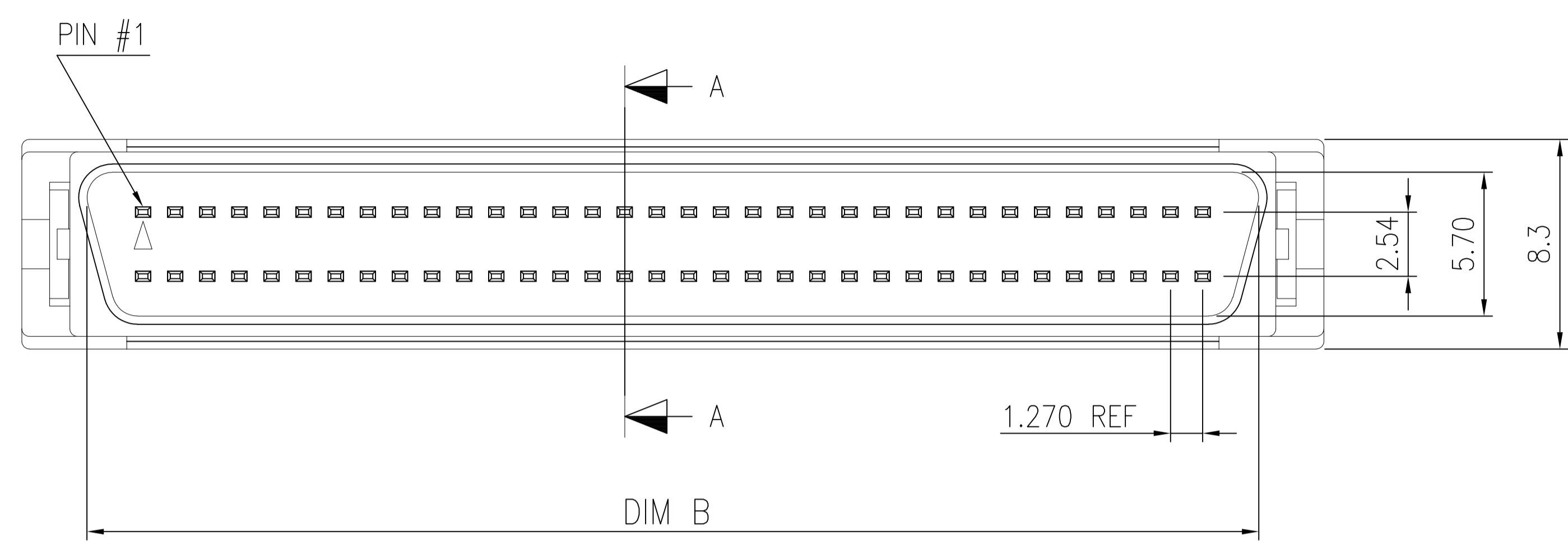
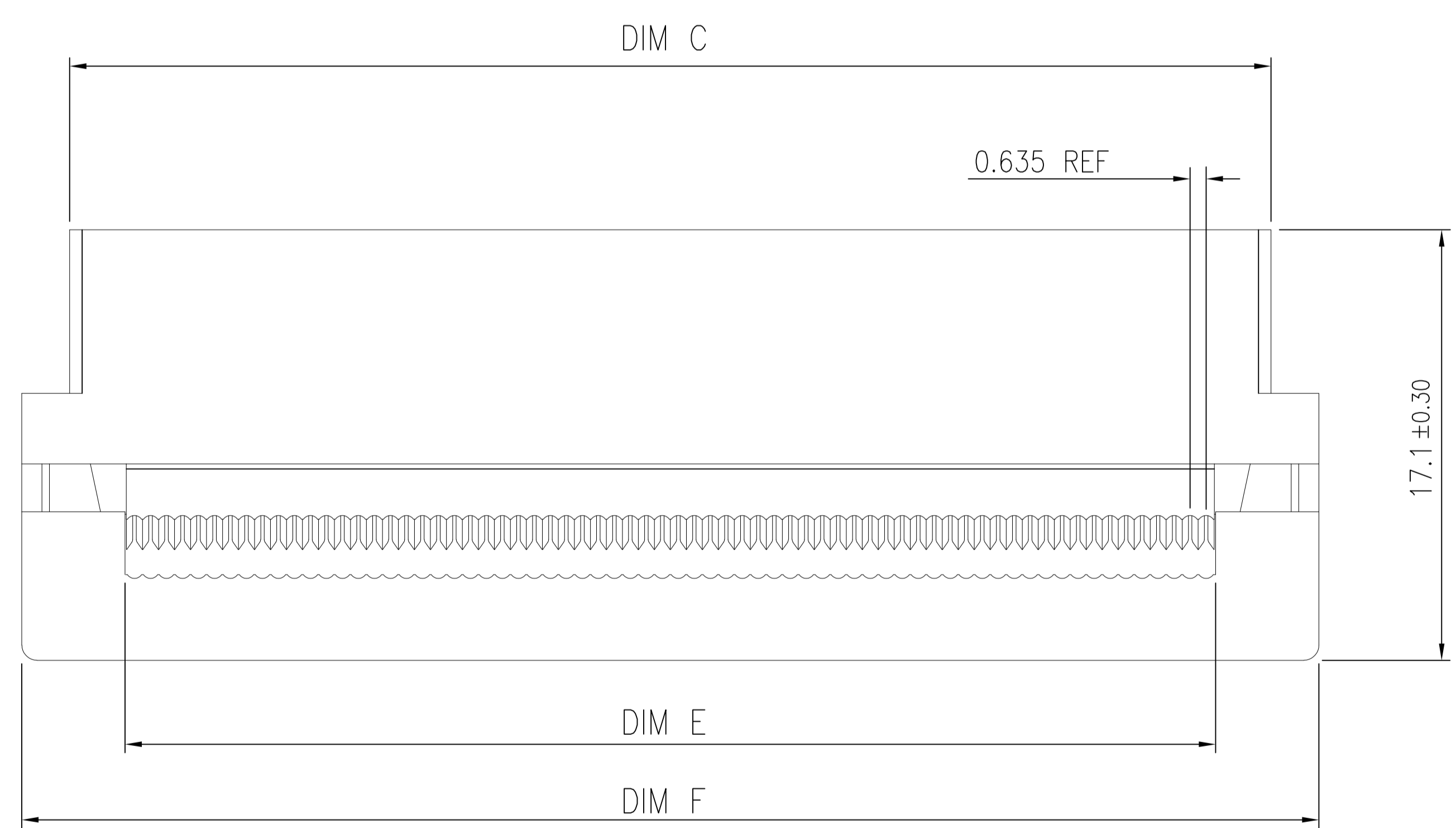

68 POSITION SHOWN

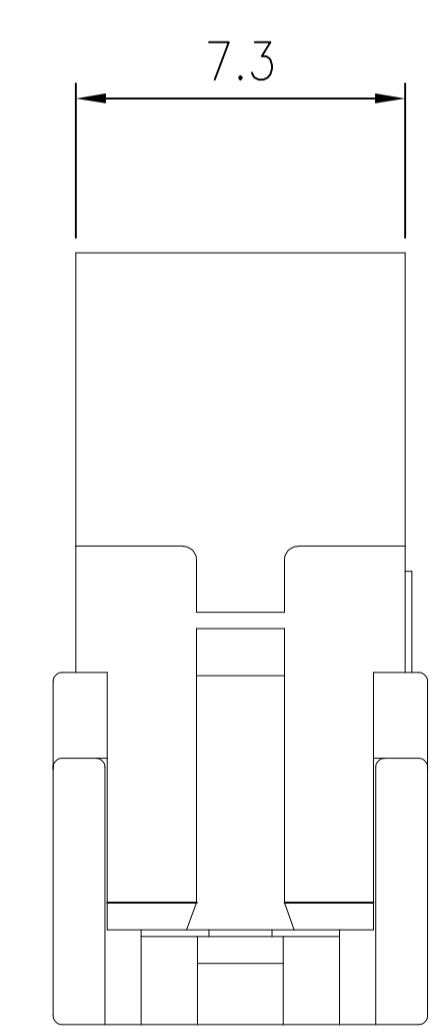

- ① HOUSING: PBT, 30% GLASS REINFORCED, UL94V-0, COLOR BLACK.
CONTACTS: PHOS. BRONZE.
- ② CONTACTS: GOLD PLATED (SEE TABLE) ON MATING END, 1.27µm [.000050in] MIN MATTE TIN ON TERMINATION AREA, ALL OVER 1.27µm [.000050in] MIN NICKEL ON ENTIRE CONTACT.
- ③ SPECIFICATIONS:
CURRENT RATING: 1A.
VOLTAGE RATING: 30V AC.
INSULATION RESISTANCE: 1000 MILLIOHMS MIN. AT 500V DC.
CONTACT RESISTANCE: 55 MILLIOHMS MAX.
DIELECTRIC WITHSTANDING VOLTAGE: 250V AC FOR 1 MINUTE.
CONTACT RETENTION FORCE: 600 gf MIN.
TOTAL INSERTION FORCE: 4 Kgf MAX. (FORCE DEPENDENT ON MATING CONNECTOR)
TOTAL WITHDRAWAL FORCE: 1.5 Kgf MAX. (FORCE DEPENDENT ON MATING CONNECTOR)
WIRE COVER RETENTION FORCE: 6 Kgf MIN.
OPERATION TEMPERATURE: -55°C TO 85°C.
- ④ FOR USE WITH 30 & 32 AWG FLAT RIBBON CABLE.
SELECTION OF COMPATIBLE RIBBON CABLE AND APPLICATION TOOLING FOR USE WITH THIS PRODUCT IS THE RESPONSIBILITY OF THE USER.
- 5. SPECIFICATIONS SUBJECT TO CHANGE WITHOUT NOTICE.
CONTACT TYCO ELECTRONICS FOR THE LATEST SPECIFICATIONS.
- ⑥ TYCO LOGO LOCATED ON THIS SURFACE.
- 7. PACKAGED IN TRAYS.

SUPERSEDED BY 5390377-7	51.5	43.30	47.7	46.35	0.03µm [.00001in]	68	-2-5390377-7
SUPERSEDED BY 5390377-7	51.5	43.30	47.7	46.35	0.38µm [.000015in]	68	-1-5390377-7
	51.5	43.30	47.7	46.35	0.76µm [.000030in]	68	5390377-7
	40.07	31.87	36.27	34.92	0.76µm [.000030in]	50	5390377-5
	DIM F	DIM E	DIM C	DIM B	CONTACT FINISH	NO OF POS	PART NUMBER

THIS DRAWING IS A CONTROLLED DOCUMENT.

DIMENSIONS:	TOLERANCES UNLESS OTHERWISE SPECIFIED:	APPROVED:	DATE:	TYCO ELECTRONICS
mm	0. PLC ± -	J. GERACE	26JAN05	Tyco Electronics Corporation
	1. PLC ± 0.15	S. SHUEY	26JAN05	Harrisburg, Pa 17105-3608
	2. PLC ± 0.10	M. WALMSLEY	26JAN05	
	3. PLC ± -			
	4. PLC ± -			
	ANGLES ± -			
MATERIAL	FINISH	WEIGHT	SIZE	RESTRICTED TO
①	②		A1 00779	
CUSTOMER DRAWING			SCALE 1:1	SHEET 1 OF 1