

**Pb** THIS PRODUCT MANUFACTURED WITH LEAD-FREE PROCESSING

**DESIGNED & DIMENSIONED IN MILLIMETERS [INCHES]**

**TABLE 1**

ITEM	COMPONENT	-HF	-GF
1	SUB ASSEMBLY	SUB-MMCXV-J-C-FF-ST-CA1	SUB-MMCXV-J-C-FN-ST-CA1
2	SOCKET	MMCXV-J-C-H-ST-CA1-SKT	MMCXV-J-C-G-ST-CA1-SKT
3	FERRULE	MCX-FER-001-F	MCX-FER-001-N

DO NOT SCALE FROM THIS PRINT

**MMCXV-J-C-XX-ST-CA1-X**

SERIES  
-V: HIGH VIBRATION

GENDER  
-J: JACK

TYPE  
-C: CABLE

PACKAGING  
-BLANK: INDIVIDUALLY BAGGED  
-B: BULK PACKAGED(QTY=100 MAX)

TERMINATION  
-CA1: CCA-174 / CCA-316 CABLE

ORIENTATION  
-ST: STRAIGHT

PLATING SPECIFICATION  
-HF: 30µ" GOLD CENTER CONTACT, 3µ" GOLD OUTER CONTACT  
-GF: 10µ" GOLD CENTER CONTACT, 3µ" GOLD OUTER CONTACT, 100µ" NICKEL REMAINING PARTS (SEE TABLE 1)

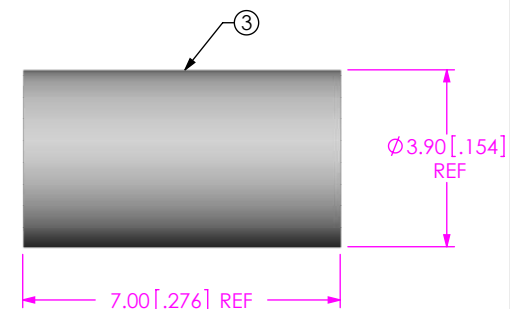
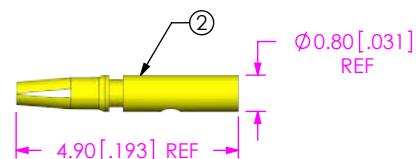
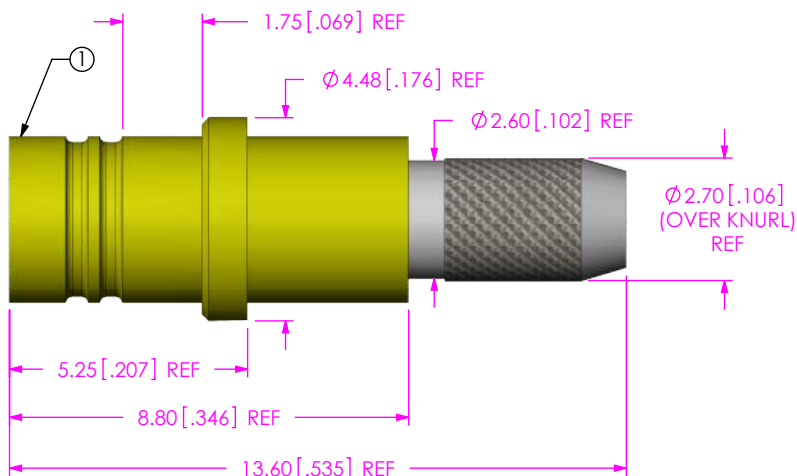

NOTES:

- ① REPRESENTS A CRITICAL DIMENSION.
- PRODUCT TO BE PACKAGED PER PRECISION RF SECTION OF PACKAGING MANUAL.  
TRAY: TY-SMA001-1  
COVER: TY-SMA001-2  
200 PARTS PER TRAY(2 PARTS PER POCKET).
- SOCKET & FERRULE TO BE PACKAGED SEPARATELY.

UNLESS OTHERWISE SPECIFIED, DIMENSIONS ARE IN MILLIMETERS.

TOLERANCES ARE:  
DECIMALS ANGLES  
X.X: ±0.3 [.01] 5°  
X.XX: ±0.13 [.005]  
X.XXX: ±0.051 [.0020]

PROPRIETARY NOTE

THIS DOCUMENT CONTAINS INFORMATION CONFIDENTIAL AND PROPRIETARY TO SAMTEC, INC. AND SHALL NOT BE REPRODUCED OR TRANSFERRED TO OTHER DOCUMENTS OR DISCLOSED TO OTHERS OR USED FOR ANY PURPOSE OTHER THAN THAT WHICH IT WAS OBTAINED WITHOUT THE EXPRESSED WRITTEN CONSENT OF SAMTEC, INC.



520 PARK EAST BLVD, NEW ALBANY, IN 47150  
PHONE: 812-944-6733 FAX: 812-948-5047  
e-Mail info@SAMTEC.com code 55322

MATERIAL: DO NOT SCALE DRAWING SHEET SCALE: 6:1

SHELL, CABLE BODY, FERRULE: BRASS  
SOCKET: BeCu  
INSULATOR: PTFE

DESCRIPTION: MMCXV ST JACK FOR CCA-174 / CCA-316 HIGH VIBRATION, 50 OHM

DWG. NO. **MMCXV-J-C-XX-ST-CA1-X**

BY: ALVIN W 10/05/2011 SHEET 1 OF 3

REVISION B

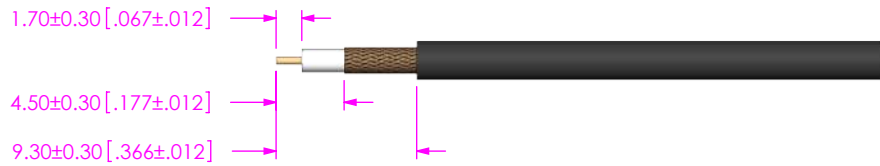

IN PROCESS 1  
STRIP AND TIN INNER  
CONDUCTOR



DETAIL 'A'  
SCALE 1:1

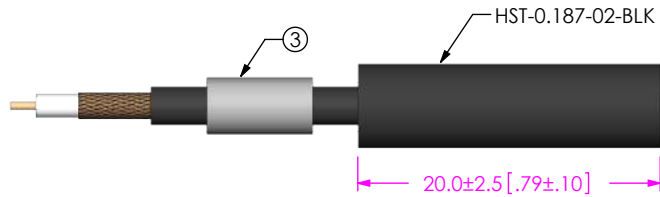

IN-PROCESS 2  
ADD HEAT SHRINK  
TUBE & FERRULE



IN-PROCESS 3  
SOLDER SIGNAL SOCKET

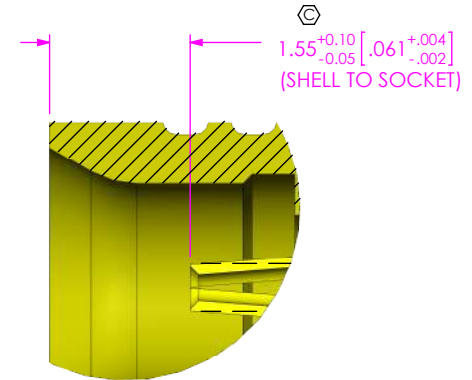

DETAIL 'B'  
SCALE 1:2



IN-PROCESS 4  
ADD SUB ASSEMBLY

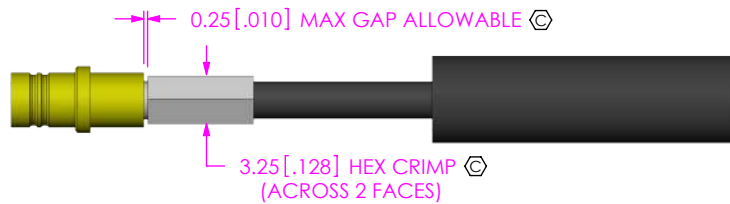

IN-PROCESS 5  
CRIMP FERRULE  
(USE CRIMP HAND TOOL  
#CAT-HT-126667-21  
OR EQUIVALENT)  
(USE .128" HEX DIE)



IN PROCESS 6  
APPLY HEAT SHRINK TUBING

PROPRIETARY NOTE

THIS DOCUMENT CONTAINS INFORMATION CONFIDENTIAL AND PROPRIETARY TO SAMTEC, INC. AND SHALL NOT BE REPRODUCED OR TRANSFERRED TO OTHER DOCUMENTS OR DISCLOSED TO OTHERS OR USED FOR ANY PURPOSE OTHER THAN THAT WHICH IT WAS OBTAINED WITHOUT THE EXPRESSED WRITTEN CONSENT OF SAMTEC, INC.

DO NOT SCALE DRAWING

SHEET SCALE: 2:1



520 PARK EAST BLVD, NEW ALBANY, IN 47150  
PHONE: 812-944-6733 FAX: 812-948-5047  
e-Mail info@SAMTEC.com code 55322

DESCRIPTION:  
MMCXV ST JACK FOR CCA-174 / CCA-316 HIGH VIBRATION, 50 OHM

DWG. NO.  
**MMCXV-J-C-XX-ST-CA1-X**

BY: ALVIN W 10/05/2011 SHEET 2 OF 3

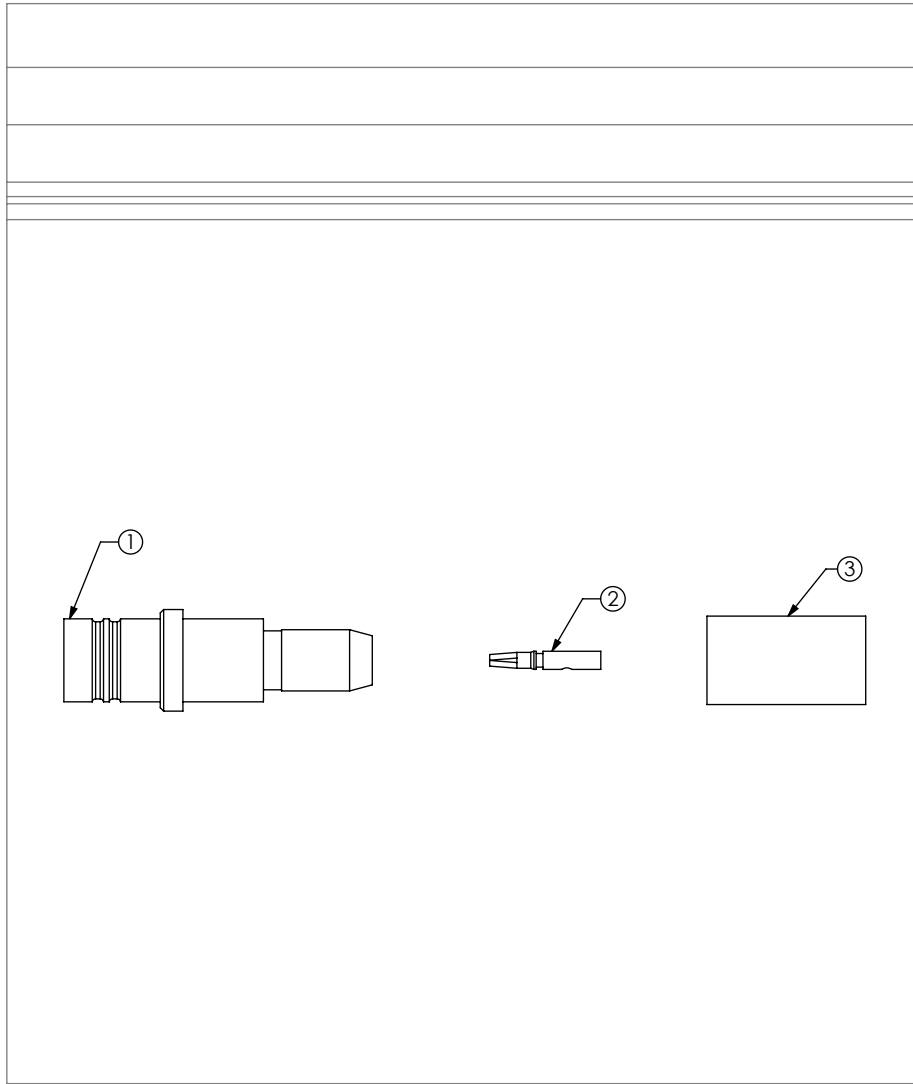

PACKAGING VIEW  
MMCXV-J-C-XX-ST-CA1 SHOWN

**PROPRIETARY NOTE**  
 THIS DOCUMENT CONTAINS CONFIDENTIAL AND PROPRIETARY INFORMATION AND ALL DESIGN, MANUFACTURING, REPRODUCTION, USE, PATENT RIGHTS AND SALES RIGHTS ARE EXPRESSLY RESERVED BY SAMTEC, INC. THIS DOCUMENT SHALL NOT BE DISCLOSED, IN WHOLE OR PART, TO ANY UNAUTHORIZED PERSON OR ENTITY NOR REPRODUCED, TRANSFERRED OR INCORPORATED IN ANY OTHER PROJECT IN ANY MANNER WITHOUT THE EXPRESS WRITTEN CONSENT OF SAMTEC, INC.



520 PARK EAST BLVD., NEW ALBANY, IN 47150  
 PHONE: 812-944-6733 FAX: 812-948-5047  
 e-Mail info@SAMTEC.com code 55322

SHEET SCALE: 6:1  
 DO NOT SCALE DRAWING

DESCRIPTION:  
 MMCXV ST JACK FOR CCA-174 / CCA-316 HIGH VIBRATION, 50 OHM

DWG. NO.  
**MMCXV-J-C-XX-ST-CA1-X**

BY: ALVIN W 10/05/2011 SHEET 3 OF 3