

DVI-D(F)

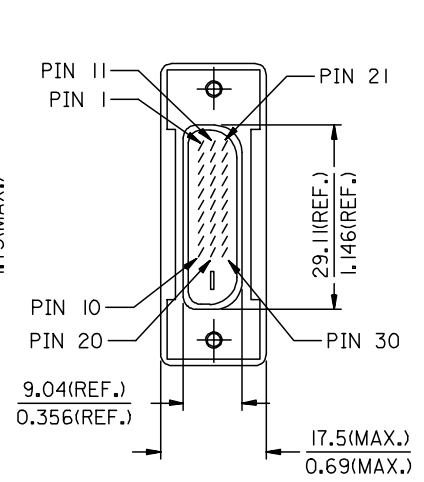

P&D-D(M)

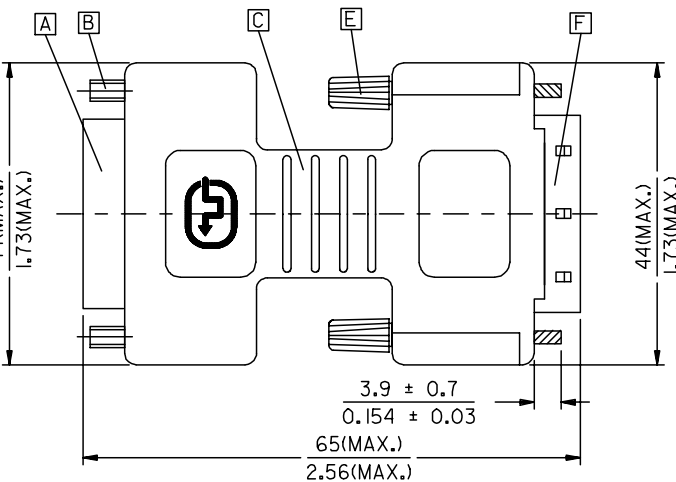
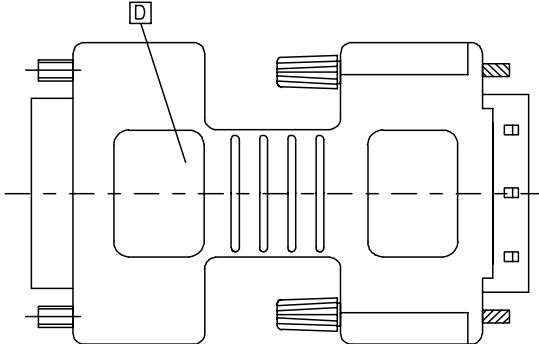

BACK SIDE

|  |  |                               |  |             |                          |              |              |                         |                        |           |  |
|--|--|-------------------------------|--|-------------|--------------------------|--------------|--------------|-------------------------|------------------------|-----------|--|
| ENTER DESCRIPTION<br>EC NO: DG2006-0186<br>DRWN:PDAI<br>CHKD:<br>APPR:TKAN | 2006/03/09<br>2006/03/09<br>2006/03/10 | QUALITY SYMBOLS<br>▽=0<br>◻=0 | GENERAL TOLERANCES (UNLESS SPECIFIED)  |             | DIMENSION STYLE<br>MM/IN |              | SCALE<br>--- | DESIGN UNITS<br>METRIC  | THIRD ANGLE PROJECTION |           |  |
|  | DESCRIPTION                            |                               | mm   | INCH        | DRAWN BY                 | DATE         | TITLE        |                         |                        |           |  |
|  | REV                                    |                               | 4 PLACES   | ± ---       | ± ---                    | PDAI         | 2006/03/07   | DVI_D(F)-P&D(M) ADAPTER |                        |           |  |
|  |  |                               | 3 PLACES   | ± ---       | ± ---                    | CHECKED BY   | DATE         | MOLEX INCORPORATED      |                        |           |  |
|  | 2 PLACES                               | ± ---                         | ± ---  | ZXDENG      | 2006/03/07               | MATERIAL NO. |              |                         |                        |           |  |
|  | 1 PLACE                                | ± ---                         | ± ---  | APPROVED BY | DATE                     | 88741-9200   |              | DOCUMENT NO.            |                        | SHEET NO. |  |
|  |  |                               |  | BORON       | 2006/03/07               |              |              | SD-88741-013            |                        | 1 OF 2    |  |
| DRAFT WHERE APPLICABLE<br>MUST REMAIN<br>WITHIN DIMENSIONS                 |  |                               | THIS DRAWING CONTAINS INFORMATION THAT IS PROPRIETARY TO MOLEX<br>INCORPORATED AND SHOULD NOT BE USED WITHOUT WRITTEN PERMISSION |             |                          |              |              |                         |                        |           |  |

NOTE:1. PLASTIC COVER: SNOW WHITE UL GRADE ABS.  
 2. DVI CONNCEOTOR SPECIFICATION  
 2.1 REFER TO PRODUCT SPEC. PS74320-0001.  
 2.2 CONTACT PLATING: AU FLASH.  
 3. ELECTRICAL PERFORMANCE  
 3.1 INSULATION RESISANCE: 20 M Ohms MIn  
 3.2 DIELECTRIC STRENGTH: 300V DC FOR 10 MILLISECONDS.  
 4. ADAPTOR SPECIFICATION  
 4.1 REFER TO PRODUCT SPEC. PS88741-8800.  
 5. THIS PRODUCT MUST MEET MX RoHS COMPLIANCE.

7. MATERIAL LIST

|      |   |
|------|---|
| F    | P&D CONNECTOR ASSY 674850009                    |
| E    | ADAPTER SCREW 887806003                         |
| D    | DVI(F) TO P&D(M) ADAPTER BOTTOM COVER 887899308 |
| C    | DVI(F) TO P&D(M) ADAPTER TOP COVER 887899301    |
| B    | DVI_D FEMALE SCREW 887806066                    |
| A    | DVI_D FEMALE CONNECTOR 743207000                |
| ITEM | DESCRIPTION                                     |

6. CONNECTION DIAGRAM

| SHIELD   | SHIEDL   | GROUND                 |
|----------|----------|------------------------|
| PIN 24   | PIN 15   | TMDS CLOCK-            |
| PIN 23   | PIN 14   | TMDS CLOCK+            |
| PIN 22   | PIN 7    | TMDS CLOCK SHIELD      |
| PIN 19   | PIN 23   | TMDS DATA 0 SHIELD     |
| PIN 18   | PIN 21   | TMDS DATA 0+           |
| PIN 17   | PIN 22   | TMDS DATA 0-           |
| PIN 16   | PIN 8    | HOT PLUG DETECT        |
| PIN 15   | PIN 25   | GROUND(+5V & HV SYNC.) |
| PIN 14   | PIN 28   | POWER +5V              |
| PIN 11   | PIN 13   | TMDS DATA 1 SHIELD     |
| PIN 10   | PIN 11   | TMDS DATA 1+           |
| PIN 9    | PIN 12   | TMDS DATA 1-           |
| PIN 7    | PIN 26   | DDC DATA               |
| PIN 6    | PIN 27   | DDC CLOCK              |
| PIN 3    | PIN 3    | TMDS DATA 2 SHIELD     |
| PIN 2    | PIN 1    | TMDS DATA 2+           |
| PIN 1    | PIN 2    | TMDS DATA 2-           |
| DVI-D(F) | P&D-D(M) | CABLE FUNCTION         |

|  |                     |                                       |            |   |                          |              |                           |  |
|--|---------------------|---------------------------------------|------------|---|--------------------------|--------------|---------------------------|--|
| ENTER DESCRIPTION<br>EC NO: DG2006-0186<br>DRWN:PDAI<br>CHKD:<br>APPR:TKAN<br>2006/03/09<br>2006/03/09<br>2006/03/10 | QUALITY SYMBOLS<br> | GENERAL TOLERANCES (UNLESS SPECIFIED) |            | DIMENSION STYLE   | SCALE                    | DESIGN UNITS | THIRD ANGLE PROJECTION    |  |
|  |                     |                                       |            | MM/IN   | ---                      | METRIC       |                           |  |
|  |                     | 4 PLACES                              | ± ---      | ± ---   | DRAWN BY                 | DATE         | TITLE                     |  |
|  |                     | 3 PLACES                              | ± ---      | ± ---   | PDAI                     | 2006/03/07   | DVI_D(F)-P&D_D(M) ADAPTER |  |
| 2 PLACES   | ± ---               | ± ---                                 | CHECKED BY | DATE  |                          |              |                           |  |
| 1 PLACE  | ± ---               | ± ---                                 | ZXDENG     | 2006/03/07  |                          |              |                           |  |
| ANGULAR ± ---°   |                     | APPROVED BY                           |            | DATE  | MOLEX MOLEX INCORPORATED |              |                           |  |
|  |                     | BORON                                 |            | 2006/03/07  |                          |              |                           |  |
| DRAFT WHERE APPLICABLE MUST REMAIN WITHIN DIMENSIONS   |                     | MATERIAL NO.                          |            | DOCUMENT NO.  | SHEET NO.                |              |                           |  |
|  |                     | 88741-9200                            |            | SD-88741-013  | 2 OF 2                   |              |                           |  |
|  |                     | SIZE                                  |            | THIS DRAWING CONTAINS INFORMATION THAT IS PROPRIETARY TO MOLEX INCORPORATED AND SHOULD NOT BE USED WITHOUT WRITTEN PERMISSION |                          |              |                           |  |
|  |                     | A 4                                   |            |   |                          |              |                           |  |