

THIS DRAWING IS UNPUBLISHED. RELEASED FOR PUBLICATION 20  
 © COPYRIGHT 20 BY - ALL RIGHTS RESERVED.

| REVISIONS |     |  |           |     |      |
|-----------|-----|--|-----------|-----|------|
| P         | LTR | DESCRIPTION                            | DATE      | DWN | APVD |
| D8        |     | PN 5-2 AND 5-6 RELEASED FOR PRODUCTION | 07DEC2018 | RK  | PS   |
| D9        |     | PART OBSOLETE                          | 28AUG2020 | DV  | PS   |

POLARIZATION KEY SLOT

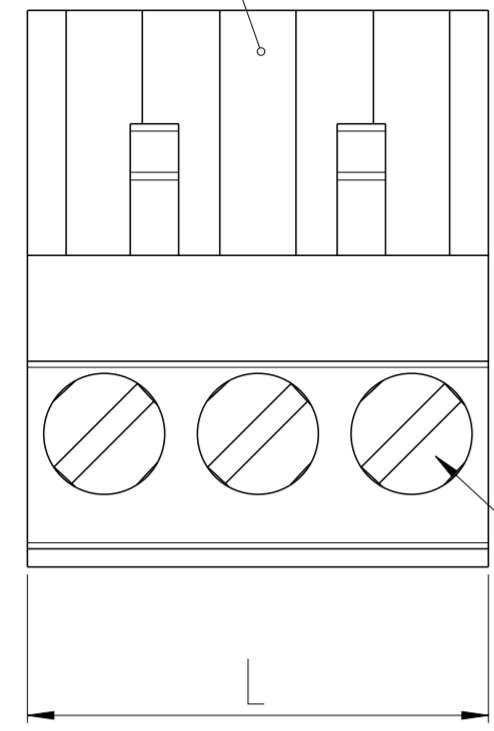

CLAMPING SCREW

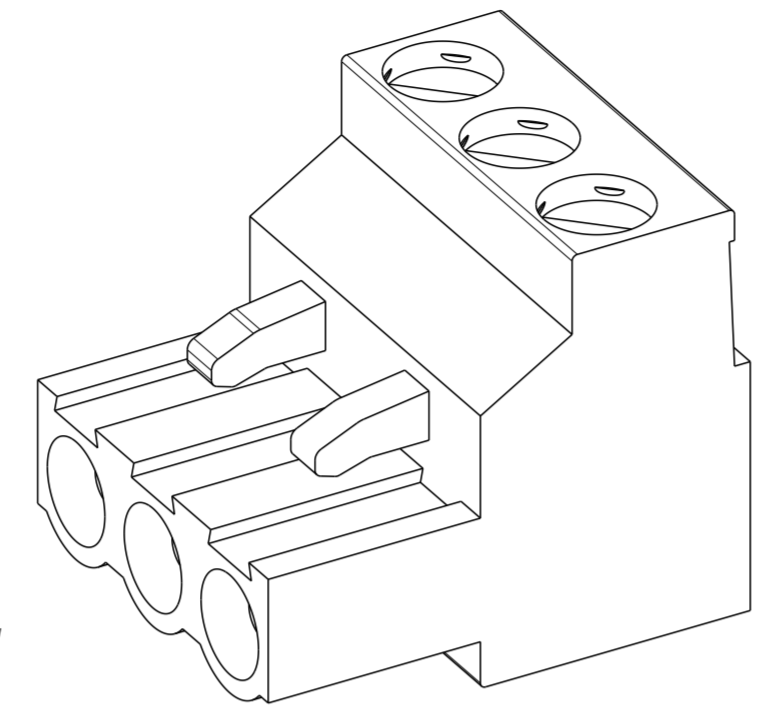

1546108-3 AS SHOWN

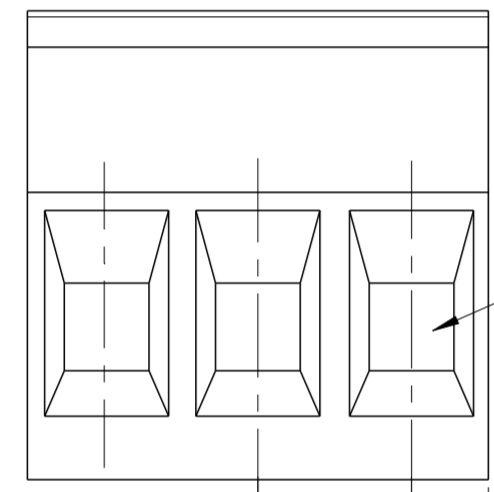

WIRE ENTRY

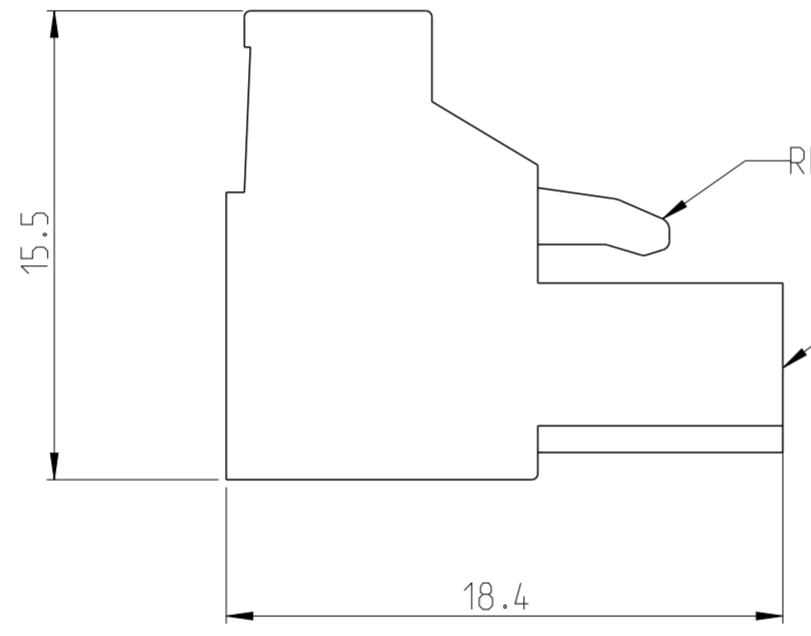

5.08±0.08 TYP  
 2.54 REF 2 PLC

|    |          |        |          |              |             |    |                        |
|----|----------|--------|----------|--------------|-------------|----|------------------------|
| 10 | OBSOLETE | BLACK  | DETAIL N | TIN          | 30.48±0.20  | 6  | <del>6-1546108-9</del> |
|    |          | GREEN  | DETAIL M | TIN          | 15.24±0.15  | 3  | <del>6-1546108-8</del> |
|    |          | ORANGE | DETAIL M | TIN          | 15.24±0.15  | 3  | <del>6-1546108-7</del> |
|    |          | BLACK  | DETAIL M | TIN          | 15.24±0.15  | 3  | <del>6-1546108-6</del> |
|    |          | BLACK  | DETAIL N | TIN          | 25.40±0.20  | 5  | <del>6-1546108-5</del> |
|    |          | GREEN  | DETAIL N | TIN          | 15.24±0.15  | 3  | <del>6-1546108-4</del> |
|    |          | ORANGE | DETAIL N | TIN          | 15.24±0.15  | 3  | <del>6-1546108-3</del> |
|    |          | BLACK  | DETAIL N | TIN          | 15.24±0.15  | 3  | <del>6-1546108-2</del> |
|    |          | GRAY   | DETAIL H | TIN          | 55.88       | 11 | <del>5-1546108-1</del> |
|    |          | GRAY   | DETAIL H | TIN          | 45.72       | 9  | <del>5-1546108-9</del> |
|    |          | GRAY   | DETAIL H | TIN          | 30.48±0.20  | 6  | <del>5-1546108-6</del> |
|    |          | GRAY   | DETAIL H | TIN          | 20.32±0.15  | 4  | <del>5-1546108-4</del> |
|    |          | GRAY   | DETAIL H | TIN          | 15.24±0.15  | 3  | <del>5-1546108-3</del> |
|    |          | GRAY   | DETAIL H | TIN          | 10.16±0.15  | 2  | <del>5-1546108-2</del> |
| 9  | OBSOLETE | GRAY   | -        | TIN          | 15.24±0.15  | 3  | <del>4-1546108-6</del> |
|    |          | GRAY   | DETAIL K | TIN          | 40.64       | 8  | <del>4-1546108-5</del> |
|    |          | GRAY   | DETAIL H | TIN          | 40.64       | 8  | <del>4-1546108-4</del> |
|    |          | GRAY   | DETAIL H | TIN          | 96.52±0.35  | 19 | <del>4-1546108-3</del> |
|    | OBSOLETE | GRAY   |          | .000030 GOLD | 60.96±0.20  | 12 | <del>4-1546108-2</del> |
|    | OBSOLETE | GRAY   |          | .000030 GOLD | 30.48±0.20  | 6  | <del>3-1546108-6</del> |
|    | OBSOLETE | GRAY   |          | .000030 GOLD | 20.32±0.15  | 4  | <del>3-1546108-4</del> |
|    | OBSOLETE | GRAY   |          | .000030 GOLD | 15.24±0.15  | 3  | <del>3-1546108-3</del> |
|    |          | GRAY   |          | TIN          | 127.00±0.35 | 25 | <del>2-1546108-5</del> |
|    |          | GRAY   |          | TIN          | 121.92±0.35 | 24 | <del>2-1546108-4</del> |
|    |          | GRAY   |          | TIN          | 116.84±0.35 | 23 | <del>2-1546108-3</del> |
|    |          | GRAY   |          | TIN          | 111.76±0.35 | 22 | <del>2-1546108-2</del> |
|    |          | GRAY   |          | TIN          | 106.68±0.35 | 21 | <del>2-1546108-1</del> |
|    |          | GRAY   |          | TIN          | 101.60±0.35 | 20 | <del>2-1546108-0</del> |
|    |          | GRAY   |          | TIN          | 96.52±0.35  | 19 | <del>1-1546108-9</del> |
|    |          | GRAY   |          | TIN          | 91.44±0.30  | 18 | <del>1-1546108-8</del> |
|    |          | GRAY   |          | TIN          | 86.36±0.30  | 17 | <del>1-1546108-7</del> |
|    |          | GRAY   |          | TIN          | 81.28±0.30  | 16 | <del>1-1546108-6</del> |
|    |          | GRAY   |          | TIN          | 76.20±0.30  | 15 | <del>1-1546108-5</del> |
|    |          | GRAY   |          | TIN          | 71.12       | 14 | <del>1-1546108-4</del> |
|    |          | GRAY   |          | TIN          | 66.04       | 13 | <del>1-1546108-3</del> |
|    |          | GRAY   |          | TIN          | 60.96       | 12 | <del>1-1546108-2</del> |
|    |          | GRAY   |          | TIN          | 55.88       | 11 | <del>1-1546108-1</del> |
|    |          | GRAY   |          | TIN          | 50.80       | 10 | <del>1-1546108-0</del> |
|    |          | GRAY   |          | TIN          | 45.72       | 9  | <del>1546108-9</del>   |
|    |          | GRAY   |          | TIN          | 40.64       | 8  | <del>1546108-8</del>   |
|    |          | GRAY   |          | TIN          | 35.56±0.20  | 7  | <del>1546108-7</del>   |
|    |          | GRAY   |          | TIN          | 30.48±0.20  | 6  | <del>1546108-6</del>   |
|    |          | GRAY   |          | TIN          | 25.40±0.20  | 5  | <del>1546108-5</del>   |
|    |          | GRAY   |          | TIN          | 20.32±0.15  | 4  | <del>1546108-4</del>   |
|    |          | GRAY   |          | TIN          | 15.24±0.15  | 3  | <del>1546108-3</del>   |
|    |          | GRAY   |          | TIN          | 10.16±0.15  | 2  | <del>1546108-2</del>   |

| COLOR | MARKING STYLE | CONTACT FINISH | L | NO OF POSN | PART NUMBER |
|-------|---------------|----------------|---|------------|-------------|
|-------|---------------|----------------|---|------------|-------------|

THIS DRAWING IS A CONTROLLED DOCUMENT.

DWN S. WELDON 11SEP2002  
 CHK C. RICHARD 11SEP2002  
 APVD C. RICHARD 11SEP2002

TE Connectivity

NAME: TERMINAL BLOCK, PLUG, STACKING, 5.08mm PITCH

SIZE: A2 CAGE CODE: 100779 DRAWING NO: 1546108 RESTRICTED TO: -

MATERIAL: SEE NOTES TOLERANCES UNLESS OTHERWISE SPECIFIED: SEE NOTES

0 PLC ±0.3  
 1 PLC ±0.25  
 2 PLC ±0.25  
 3 PLC ±0.25  
 4 PLC ±0.25

ANGLES ±2°

FINISH: SEE NOTES

APPLIC. SPEC: - WEIGHT: -

CUSTOMER DRAWING SCALE: 4:1 SHEET: 1 OF 2 REV: D9

THIS DRAWING IS UNPUBLISHED. RELEASED FOR PUBLICATION 20  
 © COPYRIGHT 20 BY - ALL RIGHTS RESERVED.

| REVISIONS |     |             |      |     |      |
|-----------|-----|-------------|------|-----|------|
| P         | LTR | DESCRIPTION | DATE | DWN | APVD |
| -         | -   | SEE SHEET 1 | -    | -   | -    |
|           |     |             |      |     |      |
|           |     |             |      |     |      |

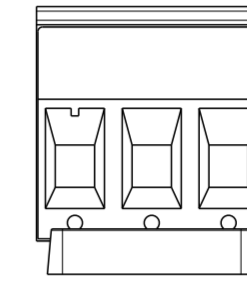
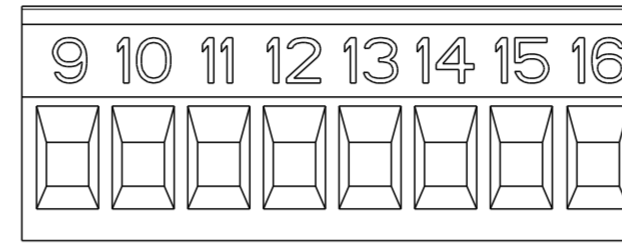
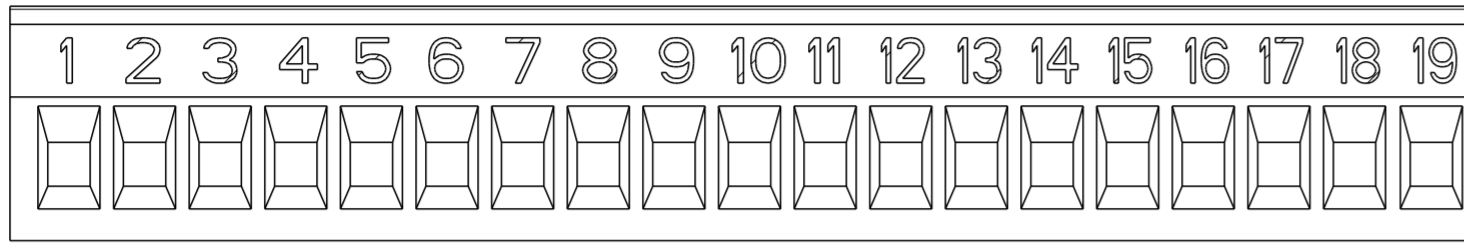

DETAIL H  
 SCALE 2:1  
 (PN 4-1546108-3, 4-1546108-4, 4-1546108-6, 4-1546108-7,  
 5-1546108-2, 5-1546108-3, 5-1546108-4, 5-1546108-6, 5-1546108-9)

DETAIL K  
 SCALE 2:1  
 (PN 4-1546108-5)

DETAIL N  
 SCALE 2:1  
 (PN 6-1546108-3, 6-1546108-4, 6-1546108-5, 6-1546108-9)

NOTES:

- MATERIALS AND FINISH:  
 HOUSING: PA 6-6, UL 94-V0.  
 CLAMP: BRASS, NICKEL PLATED.  
 CONTACT SPRING: PHOSPHOR BRONZE, FINISH: SEE TABLE.  
 CLAMPING SCREW: M3, BRASS, NICKEL PLATED.
- MECHANICAL  
 WIRE STRIPPING LENGTH : 6.0-7.5 mm  
 RECOMMENDED TIGHTENING TORQUE FOR SCREW : 0.5 Nm.
- ELECTRICAL  
 WIRE RANGE : 12-30 AWG  
 MAX. VOLTAGE : 300 V  
 MAX CURRENT : 15 A  
 CONTACT RESISTANCE : <15 m Ohm  
 INSULATION RESISTANCE : >1000 M Ohm (500V DC)
- END-TO-END STACKABLE WITHOUT LOSS OF CENTERLINE SPACING.
- RECOGNIZED UNDER THE COMPONENT PROGRAM OF UNDERWRITERS LABORATORIES INC. FILE NO E60677.
- OPERATING TEMPERATURE RANGE: -40°C TO +105°C
- NOT CUMULATIVE TOLERANCE
- INK MARKING: BLACK COLOR.  
 NUMERICAL SEQUENCE FROM LEFT TO RIGHT.
- WITHOUT RETENTION LATCHES.
- WITH STRAIN RELIEF

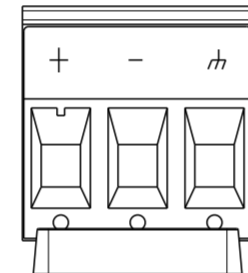
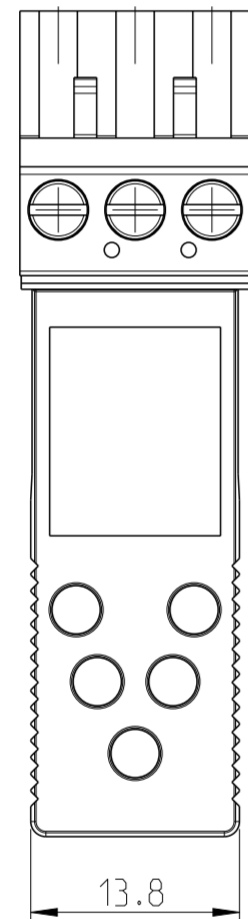

DETAIL M  
 SCALE 2:1  
 (PN 6-1546108-6, 6-1546108-7, 6-1546108-8)

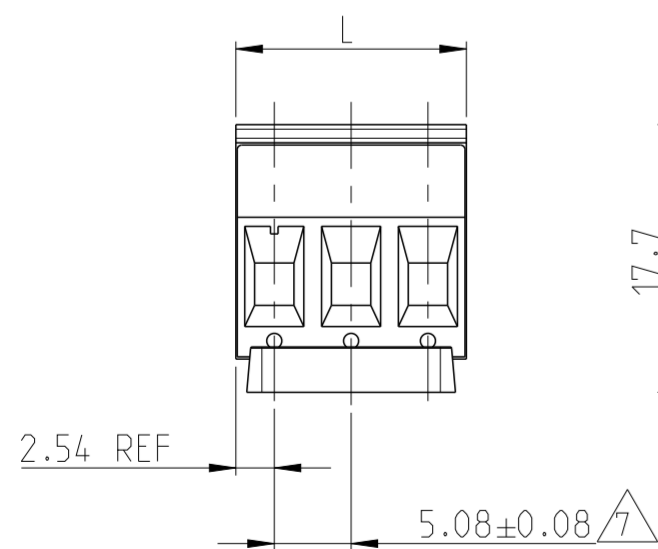
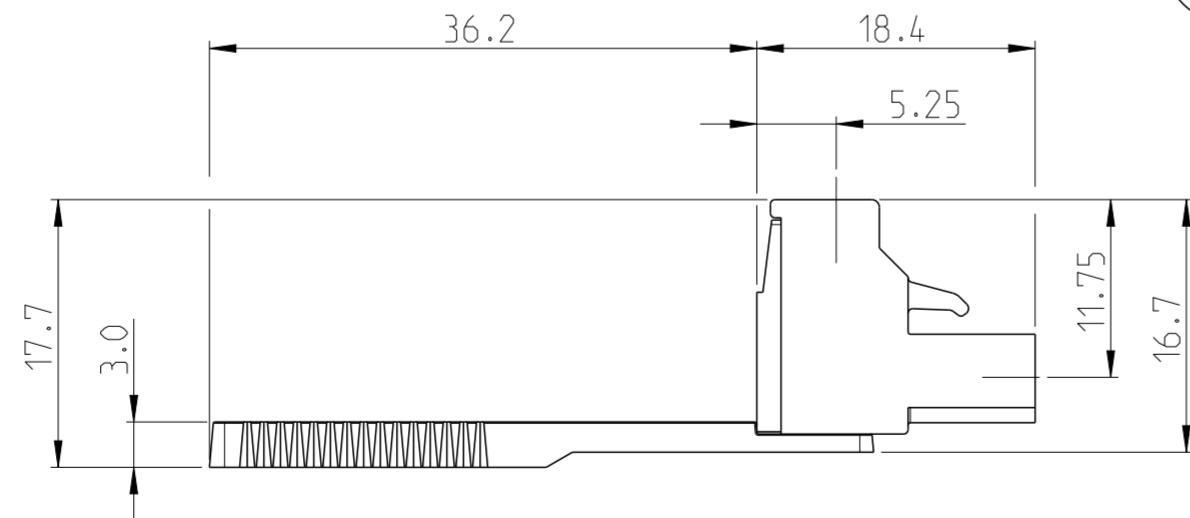
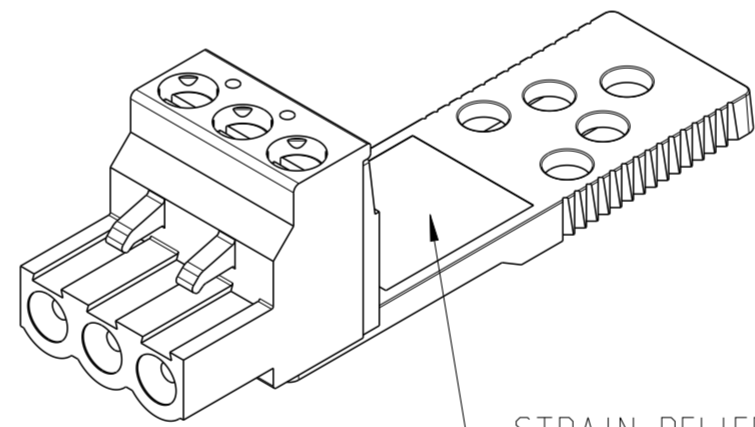
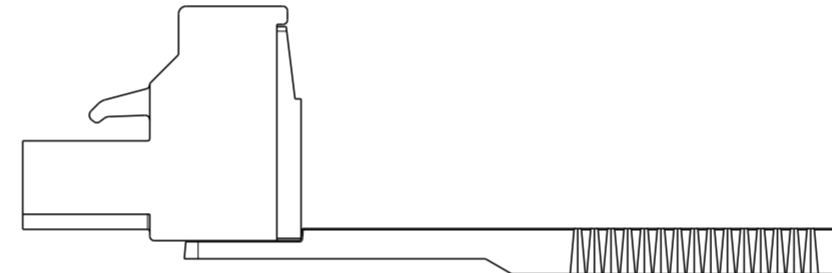

6-1546108-2  
 SCALE 2:1

|  |  |                                 |                 |                    |                       |   |
|--|--|---------------------------------|-----------------|--------------------|-----------------------|---|
| THIS DRAWING IS A CONTROLLED DOCUMENT.   |  | DWN<br>S. WELDON<br>11SEP2002   | TE Connectivity |                    |                       |   |
| DIMENSIONS:<br>mm  |  | CHK<br>C. RICHARD<br>11SEP2002  |                 |                    |                       | NAME<br>TERMINAL BLOCK, PLUG, STACKING,<br>5.08mm PITCH |
| TOLERANCES UNLESS OTHERWISE SPECIFIED:   |  | APVD<br>C. RICHARD<br>11SEP2002 | SIZE<br>A2      | CAGE CODE<br>00779 | DRAWING NO<br>1546108 | RESTRICTED TO<br>-                                      |
| 0 PLC ±<br>1 PLC ±0.3<br>2 PLC ±0.25<br>3 PLC ±<br>4 PLC ±<br>ANGLES ±2°<br>FINISH SEE NOTES |  | PRODUCT SPEC<br>-               | SCALE<br>4:1    | SHEET<br>2 OF 2    | REV<br>09             |   |
| MATERIAL<br>SEE NOTES  |  | APPLICATION SPEC<br>-           | WEIGHT<br>-     | CUSTOMER DRAWING   |                       |   |