

- NOTES:
- MATERIAL: LIQUID CRYSTALLINE POLYMER (LCP), GLASS FILLED, UL 94V-0, COLOR: BLACK.
TERMINAL & SOLTERTAB: COPPER ALLOY
PICK & PLACE CAP: PA46, UL 94V-0, COLOR: BLACK.
 - PLATING:
CONTACT: 0.76μm MIN. SELECTIVE GOLD OVER 1.27μm MIN.
NICKEL UNDERPLATE
SOLDERTAIL: 2.54μm MIN. TIN OVER 1.27μm MIN. NICKEL UNDERPLATE
SOLDERTAB: 2.54μm MIN. TIN OVER 1.91μm MIN. NICKEL UNDERPLATE.
 - MOLEX LOGO LOCATED APPROXIMATELY AS SHOWN
 - PACKAGING: REFER TO ATTACHED
 - DATE CODE TO BE LOCATED APPROXIMATELY AS SHOWN.
 - PRODUCT IS COMPLIANT TO RoHS DIRECTIVE WITH THE FOLLOWING BANNED SUBSTANCES - LEAD, MERCURY, CADMIUM, HEXAVALENT CHROMIUM, POLYBROMINATED BIPHENYLS AND POLYBROMINATED DIPHENYL ETHERS.
 - PRODUCT SPECIFICATION PS-78367-001 APPLIES.
 - MATES WITH: SFF-8482 PLUG
SATA PLUG SERIES: 87679, 87703, 87799.
 - NON-FUNCTIONAL CORING MAY VARY.

PART NUMBER	DIM A	PACKAGING	DIM B	DIM C
78367-0001	2.00	TRAY	(ø2.48)	ø2.50
78367-0005	1.00	TAPE & REEL	(ø1.26)	ø1.40
78367-0008				

VOID P/N: 78367-0003/6/7 EC NO: S2017-0457 DRWN:SKANG 2017/03/06 CHKD:MLONG 2017/03/16 APPR:MLONG 2017/03/16	QUALITY SYMBOLS	GENERAL TOLERANCES (UNLESS SPECIFIED)	DIMENSION STYLE	SCALE	DESIGN UNITS	THIRD ANGLE PROJECTION
	$\nabla_A = 0$ $\nabla_C = 0$ $\nabla_P = 0$	mm INCH 4 PLACES ± --- ± --- 3 PLACES ± --- ± --- 2 PLACES ± 0.20 ± --- 1 PLACE ± --- ± --- ANGULAR ± 3 °	MM ONLY	NTS	METRIC	
	DRAWN BY	DATE	TITLE	SAS RECEPTACLE EXTENDED HEIGHT, SMT WITH SOLDERTAB		
	CHECKED BY	DATE	MOLEX INCORPORATED			
	APPROVED BY	DATE	MATERIAL NO.	DOCUMENT NO.	SHEET NO.	
		SEE TABLE			SD-78367-001	1 OF 5
DRAFT WHERE APPLICABLE MUST REMAIN WITHIN DIMENSIONS						
THIS DRAWING CONTAINS INFORMATION THAT IS PROPRIETARY TO MOLEX INCORPORATED AND SHOULD NOT BE USED WITHOUT WRITTEN PERMISSION						

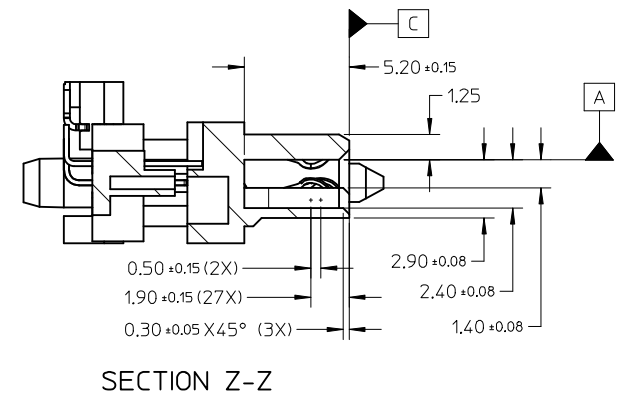
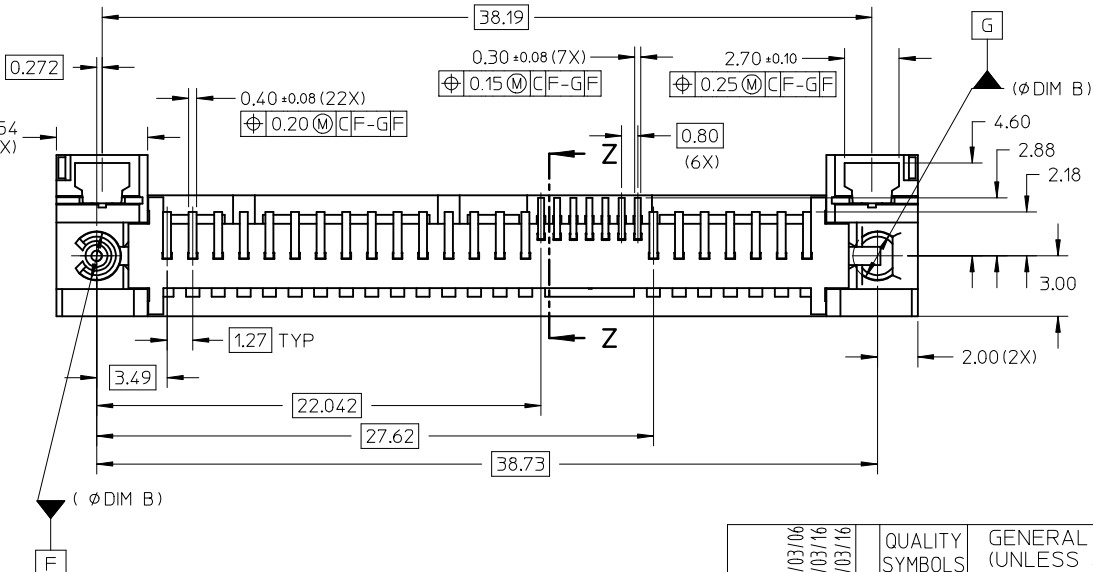
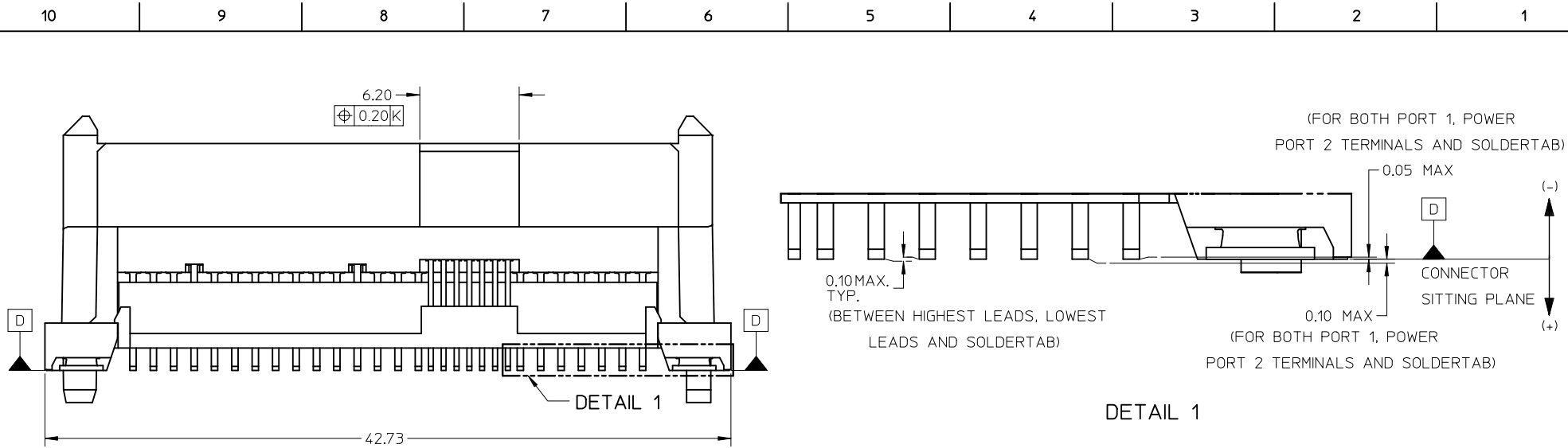

SEE SHT 1 EC NO: S2017-0457 DRWN:SKANG 2017/03/06 CHKD:MLONG 2017/03/16 APPR:MLONG 2017/03/16	QUALITY SYMBOLS $\nabla_A = 0$ $\nabla_C = 0$ $\nabla_P = 0$	GENERAL TOLERANCES (UNLESS SPECIFIED)		DIMENSION STYLE MM ONLY		SCALE NTS		DESIGN UNITS METRIC		THIRD ANGLE PROJECTION		
			mm	INCH	DRAWN BY	DATE	TITLE SAS RECEPTACLE EXTENDED HEIGHT, SMT WITH SOLDER TAB					
		4 PLACES	± ---	± ---	BOKOK	2008/02/01						
		3 PLACES	± ---	± ---	CHECKED BY	DATE	MOLEX INCORPORATED					
2 PLACES	± 0.20	± ---	YKOH	2008/02/18								
1 PLACE	± ---	± ---	APPROVED BY	DATE	DOCUMENT NO. SD-78367-001							
ANGULAR ± 3 °				BOKOK							2010/02/19	
DRAFT WHERE APPLICABLE MUST REMAIN WITHIN DIMENSIONS		SEE TABLE		MATERIAL NO.	SHEET NO. 2 OF 5							
				SIZE A3							THIS DRAWING CONTAINS INFORMATION THAT IS PROPRIETARY TO MOLEX INCORPORATED AND SHOULD NOT BE USED WITHOUT WRITTEN PERMISSION	

10 9 8 7 6 5 4 3 2 1

F

E

D

C

B

A

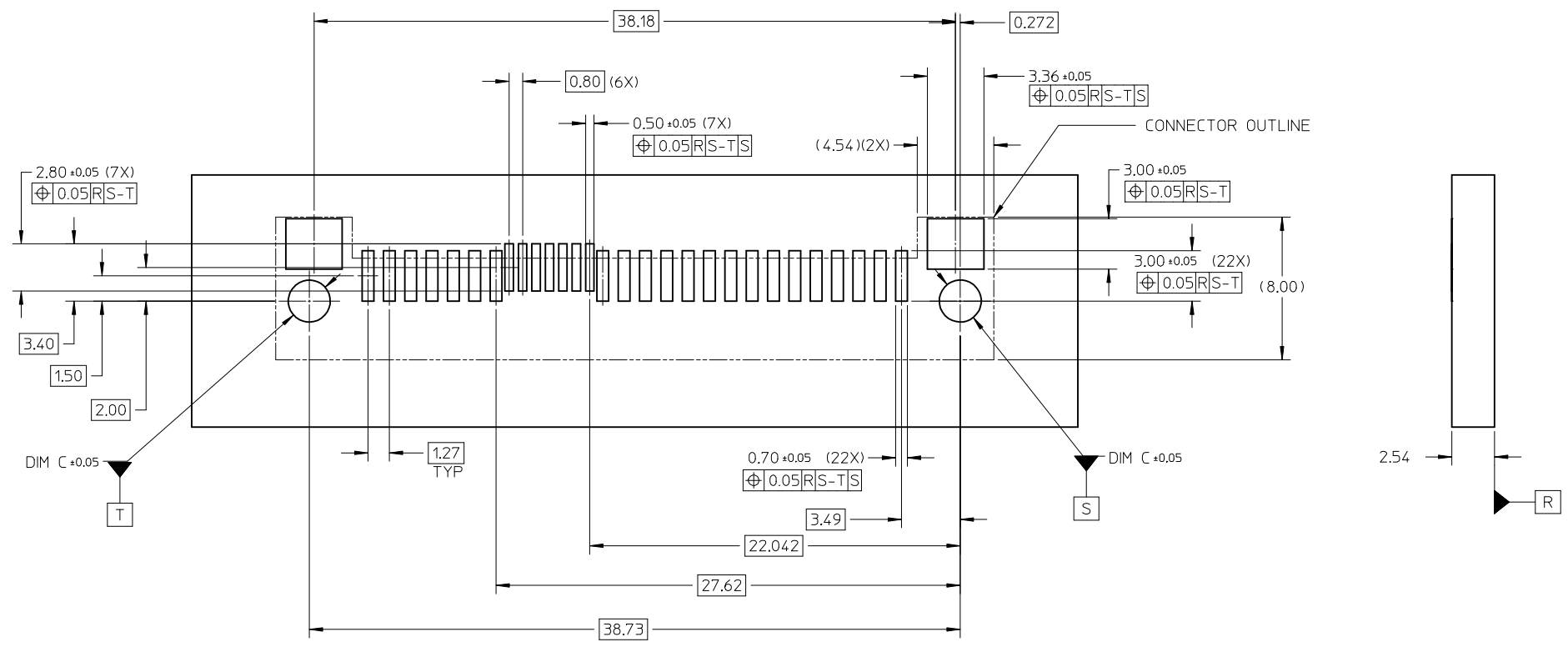

RECOMMENDED PCB LAYOUT

SEE SHT 1 EC NO: S2017-0457 DRWN:SKANG 2017/03/06 CHKD:MLONG 2017/03/16 APPR:MLONG 2017/03/16	QUALITY SYMBOLS	GENERAL TOLERANCES (UNLESS SPECIFIED)		DIMENSION STYLE	SCALE	DESIGN UNITS	THIRD ANGLE PROJECTION
	$F_A=0$ $F_C=0$ $F_P=0$	mm	INCH	MM ONLY	NTS	METRIC	
		4 PLACES ± --- ± ---	BOKOK 2008/02/01	DRAWN BY	DATE	TITLE	
		3 PLACES ± --- ± ---	YKOH 2008/02/18	CHECKED BY	DATE	SAS RECEPTACLE EXTENDED HEIGHT, SMT WITH SOLDER TAB	
	2 PLACES ± 0.20 ± ---		APPROVED BY	DATE	MOLEX INCORPORATED		
	1 PLACE ± --- ± ---		BOKOK 2010/02/19				
	ANGULAR ± 3 °	DRAFT WHERE APPLICABLE MUST REMAIN WITHIN DIMENSIONS		MATERIAL NO.	DOCUMENT NO.	SHEET NO.	
				SEE TABLE	SD-78367-001	3 OF 5	
				SIZE A3	THIS DRAWING CONTAINS INFORMATION THAT IS PROPRIETARY TO MOLEX INCORPORATED AND SHOULD NOT BE USED WITHOUT WRITTEN PERMISSION		

9 8 7 6 5 4 3 2 1

TRAY PACKAGING

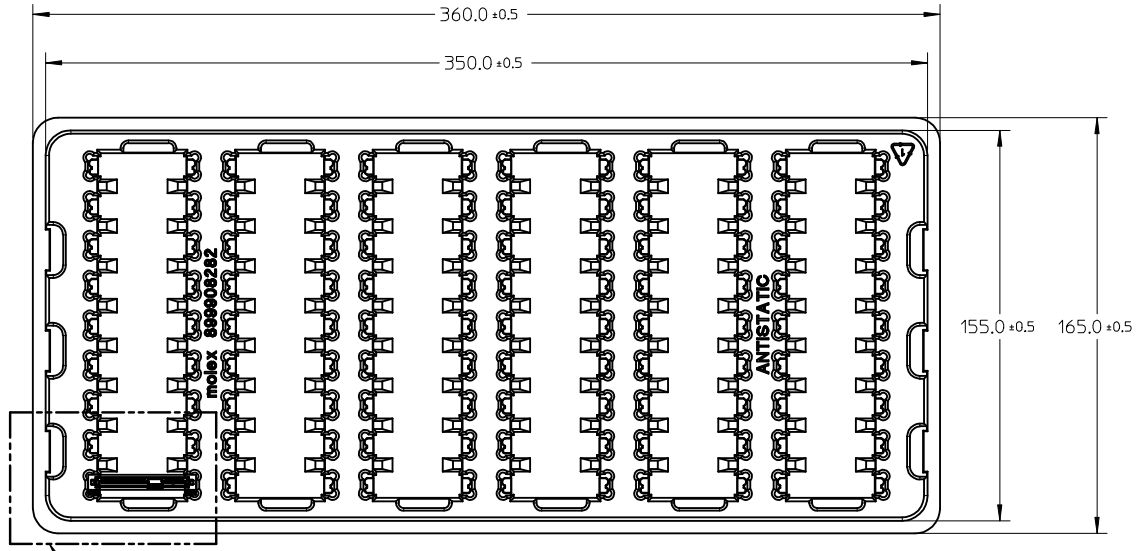

- NOTES:
 1. PACKAGING QTY: 54PCS/TRAY
 2. NO PICK AND PLACE CAP

DETAIL 2

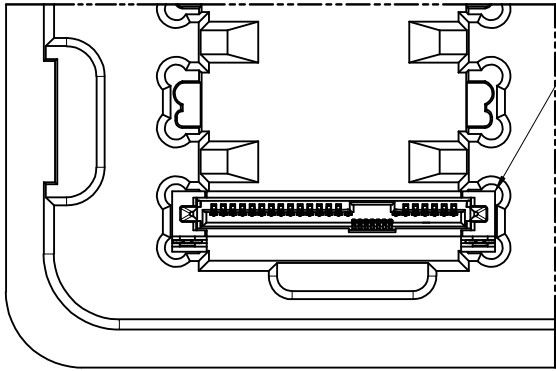

PART ORIENTATION IN TRAY

DETAIL 2

SEE SHT 1 EC NO: S2017-0457 DRWN:SKANG 2017/03/06 CHKD:MLONG 2017/03/16 APPR:MLONG 2017/03/16	QUALITY SYMBOLS F _A =0 F _C =0 F _P =0	GENERAL TOLERANCES (UNLESS SPECIFIED)		DIMENSION STYLE	SCALE	DESIGN UNITS	THIRD ANGLE PROJECTION
		mm	INCH	MM ONLY	NTS	METRIC	
B	DESCRIPTION	4 PLACES	± ---	± ---	DRAWN BY	DATE	TITLE
		3 PLACES	± ---	± ---	BOKOK	2008/02/01	SAS RECEPTACLE EXTENDED HEIGHT, SMT WITH SOLDER TAB
REV	DESCRIPTION	2 PLACES	± 0.20	± ---	CHECKED BY	DATE	
		1 PLACE	± ---	± ---	YKOH	2008/02/18	
		ANGULAR ± 3 °		APPROVED BY	DATE	MOLEX INCORPORATED	
		DRAFT WHERE APPLICABLE MUST REMAIN WITHIN DIMENSIONS		BOKOK	2010/02/19	MATERIAL NO.	DOCUMENT NO.
				SEE TABLE		SD-78367-001	SHEET NO.
				SIZE	THIS DRAWING CONTAINS INFORMATION THAT IS PROPRIETARY TO MOLEX INCORPORATED AND SHOULD NOT BE USED WITHOUT WRITTEN PERMISSION		
				A3			

TAPE AND REEL PACKAGING

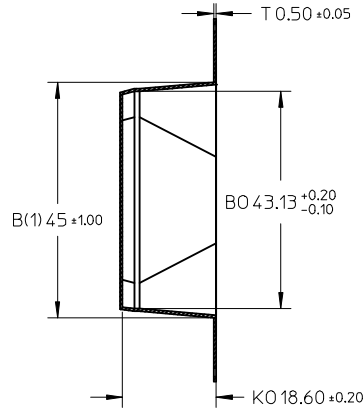

SECTION Y-Y

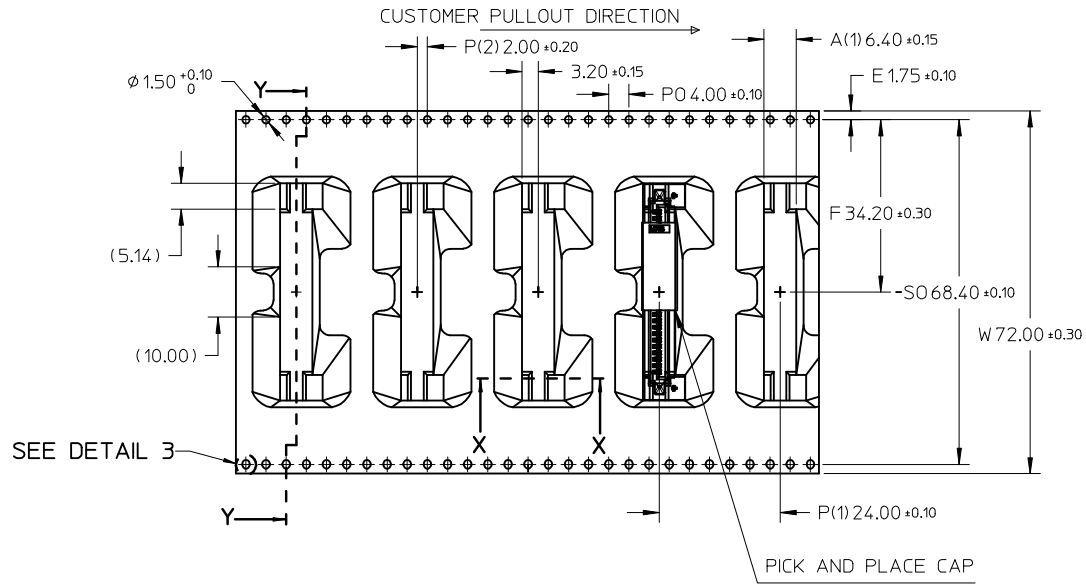

NOTES:

1. LEADER AND TRAILER TAPE

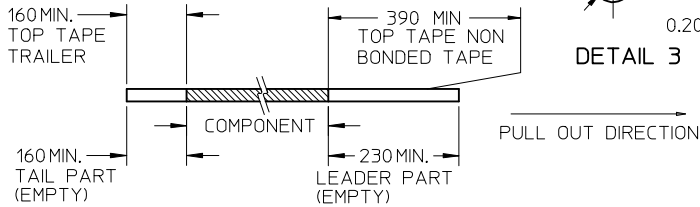

DETAIL 3

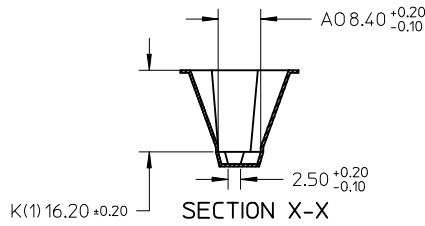

SECTION X-X

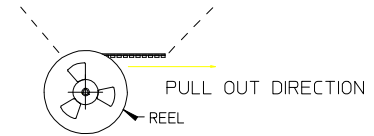

2. PEELING OFF FORCE OF THE TOP TAPE: 20 - 80gf.
(PEELING DIRECTION AS SHOWN IN FOLLOWING FIGURE)

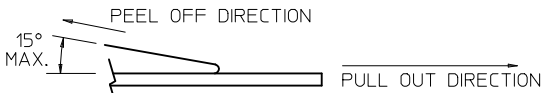

- 3. TAPE AND REEL SPECIFICATION IS AS PER EIA-481.
- 4. TAPE AND REEL QUANTITY : 100 PCS/ REEL.
- 5. THE TAPE IS TREATED FOR ANTI-STATIC.
- 6. COLOUR: BLACK. THICKNESS: 0.50mm THICK.

SEE SHT 1 EC NO: S2017-0457 DRWN:SKANG 2017/03/06 CHKD:MLONG 2017/03/16 APPR:MLONG 2017/03/16	DESCRIPTION	QUALITY SYMBOLS	GENERAL TOLERANCES (UNLESS SPECIFIED)		DIMENSION STYLE	SCALE	DESIGN UNITS	THIRD ANGLE PROJECTION		
		$\nabla_A = 0$	mm	INCH	MM ONLY	NTS	METRIC	⊙ □		
		$\nabla_C = 0$	4 PLACES ± --- ± ---	3 PLACES ± --- ± ---	DRAWN BY	DATE	TITLE			
		$\nabla_P = 0$	2 PLACES ± 0.20 ± ---	1 PLACE ± --- ± ---	CHECKED BY	DATE	SAS RECEPTACLE EXTENDED HEIGHT, SMT WITH SOLDER TAB			
		ANGULAR ± 3 °	DRAFT WHERE APPLICABLE MUST REMAIN WITHIN DIMENSIONS		APPROVED BY	DATE	MATERIAL NO.		DOCUMENT NO.	
			SEE TABLE		BOKOK	2010/02/19	MOLEX INCORPORATED			
					SIZE	THIS DRAWING CONTAINS INFORMATION THAT IS PROPRIETARY TO MOLEX INCORPORATED AND SHOULD NOT BE USED WITHOUT WRITTEN PERMISSION				
					A3					