

10

9

8

7

6

5

4

3

2

1

PART NUMBER	CKT SIZE	A	B
78045-0460	4	4.20	2.00
78045-0660	6	6.20	4.00
78045-0860	8	8.20	6.00
78045-1060	10	10.20	8.00
78045-1260	12	12.20	10.00

1ST CIRCUIT IDENTIFICATION

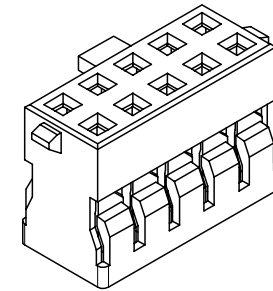
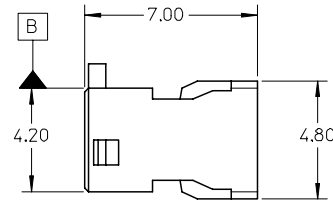
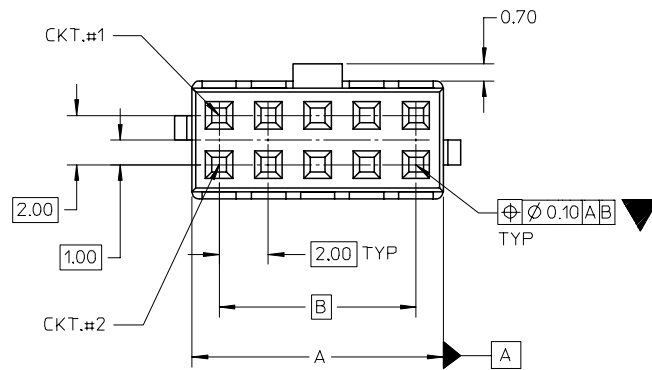
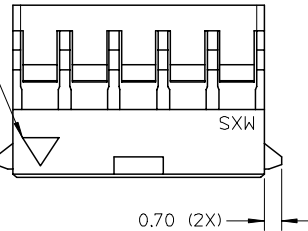

NOTES:

1. MATERIAL: HOUSING - PBT, GLASS FILLED, UL 94V-0, COLOR: BLACK.
2. FOR ILLUSTRATION PURPOSES, 10 CKT SIZE HSG. IS SHOWN.
3. PARTS TO BE USED WITH CRIMP TERMINAL PART NUMBER 50394-8***.
4. APPLICABLE WIRE RANGE : AWG #24 - #30.
5. WIRE INSULATION RANGE : DIAMETER 1.40MM MAXIMUM.

REVISED	EC NO: S2007-0473	DRWNS:SKANG	CHKD:MLONG	APPR:SKTOH	DESCRIPTION	QUALITY SYMBOLS	GENERAL TOLERANCES (UNLESS SPECIFIED)		DIMENSION STYLE		SCALE	DESIGN UNITS	THIRD ANGLE PROJECTION		
							mm	INCH	MM ONLY	NTS					
						▽=1 ▽C=0	4 PLACES	± ---	± ---	DRAWN BY	DATE	TITLE	MGRID, 2MM, W-T-B CRIMP RECEPTACLE HSG W/SIDE LOCKS MOLEX INCORPORATED		
							3 PLACES	± ---	± ---	SKANG	2006/05/15			SD-78045-001	
							2 PLACES	± 0.2	± ---	CHECKED BY	DATE				SHEET NO. 1 OF 1
							1 PLACE	± ---	± ---	MLONG	2006/06/05				
							ANGULAR ± 1 °		APPROVED BY	DATE					
							DRAFT WHERE APPLICABLE MUST REMAIN WITHIN DIMENSIONS		SEE TABLE		DOCUMENT NO.				
									MATERIAL NO.						
									SIZE						
									A3						
									THIS DRAWING CONTAINS INFORMATION THAT IS PROPRIETARY TO MOLEX INCORPORATED AND SHOULD NOT BE USED WITHOUT WRITTEN PERMISSION						

9

8

7

6

5

4

3

2

1