

LOC	DIST	REVISONS	DATE	DATE	DATE
CM	O	ECO-07-012881	21JUN07	KW	DB
FP	LINK	DESCRIPTION			
R					

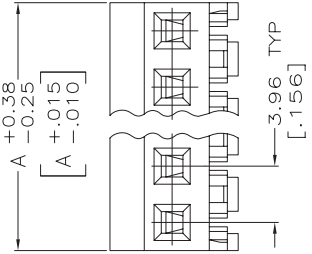
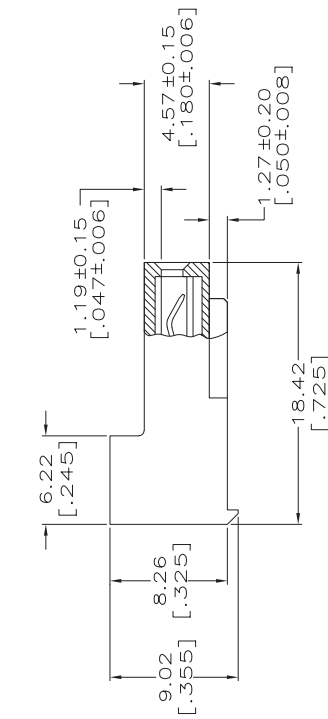
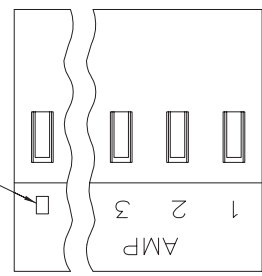

1. MATERIAL: CONNECTOR - NYLON UL94V-2 (RED). CONTACTS - 0.30[.012] THICK COPPER ALLOY. PLATING - 0.00038[.000015] GOLD IN CONTACT AREA. 0.00203[.000080] MIN THICKNESS BRIGHT TIN-LEAD IN SLOT AREA FOR 641155-2 THRU 2-641155-4 OR MATTE WHISKER MITIGATED TIN IN SLOT AREA FOR 3-641155-2 THRU 5-641155-4 OVER NICKEL UNDERPLATE.
2. CONTACTS ACCEPT 22 AWG WIRE WITH 2.41[.095] MAX INSULATION DIAMETER.
3. CONTACTS MUST ACCEPT 1.14±0.03[.045±.001] SQUARE POST AND REMAIN LOCKED IN POSITION.

4. IDENTIFICATION NUMBER FOR LAST CIRCUIT MAY NOT APPEAR ON ALL ASSEMBLIES.
5. DIMENSIONS IN BRACKETS ARE IN INCHES.
6. HOUSING FEATURES ARE: CLOSED END WITHOUT LOCKING RAMP.

NOTE DELETED.

NOTE DELETED.



NO.	DESCRIPTION	DATE	BY	APP'D
95.10	[3.744]	24	5-641155-4	
91.14	[3.588]	23	5-641155-3	
87.17	[3.432]	22	5-641155-2	
83.21	[3.276]	21	5-641155-1	
79.25	[3.120]	20	5-641155-0	
75.29	[2.964]	19	4-641155-9	
71.32	[2.808]	18	4-641155-8	
67.36	[2.652]	17	4-641155-7	
63.40	[2.496]	16	4-641155-6	
59.44	[2.340]	15	4-641155-5	
55.47	[2.184]	14	4-641155-4	
51.51	[2.028]	13	4-641155-3	
47.55	[1.872]	12	4-641155-2	
43.59	[1.716]	11	4-641155-1	
39.62	[1.560]	10	4-641155-0	
35.66	[1.404]	9	3-641155-9	
31.70	[1.248]	8	3-641155-8	
27.74	[1.092]	7	3-641155-7	
23.77	[.936]	6	3-641155-6	
19.81	[.780]	5	3-641155-5	
15.85	[.624]	4	3-641155-4	
11.89	[.468]	3	3-641155-3	
7.92	[.312]	2	3-641155-2	
95.10	[3.744]	24	2-641155-4	
91.14	[3.588]	23	2-641155-3	
87.17	[3.432]	22	2-641155-2	
83.21	[3.276]	21	2-641155-1	
79.25	[3.120]	20	2-641155-0	
75.29	[2.964]	19	1-641155-9	
71.32	[2.808]	18	1-641155-8	
67.36	[2.652]	17	1-641155-7	
63.40	[2.496]	16	1-641155-6	
59.44	[2.340]	15	1-641155-5	
55.47	[2.184]	14	1-641155-4	
51.51	[2.028]	13	1-641155-3	
47.55	[1.872]	12	1-641155-2	
43.59	[1.716]	11	1-641155-1	
39.62	[1.560]	10	1-641155-0	
35.66	[1.404]	9	641155-9	
31.70	[1.248]	8	641155-8	
27.74	[1.092]	7	641155-7	
23.77	[.936]	6	641155-6	
19.81	[.780]	5	641155-5	
15.85	[.624]	4	641155-4	
11.89	[.468]	3	641155-3	
7.92	[.312]	2	641155-2	

THIS DRAWING IS A CONTROLLED DOCUMENT.	REVISED BY	DATE	DESCRIPTION
	B. LEWIS	2-12-91	
	OK	2-12-91	
	SWING		
	APPRO		
	NAME		
	PRODUCT SPEC		
	APPLICATION SPEC		
	APPLICATION SPEC		
	WEIGHT		
	SCALE		
	CUSTOMER DRAWING		