

1.00mm CENTER FLAT FLEX CABLE (FFC) (105°C, Au PLATING)

| "L" DIM. → | 30 ± 2 MM | | 51 ± 2 MM | | 76 ± 3 MM | | 102 ± 3 MM | | 127 ± 4 MM | | 152 ± 4 MM | | 178 ± 4 MM | | 203 ± 4 MM | | 229 ± 5 MM | | 254 ± 5 MM | | 305 ± 5 MM | |
|--------------|-------------|-----------|------------|-----------|------------|-----------|------------|-----------|------------|-----------|------------|-----------|------------|-----------|------------|-----------|------------|-----------|-------------|-----------|-------------|-----------|
| REF DIM → | (1.18 INCH) | | (2 INCHES) | | (3 INCHES) | | (4 INCHES) | | (5 INCHES) | | (6 INCHES) | | (7 INCHES) | | (8 INCHES) | | (9 INCHES) | | (10 INCHES) | | (12 INCHES) | |
| CABLE TYPE → | A | D | A | D | A | D | A | D | A | D | A | D | A | D | A | D | A | D | A | D | A | D |
| CIRCUITS ↓ | A | D | A | D | A | D | A | D | A | D | A | D | A | D | A | D | A | D | A | D | A | D |
| 4 | 150390701 | 150390700 | 150390703 | 150390702 | 150390705 | 150390704 | 150390707 | 150390706 | 150390709 | 150390708 | 150390711 | 150390710 | 150390713 | 150390712 | 150390715 | 150390714 | 150390717 | 150390716 | 150390719 | 150390718 | 150390721 | 150390720 |
| 6 | 150390201 | 150390202 | 150390203 | 150390204 | 150390205 | 150390206 | 150390207 | 150390208 | 150390209 | 150390210 | 150390211 | 150390212 | 150390213 | 150390214 | 150390215 | 150390216 | 150390217 | 150390218 | 150390219 | 150390220 | 150390221 | 150390222 |
| 8 | 150390223 | 150390224 | 150390225 | 150390226 | 150390227 | 150390228 | 150390229 | 150390230 | 150390231 | 150390232 | 150390233 | 150390234 | 150390235 | 150390236 | 150390237 | 150390238 | 150390239 | 150390240 | 150390241 | 150390242 | 150390243 | 150390244 |
| 10 | 150390245 | 150390246 | 150390247 | 150390248 | 150390249 | 150390250 | 150390251 | 150390252 | 150390253 | 150390254 | 150390255 | 150390256 | 150390257 | 150390258 | 150390259 | 150390260 | 150390261 | 150390262 | 150390263 | 150390264 | 150390265 | 150390266 |
| 12 | 150390267 | 150390268 | 150390269 | 150390270 | 150390271 | 150390272 | 150390273 | 150390274 | 150390275 | 150390276 | 150390277 | 150390278 | 150390279 | 150390280 | 150390281 | 150390282 | 150390283 | 150390284 | 150390285 | 150390286 | 150390287 | 150390288 |
| 14 | 150390289 | 150390290 | 150390291 | 150390292 | 150390293 | 150390294 | 150390295 | 150390296 | 150390297 | 150390298 | 150390299 | 150390300 | 150390301 | 150390302 | 150390303 | 150390304 | 150390305 | 150390306 | 150390307 | 150390308 | 150390309 | 150390310 |
| 16 | 150390311 | 150390312 | 150390313 | 150390314 | 150390315 | 150390316 | 150390317 | 150390318 | 150390319 | 150390320 | 150390321 | 150390322 | 150390323 | 150390324 | 150390325 | 150390326 | 150390327 | 150390328 | 150390329 | 150390330 | 150390331 | 150390332 |
| 18 | 150390333 | 150390334 | 150390335 | 150390336 | 150390337 | 150390338 | 150390339 | 150390340 | 150390341 | 150390342 | 150390343 | 150390344 | 150390345 | 150390346 | 150390347 | 150390348 | 150390349 | 150390350 | 150390351 | 150390352 | 150390353 | 150390354 |
| 20 | 150390355 | 150390356 | 150390357 | 150390358 | 150390359 | 150390360 | 150390361 | 150390362 | 150390363 | 150390364 | 150390365 | 150390366 | 150390367 | 150390368 | 150390369 | 150390370 | 150390371 | 150390372 | 150390373 | 150390374 | 150390375 | 150390376 |
| 22 | 150390377 | 150390378 | 150390379 | 150390380 | 150390381 | 150390382 | 150390383 | 150390384 | 150390385 | 150390386 | 150390387 | 150390388 | 150390389 | 150390390 | 150390391 | 150390392 | 150390393 | 150390394 | 150390395 | 150390396 | 150390397 | 150390398 |
| 24 | 150390399 | 150390400 | 150390401 | 150390402 | 150390403 | 150390404 | 150390405 | 150390406 | 150390407 | 150390408 | 150390409 | 150390410 | 150390411 | 150390412 | 150390413 | 150390414 | 150390415 | 150390416 | 150390417 | 150390418 | 150390419 | 150390420 |
| 26 | 150390421 | 150390422 | 150390423 | 150390424 | 150390425 | 150390426 | 150390427 | 150390428 | 150390429 | 150390430 | 150390431 | 150390432 | 150390433 | 150390434 | 150390435 | 150390436 | 150390437 | 150390438 | 150390439 | 150390440 | 150390441 | 150390442 |
| 28 | 150390443 | 150390444 | 150390445 | 150390446 | 150390447 | 150390448 | 150390449 | 150390450 | 150390451 | 150390452 | 150390453 | 150390454 | 150390455 | 150390456 | 150390457 | 150390458 | 150390459 | 150390460 | 150390461 | 150390462 | 150390463 | 150390464 |
| 30 | 150390465 | 150390466 | 150390467 | 150390468 | 150390469 | 150390470 | 150390471 | 150390472 | 150390473 | 150390474 | 150390475 | 150390476 | 150390477 | 150390478 | 150390479 | 150390480 | 150390481 | 150390482 | 150390483 | 150390484 | 150390485 | 150390486 |
| 32 | 150390487 | 150390488 | 150390489 | 150390490 | 150390491 | 150390492 | 150390493 | 150390494 | 150390495 | 150390496 | 150390497 | 150390498 | 150390499 | 150390500 | 150390501 | 150390502 | 150390503 | 150390504 | 150390505 | 150390506 | 150390507 | 150390508 |
| 34 | 150390509 | 150390510 | 150390511 | 150390512 | 150390513 | 150390514 | 150390515 | 150390516 | 150390517 | 150390518 | 150390519 | 150390520 | 150390521 | 150390522 | 150390523 | 150390524 | 150390525 | 150390526 | 150390527 | 150390528 | 150390529 | 150390530 |
| 36 | 150390531 | 150390532 | 150390533 | 150390534 | 150390535 | 150390536 | 150390537 | 150390538 | 150390539 | 150390540 | 150390541 | 150390542 | 150390543 | 150390544 | 150390545 | 150390546 | 150390547 | 150390548 | 150390549 | 150390550 | 150390551 | 150390552 |
| 38 | 150390553 | 150390554 | 150390555 | 150390556 | 150390557 | 150390558 | 150390559 | 150390560 | 150390561 | 150390562 | 150390563 | 150390564 | 150390565 | 150390566 | 150390567 | 150390568 | 150390569 | 150390570 | 150390571 | 150390572 | 150390573 | 150390574 |
| 40 | 150390575 | 150390576 | 150390577 | 150390578 | 150390579 | 150390580 | 150390581 | 150390582 | 150390583 | 150390584 | 150390585 | 150390586 | 150390587 | 150390588 | 150390589 | 150390590 | 150390591 | 150390592 | 150390593 | 150390594 | 150390595 | 150390596 |

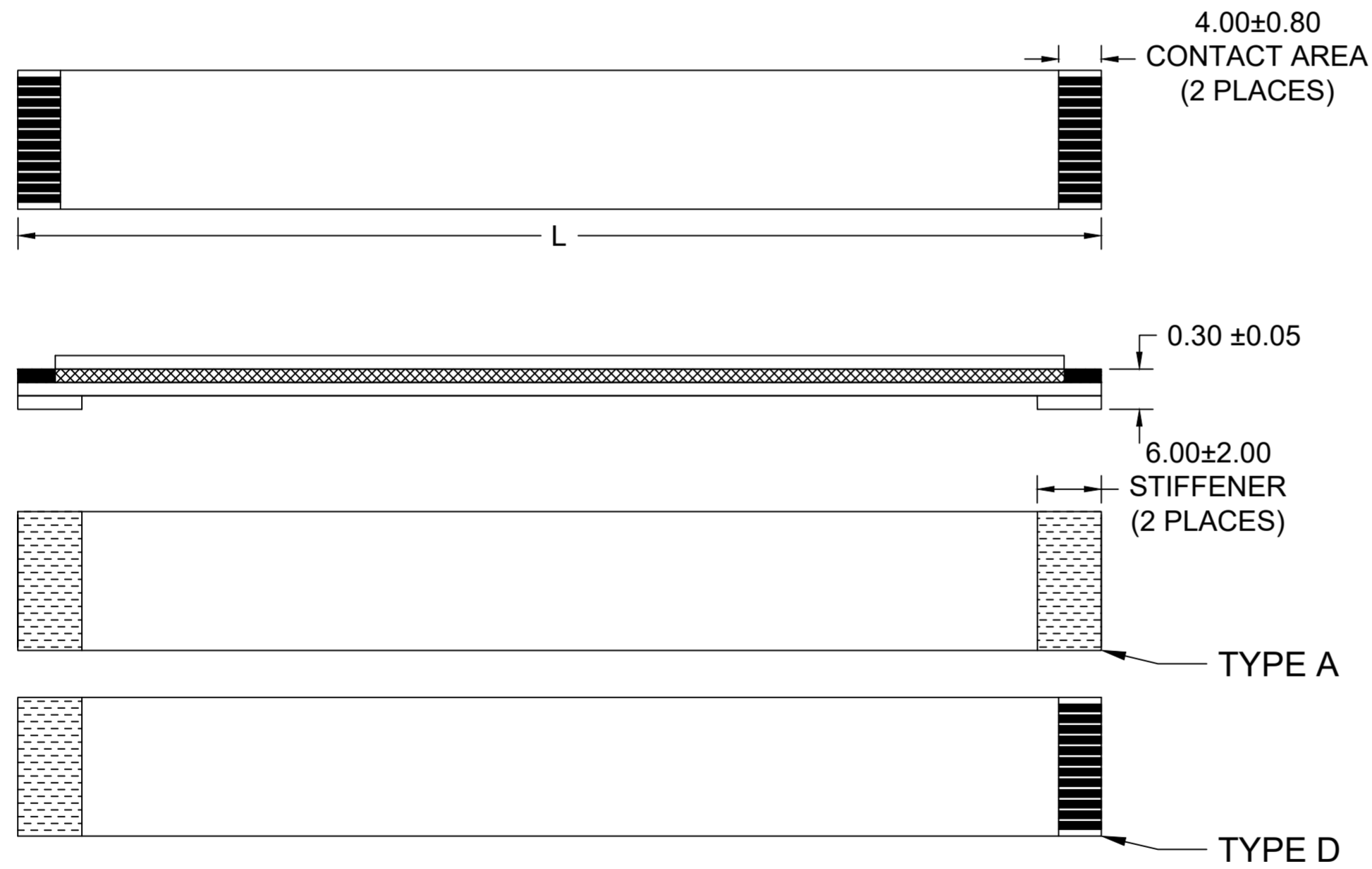

NOTES:

- NO PRINTING ON JUMPER CABLE UNLESS OTHERWISE SPECIFIED. IF PRINTING IS REQUIRED, THEN IT WOULD BE CONSIDERED A SPECIAL JUMPER CABLE.
- FOR ODD CIRCUIT COUNT, CROSS-SECTION AND END-TAIL DETAIL REFER TO SHEET # 2

| | | | | | | | | | | | | | | | |
|---|--|----------------|-------|---|--|--------------|--|---------------------|--|-------------------|--|---------------|--|------------|--|
| THIS DRAWING CONTAINS INFORMATION THAT IS PROPRIETARY TO MOLEX ELECTRONIC TECHNOLOGIES, LLC AND SHOULD NOT BE USED WITHOUT WRITTEN PERMISSION | | | | | | | | | | | | | | | |
| DIMENSION UNITS | | SCALE | | CURRENT REV DESC: DRAWING CORRECTION | | | | | | | | | | | |
| MM | | 2:1 | | <p>1.00MM CENTER FLAT FLEX CABLE (FFC) (105°C, AU PLATED) SALES DRAWING</p> <p>PRODUCT CUSTOMER DRAWING</p> | | | | | | | | | | | |
| GENERAL TOLERANCES (UNLESS SPECIFIED) | | | | | | | | | | EC NO: 728054 | | DRWN: DIEGOG7 | | 2022/11/10 | |
| | | mm | INCH | | | | | | | CHK'D: JSMITH11 | | 2022/11/14 | | | |
| 4 PLACES | | ±---- | ±---- | | | | | | | APPR: JSMITH11 | | 2022/11/14 | | | |
| 3 PLACES | | ±---- | ±---- | | | | | | | INITIAL REVISION: | | DRWN: DIEGOG7 | | 2022/06/01 | |
| 2 PLACES | | ±---- | ±---- | APPR: JSMITH11 | | 2022/11/03 | | | | | | | | | |
| 1 PLACE | | ±---- | ±---- | DRWN: DIEGOG7 | | 2022/06/01 | | | | | | | | | |
| 0 PLACES | | ±---- | ±---- | APPR: JSMITH11 | | 2022/11/03 | | | | | | | | | |
| ANGULAR TOL ± 0.5 ° | | | | THIRD ANGLE PROJECTION | | DRAWING | | SERIES | | | | | | | |
| DRAFT WHERE APPLICABLE MUST REMAIN WITHIN DIMENSIONS | | | | | | C-SIZE | | 15039 | | | | | | | |
| DOCUMENT STATUS | | | | P1 | | RELEASE DATE | | 2022/11/14 14:34:26 | | | | | | | |
| DOCUMENT NUMBER | | 150390001 | | DOC TYPE | | PSD | | DOC PART | | | | | | | |
| CUSTOMER | | GENERAL MARKET | | REVISION | | 000 | | B | | | | | | | |
| MATERIAL NUMBER | | | | SEE CHART | | CUSTOMER | | SHEET NUMBER | | | | | | | |
| | | | | | | | | 1 OF 2 | | | | | | | |

1.00mm CENTER FLAT FLEX CABLE (FFC) (105°C, Au PLATING)

| "L" DIM. → | 30 ± 2 MM | | 51 ± 2 MM | | 76 ± 3 MM | | 102 ± 3 MM | | 127 ± 4 MM | | 152 ± 4 MM | | 178 ± 4 MM | | 203 ± 4 MM | | 229 ± 5 MM | | 254 ± 5 MM | | 305 ± 5 MM | | | |
|--------------|-------------|-----------|------------|-----------|------------|-----------|------------|-----------|------------|-----------|------------|-----------|------------|-----------|------------|-----------|------------|-----------|-------------|-----------|-------------|-----------|---|--|
| REF DIM → | (1.18 INCH) | | (2 INCHES) | | (3 INCHES) | | (4 INCHES) | | (5 INCHES) | | (6 INCHES) | | (7 INCHES) | | (8 INCHES) | | (9 INCHES) | | (10 INCHES) | | (12 INCHES) | | | |
| CABLE TYPE → | A | | D | | A | | D | | A | | D | | A | | D | | A | | D | | A | | D | |
| CIRCUITS ↓ | A | D | A | D | A | D | A | D | A | D | A | D | A | D | A | D | A | D | A | D | A | D | | |
| 5 | 150390723 | 150390722 | 150390725 | 150390724 | 150390727 | 150390726 | 150390729 | 150390728 | 150390731 | 150390730 | 150390733 | 150390732 | 150390735 | 150390734 | 150390737 | 150390736 | 150390739 | 150390738 | 150390741 | 150390740 | 150390743 | 150390742 | | |
| 7 | 150390745 | 150390744 | 150390747 | 150390746 | 150390749 | 150390748 | 150390751 | 150390750 | 150390753 | 150390752 | 150390755 | 150390754 | 150390757 | 150390756 | 150390759 | 150390758 | 150390761 | 150390760 | 150390763 | 150390762 | 150390765 | 150390764 | | |
| 9 | 150390767 | 150390766 | 150390769 | 150390768 | 150390771 | 150390770 | 150390773 | 150390772 | 150390775 | 150390774 | 150390777 | 150390776 | 150390779 | 150390778 | 150390781 | 150390780 | 150390783 | 150390782 | 150390785 | 150390784 | 150390787 | 150390786 | | |
| 11 | 150390789 | 150390788 | 150390791 | 150390790 | 150390793 | 150390792 | 150390795 | 150390794 | 150390797 | 150390796 | 150390799 | 150390798 | 150390801 | 150390800 | 150390803 | 150390802 | 150390805 | 150390804 | 150390807 | 150390806 | 150390809 | 150390808 | | |
| 13 | 150390811 | 150390810 | 150390813 | 150390812 | 150390815 | 150390814 | 150390817 | 150390816 | 150390819 | 150390818 | 150390821 | 150390820 | 150390823 | 150390822 | 150390825 | 150390824 | 150390827 | 150390826 | 150390829 | 150390828 | 150390831 | 150390830 | | |
| 15 | 150390833 | 150390832 | 150390835 | 150390834 | 150390837 | 150390836 | 150390839 | 150390838 | 150390841 | 150390840 | 150390843 | 150390842 | 150390845 | 150390844 | 150390847 | 150390846 | 150390849 | 150390848 | 150390851 | 150390850 | 150390853 | 150390852 | | |
| 17 | 150390855 | 150390854 | 150390857 | 150390856 | 150390859 | 150390858 | 150390861 | 150390860 | 150390863 | 150390862 | 150390865 | 150390864 | 150390867 | 150390866 | 150390869 | 150390868 | 150390871 | 150390870 | 150390873 | 150390872 | 150390875 | 150390874 | | |
| 19 | 150390877 | 150390876 | 150390879 | 150390878 | 150390881 | 150390880 | 150390883 | 150390882 | 150390885 | 150390884 | 150390887 | 150390886 | 150390889 | 150390888 | 150390891 | 150390890 | 150390893 | 150390892 | 150390895 | 150390894 | 150390897 | 150390896 | | |
| 21 | 150390899 | 150390898 | 150390901 | 150390900 | 150390903 | 150390902 | 150390905 | 150390904 | 150390907 | 150390906 | 150390909 | 150390908 | 150390911 | 150390910 | 150390913 | 150390912 | 150390915 | 150390914 | 150390917 | 150390916 | 150390919 | 150390918 | | |
| 23 | 150390921 | 150390920 | 150390923 | 150390922 | 150390925 | 150390924 | 150390927 | 150390926 | 150390929 | 150390928 | 150390931 | 150390930 | 150390933 | 150390932 | 150390935 | 150390934 | 150390937 | 150390936 | 150390939 | 150390938 | 150390941 | 150390940 | | |
| 25 | 150390943 | 150390942 | 150390945 | 150390944 | 150390947 | 150390946 | 150390949 | 150390948 | 150390951 | 150390950 | 150390953 | 150390952 | 150390955 | 150390954 | 150390957 | 150390956 | 150390959 | 150390958 | 150390961 | 150390960 | 150390963 | 150390962 | | |
| 27 | 150390965 | 150390964 | 150390967 | 150390966 | 150390969 | 150390968 | 150390971 | 150390970 | 150390973 | 150390972 | 150390975 | 150390974 | 150390977 | 150390976 | 150390979 | 150390978 | 150390981 | 150390980 | 150390983 | 150390982 | 150390985 | 150390984 | | |
| 29 | 150390987 | 150390986 | 150390989 | 150390988 | 150390991 | 150390990 | 150390993 | 150390992 | 150390995 | 150390994 | 150390997 | 150390996 | 150390999 | 150390998 | 150391001 | 150391000 | 150391003 | 150391002 | 150391005 | 150391004 | 150391007 | 150391006 | | |
| 31 | 150391009 | 150391008 | 150391011 | 150391010 | 150391013 | 150391012 | 150391015 | 150391014 | 150391017 | 150391016 | 150391019 | 150391018 | 150391021 | 150391020 | 150391023 | 150391022 | 150391025 | 150391024 | 150391027 | 150391026 | 150391029 | 150391028 | | |
| 33 | 150391031 | 150391030 | 150391033 | 150391032 | 150391035 | 150391034 | 150391037 | 150391036 | 150391039 | 150391038 | 150391041 | 150391040 | 150391043 | 150391042 | 150391045 | 150391044 | 150391047 | 150391046 | 150391049 | 150391048 | 150391051 | 150391050 | | |
| 35 | 150391053 | 150391052 | 150391055 | 150391054 | 150391057 | 150391056 | 150391059 | 150391058 | 150391061 | 150391060 | 150391063 | 150391062 | 150391065 | 150391064 | 150391067 | 150391066 | 150391069 | 150391068 | 150391071 | 150391070 | 150391073 | 150391072 | | |
| 37 | 150391075 | 150391074 | 150391077 | 150391076 | 150391079 | 150391078 | 150391081 | 150391080 | 150391083 | 150391082 | 150391085 | 150391084 | 150391087 | 150391086 | 150391089 | 150391088 | 150391091 | 150391090 | 150391093 | 150391092 | 150391095 | 150391094 | | |
| 39 | 150391097 | 150391096 | 150391099 | 150391098 | 150391101 | 150391100 | 150391103 | 150391102 | 150391105 | 150391104 | 150391107 | 150391106 | 150391109 | 150391108 | 150391111 | 150391110 | 150391113 | 150391112 | 150391115 | 150391114 | 150391117 | 150391116 | | |

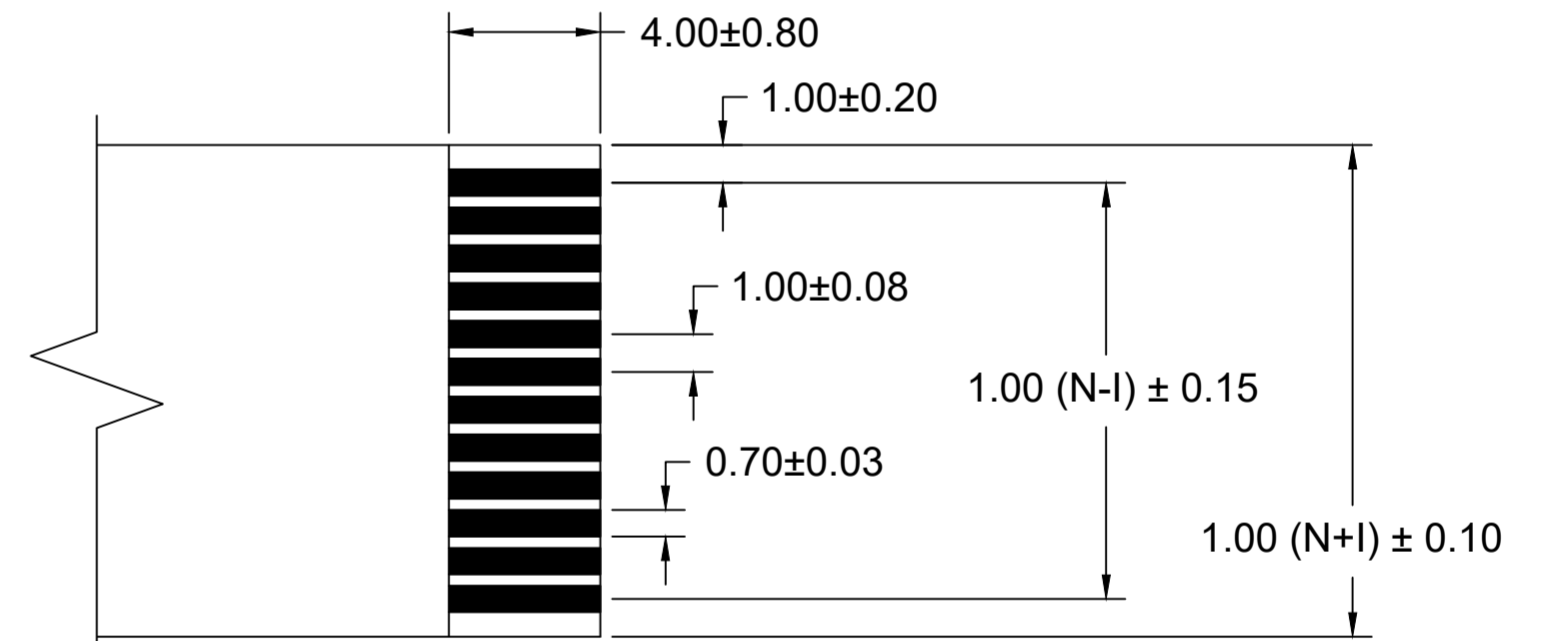

END TAIL DETAIL
SCALE 5:1

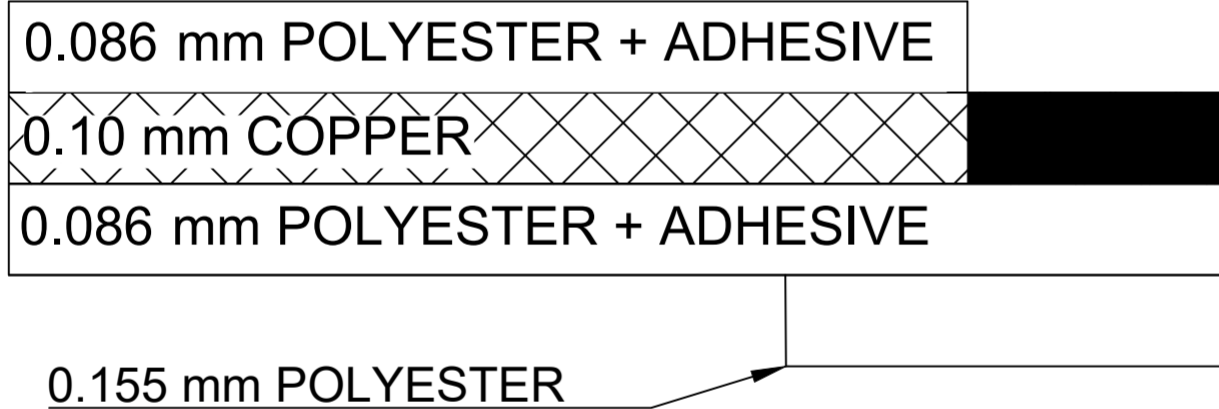

CROSS-SECTION

NOTES:

- NO PRINTING ON JUMPER CABLE UNLESS OTHERWISE SPECIFIED. IF PRINTING IS REQUIRED, THEN IT WOULD BE CONSIDERED A SPECIAL JUMPER CABLE.

| | | | | | | | | | |
|---|-------|-------|------|---|--|---------------------|--|--------------------------------|--|
| THIS DRAWING CONTAINS INFORMATION THAT IS PROPRIETARY TO MOLEX ELECTRONIC TECHNOLOGIES, LLC AND SHOULD NOT BE USED WITHOUT WRITTEN PERMISSION | | | | | | | | | |
| DIMENSION UNITS | | SCALE | | CURRENT REV DESC: DRAWING CORRECTION | | | | | |
| MM | | NA | | <p>molex</p> <p>1.00MM CENTER FLAT FLEX CABLE (FFC) (105°C, AU PLATED) SALES DRAWING</p> | | | | | |
| GENERAL TOLERANCES (UNLESS SPECIFIED) | | | | | | | | | |
| | mm | | INCH | EC NO: 728054 | | 2022/11/10 | | DOCUMENT NUMBER | |
| 4 PLACES | ±---- | ±---- | | DRWN: DIEGOG7 | | 2022/11/14 | | 150390001 | |
| 3 PLACES | ±---- | ±---- | | CHK'D: JSMITH11 | | 2022/11/14 | | DOC TYPE DOC PART REVISION | |
| 2 PLACES | ±---- | ±---- | | APPR: JSMITH11 | | 2022/11/14 | | PSD 000 B | |
| 1 PLACE | ±---- | ±---- | | INITIAL REVISION: | | | | | |
| 0 PLACES | ±---- | ±---- | | DRWN: DIEGOG7 | | 2022/06/01 | | MATERIAL NUMBER | |
| ANGULAR TOL ± 0.5 ° | | | | APPR: JSMITH11 | | 2022/11/03 | | CUSTOMER | |
| DRAFT WHERE APPLICABLE MUST REMAIN WITHIN DIMENSIONS | | | | THIRD ANGLE PROJECTION | | DRAWING | | SERIES | |
| | | | | | | C-SIZE | | 15039 | |
| DOCUMENT STATUS | | P1 | | RELEASE DATE | | 2022/11/14 14:34:26 | | SEE CHART | |
| 12 | | 11 | | 10 | | 9 | | 2 OF 2 | |

1.00MM CENTER FFC JUMPER CABLE (HIGH TEMPERATURE) CHART

| "A" DIM. | 1.18 ± .079 INCHES 30 ± 2.00 | | 2 ± .079 INCHES 51 ± 2.00 MM | | 3 ± .118 INCHES 76 ± 3.00 MM | | 4 ± .118 INCHES 102 ± 3.00 MM | | 5 ± .157 INCHES 127 ± 4.00 MM | | 6 ± .157 INCHES 152 ± 4.00 MM | | 7 ± .157 INCHES 178 ± 4.00 MM | | 8 ± .157 INCHES 203 ± 4.00 MM | | 9 ± .197 INCHES 229 ± 5.00 MM | | 10 ± .197 INCHES 254 ± 5.00 MM | | 12 ± .197 INCHES 305 ± 5.00 MM | |
|----------|---------------------------------|-----------|---------------------------------|-----------|---------------------------------|-----------|----------------------------------|-----------|----------------------------------|-----------|----------------------------------|-----------|----------------------------------|-----------|----------------------------------|-----------|----------------------------------|-----------|-----------------------------------|-----------|-----------------------------------|-----------|
| | STIFFENER | TYPE "A" | TYPE "D" | TYPE "A" | TYPE "D" | TYPE "A" | TYPE "D" | TYPE "A" | TYPE "D" | TYPE "A" | TYPE "D" | TYPE "A" | TYPE "D" | TYPE "A" | TYPE "D" | TYPE "A" | TYPE "D" | TYPE "A" | TYPE "D" | TYPE "A" | TYPE "D" | TYPE "A" |
| CKTS: 4 | 150390701 | 150390700 | 150390703 | 150390702 | 150390705 | 150390704 | 150390707 | 150390706 | 150390709 | 150390708 | 150390711 | 150390710 | 150390713 | 150390712 | 150390715 | 150390714 | 150390717 | 150390716 | 150390719 | 150390718 | 150390721 | 150390720 |
| CKTS: 6 | 150390201 | 150390202 | 150390203 | 150390204 | 150390205 | 150390206 | 150390207 | 150390208 | 150390209 | 150390210 | 150390211 | 150390212 | 150390213 | 150390214 | 150390215 | 150390216 | 150390217 | 150390218 | 150390219 | 150390220 | 150390221 | 150390222 |
| CKTS: 8 | 150390223 | 150390224 | 150390225 | 150390226 | 150390227 | 150390228 | 150390229 | 150390230 | 150390231 | 150390232 | 150390233 | 150390234 | 150390235 | 150390236 | 150390237 | 150390238 | 150390239 | 150390240 | 150390241 | 150390242 | 150390243 | 150390244 |
| CKTS: 10 | 150390245 | 150390246 | 150390247 | 150390248 | 150390249 | 150390250 | 150390251 | 150390252 | 150390253 | 150390254 | 150390255 | 150390256 | 150390257 | 150390258 | 150390259 | 150390260 | 150390261 | 150390262 | 150390263 | 150390264 | 150390265 | 150390266 |
| CKTS: 12 | 150390267 | 150390268 | 150390269 | 150390270 | 150390271 | 150390272 | 150390273 | 150390274 | 150390275 | 150390276 | 150390277 | 150390278 | 150390279 | 150390280 | 150390281 | 150390282 | 150390283 | 150390284 | 150390285 | 150390286 | 150390287 | 150390288 |
| CKTS: 14 | 150390289 | 150390290 | 150390291 | 150390292 | 150390293 | 150390294 | 150390295 | 150390296 | 150390297 | 928670298 | 150390299 | 150390300 | 150390301 | 150390302 | 150390303 | 150390304 | 150390305 | 150390306 | 150390307 | 150390308 | 150390309 | 150390310 |
| CKTS: 16 | 150390311 | 150390312 | 150390313 | 150390314 | 150390315 | 150390316 | 150390317 | 150390318 | 150390319 | 150390320 | 150390321 | 150390322 | 150390323 | 150390324 | 150390325 | 150390326 | 150390327 | 150390328 | 150390329 | 150390330 | 150390331 | 150390332 |
| CKTS: 18 | 150390333 | 150390334 | 150390335 | 150390336 | 150390337 | 150390338 | 150390339 | 150390340 | 150390341 | 150390342 | 150390343 | 150390344 | 150390345 | 150390346 | 150390347 | 150390348 | 150390349 | 150390350 | 150390351 | 150390352 | 150390353 | 150390354 |
| CKTS: 20 | 150390355 | 150390356 | 150390357 | 150390358 | 150390359 | 150390360 | 150390361 | 150390362 | 150390363 | 150390364 | 150390365 | 150390366 | 150390367 | 150390368 | 150390369 | 150390370 | 150390371 | 150390372 | 150390373 | 150390374 | 150390375 | 150390376 |
| CKTS: 22 | 150390377 | 150390378 | 150390379 | 150390380 | 150390381 | 150390382 | 150390383 | 150390384 | 150390385 | 150390386 | 150390387 | 150390388 | 150390389 | 150390390 | 150390391 | 150390392 | 150390393 | 150390394 | 150390395 | 150390396 | 150390397 | 150390398 |
| CKTS: 24 | 150390399 | 150390400 | 150390401 | 150390402 | 150390403 | 150390404 | 150390405 | 150390406 | 150390407 | 150390408 | 150390409 | 150390410 | 150390411 | 150390412 | 150390413 | 150390414 | 150390415 | 150390416 | 150390417 | 150390418 | 150390419 | 150390420 |
| CKTS: 26 | 150390421 | 150390422 | 150390423 | 150390424 | 150390425 | 150390426 | 150390427 | 150390428 | 150390429 | 150390430 | 150390431 | 150390432 | 150390433 | 150390434 | 150390435 | 150390436 | 150390437 | 150390438 | 150390439 | 150390440 | 150390441 | 150390442 |
| CKTS: 28 | 150390443 | 150390444 | 150390445 | 150390446 | 150390447 | 150390448 | 150390449 | 150390450 | 150390451 | 150390452 | 150390453 | 150390454 | 150390455 | 150390456 | 150390457 | 150390458 | 150390459 | 150390460 | 150390461 | 150390462 | 150390463 | 150390464 |
| CKTS: 30 | 150390465 | 150390466 | 150390467 | 150390468 | 150390469 | 150390470 | 150390471 | 150390472 | 150390473 | 150390474 | 150390475 | 150390476 | 150390477 | 150390478 | 150390479 | 150390480 | 150390481 | 150390482 | 150390483 | 150390484 | 150390485 | 150390486 |
| CKTS: 32 | 150390487 | 150390488 | 150390489 | 150390490 | 150390491 | 150390492 | 150390493 | 150390494 | 150390495 | 150390496 | 150390497 | 150390498 | 150390499 | 150390500 | 150390501 | 150390502 | 150390503 | 150390504 | 150390505 | 150390506 | 150390507 | 150390508 |
| CKTS: 34 | 150390509 | 150390510 | 150390511 | 150390512 | 150390513 | 150390514 | 150390515 | 150390516 | 150390517 | 150390518 | 150390519 | 150390520 | 150390521 | 150390522 | 150390523 | 150390524 | 150390525 | 150390526 | 150390527 | 150390528 | 150390529 | 150390530 |
| CKTS: 36 | 150390531 | 150390532 | 150390533 | 150390534 | 150390535 | 150390536 | 150390537 | 150390538 | 150390539 | 150390540 | 150390541 | 150390542 | 150390543 | 150390544 | 150390545 | 150390546 | 150390547 | 150390548 | 150390549 | 150390550 | 150390551 | 150390552 |
| CKTS: 38 | 150390553 | 150390554 | 150390555 | 150390556 | 150390557 | 150390558 | 150390559 | 150390560 | 150390561 | 150390562 | 150390563 | 150390564 | 150390565 | 150390566 | 150390567 | 150390568 | 150390569 | 150390570 | 150390571 | 150390572 | 150390573 | 150390574 |
| CKTS: 40 | 150390575 | 150390576 | 150390577 | 150390578 | 150390579 | 150390580 | 150390581 | 150390582 | 150390583 | 150390584 | 150390585 | 150390586 | 150390587 | 150390588 | 150390589 | 150390590 | 150390591 | 150390592 | 150390593 | 150390594 | 150390595 | 150390596 |

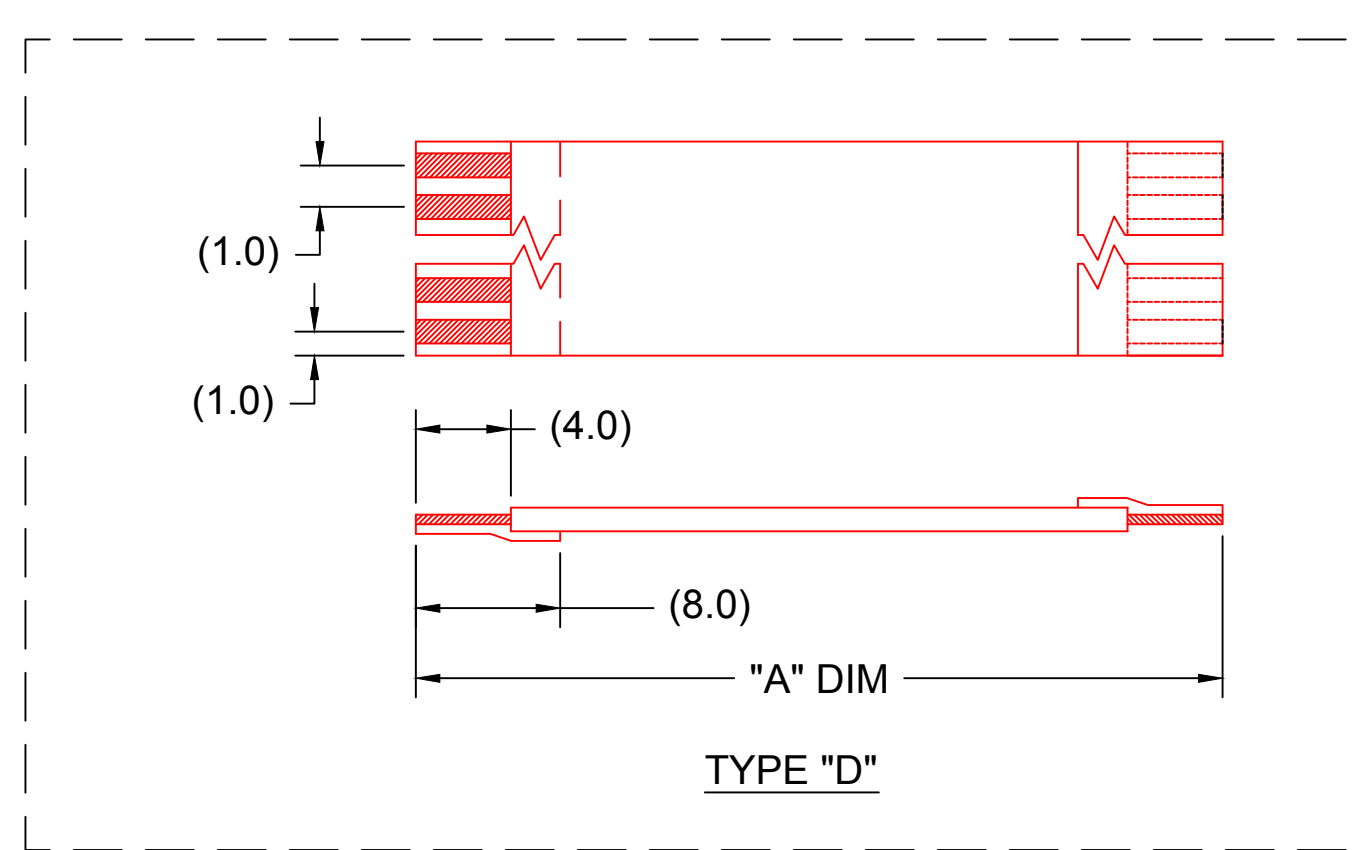
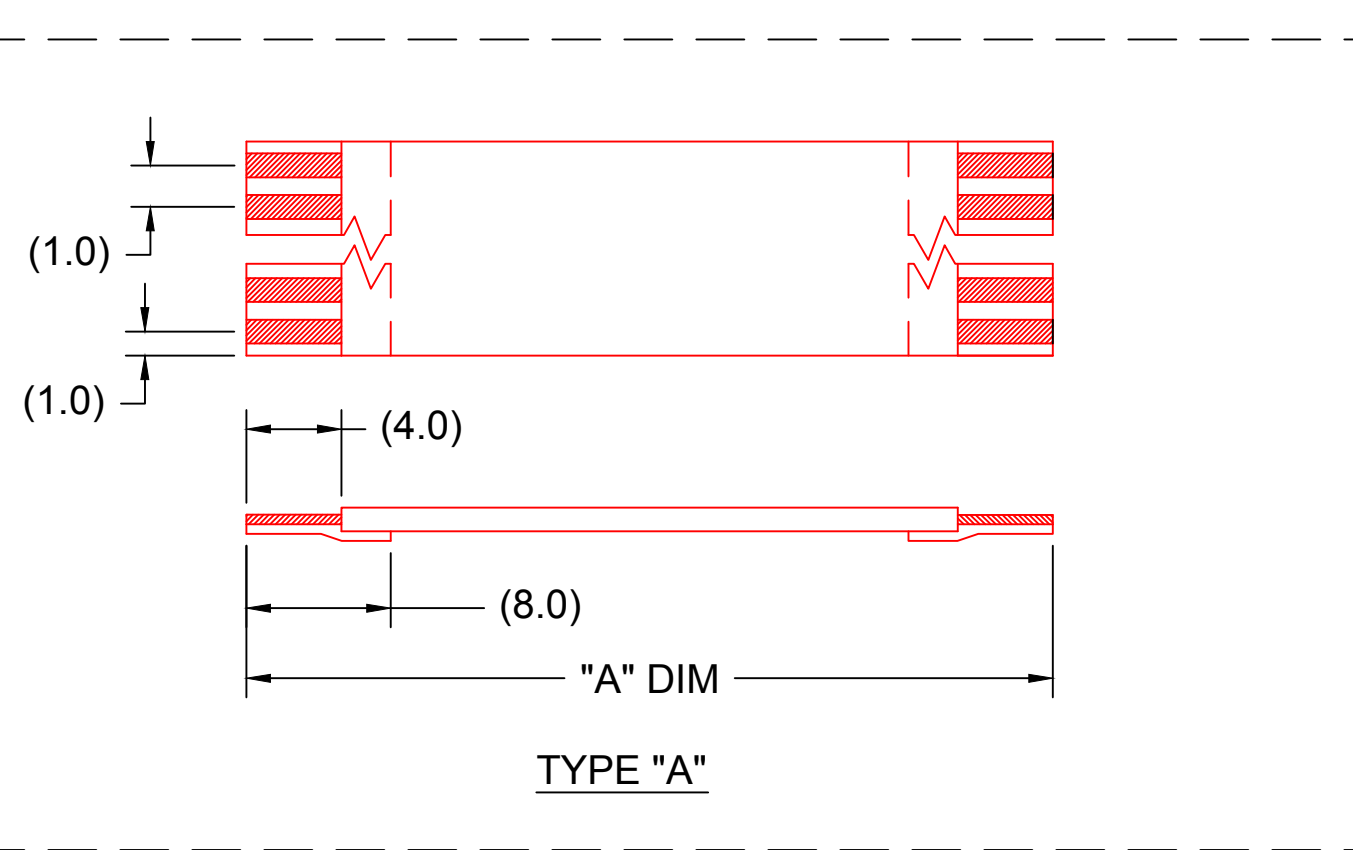

NOTES:
 1. NO PRINTING ON JUMPER CABLE UNLESS OTHERWISE SPECIFIED. IF PRINTING IS REQUIRED, THEN IT WOULD BE CONSIDERED A SPECIAL JUMPER CABLE.

| | | | | | | | |
|---|-------------------------------|---|----------------------------------|---|------------------------|---------------------------|----------------------------|
| RELEASED EC NO: USW2011-0065 DRWN: JLW 2010/09/30 | QUALITY SYMBOL ▽=0 ▽C=0 | GENERAL TOLERANCES (UNLESS SPECIFIED) | DIMENSION STYLE MM | SCALE --- | DESIGN UNITS METRIC | THIRD ANGLE PROJECTION | |
| | | 4 PLACES ±--- ±--- 3 PLACES ±--- ±--- 2 PLACES ±--- ±--- 1 PLACE ±--- ±--- | DRAWN BY DATE --- | TITLE 1.00MM CENTER FFC JUMPER CABLE AU PLATING | | | |
| | | ANGULAR ±1/2° | CHECKED BY DATE --- | APPROVED BY DATE SFULTON 2011/03/23 | | | |
| | | DRAFT WHERE APPLICABLE MUST REMAIN WITHIN DIMENSIONS | MATERIAL NO. SEE CHART | MOLEX INCORPORATED | | MOLEX INCORPORATED | |
| | 1 | | SIZE C | DOCUMENT NO. SD-15039-001 | | | SHEET NO. 1 OF 2 |

THIS DRAWING CONTAINS INFORMATION THAT IS PROPRIETARY TO MOLEX INCORPORATED AND SHOULD NOT BE USED WITHOUT WRITTEN PERMISSION

1.00MM CENTER FFC JUMPER CABLE (HIGH TEMPERATURE) CHART

| "A" DIM. | 1.18 ± .079 INCHES 30 ± 2.00 | | 2 ± .079 INCHES 51 ± 2.00 MM | | 3 ± .118 INCHES 76 ± 3.00 MM | | 4 ± .118 INCHES 102 ± 3.00 MM | | 5 ± .157 INCHES 127 ± 4.00 MM | | 6 ± .157 INCHES 152 ± 4.00 MM | | 7 ± .157 INCHES 178 ± 4.00 MM | | 8 ± .157 INCHES 203 ± 4.00 MM | | 9 ± .197 INCHES 229 ± 5.00 MM | | 10 ± .197 INCHES 254 ± 5.00 MM | | 12 ± .197 INCHES 305 ± 5.00 MM | |
|----------|---------------------------------|-----------|---------------------------------|-----------|---------------------------------|-----------|----------------------------------|-----------|----------------------------------|-----------|----------------------------------|-----------|----------------------------------|-----------|----------------------------------|-----------|----------------------------------|-----------|-----------------------------------|-----------|-----------------------------------|-----------|
| | STIFFENER | TYPE "A" | TYPE "D" | TYPE "A" | TYPE "D" | TYPE "A" | TYPE "D" | TYPE "A" | TYPE "D" | TYPE "A" | TYPE "D" | TYPE "A" | TYPE "D" | TYPE "A" | TYPE "D" | TYPE "A" | TYPE "D" | TYPE "A" | TYPE "D" | TYPE "A" | TYPE "D" | TYPE "A" |
| CKTS: 5 | 150390723 | 150390722 | 150390725 | 150390724 | 150390727 | 150390726 | 150390729 | 150390728 | 150390731 | 150390730 | 150390733 | 150390732 | 150390735 | 150390734 | 150390737 | 150390736 | 150390739 | 150390738 | 150390741 | 150390740 | 150390743 | 150390742 |
| CKTS: 7 | 150390745 | 150390744 | 150390747 | 150390746 | 150390749 | 150390748 | 150390751 | 150390750 | 150390753 | 150390752 | 150390755 | 150390754 | 150390757 | 150390756 | 150390759 | 150390758 | 150390761 | 150390760 | 150390763 | 150390762 | 150390765 | 150390764 |
| CKTS: 9 | 150390767 | 150390766 | 150390769 | 150390768 | 150390771 | 150390770 | 150390773 | 150390772 | 150390775 | 150390774 | 150390777 | 150390776 | 150390779 | 150390778 | 150390781 | 150390780 | 150390783 | 150390782 | 150390785 | 150390784 | 150390787 | 150390786 |
| CKTS: 11 | 150390789 | 150390788 | 150390791 | 150390790 | 150390793 | 150390792 | 150390795 | 150390794 | 150390797 | 150390796 | 150390799 | 150390798 | 150390801 | 150390800 | 150390803 | 150390802 | 150390805 | 150390804 | 150390807 | 150390806 | 150390809 | 150390808 |
| CKTS: 13 | 150390811 | 150390810 | 150390813 | 150390812 | 150390815 | 150390814 | 150390817 | 150390816 | 150390819 | 150390818 | 150390821 | 150390820 | 150390823 | 150390822 | 150390825 | 150390824 | 150390827 | 150390826 | 150390829 | 150390828 | 150390831 | 150390830 |
| CKTS: 15 | 150390833 | 150390832 | 150390835 | 150390834 | 150390837 | 150390836 | 150390839 | 150390838 | 150390841 | 150390840 | 150390843 | 150390842 | 150390845 | 150390844 | 150390847 | 150390846 | 150390849 | 150390848 | 150390851 | 150390850 | 150390853 | 150390852 |
| CKTS: 17 | 150390855 | 150390854 | 150390857 | 150390856 | 150390859 | 150390858 | 150390861 | 150390860 | 150390863 | 150390862 | 150390865 | 150390864 | 150390867 | 150390866 | 150390869 | 150390868 | 150390871 | 150390870 | 150390873 | 150390872 | 150390875 | 150390874 |
| CKTS: 19 | 150390877 | 150390876 | 150390879 | 150390878 | 150390881 | 150390880 | 150390883 | 150390882 | 150390885 | 150390884 | 150390887 | 150390886 | 150390889 | 150390888 | 150390891 | 150390890 | 150390893 | 150390892 | 150390895 | 150390894 | 150390897 | 150390896 |
| CKTS: 21 | 150390899 | 150390898 | 150390901 | 150390900 | 150390903 | 150390902 | 150390905 | 150390904 | 150390907 | 150390906 | 150390909 | 150390908 | 150390911 | 150390910 | 150390913 | 150390912 | 150390915 | 150390914 | 150390917 | 150390916 | 150390919 | 150390918 |
| CKTS: 23 | 150390921 | 150390920 | 150390923 | 150390922 | 150390925 | 150390924 | 150390927 | 150390926 | 150390929 | 150390928 | 150390931 | 150390930 | 150390933 | 150390932 | 150390935 | 150390934 | 150390937 | 150390936 | 150390939 | 150390938 | 150390941 | 150390940 |
| CKTS: 25 | 150390943 | 150390942 | 150390945 | 150390944 | 150390947 | 150390946 | 150390949 | 150390948 | 150390951 | 150390950 | 150390953 | 150390952 | 150390955 | 150390954 | 150390957 | 150390956 | 150390959 | 150390958 | 150390961 | 150390960 | 150390963 | 150390962 |
| CKTS: 27 | 150390965 | 150390964 | 150390967 | 150390966 | 150390969 | 150390968 | 150390971 | 150390970 | 150390973 | 150390972 | 150390975 | 150390974 | 150390977 | 150390976 | 150390979 | 150390978 | 150390981 | 150390980 | 150390983 | 150390982 | 150390985 | 150390984 |
| CKTS: 29 | 150390987 | 150390986 | 150390989 | 150390988 | 150390991 | 150390990 | 150390993 | 150390992 | 150390995 | 150390994 | 150390997 | 150390996 | 150390999 | 150390998 | 150391001 | 150391000 | 150391003 | 150391002 | 150391005 | 150391004 | 150391007 | 150391006 |
| CKTS: 31 | 150391009 | 150391008 | 150391011 | 150391010 | 150391013 | 150391012 | 150391015 | 150391014 | 150391017 | 150391016 | 150391019 | 150391018 | 150391021 | 150391020 | 150391023 | 150391022 | 150391025 | 150391024 | 150391027 | 150391026 | 150391029 | 150391028 |
| CKTS: 33 | 150391031 | 150391030 | 150391033 | 150391032 | 150391035 | 150391034 | 150391037 | 150391036 | 150391039 | 150391038 | 150391041 | 150391040 | 150391043 | 150391042 | 150391045 | 150391044 | 150391047 | 150391046 | 150391049 | 150391048 | 150391051 | 150391050 |
| CKTS: 35 | 150391053 | 150391052 | 150391055 | 150391054 | 150391057 | 150391056 | 150391059 | 150391058 | 150391061 | 150391060 | 150391063 | 150391062 | 150391065 | 150391064 | 150391067 | 150391066 | 150391069 | 150391068 | 150391071 | 150391070 | 150391073 | 150391072 |
| CKTS: 37 | 150391075 | 150391074 | 150391077 | 150391076 | 150391079 | 150391078 | 150391081 | 150391080 | 150391083 | 150391082 | 150391085 | 150391084 | 150391087 | 150391086 | 150391089 | 150391088 | 150391091 | 150391090 | 150391093 | 150391092 | 150391095 | 150391094 |
| CKTS: 39 | 150391097 | 150391096 | 150391099 | 150391098 | 150391101 | 150391100 | 150391103 | 150391102 | 150391105 | 150391104 | 150391107 | 150391106 | 150391109 | 150391108 | 150391111 | 150391110 | 150391113 | 150391112 | 150391115 | 150391114 | 150391117 | 150391116 |

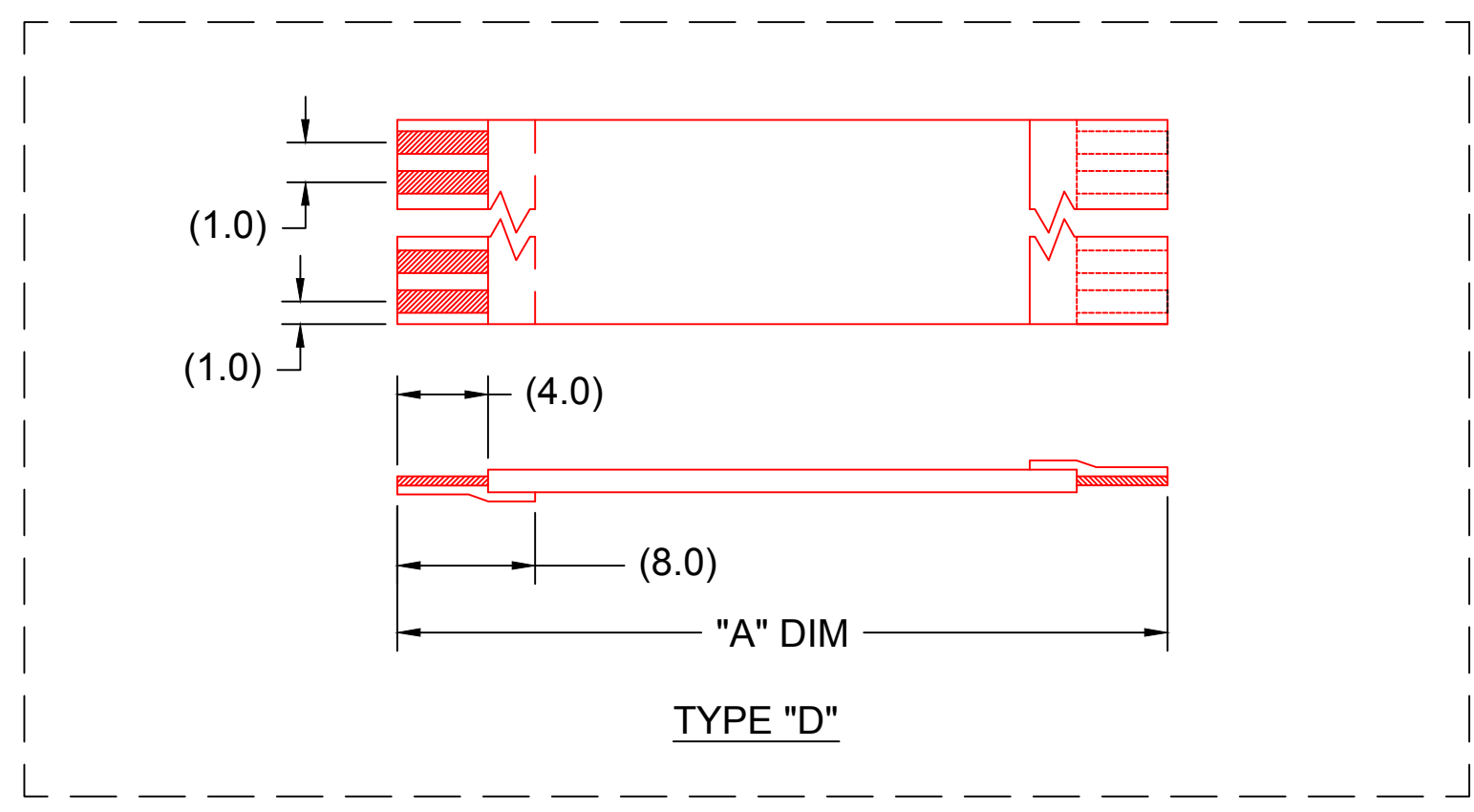
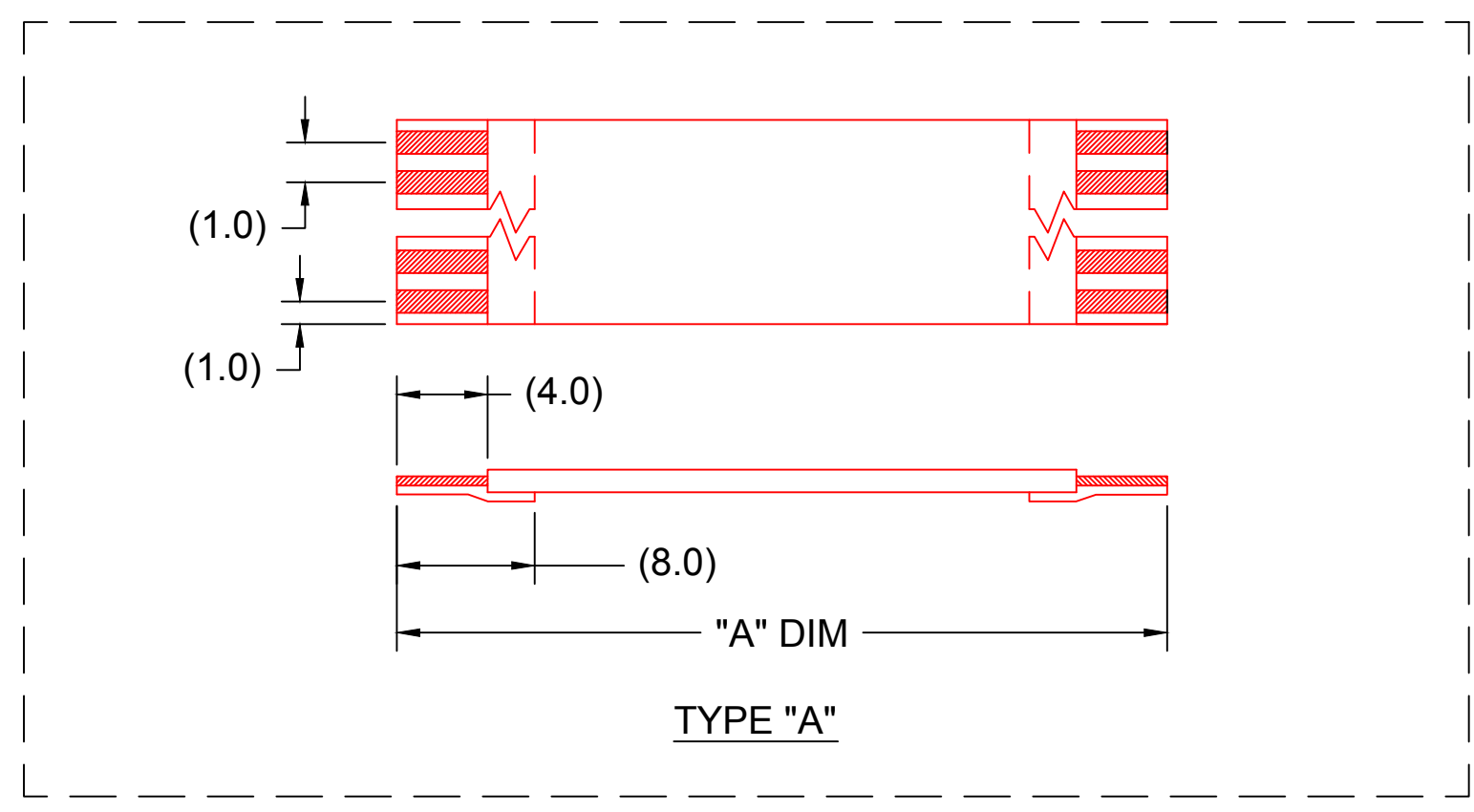

NOTES:
 1. NO PRINTING ON JUMPER CABLE UNLESS OTHERWISE SPECIFIED. IF PRINTING IS REQUIRED, THEN IT WOULD BE CONSIDERED A SPECIAL JUMPER CABLE.

| | | | | | | | | |
|-------------|------------------------|--------------------|--|---------------------------------------|---|--------------|--------------|------------------------|
| SEE SHEET 1 | EC NO: DRWN: REV | DESCRIPTION | QUALITY SYMBOL | GENERAL TOLERANCES (UNLESS SPECIFIED) | DIMENSION STYLE | SCALE | DESIGN UNITS | THIRD ANGLE PROJECTION |
| | | | ▽=0 | mm INCH | MM | --- | METRIC | |
| | | | ▽C=0 | 4 PLACES ±--- ±--- | DRAWN BY DATE | TITLE | | |
| | | | | 3 PLACES ±--- ±--- | CHECKED BY DATE | | | |
| | 2 PLACES ±--- ±--- | APPROVED BY DATE | MATERIAL NO. | DOCUMENT NO. | | | | |
| | 1 PLACE ±--- ±--- | SFULTON 2011/03/23 | | | SEE CHART | SD-15039-001 | | |
| | | | DRAFT WHERE APPLICABLE MUST REMAIN WITHIN DIMENSIONS | SIZE C | THIS DRAWING CONTAINS INFORMATION THAT IS PROPRIETARY TO MOLEX INCORPORATED AND SHOULD NOT BE USED WITHOUT WRITTEN PERMISSION | | | |

1.00MM CENTER FFC JUMPER CABLE AU PLATING

MOLEX INCORPORATED

SHEET NO. **2 OF 2**