

REVISIONS				
P	LTN	DESCRIPTION	DATE	APVD
E		REVISION PER B6648	1992/04	MX MX
E1		RELEASED IN NEW FORMAT	01MAY2016	ML SZ
E2		REACTIVED	20JUL2020	ML SZ

- ALL DIMENSIONS REFERENCE ONLY.
- MATERIAL:**  
BUS PLUG - HIGH CONNECTIVITY COPPER ALLOY
- FINISH:**  
SILVER PLATING OVER NICKEL PLATING ON CONTACT.
- COMPONENTS UNASSEMBLED IN A SEALED POLY BAG.
- MATED BUS BAR BOARD THICKNESS SHALL BE 3.175+/-0.05MM (.125+/-0.002 INCH)  
DETAIL APPLICATION INFORMATION, PLEASE REFER TO APPLICATION SPEC 114-2111.

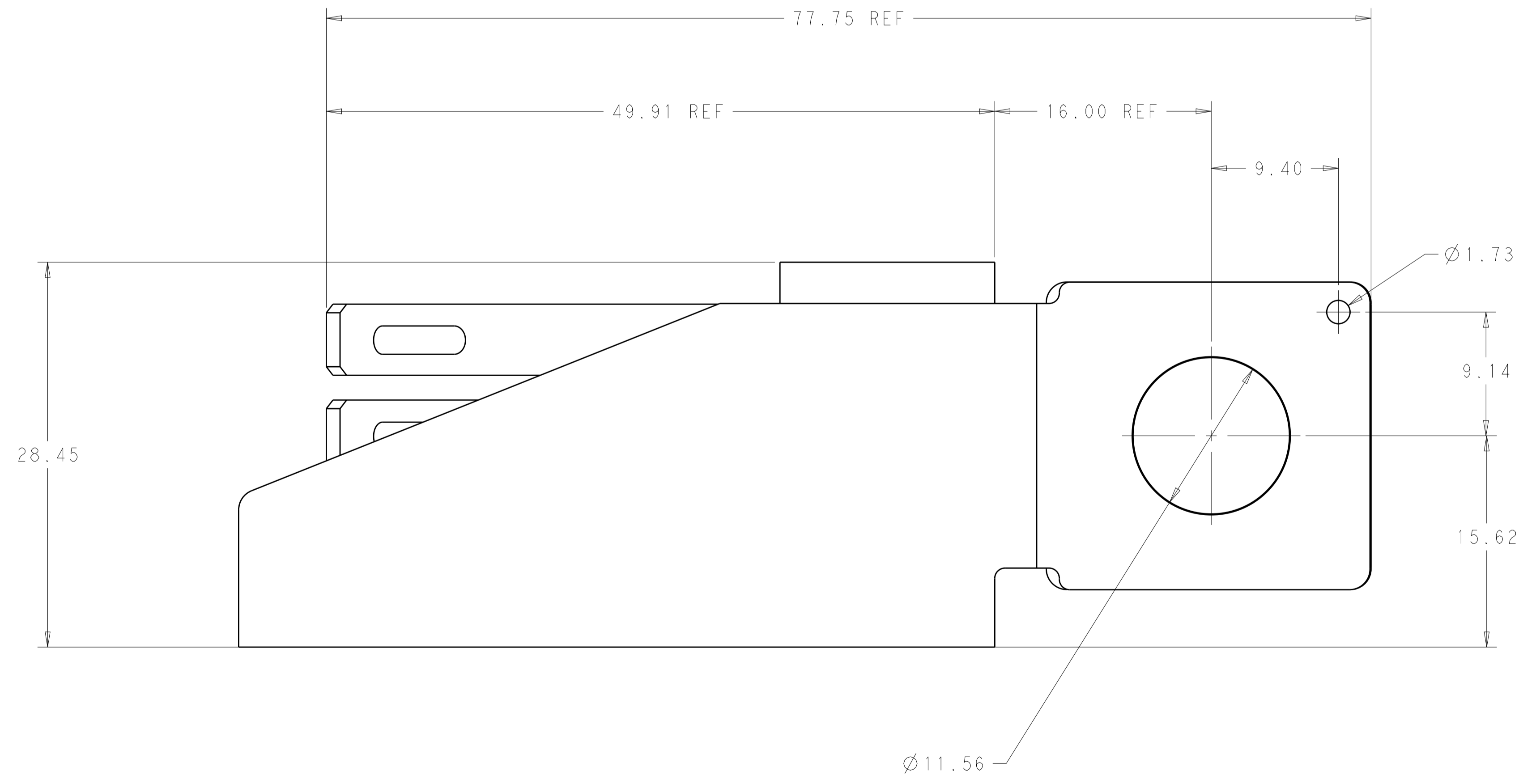
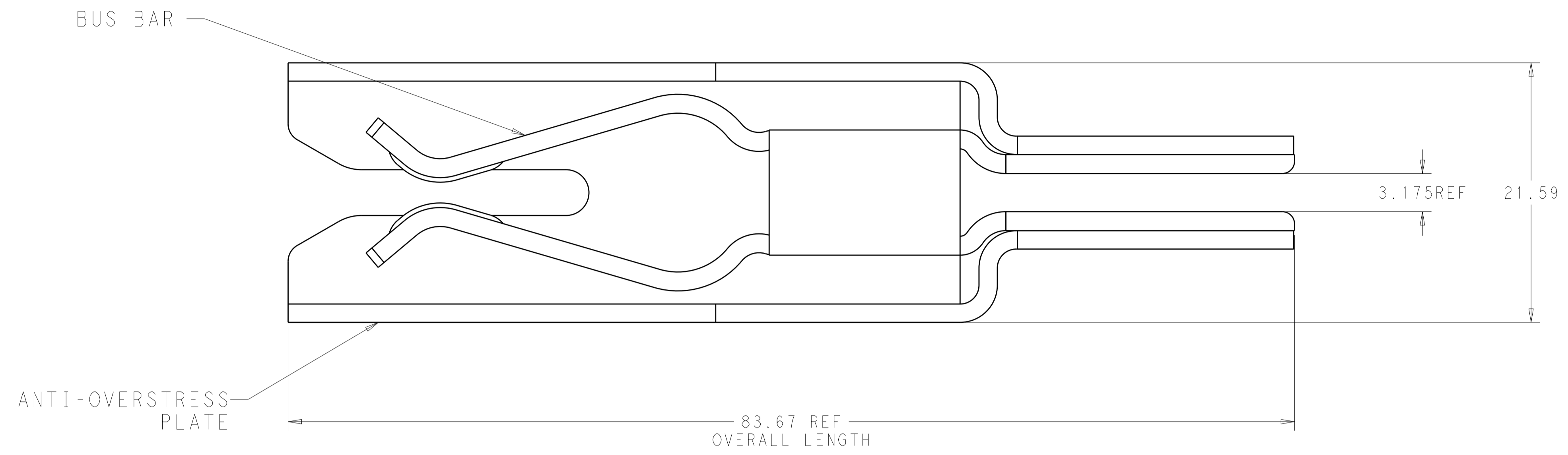

PLUGGABLE BUS BAR 125F2 POWER CONN	104501-1
DESCRIPTION	PART NUMBER

THIS DRAWING IS A CONTROLLED DOCUMENT.		DWN: MAC LIU 03FEB2016	 TE Connectivity
DIMENSIONS: mm		CHK: SUNY ZHAO 03FEB2016	
TOLERANCES UNLESS OTHERWISE SPECIFIED:		APVD: SUNY ZHAO 03FEB2016	NAME: AMP PDS 125F2 BUS W/GUIDE PLUGGABLE BUS BAR POWER SERIES
0 PLC ±0.8	1 PLC ±0.50	PRODUCT SPEC: 108-1101	SIZE: A1
2 PLC ±0.150	3 PLC ±0.150	APPLICATION SPEC: 114-2111	CAGE CODE: 104501
4 PLC ±0.150	ANGLES ±2°	WEIGHT: -	RESTRICTED TO: -
MATERIAL:	FINISH:	CUSTOMER DRAWING	SCALE: 1:1 SHEET 1 OF 1 REV: E2