

# Dialight

## 586 Series BASED LED T3 1/4 WEDGE (T10)



### FEATURES / BENEFITS

- ▲ RoHS Compliant
- ▲ Unique multi-LED design provide superior illumination and ability to mix colors
- ▲ True non-polarized design
- ▲ Incorporating AlInGaP and InGaN technology
- ▲ Mounts directly into industry standard socket
- ▲ High brightness with low current draw - uses up to 90% less energy than incandescent
- ▲ Long Life - up to 100K hours
- ▲ No heat generated
- ▲ Resistant to shock and vibration
- ▲ Colors include red, green, yellow, blue and white, as well as white/yellow and white/orange combinations

Dialight's line of based LED lamps is designed to directly replace many popular subminiature and miniature incandescent lamps. The benefits of LED technology over incandescent are significant: They offer long life, are shock resistant, withstand vibration and provide energy conservation.

### SPECIFICATIONS

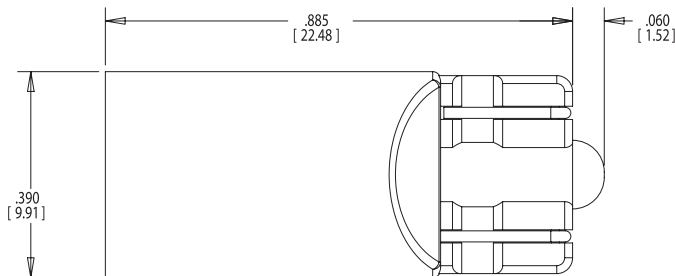

*Measurements are typical  
Dimensions are inches [mm]*

- ▲ Operating Voltages: 6,12,14 and 24 VDC
- ▲ Non-polarized
- ▲ Operating temperature: -30°C to +85°C
- ▲ Storage temperature: -40°C to +100°C
- ▲ Replaces incandescent lamp numbers\*: 159, 259, 444, 447, 555, 124, 158, 161, 168, 193, 194, 658, 184, 3-505, 3-507

\*See Dialight's Incandescent lamp/based LED cross reference for a complete listing

### CONSIDERATIONS

- ▲ Since lens caps act as filters for the light emitted from the based LED, it is important to match the emitting color of the LED. If not matched properly, the overall light output may be substantially reduced. Dialight recommends using transparent lenses, which will optimize the light output.
- ▲ Although these lamps can be operated at a lower voltage, which will increase the life, the intensity will be reduced.
- ▲ Operation of the based LED at a higher voltage should not exceed 10% above the recommended voltage.
- ▲ Dialight does not recommend that based LED lamps be used in neon sockets.

Dialight reserves the right to make changes at any time in order to supply the best product possible.



Dialight Corporation

1501 Route 34 South • Farmingdale, NJ 07727 USA  
Tel: (1) 732-919-3119 • Fax: (1) 732-751-5778 • www.dialight.com



MDEL586K001\_C

## T3 1/4 WEDGE NON-POLARIZED

PART NUMBER	COLOR	PEAK WAVELENGTH (nm)	VOLTAGE (VDC)	CURRENT TYP.-(mA)	INTENSITY TYP.-(mcd)	RoHS COMPLIANT
586-2201-201F	Red	615	6	69	770	✓
586-2202-201F	Green	528	6	30	300	✓
586-2203-201F	Yellow	591	6	69	550	✓
586-2205-201F	Blue	470	6	30	90	✓
586-2206-201F	White	*	6	30	630	✓
586-2201-202F	Red	615	12	37	820	✓
586-2202-202F	Green	528	12	19	380	✓
586-2203-202F	Yellow	591	12	37	590	✓
586-2205-202F	Blue	470	12	19	115	✓
586-2206-202F	White	*	12	19	800	✓
586-220A-202F	White/Yellow	* / 591	12	25	725	✓
586-220B-202F	White/Orange	* / 610	12	25	775	✓
586-2201-203F	Red	615	14	41	910	✓
586-2202-203F	Green	528	14	24	480	✓
586-2203-203F	Yellow	591	14	41	650	✓
586-2205-203F	Blue	470	14	24	145	✓
586-2206-203F	White	*	14	24	1000	✓
586-220A-203F	White/Yellow	* / 591	14	25	725	✓
586-220B-203F	White/Orange	* / 610	14	25	775	✓
586-2201-204F	Red	615	24	19	850	✓
586-2202-204F	Green	528	24	12	480	✓
586-2203-204F	Yellow	591	24	19	610	✓
586-2205-204F	Blue	470	24	12	145	✓
586-2206-204F	White	*	24	12	1000	✓
586-220A-204F	White/Yellow	* / 591	24	14	810	✓
586-220B-204F	White/Orange	* / 610	24	14	870	✓

## Based LEDs SELECTION

With the technological advancements in Light Emitting Diodes (LEDs) brightness can now rival the incandescent lamp when used in similar packages. These advancements have created a new type of product called the based LED - an LED with the functionality of an incandescent bulb.

The following styles are currently available in red, green, yellow, blue and white:

- ▲ T1 3/4 Midget Flange                      ▲ T1 3/4 Bi-Pin                                      ▲ T1 3/4 Wedge (T5)                      ▲ T2 Telephone Slide
- ▲ T3 1/4 Miniature Bayonet (BA9s)      ▲ T3 1/4 Miniature Screw (E10)              ▲ T3 1/4 Wedge (T10)                      ▲ 15mm SC Bayonet (BA15s)

Dialight's line of based LEDs continues to grow. Please visit our website for more information.  
[www.dialight.com](http://www.dialight.com)

Dialight reserves the right to make changes at any time  
in order to supply the best product possible.



Dialight Corporation  
1501 Route 34 South • Farmingdale, NJ 07727 USA  
Tel: (1) 732-919-3119 • Fax: (1) 732-751-5778 • [www.dialight.com](http://www.dialight.com)



MDEL586K001\_C