

**Male**

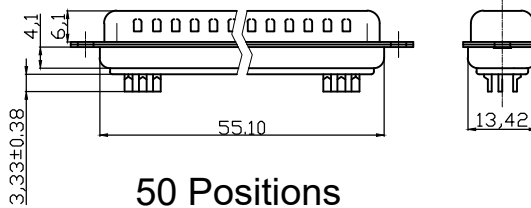
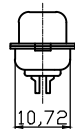
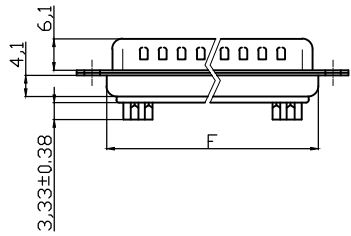
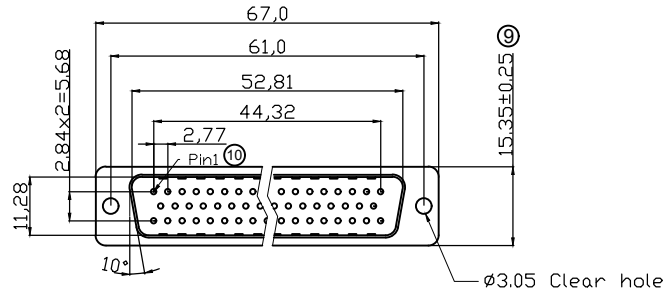
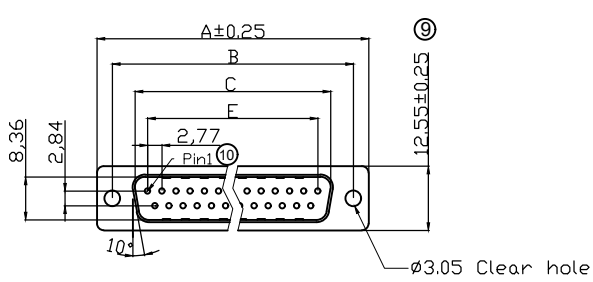

**50 Positions**

**Product Specification**

**Material**

- ⑨ Insulator : Glass-Filled Thermoplastic PBT,UL94V-0
- ⑨ Contact : Copper alloy, plating: see order code
- ⑥ Shell: Steel ,100u"Tin Over 50u" min Copper

**Electrical**

- Contact Resistance : 20 milliohms Max at 1 AMP DC.
- Insulation Resistance : 1000 magohms at 500 VDC
- Dielectric Withstanding Voltage : 1000 VAC/rms 60Hz for 1 minute
- Current Rating : 3 AMP
- Volatge Rating : 250 VAC/rms 60Hz

- ⑤ Durability :250 mating cycles
- Operating Temperature : -55°C+105°C
- ⑦ Soldering Temperature : 245±5°C in 10s
- ⑧ Recommended wire size: 28~30AWG

| D-SUB         |          |                |                       |                      |       |       |
|---------------|----------|----------------|-----------------------|----------------------|-------|-------|
| ORDERING CODE |          |                |                       |                      |       |       |
| Style         | Gender   | No of contacts | Plating specification | Insulator color      |       |       |
| A - D         | x        | xx             | LL/                   | x                    | - xx  |       |
| A - D         | F Female | 09             | LL/                   | Z Gold selective tin | Blank | White |
|               | S Male   | 15             |                       | G Gold flash         | BK    | Black |
|               |          | 25             |                       |                      | GY    | Gray  |
|               |          | 37             |                       |                      |       |       |
|               |          | 50             |                       |                      |       |       |

| Dimensions |       |       |       |       |       |
|------------|-------|-------|-------|-------|-------|
| Positions  | A     | B     | C     | E     | F     |
| 9          | 30.81 | 24.99 | 16.92 | 11.08 | 19.20 |
| 15         | 39.20 | 33.30 | 25.25 | 19.39 | 27.70 |
| 25         | 53.04 | 47.04 | 38.96 | 33.24 | 41.10 |
| 37         | 69.40 | 63.50 | 55.42 | 49.86 | 57.30 |

**RoHS compliant**

Unit: mm



File No.: E198287

| Scale     | Free  | ⑪   | Add PN                          | 21.07.2022 | Daniel |                           | Date       | Name   | Customer-No.                         |
|-----------|-------|-----|---------------------------------|------------|--------|---------------------------|------------|--------|--------------------------------------|
| TOLERANCE |       | ⑩   | Show the pin1 in drawing        | 22.10.2021 | Daniel | Drawn                     | 15.08.2012 | Lucas  | ASSMANN WSW-No.<br>⑨ A-Dx xx LL/x-xx |
| X.        | ±0.38 | ⑨   | Add PN and update dimension     | 09.03.2021 | Daniel | Approved                  | 21.07.2022 | Daniel |                                      |
| X.X       | ±0.25 | ⑧   | Add recommended wire size       | 17.01.2019 | Xavier |                           |            |        | Drawing-No.                          |
| X.XX      | ±0.13 | ⑦   | Add solder temperature          | 16.07.2018 | Xavier | ASSMANN<br>WSW components |            |        | ASS 4884 CO                          |
| DIM       | TOL   | ⑥   | Add the detail plating of shell | 17.01.2018 | Tom    |                           |            |        | rev11                                |
| X.°       | ±3°   | Id. | Modification                    | Date       | Name   |                           |            |        | Sheet 1/2                            |
| X.X°      | ±1°   |     |                                 |            |        |                           |            |        |                                      |
| Angle     | TOL   |     |                                 |            |        |                           |            |        |                                      |



ASS 4884 CO

rev11

Replace

Sheet 1/2

# Female

## Product Specification

### Material

- ⑨ Insulator : Glass-Filled Thermoplastic PBT,UL94V-0
- ⑨ Contact : Copper Alloy , plating: see order code
- ⑥ Shell: Steel 100u"Tin Over 50u" min Copper

### Electrical

- Contact Resistance : 20 milliohms Max at 1 AMP DC.
- Insulation Resistance : 1000 magohms at 500 VDC
- Dielectric Withstanding Voltage :1000 VAC/rms 60Hz for 1 minute
- Current Rating : 3 AMP
- Volatge Rating : 250 VAC/rms 60Hz
- ⑤ Durability :250 mating cycles
- Operating Temperature : -55°C+105°C
- ⑦ Soldering Temperature : 245±5°C in 10s
- ⑧ Recommended wire size: 28~30AWG

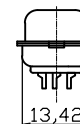
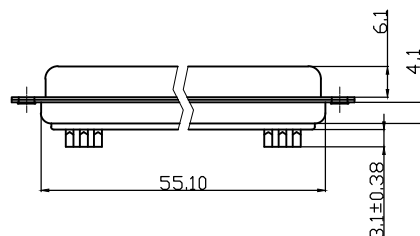
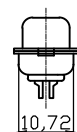
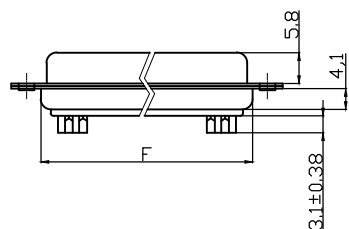
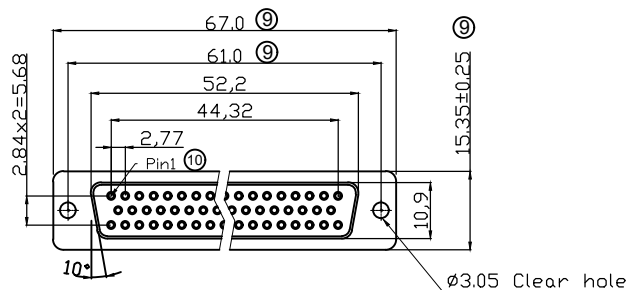
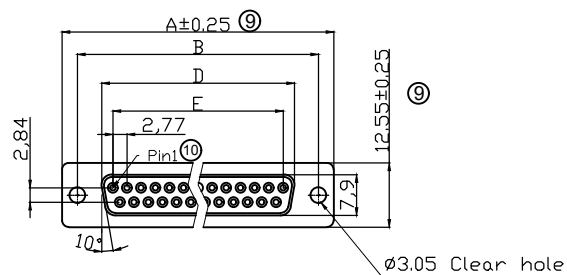

| D-SUB         |       |        |                |    |                       |                                    |
|---------------|-------|--------|----------------|----|-----------------------|------------------------------------|
| ORDERING CODE |       |        |                |    |                       |                                    |
| ⑪             | Style | Gender | No of contacts |    | Plating specification | Insulator color                    |
|               | A -   | D      | x              | xx | LL/                   | x - xx                             |
|               | A -   | D      | F Female       | 09 | LL/                   | Z Gold selective tin - Blank White |
|               |       |        | S Male         | 15 |                       | G Gold flash BK Black              |
|               |       |        |                | 25 |                       | GY Gray                            |
|               |       |        |                | 37 |                       |                                    |
|               |       |        |                | 50 |                       |                                    |

| Dimensions |       |       |       |       |       |
|------------|-------|-------|-------|-------|-------|
| Positions  | A     | B     | D     | E     | F     |
| 9          | 30.81 | 24.99 | 16.33 | 11.08 | 19.20 |
| 15         | 39.20 | 33.30 | 24.70 | 19.39 | 27.70 |
| 25         | 53.05 | 47.04 | 38.40 | 33.24 | 41.10 |
| 37         | 69.40 | 63.50 | 54.84 | 49.86 | 57.30 |

**RoHS compliant**

Unit: mm



File No.: E198287

| Scale     | Free  | ⑪   | Add PN                          | 21.07.2022 | Daniel |                           | Date       | Name   | Customer-No.                         |
|-----------|-------|-----|---------------------------------|------------|--------|---------------------------|------------|--------|--------------------------------------|
| TOLERANCE |       | ⑩   | Show the pin1 in drawing        | 22.10.2021 | Daniel | Drawn                     | 15.08.2012 | Lucas  | ASSMANN WSW-No.<br>⑨ A-Dx xx LL/x-xx |
| X.        | ±0.38 | ⑨   | Add PN and update dimension     | 09.03.2021 | Daniel | Approved                  | 21.07.2022 | Daniel |                                      |
| X.X       | ±0.25 | ⑧   | Add recommended wire size       | 17.01.2019 | Xavier |                           |            |        | Drawing-No.                          |
| X.XX      | ±0.13 | ⑦   | Add solder temperature          | 16.07.2018 | Xavier | ASSMANN<br>WSW components |            |        | ASS 4884 CO                          |
| DIM       | TOL   | ⑥   | Add the detail plating of shell | 17.01.2018 | Tom    |                           |            |        | rev11                                |
| X.°       | ±3°   | Id. | Modification                    | Date       | Name   |                           |            |        | Sheet 2/2                            |
| X.X°      | ±1°   |     |                                 |            |        |                           |            |        | Replace                              |
| Angle     | TOL   |     |                                 |            |        |                           |            |        |                                      |



ASS 4884 CO  
rev11  
Sheet 2/2