

6

5

4

3

2

1

APPROVED: _____

DATE: _____ TITLE: _____

Rev	AWO #	Description	Date	Appr
-		RELEASED	11/1/22	
A		UPDATE SPEC.	11/30/22	JJ/RC

D

D

C

C

B

B

A

A

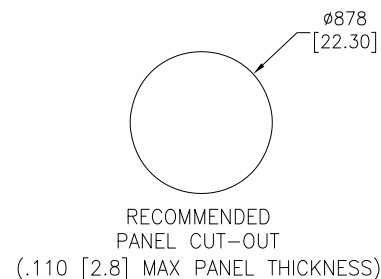
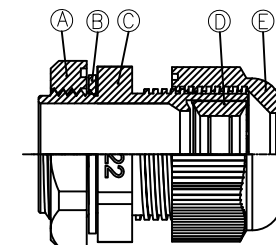
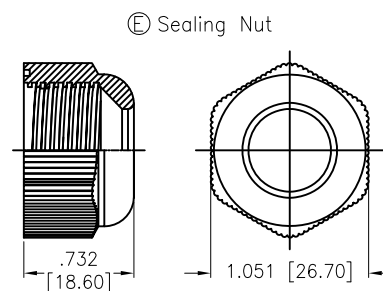
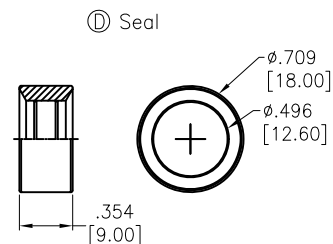
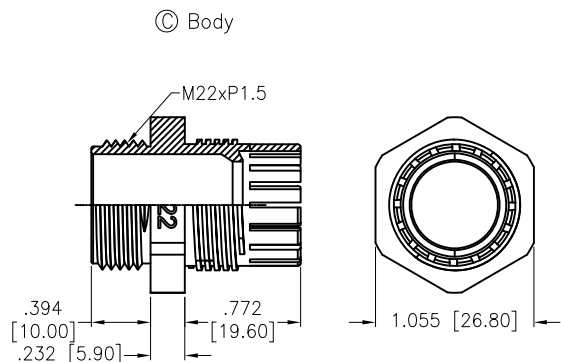
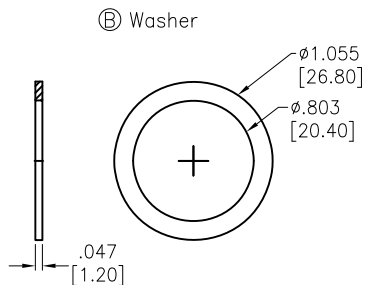
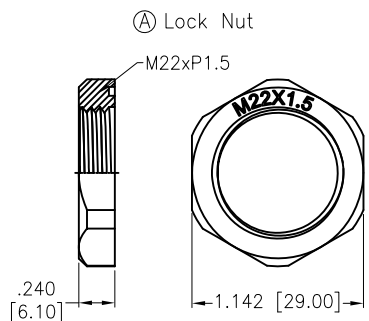

SPECIFICATIONS:

Material:

Lock Nut: PA66, rated UL 94V-2

Body: PA66, rated UL 94V-2

Sealing Nut: PA66, rated UL 94V-2

Washer: Nitrile Butylene

Seal: Nitrile Butylene

Mechanical:

Cable range O.D.: ϕ .315~ ϕ .512 [8.00~13.00mm]

Nut Torque: 2.5Nm Max.

Environmental:

Waterproof: IP68

Lead free, RoHS compliant.



UNLESS OTHERWISE SPECIFIED ALL DIMENSIONS ARE INCHES [MM]. TOLERANCES: EXCEPT AS NOTED				909 Rahway Avenue, Union, NJ 07083															
<table border="0"> <tr> <td>INCHES</td> <td></td> <td>HOLES</td> </tr> <tr> <td>.X</td> <td>\pm.10</td> <td>ϕX</td> <td>\pm.10</td> </tr> <tr> <td>.XX</td> <td>\pm.020</td> <td>ϕ.XX</td> <td>\pm.015</td> </tr> <tr> <td>.XXX</td> <td>\pm.015</td> <td>ϕ.XXX</td> <td>\pm.010</td> </tr> </table>				INCHES		HOLES	.X	\pm .10	ϕ X	\pm .10	.XX	\pm .020	ϕ .XX	\pm .015	.XXX	\pm .015	ϕ .XXX	\pm .010	Phone: 908-687-5000
INCHES		HOLES																	
.X	\pm .10	ϕ X	\pm .10																
.XX	\pm .020	ϕ .XX	\pm .015																
.XXX	\pm .015	ϕ .XXX	\pm .010																
			Fax: 908-687-5710																
DRAWN	LH	11/1/22	TITLE																
CHECKED	RC	11/1/22	WATERPROOF CONNECTOR, M22, 1 HOLE, CABLE GLAND, WATERPROOF: IP68																
APPROVED			SIZE	PART NO.	REV.														
THIS DRAWING CONTAINS INFORMATION THAT IS PROPRIETARY AND SHOULD NOT BE USED WITHOUT PRIOR WRITTEN PERMISSION FROM ADAM TECH			X	CG-P-M22	A														
			REF: S00211C	SCALE: NTS	SHEET 1 OF 1														

6

5

4

3

2

1