



## Small Signal Schottky Diode



**SOT-323**

### Features

- Epoxy meets UL-94 V-0 flammability rating and halogen free
- Moisture Sensitivity Level 1
- Low Forward Voltage Schottky Rectifier
- $V_{RRM}$  30V
- $I_{FAV}$  200mA
- Part no. with suffix "Q" means AEC-Q101 qualified

### Mechanical Data

- **Case:** SOT-323
- **Terminals:** Tin plated leads, solderable per J-STD-002 and JESD22-B102

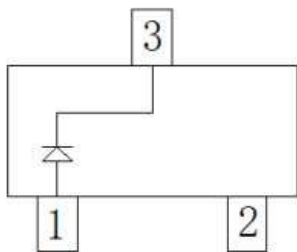

BAT54WTQ  
Marking:KL5

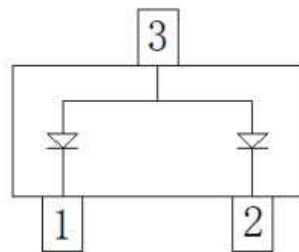

BAT54AWTQ  
Marking:KL6

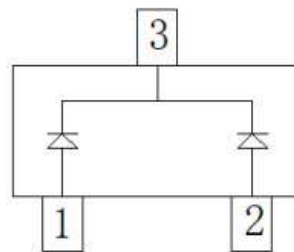

BAT54CWTQ  
Marking:KL7

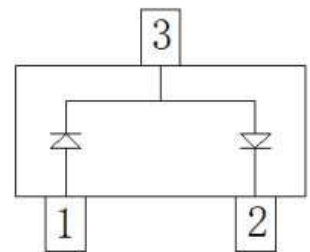

BAT54SWTQ  
Marking:KL8

### ■ Maximum Ratings ( $T_a=25^\circ\text{C}$ Unless otherwise specified)

PARAMETER	SYMBOL	UNIT	CONDITIONS	VALUE
Peak Repetitive Reverse Voltage	$V_{RRM}$	V		30
Average Forward Current	$I_{FAV}$	mA		200
Non-Repetitive Peak Forward Surge Current	$I_{FSM}$	A	square wave $t_p < 10\text{ms}$	3
Power Dissipation	$P_D$	mW		200
Thermal Resistance Junction to Ambient	$R_{thJA}$	$^\circ\text{C/W}$		500
Junction Temperature	$T_j$	$^\circ\text{C}$		-55 to +125
Storage Temperature Range	$T_{stg}$	$^\circ\text{C}$		-55 to +150



# BAT54WTQ&BAT54AWTQ&BAT54CWTQ&BAT54SWTQ

## ■ Electrical Characteristics (T<sub>a</sub>=25°C Unless otherwise specified)

PARAMETER	SYMBOL	UNIT	CONDITIONS	MIN	MAX
Forward Voltage	V <sub>F</sub>	V	I <sub>F</sub> =0.1mA		0.24
			I <sub>F</sub> =1mA		0.32
			I <sub>F</sub> =10mA		0.4
			I <sub>F</sub> =30mA		0.5
			I <sub>F</sub> =100mA		1
Reverse Current	I <sub>R</sub>	μA	V <sub>R</sub> =25V		2
Reverse Breakdown Voltage	V <sub>BR</sub>	V	I <sub>R</sub> =10μA	30	
Junction Capacitance	C <sub>J</sub>	pF	V <sub>R</sub> =1V, f =1MHz		10
Reverse Recovery Time	t <sub>rr</sub>	ns	I <sub>F</sub> =I <sub>R</sub> =10mA, I <sub>rr</sub> =1mA, R <sub>L</sub> =100Ω		5

## ■ Ordering Information (Example)

PREFERRED P/N	PACKING CODE	UNIT WEIGHT(g)	MINIMUM PACKAGE(pcs)	INNER BOX QUANTITY(pcs)	OUTER CARTON QUANTITY(pcs)	DELIVERY MODE
BAT54WTQ BAT54AWTQ BAT54CWTQ BAT54SWTQ	F2	Approximate 0.006	3000	30000	120000	7" reel



## ■ Characteristics (Typical)

Fig.1:  $P_D - T_A$

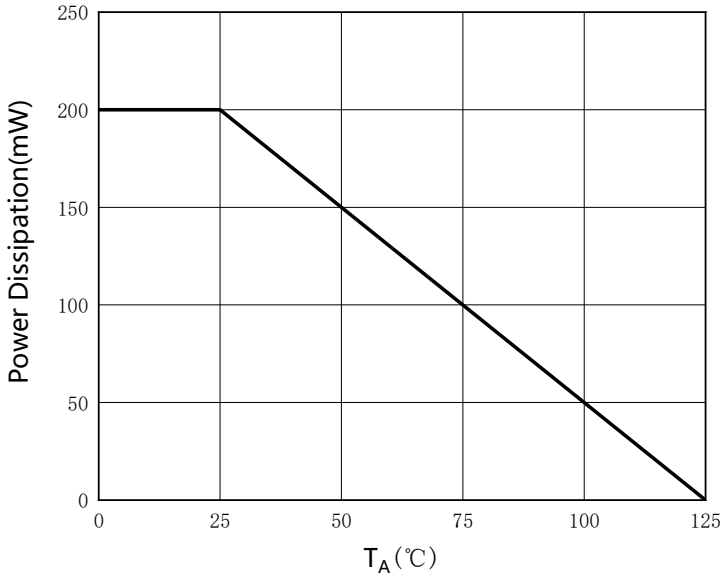

Fig.2: Capacitance Characteristics

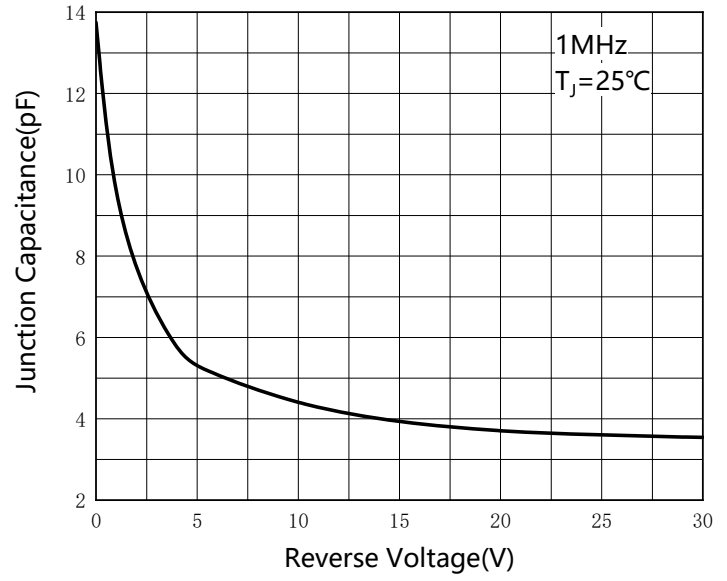

Fig.3: Forward Characteristics

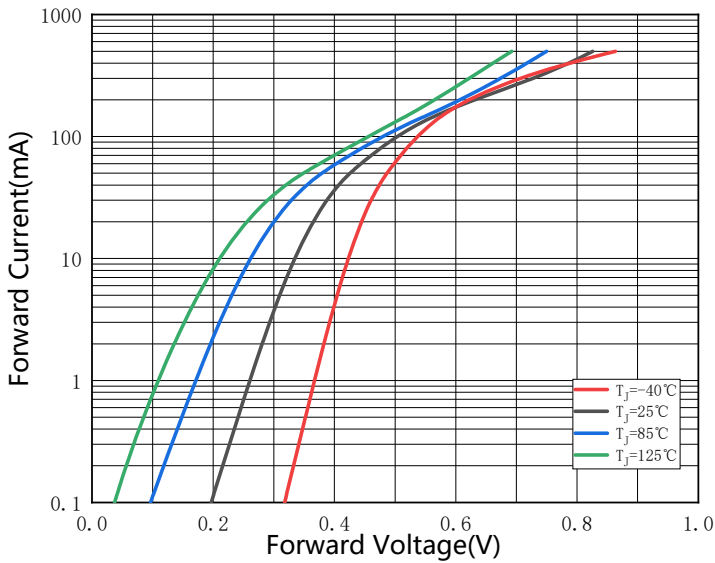
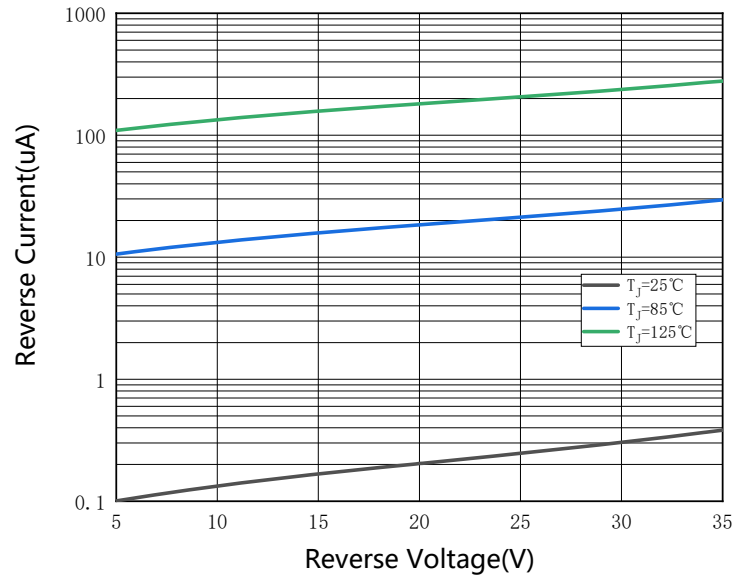
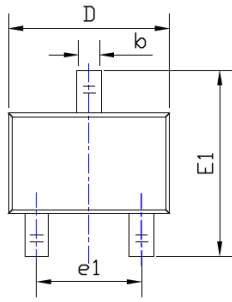

Fig.4: Reverse Characteristics





■ Outline Dimensions



TOP VIEW

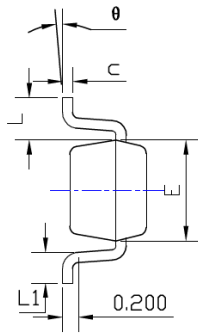

SIDE VIEW

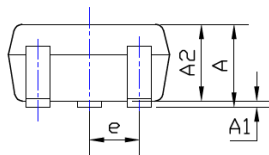

SIDE VIEW

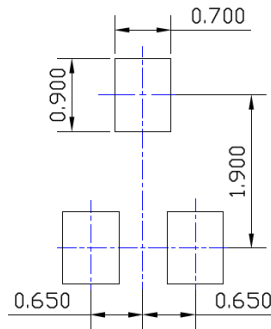

UNIT: mm

SUGGESTED SOLDER PAD LAYOUT

SYMBOL	DIMENSIONS			
	INCHES		Millimeter	
	MIN.	MAX.	MIN.	MAX.
A	0.035	0.043	0.900	1.100
A1	0.000	0.004	0.000	0.100
A2	0.035	0.039	0.900	1.000
b	0.006	0.016	0.150	0.400
c	0.004	0.010	0.100	0.250
D	0.071	0.087	1.800	2.200
E	0.045	0.053	1.150	1.350
E1	0.085	0.096	2.150	2.450
e	0.026TYP		0.650TYP	
e1	0.047	0.055	1.200	1.400
L	0.021REF		0.525REF	
L1	0.010	0.018	0.260	0.460
θ	0°	8°	0°	8°

NOTE:

1.PACKAGE BODY SIZES EXCLUDE MOLD FLASH AND GATE BURRS.

2.TOLERANCE 0.1mm UNLESS OTHERWISE SPECIFIED.

3.THE PAD LAYOUT IS FOR REFERENCE PURPOSES ONLY.

■ Marking Information

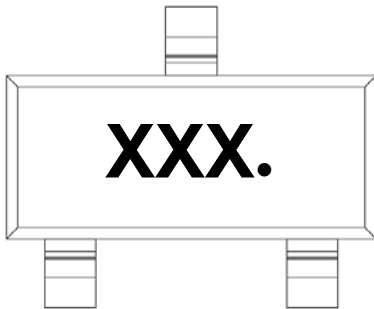

PN	Marking Code
BAT54WTQ	KL5.
BAT54AWTQ	KL6.
BAT54CWTQ	KL7.
BAT54SWTQ	KL8.

Note:

1. All marking is at middle of the product body
2. All marking is in laser marking
3. XXX is Marking Code
4. Body color: Black



## Disclaimer

The information presented in this document is for reference only. Yangzhou Yangjie Electronic Technology Co., Ltd. reserves the right to make changes without notice for the specification of the products displayed herein to improve reliability, function or design or otherwise.

The product listed herein is designed to be used with automotive electronics, are not designed for use in medical, life-saving, lifesustaining, or military, Yangjie or anyone on its behalf, assumes no responsibility or liability for any damages resulting from such improper use of sale.

This publication supersedes & replaces all information previously supplied. For additional information, please visit our website [http:// www.21yangjie.com](http://www.21yangjie.com) , or consult your nearest Yangjie's sales office for further assistance.