

PART NUMBER	PLATING	RECOMMENDED WIRE SIZE	DIM "A" HEIGHT	DIM "B" WIDTH	RECOMMENDED CRIMP APPLICATOR	PACKAGE SIZE
173693-4634	30μ * GOLD STRIPE OVER 50μ * NICKEL OVERALL WITH 80-130μ * SELECT TIN	8 AWG (2) 12 AWG	7.42±0.5	5.84±0.5	63832-6300	1800 PARTS/ REEL
173693-4632		10-12 AWG (2) 14 AWG	5.97±0.5	5.33±0.5	63832-6000	2500 PARTS/ REEL
173693-4636		14-16 AWG (2) 16 AWG (2) 18 AWG	5.20±0.5	5.33±0.5	63832-6100	

- NOTES:
1. MATERIAL: COPPER ALLOY .032 IN THICK
  2. FINISH: PER MOLEX PLATING SPECIFICATION ES-88 - SEE CHART
  3. FOR CRIMP APPLICATOR SEE CHART
  4. FOR CRIMP TOOLING CONTACT MOLEX OR VISIT THE MOLEX WEBSITE AT: [WWW.MOLEX.COM](http://WWW.MOLEX.COM)
  5. STANDARD PACKAGE SIZE: SEE CHART
  6. SEE PRODUCT SPECIFICATION: PS-173693-001 FOR MORE INFORMATION
  7. PARTS ARE RoHS COMPLIANT
  8. FOR MATING CONTACT: SEE CHART
  9. FOR CRIMP SET UP INFORMATION SEE MOLEX APPLICATION SPECIFICATION DOCUMENT:
- 8 AWG - ATS-638326300  
10/12 AWG - ATS-638326000  
14/16 AWG - ATS-638326100

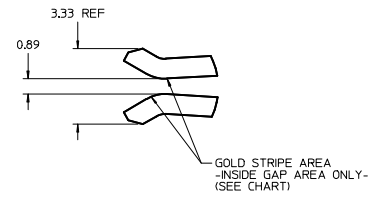

DETAIL 1  
SCALE 10:1

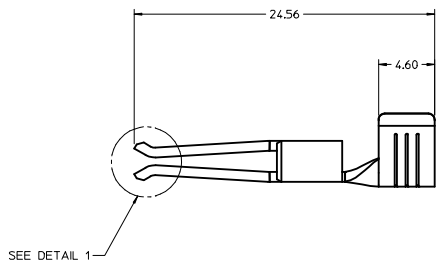
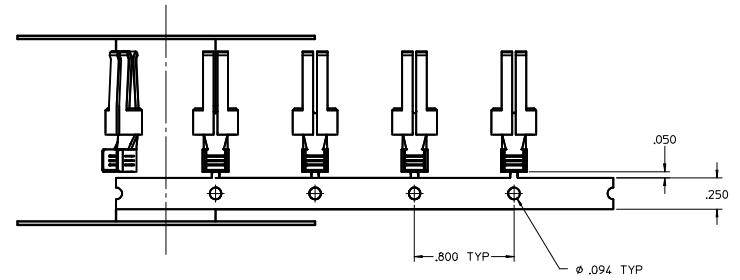
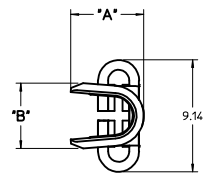
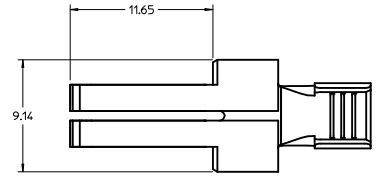
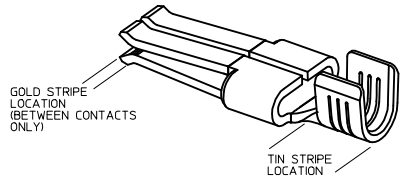
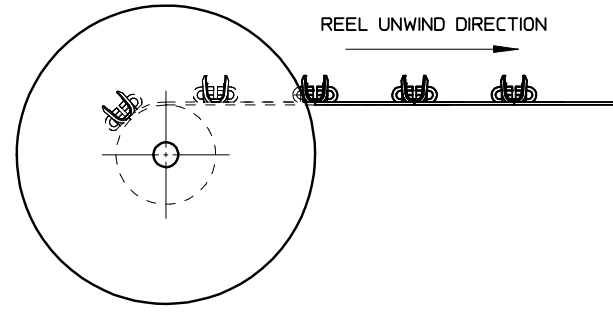

<b>PRELIMINARY</b> IEC NO. UCF2016-4071 DRAWN BY JSCHAFFER 2016/04/15 CHECKED BY CHYKOB. PISZCZOR APPR: BPI SZCZOR 2016/10/03	QUALITY SYMBOLS	GENERAL TOLERANCES (UNLESS SPECIFIED)	DIMENSION STYLE	SCALE	DESIGN UNITS	THIRD ANGLE PROJECTION
	▽=0	4 PLACES ±--- ±---	MM ONLY	5:1	METRIC	☉
	▽=0	3 PLACES ±--- ±---				
	▽=0	2 PLACES ±0.13 ±---				
		1 PLACE ±0.25 ±---				
		0 PLACE ±--- ±---				
		ANGULAR ±1/2°				
		DRAFT WHERE APPLICABLE MUST REMAIN WITHIN DIMENSIONS				
			MATERIAL NO.	DATE	TITLE	
			SEE CHART	2016/10/03	TERMINAL - RECEPTACLE POWER CONTACT TEN60 POWER FAMILY	
					<b>molex</b>	
					DOCUMENT NO. SD-173693-001	SHEET NO. 1 OF 1

PART NUMBER	PLATING	RECOMMENDED WIRE SIZE	DIM "A" HEIGHT	DIM "B" WIDTH	RECOMMENDED CRIMP APPLICATOR	PACKAGE SIZE
44262-4634	30μ * GOLD STRIPE OVER 50μ * NICKEL OVERALL WITH 80-130μ * SELECT TIN	8 AWG (2) 12 AWG	7.42±0.5	5.84±0.5	63832-6300	1800 PARTS/ REEL
44262-4632		10-12 AWG (2) 14 AWG	5.97±0.5	5.33±0.5	63832-6000	2500 PARTS/ REEL
44262-4636		14-16 AWG (2) 16 AWG (2) 18 AWG	5.20±0.5	5.33±0.5	63832-6100	

- NOTES:
1. MATERIAL: COPPER ALLOY .032 IN THICK
  2. FINISH: PER MOLEX PLATING SPECIFICATION ES-88 - SEE CHART
  3. FOR CRIMP APPLICATOR SEE CHART
  4. FOR CRIMP TOOLING CONTACT MOLEX OR VISIT THE MOLEX WEBSITE AT: WWW.MOLEX.COM
  5. STANDARD PACKAGE SIZE: SEE CHART
  6. SEE PRODUCT SPECIFICATION: PS-44262-001 FOR MORE INFORMATION
  7. PARTS ARE RoHS COMPLIANT
  8. FOR MATING CONTACT: SEE CHART
  9. FOR CRIMP SET UP INFORMATION SEE MOLEX APPLICATION SPECIFICATION DOCUMENT:
- 8 AWG - ATS-638326300  
 10/12 AWG - ATS-638326000  
 14/16 AWG - ATS-638326100

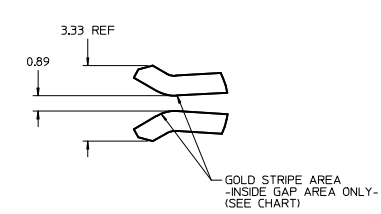
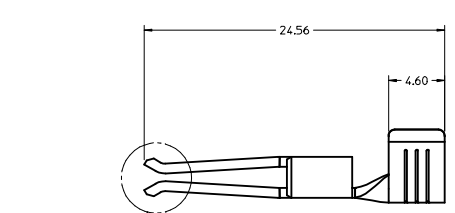
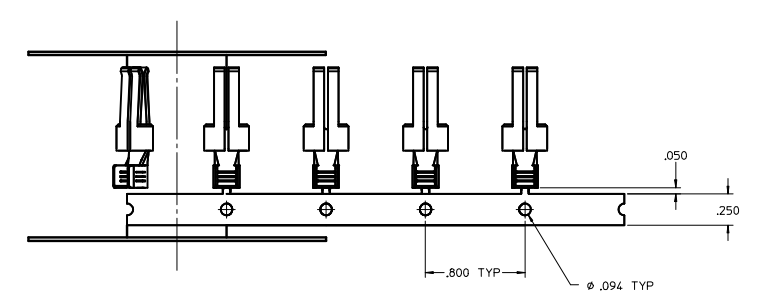
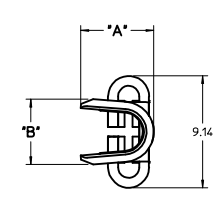
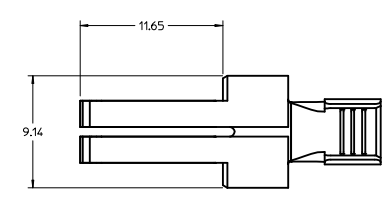
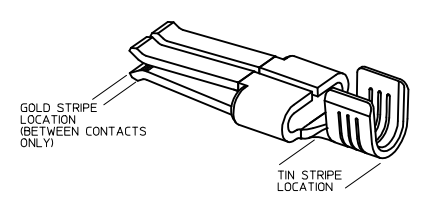

DETAIL 1  
SCALE 10:1

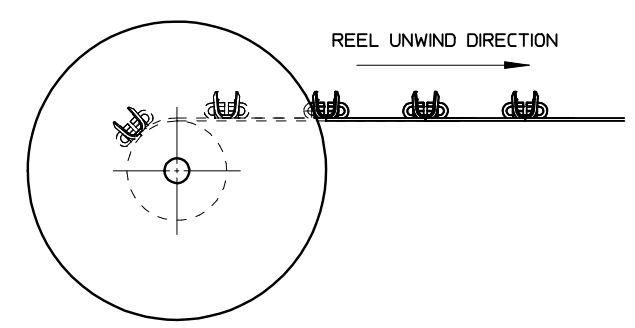

<b>RELEASED</b> IEC NO. UCF2015-4855 DRAWN BY JOUILLES 2015/05/19 CHKD BY BPSZCZOR 2015/05/21 APPR: APATEL 2015/06/11	<b>QUALITY SYMBOLS</b> ∇=0 ∇=0 ∇=0	<b>GENERAL TOLERANCES (UNLESS SPECIFIED)</b>		<b>DIMENSION STYLE</b> MM ONLY	<b>SCALE</b> 5:1	<b>DESIGN UNITS</b> METRIC	THIRD ANGLE PROJECTION
		4 PLACES ± .--- ± .--- 3 PLACES ± .--- ± .--- 2 PLACES ± 0.13 ± .--- 1 PLACE ± 0.25 ± .--- 0 PLACE ± .--- ± .---	mm    INCH	DRAWN BY DATE JOUILLES 2015/05/19	CHECKED BY DATE BPSZCZOR 2015/05/21	APPROVED BY DATE APATEL 2015/06/11	<b>TITLE</b> TERMINAL - RECEPTACLE POWER CONTACT TEN60 POWER FAMILY <b>molex</b>
<b>REVISIONS</b> A	DESCRIPTION	ANGULAR ±1/2° DRAFT WHERE APPLICABLE MUST REMAIN WITHIN DIMENSIONS		MATERIAL NO. <b>SEE CHART</b>	DOCUMENT NO. SD-44262-2000	SHEET NO. 1 OF 1	