

NOTES:

- 1. INK PRINTED DATE CODE: \* \* \*  
 \* WORKING DAY  
 \* WORKING MONTH  
 \* WORKING YEAR
- 2. AREA FILLED WITH BLACK INK.
- 3. INSULATOR OVERHANG ILM FRAME.
- 4. PARTS ARE COMPLIANT TO RoHS DIRECTIVE 2002/95/EC AND ELV 2000/53/EC.
- 5. PARTS ARE HALOGEN FREE.

| BILL OF MATERIAL(47596-8755) |         |      |                            |                           |
|------------------------------|---------|------|----------------------------|---------------------------|
| PART NO.                     | ITEM NO | Q'TY | DESCRIPTION                | MATERIAL                  |
| 475968855                    |         | 1    | ILM TOP ASSY WITHOUT SCREW |                           |
|                              | ①       | 1    | ILM LEVER                  | STAINLESS STEEL           |
|                              | ②       | 1    | ILM LOAD PLATE             | SUS430                    |
|                              | ③       | 1    | ILM FRAME                  | STEEL WITH NICKEL PLATING |
|                              | ④       | 1    | ILM FRAME INSULATOR        | POLYCARBONATE FILM        |
| 475973003                    | ⑤       | 1    | ILM PNP COVER              | PC/ABS                    |

| 47596-8755 | WITH ILM PNP COVER |
|------------|--------------------|
| PART NO.   | DESCRIPTION        |

ENTER DESCRIPTION  
 EC NO: SH2013-0064  
 DRWN: YXZHENG 2012/05/29  
 CHKD:  
 APPR: AYIN 2013/02/04

QUALITY SYMBOLS  
 $F_A=0$   
 $F_G=0$   
 $F_B=0$

GENERAL TOLERANCES (UNLESS SPECIFIED)  
 mm INCH  
 4 PLACES ± --- ± ---  
 3 PLACES ± --- ± ---  
 2 PLACES ± 0.10 ± ---  
 1 PLACE ± 0.25 ± ---  
 ANGULAR ± ---°  
 DRAFT WHERE APPLICABLE  
 MUST REMAIN WITHIN DIMENSIONS

DIMENSION STYLE  
 MM ONLY  
 DRAWN BY YXZHENG DATE 2012/05/29  
 CHECKED BY DATE  
 APPROVED BY AYIN DATE 2013/02/04  
 MATERIAL NO.  
 SEE TABLE

SCALE 1:1  
 DESIGN UNITS METRIC  
 THIRD ANGLE PROJECTION  
 TITLE 115X ILM TOP ASSY SUS430  
 MOLEX MOLEX INCORPORATED  
 DOCUMENT NO. RSD-47596-003 SHEET NO. 1 OF 1  
 THIS DRAWING CONTAINS INFORMATION THAT IS PROPRIETARY TO MOLEX INCORPORATED AND SHOULD NOT BE USED WITHOUT WRITTEN PERMISSION

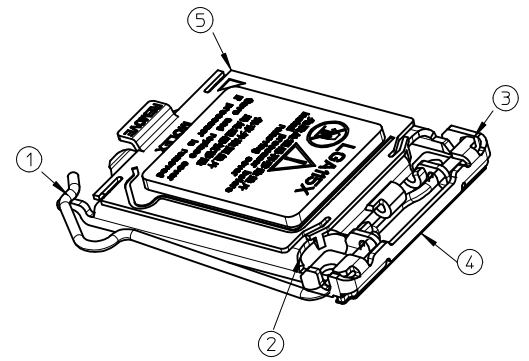
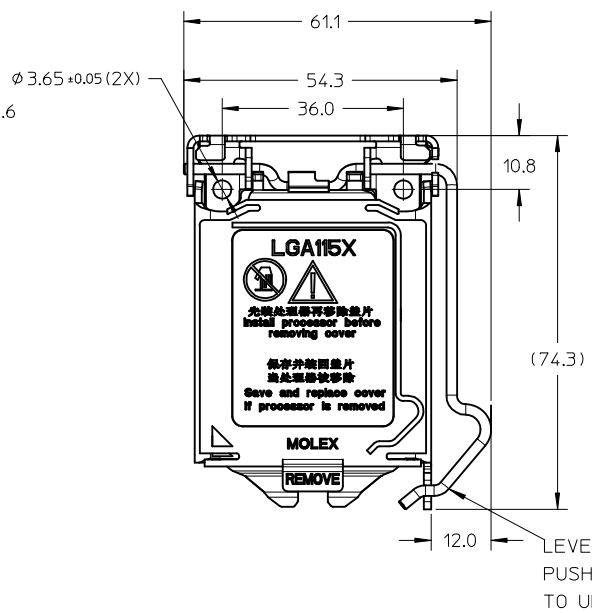
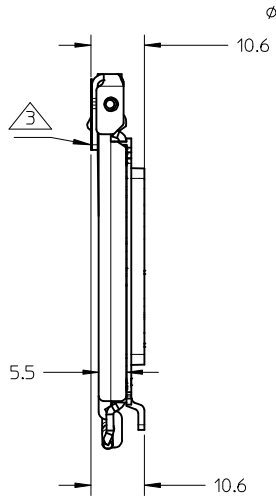
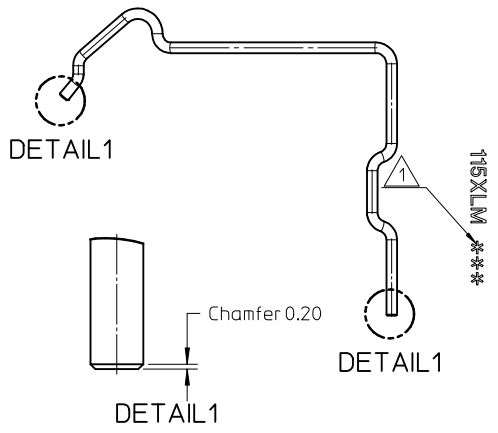

NOTES:

- 1. INK PRINTED DATE CODE: \* \* \*  
 \* WORKING DAY  
 \* WORKING MONTH  
 \* WORKING YEAR
- 2. AREA FILLED WITH BLACK INK.
- 3. INSULATOR OVERHANG ILM FRAME.
- 4. PARTS ARE COMPLIANT TO RoHS DIRECTIVE 2002/95/EC AND ELV 2000/53/EC.
- 5. PARTS ARE HALOGEN FREE.

| BILL OF MATERIAL(47596-8755) |         |      |                            |                           |
|------------------------------|---------|------|----------------------------|---------------------------|
| PART NO.                     | ITEM NO | Q'TY | DESCRIPTION                | MATERIAL                  |
| 475968855                    |         | 1    | ILM TOP ASSY WITHOUT SCREW |                           |
|                              | ①       | 1    | ILM LEVER                  | STAINLESS STEEL           |
|                              | ②       | 1    | ILM LOAD PLATE             | SUS430                    |
|                              | ③       | 1    | ILM FRAME                  | STEEL WITH NICKEL PLATING |
|                              | ④       | 1    | ILM FRAME INSULATOR        | POLYCARBONATE FILM        |
| 475973003                    | ⑤       | 1    | ILM PNP COVER              | PC/ABS                    |

| 47596-8755 | WITH ILM PNP COVER |
|------------|--------------------|
| PART NO.   | DESCRIPTION        |

|  |  |  |   |  |                              |                                     |                  |
|--|--|--|---|--|------------------------------|-------------------------------------|------------------|
| ENTER DESCRIPTION<br>EC NO: SH2013-0064<br>DRWN: YXZHENG 2012/05/29<br>CHKD:<br>APPR: AYIN 2013/02/04<br>A | QUALITY SYMBOLS  | GENERAL TOLERANCES (UNLESS SPECIFIED)  | DIMENSION STYLE   | SCALE                                  | DESIGN UNITS                 | THIRD ANGLE PROJECTION              |                  |
|  | $F_A=0$<br>$F_C=0$<br>$F_B=0$                              | mm INCH<br>4 PLACES ± --- ± ---<br>3 PLACES ± --- ± ---<br>2 PLACES ± 0.10 ± ---<br>1 PLACE ± 0.25 ± ---<br>ANGULAR ± ---° | MM ONLY<br>DRAWN BY: YXZHENG DATE: 2012/05/29<br>CHECKED BY: DATE:<br>APPROVED BY: AYIN DATE: 2013/02/04<br>MATERIAL NO.      | 1:1<br>TITLE: 115X ILM TOP ASSY SUS430 | METRIC<br>MOLEX INCORPORATED | MOLEX INCORPORATED<br>RSD-47596-003 | SHEET NO. 1 OF 1 |
|  | DRAFT WHERE APPLICABLE<br>MUST REMAIN<br>WITHIN DIMENSIONS | SEE TABLE  | THIS DRAWING CONTAINS INFORMATION THAT IS PROPRIETARY TO MOLEX INCORPORATED AND SHOULD NOT BE USED WITHOUT WRITTEN PERMISSION |  |                              |                                     |                  |
|  | SIZE A3  |  |   |  |                              |                                     |                  |

10 9 8 7 6 5 4 3 2 1

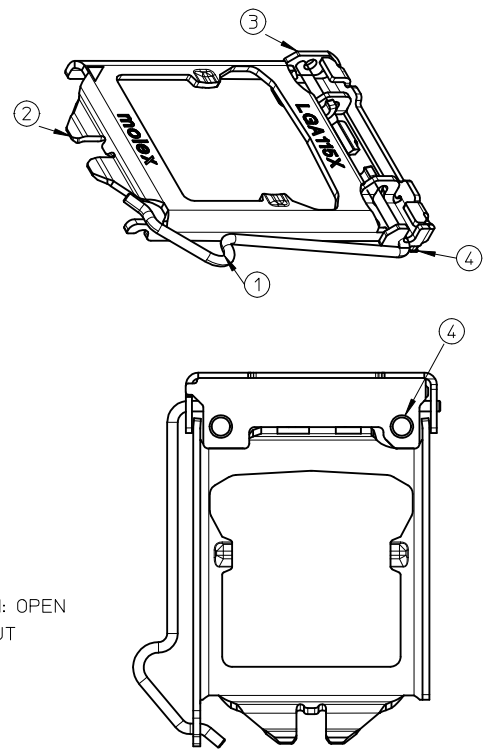
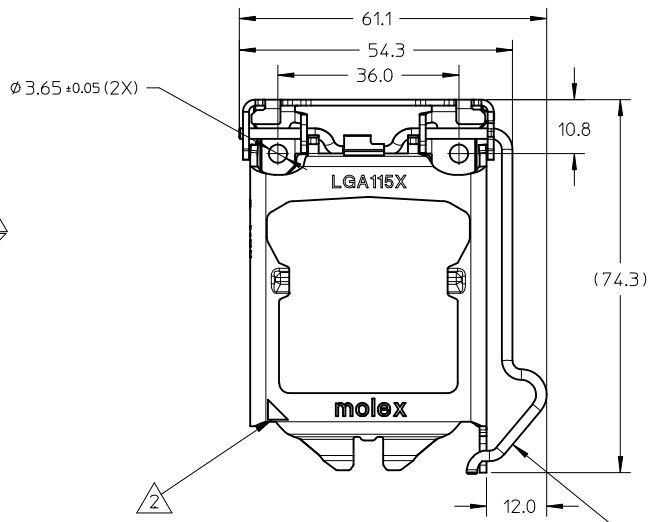
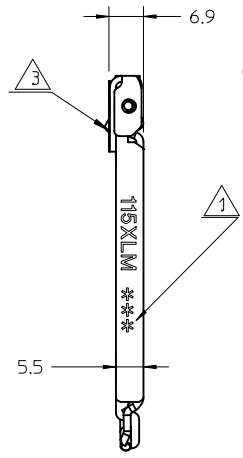
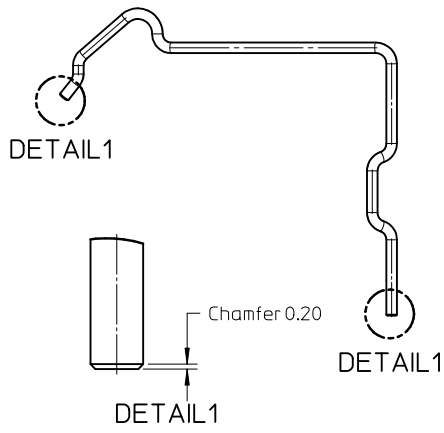

LEVER POSITION: OPEN  
PUSH LEVER OUT  
TO UNLOCK

NOTES:

- 1. INK PRINTED DATE CODE: \* \* \*  
 \* WORKING DAY  
 \* WORKING MONTH  
 \* WORKING YEAR
- 2. AREA FILLED WITH BLACK INK.
- 3. INSULATOR OVERHANG ILM FRAME.
- 4. PARTS ARE COMPLIANT TO RoHS DIRECTIVE 2002/95/EC AND ELV 2000/53/EC.
- 5. PARTS ARE HALOGEN FREE.

| BILL OF MATERIAL (47596-8855) |      |                            |                           |
|-------------------------------|------|----------------------------|---------------------------|
| ITEM NO                       | Q'TY | DESCRIPTION                | MATERIAL                  |
|                               | 1    | ILM TOP ASSY WITHOUT SCREW |                           |
| ①                             | 1    | ILM LEVER                  | STAINLESS STEEL           |
| ②                             | 1    | ILM LOAD PLATE             | SUS430                    |
| ③                             | 1    | ILM FRAME                  | STEEL WITH NICKEL PLATING |
| ④                             | 1    | ILM FRAME INSULATOR        | POLYCARBONATE FILM        |

|  |   |  |                 |                          |              |                        |
|--|---|--|-----------------|--------------------------|--------------|------------------------|
| ENTER DESCRIPTION<br>EC NO: SH2012-0210<br>DRWN: JZHANG11 2012/01/05<br>CHKD:<br>APPR: AYIN 2012/02/02 | QUALITY SYMBOLS   | GENERAL TOLERANCES (UNLESS SPECIFIED)  | DIMENSION STYLE | SCALE                    | DESIGN UNITS | THIRD ANGLE PROJECTION |
|  | $F_A=0$<br>$F_C=0$<br>$F_P=0$                                 | mm INCH<br>4 PLACES ± --- ± ---<br>3 PLACES ± --- ± ---<br>2 PLACES ± 0.10 ± ---<br>1 PLACE ± 0.25 ± ---<br>ANGULAR ± ---° | MM ONLY         | 1:1                      | METRIC       | ☉                      |
|  | DRAWN BY: JGU007<br>CHECKED BY: JKACHLIC<br>APPROVED BY: AYIN | DATE: 2008/01/10<br>DATE: 2008/01/10<br>DATE: 2010/12/10   | TITLE           | 115X ILM TOP ASSY SUS430 |              |                        |
|  | DRAFT WHERE APPLICABLE MUST REMAIN WITHIN DIMENSIONS          |  | SEE TABLE       | MOLEX INCORPORATED       |              | SD-47596-003           |

|            |                       |
|------------|-----------------------|
| 47596-8855 | WITHOUT ILM PNP COVER |
| PART NO.   | DESCRIPTION           |

9 8 7 6 5 4 3 2 1

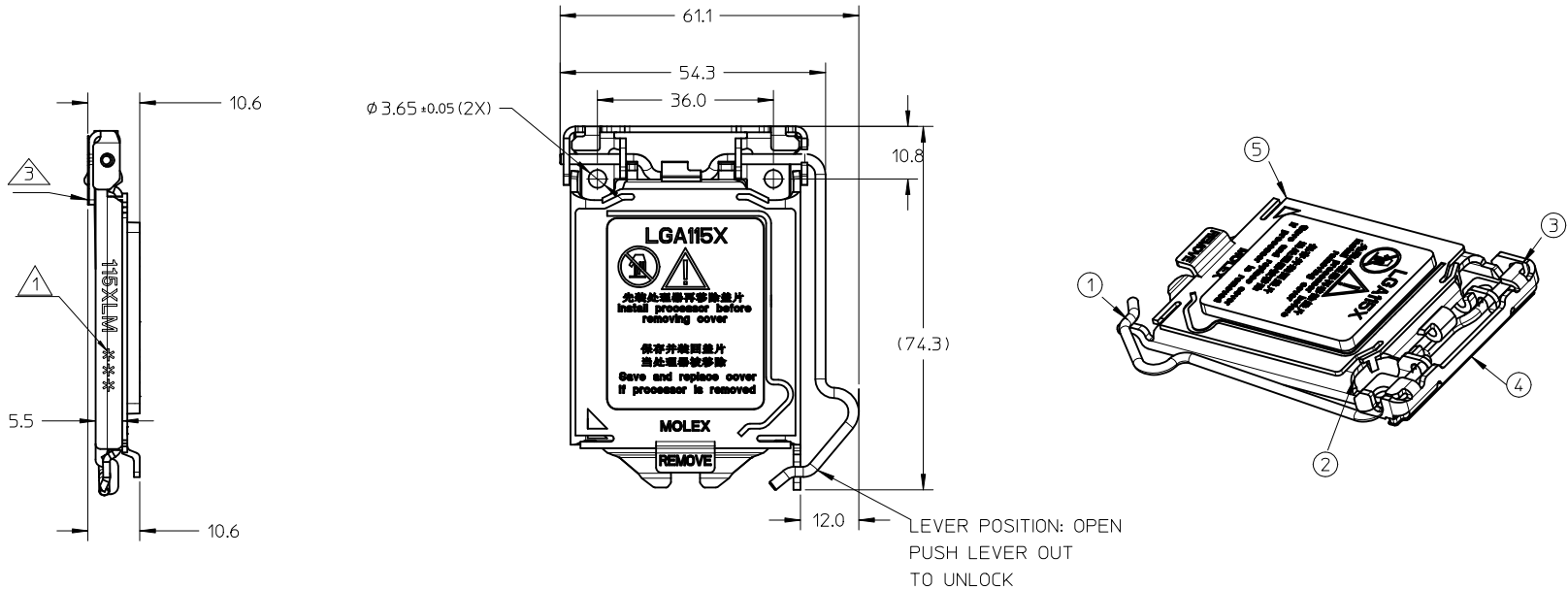

| BILL OF MATERIAL (47596-8755) |      |                            |                           |
|-------------------------------|------|----------------------------|---------------------------|
| ITEM NO                       | Q'TY | DESCRIPTION                | MATERIAL                  |
|                               | 1    | ILM TOP ASSY WITHOUT SCREW |                           |
| ①                             | 1    | ILM LEVER                  | STAINLESS STEEL           |
| ②                             | 1    | ILM LOAD PLATE             | SUS430                    |
| ③                             | 1    | ILM FRAME                  | STEEL WITH NICKEL PLATING |
| ④                             | 1    | ILM FRAME INSULATOR        | POLYCARBONATE FILM        |
| ⑤                             | 1    | ILM PNP COVER              | PC/ABS                    |

| 47596-8755 | WITH ILM PNP COVER |
|------------|--------------------|
| PART NO.   | DESCRIPTION        |

|   |                    |                 |  |                        |                            |                           |   |                        |                        |  |
|---|--------------------|-----------------|--|------------------------|----------------------------|---------------------------|---|------------------------|------------------------|--|
| ENTER DESCRIPTION<br>EC NO: SHZ012-0210<br>DRWN: ZHANG11<br>CHKD:<br>APPR: AYIN | DESCRIPTION<br>REV | QUALITY SYMBOLS | GENERAL TOLERANCES (UNLESS SPECIFIED)                |                        | DIMENSION STYLE<br>MM ONLY |                           | SCALE<br>1:1  | DESIGN UNITS<br>METRIC | THIRD ANGLE PROJECTION |  |
|   |                    | $F_A=0$         | mm   | INCH                   | DRAWN BY<br>JGU007         | DATE<br>2008/01/10        | TITLE<br>115X ILM TOP ASSY<br>SUS430  |                        |                        |  |
|   |                    | $F_C=0$         | 4 PLACES ± ---                                       | ± ---                  | CHECKED BY<br>JKACHLIC     | DATE<br>2008/01/10        | APPROVED BY<br>AYIN   |                        |                        |  |
|   |                    | $F_B=0$         | 3 PLACES ± ---                                       | ± ---                  | DATE<br>2010/12/10         | MATERIAL NO. SEE TABLE    |   |                        |                        |  |
|   |                    | 2 PLACES ± 0.10 | ± ---  | MATERIAL NO. SEE TABLE |                            | DOCUMENT NO. SD-47596-003 |   | SHEET NO. 2 OF 2       |                        |  |
|   |                    | 1 PLACE ± 0.25  | ± ---  | MATERIAL NO. SEE TABLE |                            | DOCUMENT NO. SD-47596-003 |   | SHEET NO. 2 OF 2       |                        |  |
|   |                    | ANGULAR ± ---°  | DRAFT WHERE APPLICABLE MUST REMAIN WITHIN DIMENSIONS |                        | MATERIAL NO. SEE TABLE     |                           | DOCUMENT NO. SD-47596-003   |                        | SHEET NO. 2 OF 2       |  |
|   |                    |                 |  |                        | SIZE A3                    |                           | THIS DRAWING CONTAINS INFORMATION THAT IS PROPRIETARY TO MOLEX INCORPORATED AND SHOULD NOT BE USED WITHOUT WRITTEN PERMISSION |                        |                        |  |

10 9 8 7 6 5 4 3 2 1

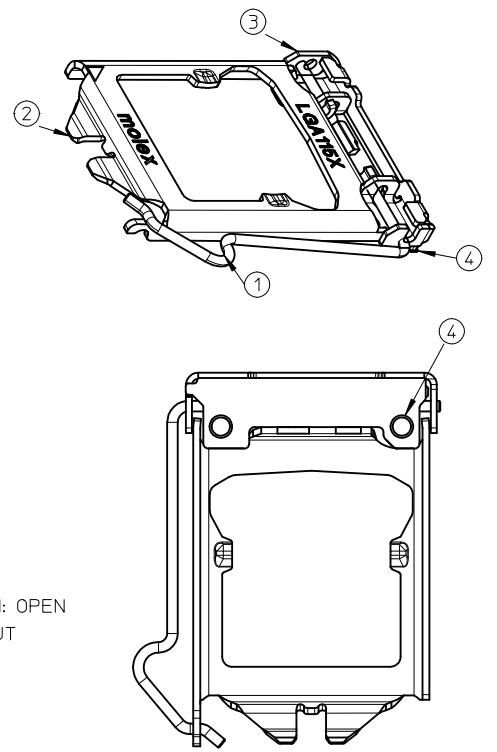
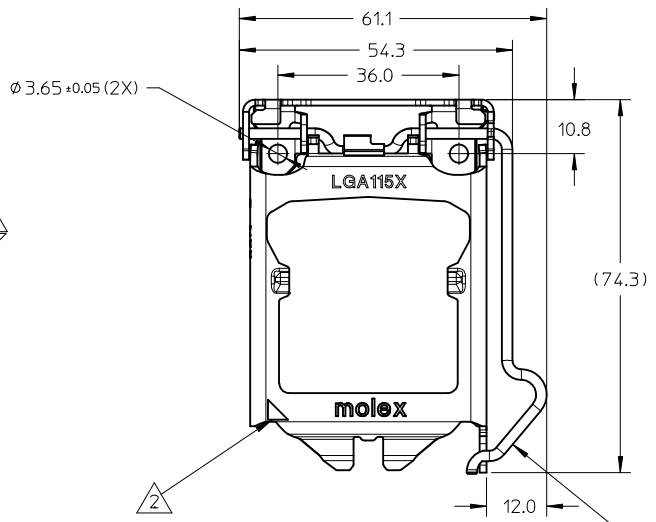
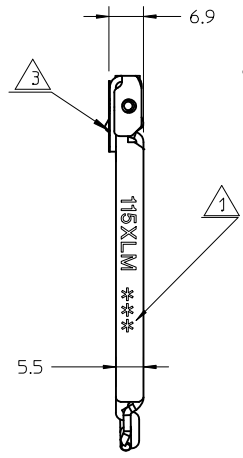
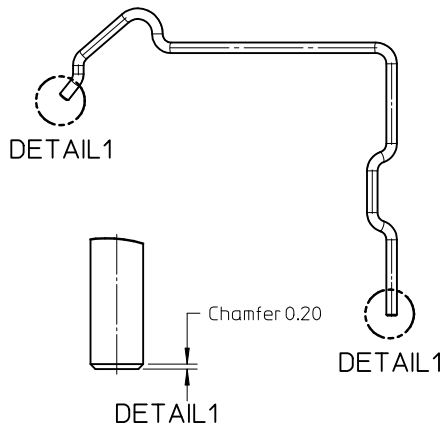

LEVER POSITION: OPEN  
PUSH LEVER OUT  
TO UNLOCK

NOTES:

- 1. INK PRINTED DATE CODE: \* \* \*  
 \* WORKING DAY  
 \* WORKING MONTH  
 \* WORKING YEAR
- 2. AREA FILLED WITH BLACK INK.
- 3. INSULATOR OVERHANG ILM FRAME.
- 4. PARTS ARE COMPLIANT TO RoHS DIRECTIVE 2002/95/EC AND ELV 2000/53/EC.
- 5. PARTS ARE HALOGEN FREE.

| BILL OF MATERIAL (47596-8855) |      |                            |                           |
|-------------------------------|------|----------------------------|---------------------------|
| ITEM NO                       | Q'TY | DESCRIPTION                | MATERIAL                  |
|                               | 1    | ILM TOP ASSY WITHOUT SCREW |                           |
| ①                             | 1    | ILM LEVER                  | STAINLESS STEEL           |
| ②                             | 1    | ILM LOAD PLATE             | SUS430                    |
| ③                             | 1    | ILM FRAME                  | STEEL WITH NICKEL PLATING |
| ④                             | 1    | ILM FRAME INSULATOR        | POLYCARBONATE FILM        |

|   |                 |  |                 |   |                             |                        |  |
|---|-----------------|--|-----------------|---|-----------------------------|------------------------|--|
| ENTER DESCRIPTION<br>EC NO: SH2012-0210<br>DRWN: ZHANG11 2012/01/05<br>CHKD:<br>APPR: AYIN 2012/02/02 | QUALITY SYMBOLS | GENERAL TOLERANCES (UNLESS SPECIFIED)                | DIMENSION STYLE | SCALE   | DESIGN UNITS                | THIRD ANGLE PROJECTION |  |
|   | $F_A=0$         | 4 PLACES ± --- ± ---                                 | MM ONLY         | 1:1   | METRIC                      | ⊙                      |  |
|   | $F_C=0$         | 3 PLACES ± --- ± ---                                 | mm INCH         | DRAWN BY DATE   | TITLE                       |                        |  |
|   | $F_D=0$         | 2 PLACES ± 0.10 ± ---                                | mm INCH         | CHECKED BY DATE   | 115X ILM TOP ASSY<br>SUS430 |                        |  |
|   | $F_E=0$         | 1 PLACE ± 0.25 ± ---                                 | mm INCH         | APPROVED BY DATE  | MOLEX INCORPORATED          |                        |  |
|   | ANGULAR ± ---°  |  | MATERIAL NO.    | DOCUMENT NO.  |                             | SHEET NO.              |  |
|   |                 | DRAFT WHERE APPLICABLE MUST REMAIN WITHIN DIMENSIONS | SEE TABLE       | SD-47596-003  |                             | 1 OF 2                 |  |
|   |                 |  | SIZE A3         | THIS DRAWING CONTAINS INFORMATION THAT IS PROPRIETARY TO MOLEX INCORPORATED AND SHOULD NOT BE USED WITHOUT WRITTEN PERMISSION |                             |                        |  |

|            |                       |
|------------|-----------------------|
| 47596-8855 | WITHOUT ILM PNP COVER |
| PART NO.   | DESCRIPTION           |

9 8 7 6 5 4 3 2 1

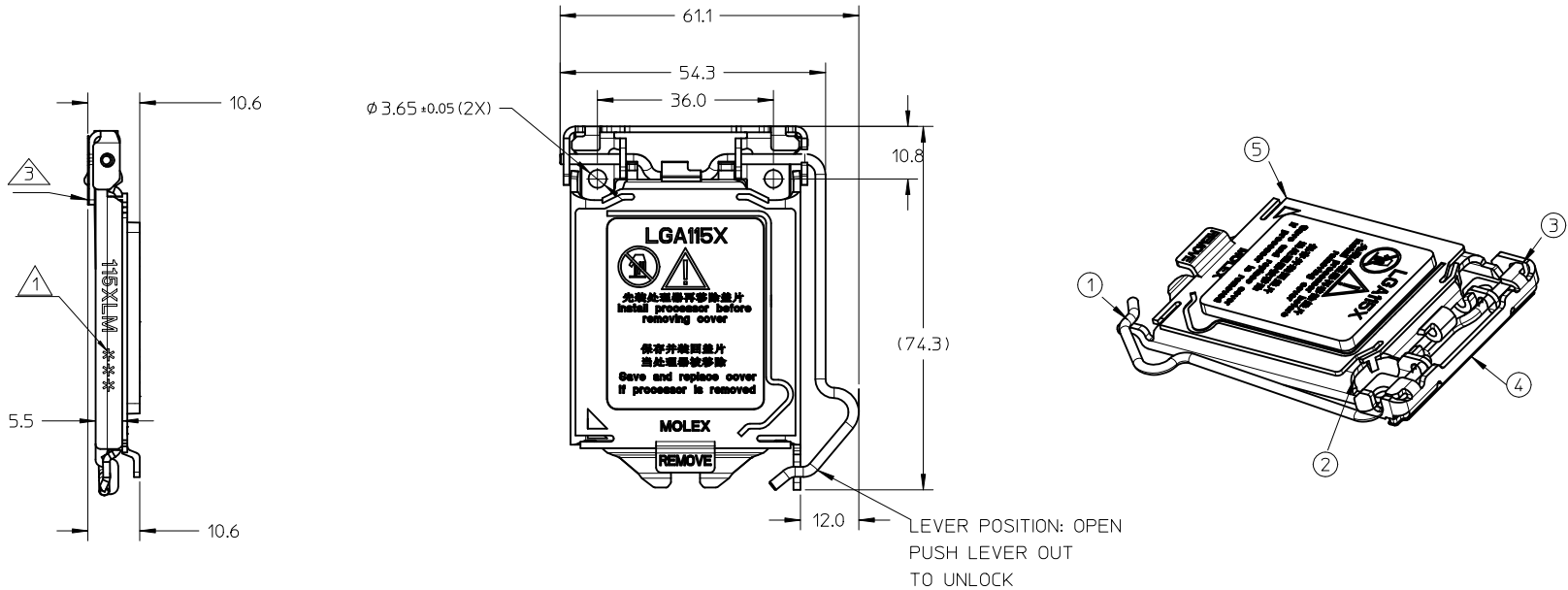

BILL OF MATERIAL (47596-8755)

| ITEM NO | Q'TY | DESCRIPTION                | MATERIAL                  |
|---------|------|----------------------------|---------------------------|
|         | 1    | ILM TOP ASSY WITHOUT SCREW |                           |
| ①       | 1    | ILM LEVER                  | STAINLESS STEEL           |
| ②       | 1    | ILM LOAD PLATE             | SUS430                    |
| ③       | 1    | ILM FRAME                  | STEEL WITH NICKEL PLATING |
| ④       | 1    | ILM FRAME INSULATOR        | POLYCARBONATE FILM        |
| ⑤       | 1    | ILM PNP COVER              | PC/ABS                    |

|            |                    |
|------------|--------------------|
| 47596-8755 | WITH ILM PNP COVER |
| PART NO.   | DESCRIPTION        |

|   |   |                 |                                       |   |                            |   |                                      |                        |                        |  |
|---|---|-----------------|---------------------------------------|---|----------------------------|---|--------------------------------------|------------------------|------------------------|--|
| ENTER DESCRIPTION<br>EC NO: SHZ012-0210<br>DRWN: ZHANG11<br>CHKD:<br>APPR: AYIN | DESCRIPTION<br>2012/01/05<br>2012/02/02 | QUALITY SYMBOLS | GENERAL TOLERANCES (UNLESS SPECIFIED) |   | DIMENSION STYLE<br>MM ONLY |   | SCALE<br>1:1                         | DESIGN UNITS<br>METRIC | THIRD ANGLE PROJECTION |  |
|   |   | $F_A=0$         | mm                                    | INCH  | DRAWN BY<br>JGU007         | DATE<br>2008/01/10  | TITLE<br>115X ILM TOP ASSY<br>SUS430 |                        |                        |  |
|   |   | $F_C=0$         | 4 PLACES ± ---                        | ± ---   | CHECKED BY<br>JKACHLIC     | DATE<br>2008/01/10  | APPROVED BY<br>AYIN                  |                        |                        |  |
|   |   | $F_B=0$         | 3 PLACES ± ---                        | ± ---   | DATE<br>2010/12/10         | MATERIAL NO.<br>SEE TABLE   |                                      |                        |                        |  |
|   |   | 2 PLACES ± 0.10 | ± ---                                 | APPROVED BY<br>AYIN                                     |                            | DATE<br>2010/12/10  |                                      | MOLEX INCORPORATED     |                        |  |
|   |   | 1 PLACE ± 0.25  | ± ---                                 | MATERIAL NO.  |                            | DOCUMENT NO.  |                                      | SHEET NO.              |                        |  |
|   |   | ANGULAR ± ---°  |                                       | DRAFT WHERE APPLICABLE<br>MUST REMAIN WITHIN DIMENSIONS |                            | SD-47596-003  |                                      | 2 OF 2                 |                        |  |
|   |   |                 |                                       | SIZE<br>A3  |                            | THIS DRAWING CONTAINS INFORMATION THAT IS PROPRIETARY TO MOLEX INCORPORATED AND SHOULD NOT BE USED WITHOUT WRITTEN PERMISSION |                                      |                        |                        |  |