

Adapter plate - VS-ADP16-RJ45/RJ45 - 1652156

Please be informed that the data shown in this PDF Document is generated from our Online Catalog. Please find the complete data in the user's documentation. Our General Terms of Use for Downloads are valid (<http://download.phoenixcontact.com>)



Adapter plate, size B16, reinforced, including the RJ45/IP67 panel mounting frame for modular socket inserts with protective cover and without contact insert, and the RJ45/IP67 panel mounting frame for modular socket inserts with protective cover and without contact insert



Key commercial data

Packing unit	1 1
Weight per Piece (excluding packing)	58.2 GRM
Custom tariff number	85369010
Country of origin	Germany

Technical data

Ambient conditions

Ambient temperature (operation)	-20 °C ... 80 °C
Degree of protection	IP54

Material data

Inflammability class according to UL 94	HB
Housing material	PA
Material	PA
Sealing material	TPE
Seal material	TPE

Classifications

eCl@ss

eCl@ss 4.0	27140816
eCl@ss 4.1	27140816
eCl@ss 5.0	27189239

Adapter plate - VS-ADP16-RJ45/RJ45 - 1652156

Classifications

eCl@ss

eCl@ss 5.1	27189239
eCl@ss 6.0	27144001
eCl@ss 7.0	27144001
eCl@ss 8.0	27144001

ETIM

ETIM 2.0	EC000007
ETIM 3.0	EC000007
ETIM 4.0	EC000007
ETIM 5.0	EC002309

UNSPSC

UNSPSC 6.01	31261501
UNSPSC 7.0901	31261501
UNSPSC 11	31261501
UNSPSC 12.01	31261501
UNSPSC 13.2	31261501

Drawings

Dimensioned drawing

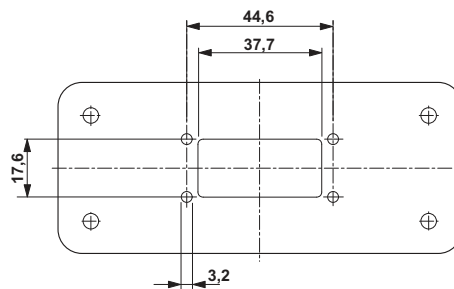

Panel cutout

Adapter plate - VS-ADP16-RJ45/RJ45 - 1652156

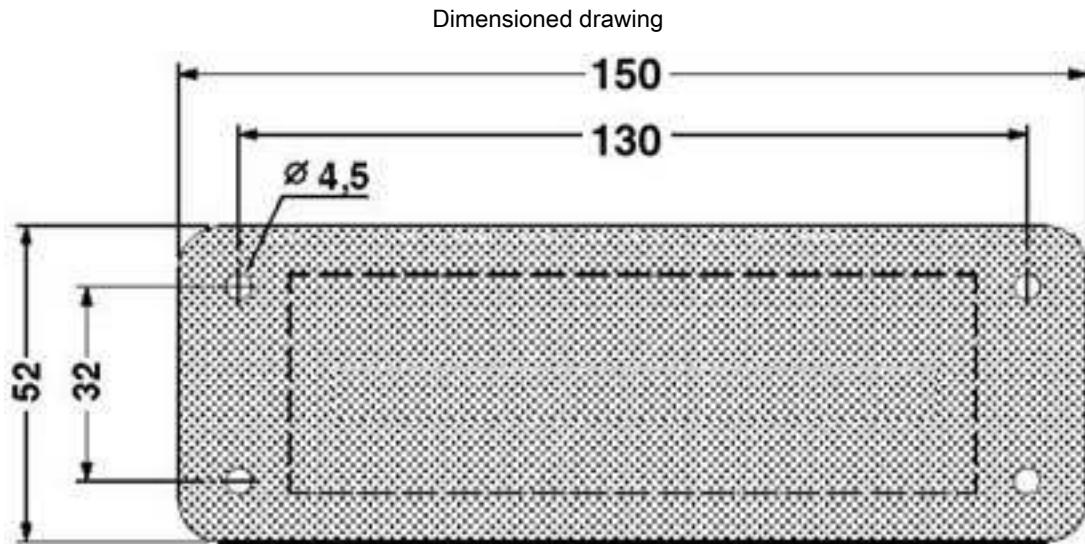

Adapter plate